

UNITED STATES
DEPARTMENT OF THE INTERIOR
GEOLOGICAL SURVEY

30-039-20881

APPLICATION FOR PERMIT TO DRILL, DEEPEN, OR PLUG BACK

1a. TYPE OF WORK

DRILL ☒DEEPEN ☐PLUG BACK ☐

b. TYPE OF WELL

OIL
WELL ☐GAS
WELL ☒

OTHER

SINGLE
ZONE ☒MULTIPLE
ZONE ☐

2. NAME OF OPERATOR

El Paso Natural Gas Company

3. ADDRESS OF OPERATOR

PO Box 990, Farmington, NM 87401

4. LOCATION OF WELL (Report location clearly and in accordance with any State requirements.*)

At surface

1190'S, 800'W

At proposed prod. zone

14. DISTANCE IN MILES AND DIRECTION FROM NEAREST TOWN OR POST OFFICE*

15. DISTANCE FROM PROPOSED*

LOCATION TO NEAREST
PROPERTY OR LEASE LINE, FT.
(Also to nearest drlg. unit line, if any)

16. NO. OF ACRES IN LEASE

17. NO. OF ACRES ASSIGNED
TO THIS WELL

320 ✓

18. DISTANCE FROM PROPOSED LOCATION*
TO NEAREST WELL, DRILLING, COMPLETED,
OR APPLIED FOR, ON THIS LEASE, FT.19. PROPOSED DEPTH
8478'20. ROTARY OR CABLE TOOLS
Rotary

21. ELEVATIONS (Show whether DF, RT, GR, etc.)

7124'GL

22. APPROX. DATE WORK WILL START*

23. PROPOSED CASING AND CEMENTING PROGRAM

SIZE OF HOLE	SIZE OF CASING	WEIGHT PER FOOT	SETTING DEPTH	QUANTITY OF CEMENT
13 3/4"	9 5/8"	32.3#	200'	210 cu. ft. to circulate
8 3/4"	7"	20.0#	4291'	193 cu. ft. to cover Ojo Alamo
6 1/4"	4 1/2"	10.5#&11.6#	8478'	659 cu. ft. to fill to 4291'

Selectively perforate and sandwater fracture the Dakota formation.

Forest approval has been secured.

The W/2 of Section 22 is dedicated to this well.

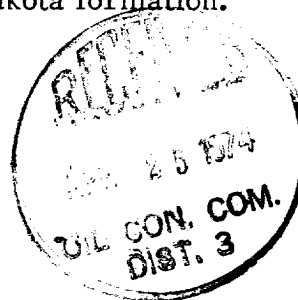

IN ABOVE SPACE DESCRIBE PROPOSED PROGRAM: If proposal is to deepen or plug back, give data on present productive zone and proposed new productive zone. If proposal is to drill or deepen directionally, give pertinent data on subsurface locations and measured and true vertical depths. Give blowout preventer program, if any.

24. SIGNED A. H. Suico TITLE Drilling Clerk DATE April 23, 1974

(This space for Federal or State office use)

PERMIT NO. _____ APPROVAL DATE _____

APPROVED BY _____ TITLE _____ DATE APR 24 1974
CONDITIONS OF APPROVAL, IF ANY:

NEW MEXICO OIL CONSERVATION COMMISSION

WELL LOCATION AND ACERAGE DEDICATION PLAT

All distances must be from the outer boundaries of the Section

Operator EL PASO NATURAL GAS COMPANY			Lease SAN JUAN 27-4 UNIT (SF-080674)		Well No. 100
Unit Letter M	Section 22	Township 27 NORTH	Range 4 WEST	County RIO ARriba	
Actual Footage Location of Well: 1190 feet from the SOUTH line and 800 feet from the WEST line					
Ground Level Elev. 7124.0	Producing Formation DAKOTA	Pool BASIN DAKOTA	Dedicated Acreage: 320.00 ✓ Acres		

1. Outline the acreage dedicated to the subject well by colored pencil or hatchure marks on the plat below.
2. If more than one lease is dedicated to the well, outline each and identify the ownership thereof (both as to working interest and royalty),
3. If more than one lease of different ownership is dedicated to the well, have the interests of all owners been consolidated by communitization, unitization, force-pooling, etc?

(X) Yes () No If answer is "yes," type of consolidation Unitization

If answer is "no," list the owners and tract descriptions which have actually consolidated. (Use reverse side of this form if necessary.)

No allowable will be assigned to the well until all interests have been consolidated (by communitization, unitization, forced-pooling, or otherwise) or until a non standard unit, eliminating such interests, has been approved by the Commission.

CERTIFICATION

I hereby certify that the information contained herein is true and complete to the best of my knowledge and belief.

M. D. Buices
Name
Drilling Clerk
Position
El Paso Natural Gas Company
Company
April 23, 1974
Date

I hereby certify that the well location shown on this plat was plotted from field notes of actual surveys made by me or under my supervision, and that the same is true and correct to the best of my knowledge and belief.

22 October, 1973
Date Surveyed
James P. Leese
Professional Engineer
and/or Land Surveyor
JAMES P. LEESE
1162
Certificate No.

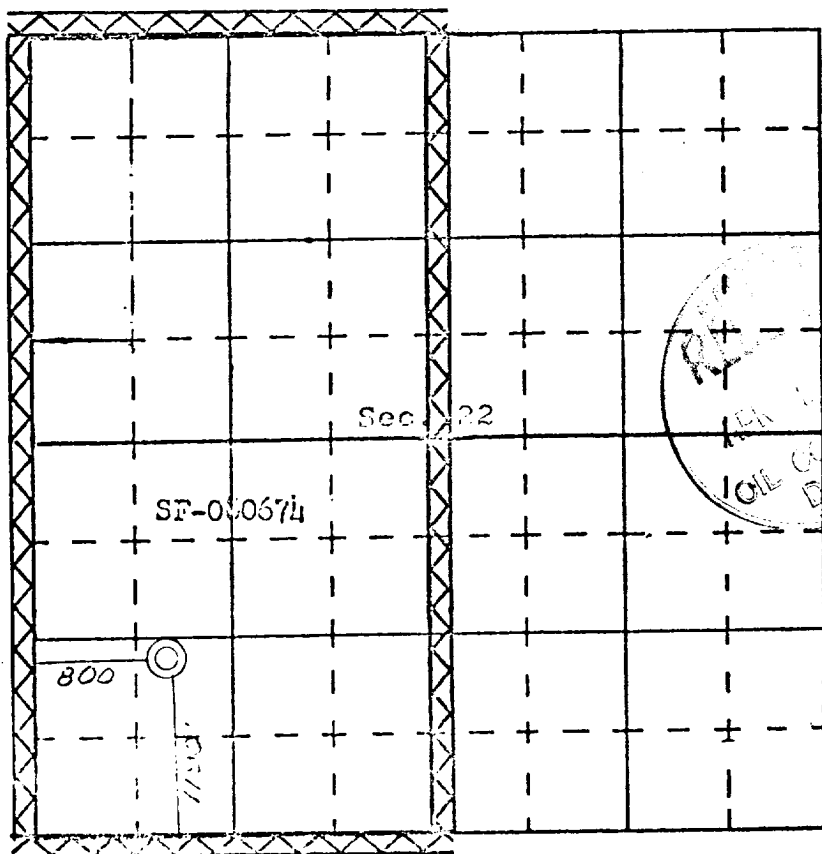

San Juan. 27-4 #100
NW/4 Sec 22, T-27N, R-4-W

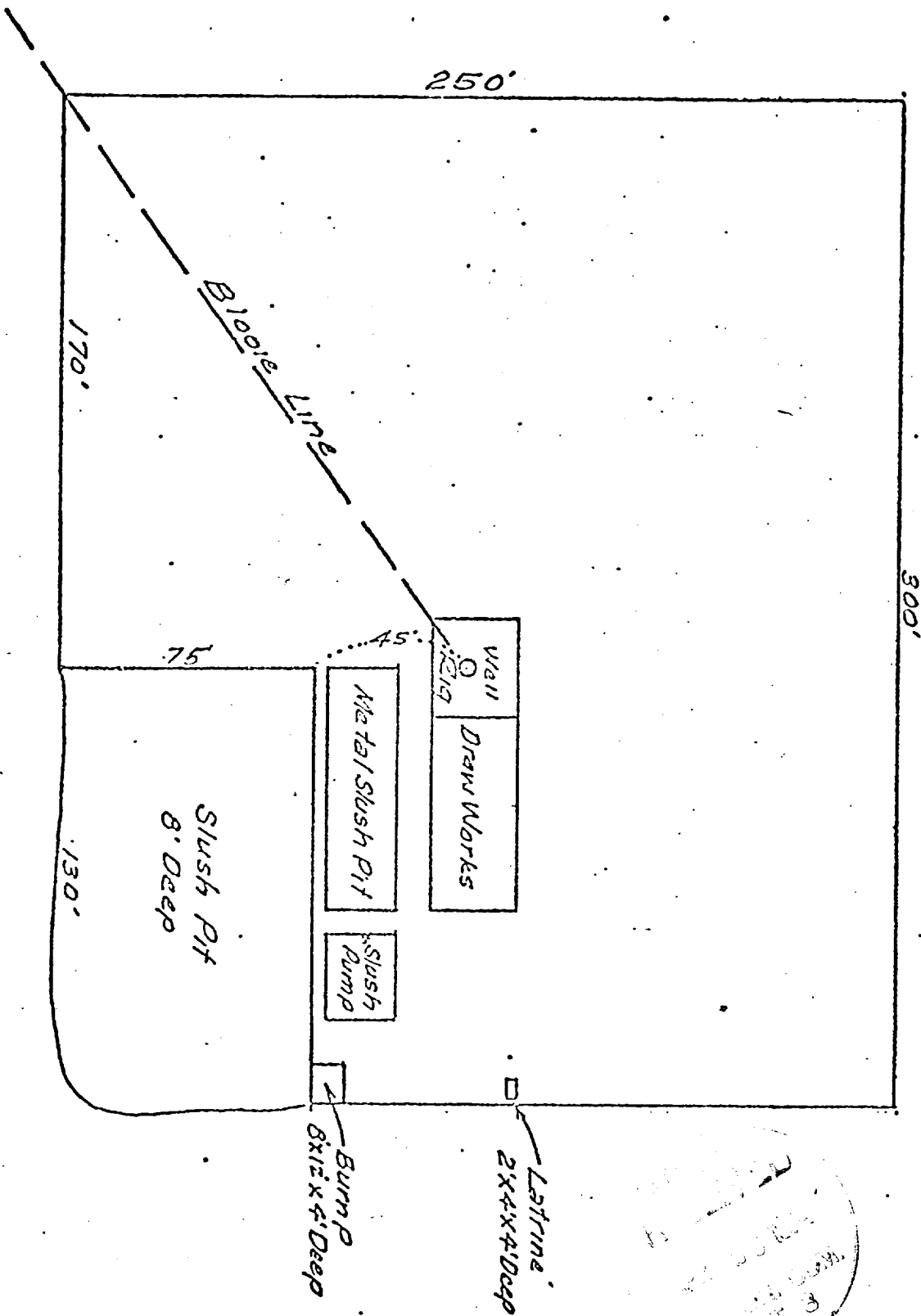

*See Cont. 27. 4 Cont # 100
 4557 III SE, Sec. 22, T. 27. N, R. 4. W
 510*

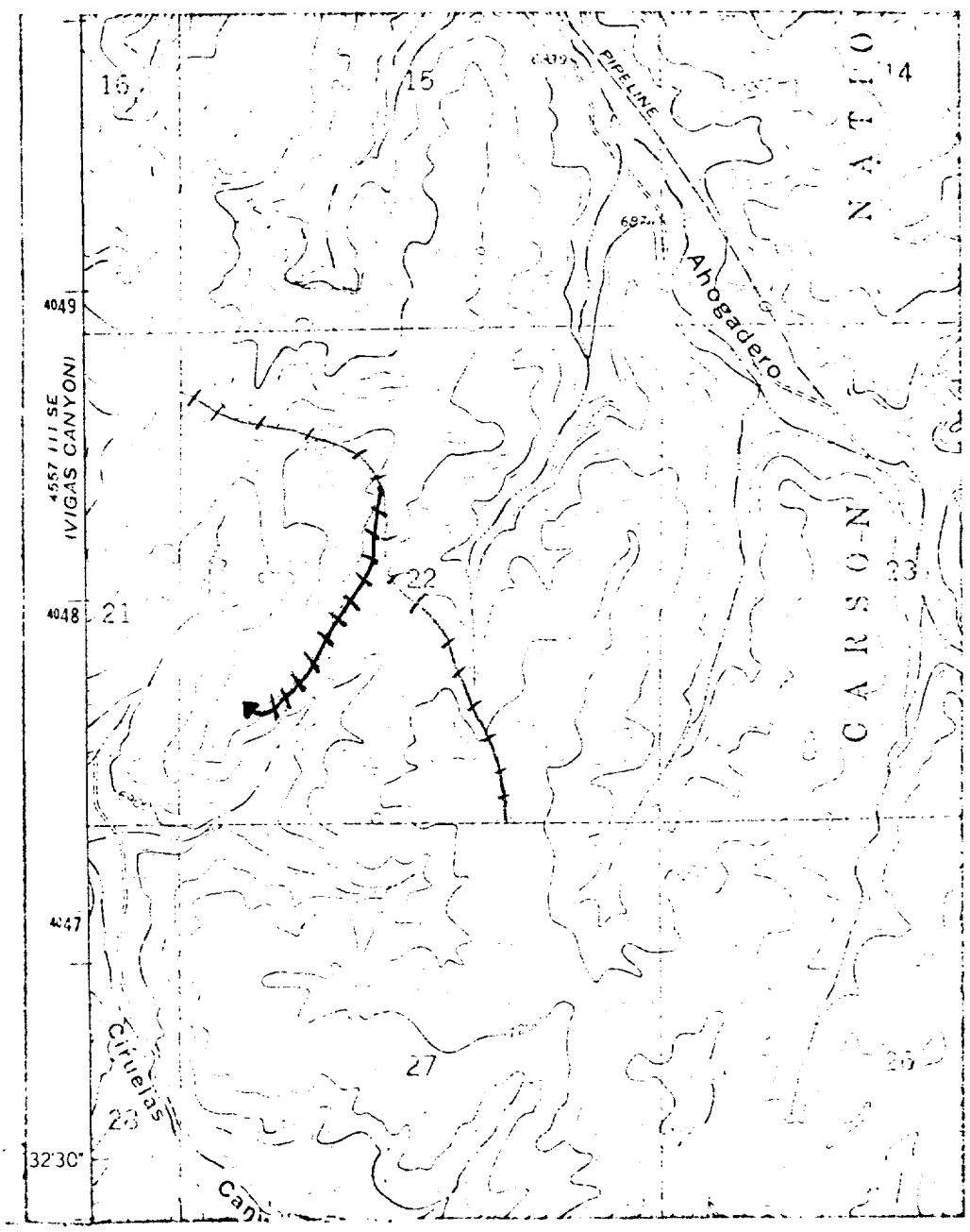

*See Cont. 27. 4 Cont # 100
 4557 III SE, Sec. 22, T. 27. N, R. 4. W
 510*

LEGEND OF RIGHT-OF-WAYS

- EXISTING ROADS —————
- EXISTING PIPELINES + + + +
- EXISTING ROAD & PIPELINE - + - + - +
- PROPOSED ROADS —————
- PROPOSED PIPELINES + + + + +
- PROPOSED ROAD & PIPELINE - + - + - +