

UNITED STATES  
DEPARTMENT OF THE INTERIOR  
GEOLOGICAL SURVEY

30-039-20914

## APPLICATION FOR PERMIT TO DRILL, DEEPEN, OR PLUG BACK

1a. TYPE OF WORK DRILL <input checked="" type="checkbox"/> DEEPEN <input type="checkbox"/> PLUG BACK <input type="checkbox"/>			5. LEASE DESIGNATION AND SERIAL NO. NM 03733
b. TYPE OF WELL OIL WELL <input type="checkbox"/> GAS WELL <input checked="" type="checkbox"/> OTHER <input type="checkbox"/> SINGLE ZONE <input type="checkbox"/> MULTIPLE ZONE <input checked="" type="checkbox"/>			6. IF INDIAN, ALLOTTEE OR TRIBE NAME
2. NAME OF OPERATOR Caulkins Oil Company			7. UNIT AGREEMENT NAME
3. ADDRESS OF OPERATOR P. O. Box 730, Farmington, New Mexico			8. FARM OR LEASE NAME Brecch
4. LOCATION OF WELL (Report location clearly and in accordance with any State requirements.)* At surface 790 from East Line - 1850 From North Line At proposed prod. zone Section 24 26 North 7 West Same			9. WELL NO. 354
11. DISTANCE IN MILES AND DIRECTION FROM NEAREST TOWN OR POST OFFICE* 32 miles South East Blanco New Mexico			10. FIELD AND POOL, OR WILDCAT South Blanco = Otero Chacr
12. DISTANCE FROM PROPOSED* LOCATION TO NEAREST PROPERTY OR LEASE LINE, FT. (Also to nearest drlg. unit line, if any) 790'			11. SEC., T., R., M., OR BLK. AND SURVEY OR AREA Section 24 26 North 7 We
13. DISTANCE FROM PROPOSED LOCATION* TO NEAREST WELL, DRILLING, COMPLETED, OR APPLIED FOR, ON THIS LEASE, FT. 2815'			12. COUNTY OR PARISH Rio Arriba
14. ELEVATIONS (Show whether DF, RT, GR, etc.) 6156 Ground			13. STATE New Mexico
15. NO. OF ACRES IN LEASE 2400			16. NO. OF ACRES ASSIGNED TO THIS WELL 160
17. PROPOSED DEPTH 3400			18. ROTARY OR CABLE TOOLS Rotary
19. APPROX. DATE WORK WILL START* June 15, 1974			

## 23. PROPOSED CASING AND CEMENTING PROGRAM

SIZE OF HOLE	SIZE OF CASING	WEIGHT PER FOOT	SETTING DEPTH	QUANTITY OF CEMENT
12 3/4	8 5/8"	24 <sup>1/2</sup>	120'	Sufficient to Circulate
7 7/8"	4 1/2"	12.60 <sup>1/2</sup>	3400'	Approx. 400 sacks

It is proposed to drill well to approx. 3400'. 4 1/2" casing will be run to TD and cemented with sufficient cement to cover Alamo sand. After cement sets 120 hours or more, casing will be perforated opposite Chacra sand and then sand water fraced with approx. 50,000 sand. Bridge plug will be set above Chacra perforations and then Pictured Cliffs will be perforated and sand water fraced. Bridge plug will be drilled out then permanent type production packer will be set at at approx. 3200'. 1 1/4" 2.4# IJ tubing will be run to production packer for Chacra production. 1" 1.7# IJ tubing will be run to top of Pictured Cliffs pay.

A pressure operated double blowout preventor will be in use at all times while drilling below 120'.

IN ABOVE SPACE DESCRIBE PROPOSED PROGRAM: If proposal is to deepen or plug back, give data on present productive zone and proposed new productive zone. If proposal is to drill or deepen directionally, give pertinent data on subsurface locations and measured and true vertical depths. Give blowout preventer program, if any.

24. SIGNED Charles E. Wagner TITLE Superintendent DATE 5-30-74  
(This space for Federal or State office use)

PERMIT NO. \_\_\_\_\_ APPROVAL DATE \_\_\_\_\_

APPROVED BY EA TITLE \_\_\_\_\_ DATE \_\_\_\_\_  
CONDITIONS OF APPROVAL, IF ANY:

CAULKINS OIL COMPANY  
Post Office Box 700  
Farmington, New Mexico 87401

May 30, 1974

United States Dept. of the Interior  
Geological Survey  
Post Office Box 1809  
Durango, Colorado 81301

Gentlemen:

Following is our 12 point development plan for surface use on our well number 354, located in NE $\frac{1}{4}$  of section 24 26 north 7 west, Rio Arriba County, New Mexico:

- (1) Location will be built next to existing unimproved road, State Highway No. 403 approximately 1/2 mile south east of Largo Canyon school.
- (2) No new roads.
- (3) Included on attached Nageezi Quadrangle Topographic.
- (4) Ditto
- (5) No tank batteries. Produced gas will be sold to Southern Union Gas Company.
- (6) Water will be hauled from pit in Largo Canyon. Pit located at bridge near Largo Canyon School.
- (7) All cuttings, trash, garbage and etc. will be confined in reserve pit shown on attached layout plat.
- (8) No Camps.
- (9) No Airstrip.
- (10) Surface vegetation is sage brush. Completed drilling pad will be compacted.
- (11) Reserve pit will be cleaned up and leveled, then complete location area will be reseeded with BLM approved seed mixture.
- (12) Location will be on nearly level land next to main road and Largo Wash.

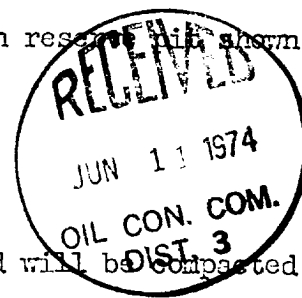

Yours very truly,

*Charles E. Verquer*  
Charles Verquer, Supt.  
Caulkins Oil Company

NEW MEXICO OIL CONSERVATION COMMISSION  
WELL LOCATION AND ACREAGE DEDICATION PLAT

Form C-102  
Supersedes C-128  
Effective 1-1-65

All distances must be from the outer boundaries of the Section.

Operator <b>Caulkins Oil Company</b>		Lease <b>NM 03733</b>		Well No. <b>354</b>	
Unit Letter <b>H</b>	Section <b>24</b>	Township <b>26 North</b>	Range <b>7 West</b>	County <b>Rio Arriba</b>	
Actual Footage Location of Well: <b>1850</b> feet from the <b>North</b> line and <b>790</b> feet from the <b>East</b> line					
Ground Level Elev. <b>6156</b>	Producing Formation <b>Pictured Cliffs-Chacra</b>		Pool <b>South Blanco</b>	Dedicated Acreage <b>160</b> Acres	

1. Outline the acreage dedicated to the subject well by colored pencil or hachure marks on the plat below.
2. If more than one lease is dedicated to the well, outline each and identify the ownership thereof (both as to working interest and royalty).
3. If more than one lease of different ownership is dedicated to the well, have the interests of all owners been consolidated by communitization, unitization, force-pooling, etc?

☐ Yes ☐ No If answer is "yes," type of consolidation \_\_\_\_\_

If answer is "no," list the owners and tract descriptions which have actually been consolidated. (Use reverse side of this form if necessary.) \_\_\_\_\_

No allowable will be assigned to the well until all interests have been consolidated (by communitization, unitization, forced-pooling, or otherwise) or until a non-standard unit, eliminating such interests, has been approved by the Commission.

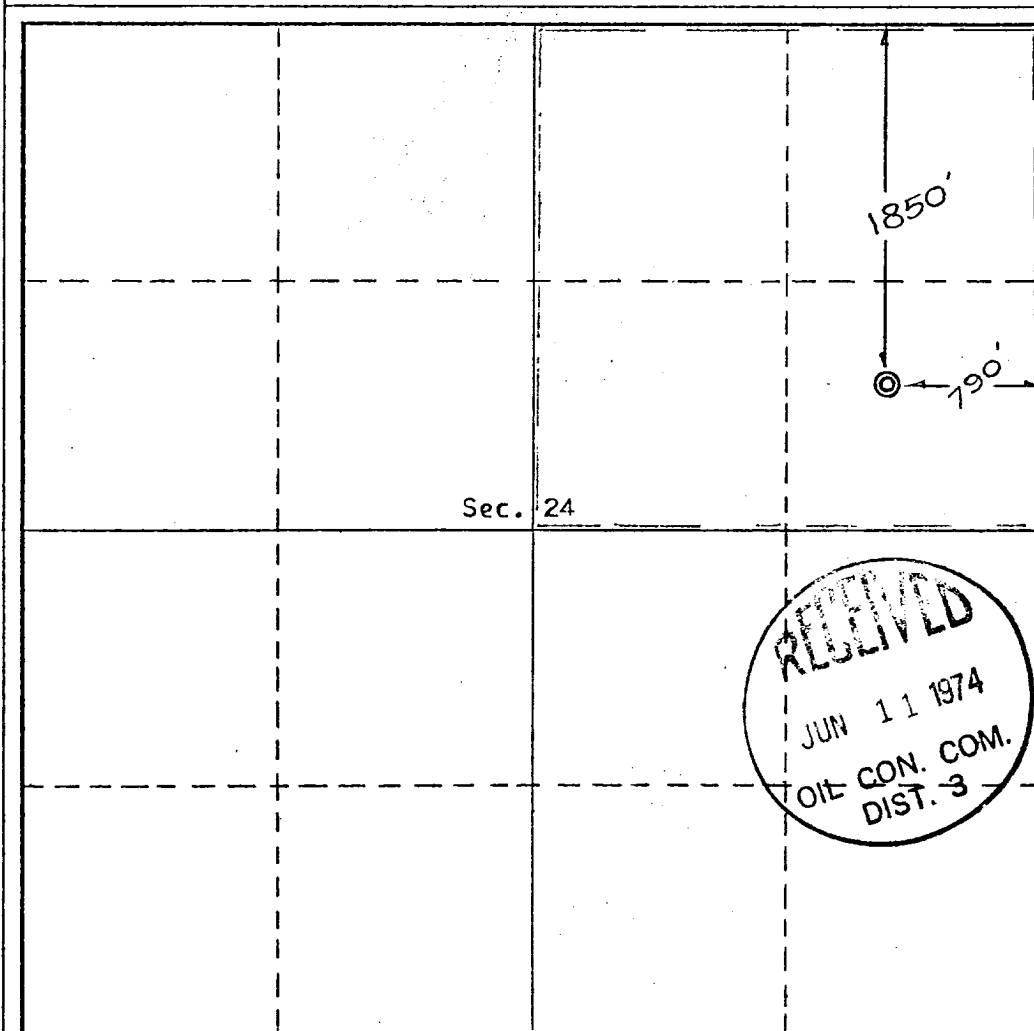

CERTIFICATION

I hereby certify that the information contained herein is true and complete to the best of my knowledge and belief.

Name  
*Charles E. Viquez*

Position  
**Superintendent**

Company  
**Caulkins Oil Company**

Date  
**May 30, 1974**

hereby certify that the well location shown on this plat was plotted from field notes of actual surveys made by me or under my supervision, and that the same is true and correct to the best of my knowledge and belief.

REGISTERED LAND SURVEYOR

Date Surveyed  
**May 21, 1974**

Registered Professional Engineer and/or Land Surveyor

*E.V. Echhawk*

Certificate No. **3602**  
**E.V. Echhawk LS**

0 330 660 990 1320 1650 1980 2310 2640 2000 1500 1000 500 0

A 354

15 MINUTE SERIES (TOPOGRAPHIC)

107°30'

 $36^{\circ}30'$ 

200,000 FEET  
(WEST)

- New Loc.  
- no new Road.

RECEIVED

DIE CON. COM.  
DIST. 3

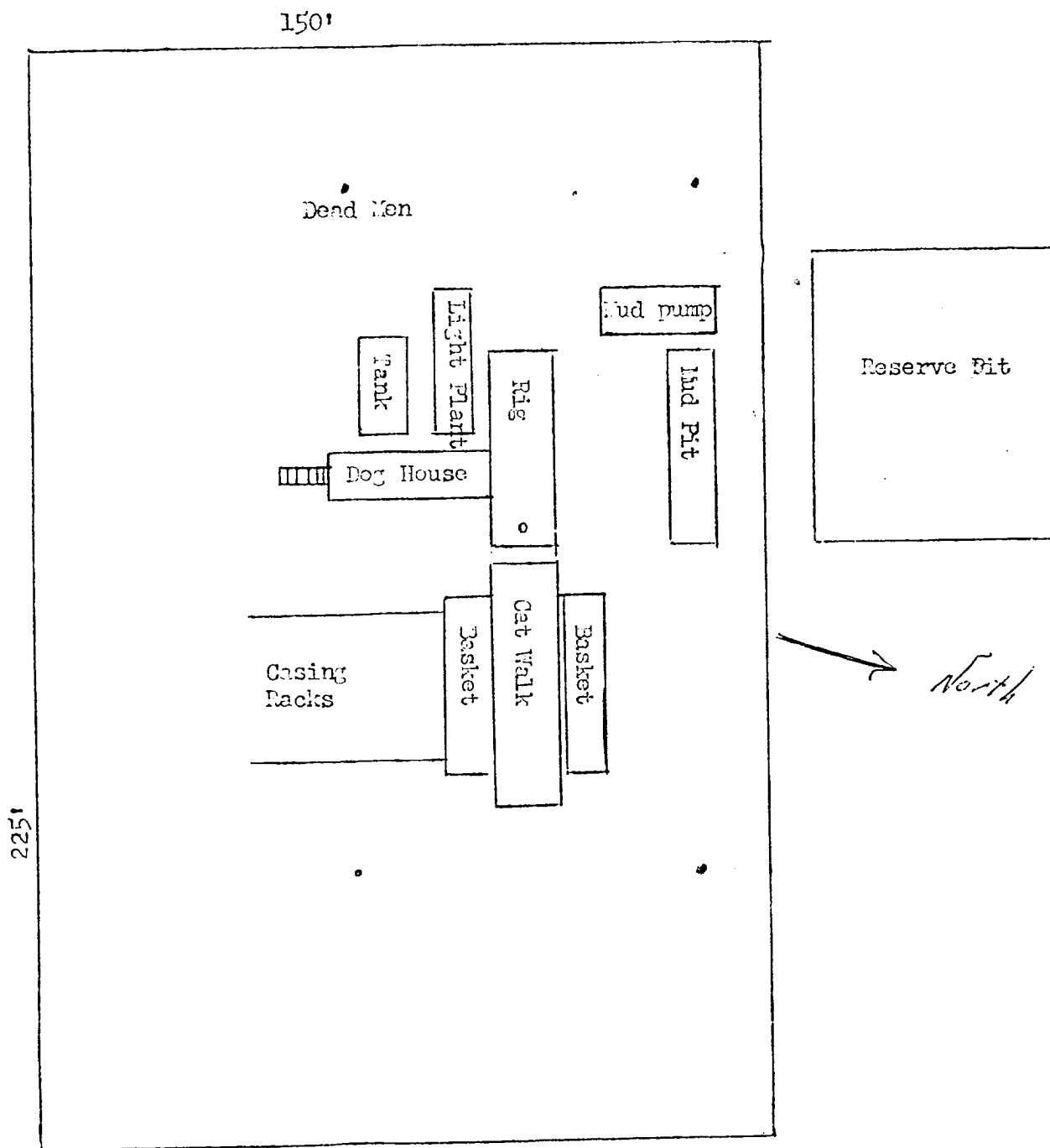

Scale - 33 1/3 feet per inch

Location Number 354

NE 1/4 section 24 26 North 7 West

