

UNITED STATES
DEPARTMENT OF THE INTERIOR
GEOLOGICAL SURVEY

30-039-21014

APPLICATION FOR PERMIT TO DRILL, DEEPEN, OR PLUG BACK		5. LEASE DESIGNATION AND SERIAL NO.
1a. TYPE OF WORK DRILL <input checked="" type="checkbox"/> DEEPEN <input type="checkbox"/> PLUG BACK <input type="checkbox"/>		SF 080675
b. TYPE OF WELL OIL WELL <input type="checkbox"/> GAS WELL <input checked="" type="checkbox"/> OTHER <input type="checkbox"/> SINGLE ZONE <input checked="" type="checkbox"/> MULTIPLE ZONE <input type="checkbox"/>		6. IF INDIAN, ALLOTTEE OR TRIBE NAME
2. NAME OF OPERATOR El Paso NaturalGas Company		7. UNIT AGREEMENT NAME San Juan 27-4 Unit
3. ADDRESS OF OPERATOR PO Box 990, Farmington, NM 87401		8. FARM OR LEASE NAME San Juan 27-4 Unit
4. LOCATION OF WELL (Report location clearly and in accordance with any State requirements.)* At surface 1530'N, 790'W At proposed prod. zone		9. WELL NO. 111
14. DISTANCE IN MILES AND DIRECTION FROM NEAREST TOWN OR POST OFFICE*		10. FIELD AND POOL, OR WILDCAT Tapacito Pictured Cliffs Ext.
15. DISTANCE FROM PROPOSED* LOCATION TO NEAREST PROPERTY OR LEASE LINE, FT. (Also to nearest drlg. unit line, if any.)		11. SEC., T., R., M., OR BLK. AND SURVEY OR AREA Sec. 28, T-27-N, R-4-W NMPM
16. NO. OF ACRES IN LEASE		12. COUNTY OR PARISH Rio Arriba
17. NO. OF ACRES ASSIGNED TO THIS WELL 160.00		13. STATE NM
18. DISTANCE FROM PROPOSED LOCATION* TO NEAREST WELL, DRILLING, COMPLETED, OR APPLIED FOR, ON THIS LEASE, FT.		19. PROPOSED DEPTH 4140'
20. ROTARY OR CABLE TOOLS Rotary		21. APPROX. DATE WORK WILL START*
21. ELEVATIONS (Show whether DF, RT, GR, etc.) 7150'GL		

23. PROPOSED CASING AND CEMENTING PROGRAM

SIZE OF HOLE	SIZE OF CASING	WEIGHT PER FOOT	SETTING DEPTH	QUANTITY OF CEMENT
12 1/4"	8 5/8"	24.0#	120'	105 cu. ft. to circulate
6 3/4"	2 7/8"	6.4#	4140'	200 cu. ft. to cover Ojo Alamo

Selectively perforate and sandwater fracture the Pictured Cliffs formation.

Forest approval has been secured.

The NW/4 of Section 28 is dedicated to this well.

IN ABOVE SPACE DESCRIBE PROPOSED PROGRAM: If proposal is to deepen or plug back, give data on present productive zone and proposed new productive zone. If proposal is to drill or deepen directionally, give pertinent data on subsurface locations and measured and true vertical depths. Give blowout preventer program, if any.

24. SIGNED A. G. Buico TITLE Drilling Clerk DATE September 5, 1974
(This space for Federal or State office use)

PERMIT NO. _____ APPROVAL DATE _____

APPROVED BY _____ TITLE _____ DATE SEP 20 1974
CONDITIONS OF APPROVAL, IF ANY:*alio*

*See Instructions On Reverse Side

U. S. GEOLOGICAL SURVEY
BIO. LAB., COLO.

NEW MEXICO OIL CONSERVATION COMMISSION
WELL LOCATION AND ACREAGE DEDICATION PLAT

Form C-102
Supersedes C-128
Effective 1-1-65

All distances must be from the outer boundaries of the Section.

Operator El Paso Natural Gas Company			Lease San Juan 27-4 Unit (SF-080675)		Well No. 111
Unit Letter E	Section 28	Township 27N	Range 4W	County Rio Arriba	
Actual Footage Location of Well: 1530 feet from the North line and 790 feet from the West line					
Ground Level Elev. 7150	Producing Formation Pictured Cliffs	Pool TAPACITO PICTURED CLIFFS EXT.		Dedicated Acreage: 160.00 Acres	

1. Outline the acreage dedicated to the subject well by colored pencil or hachure marks on the plat below.
2. If more than one lease is dedicated to the well, outline each and identify the ownership thereof (both as to working interest and royalty).
3. If more than one lease of different ownership is dedicated to the well, have the interests of all owners been consolidated by communitization, unitization, force-pooling, etc?

☒ Yes ☐ No If answer is "yes," type of consolidation Unitization

If answer is "no," list the owners and tract descriptions which have actually been consolidated. (Use reverse side of this form if necessary.)

No allowable will be assigned to the well until all interests have been consolidated (by communitization, unitization, forced-pooling, or otherwise) or until a non-standard unit, eliminating such interests, has been approved by the Commission.

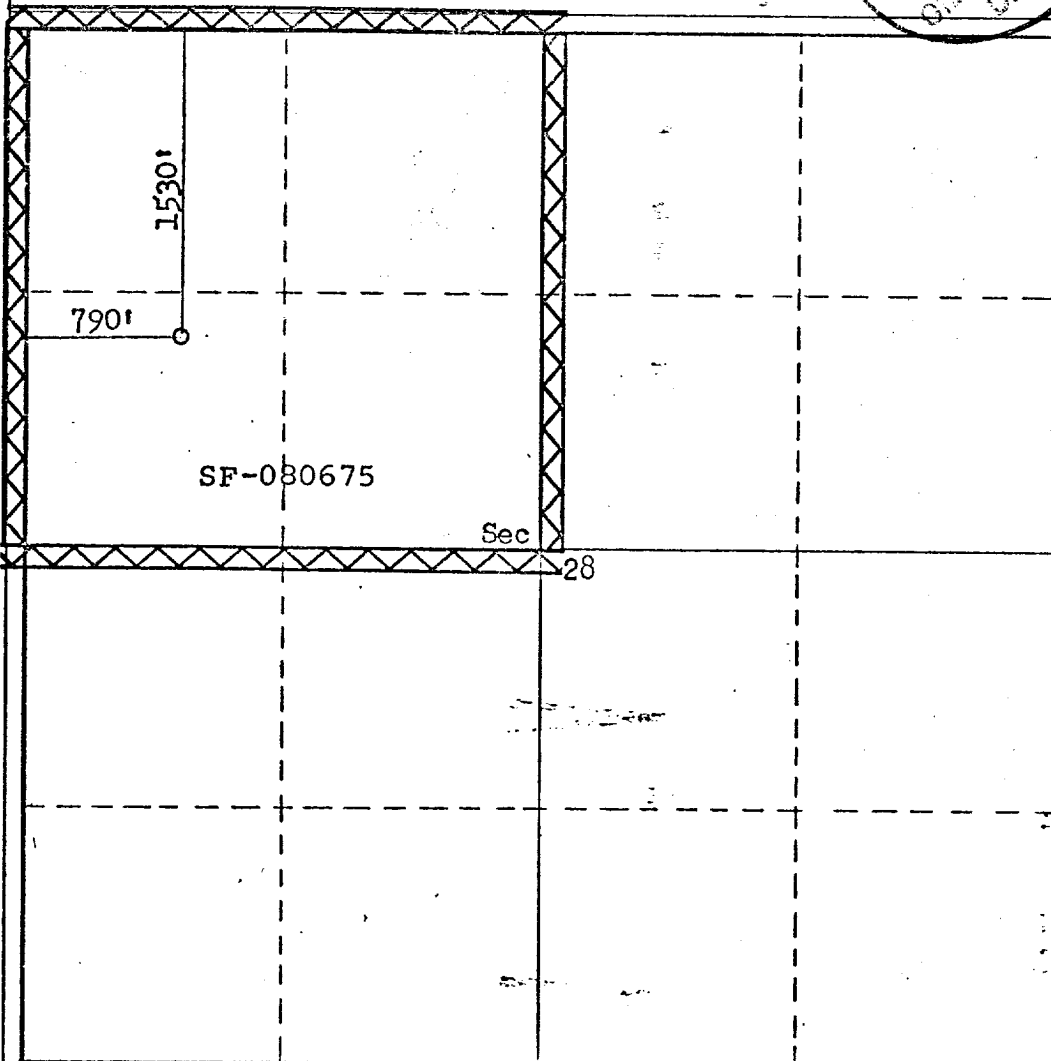

CERTIFICATION

I hereby certify that the information contained herein is true and complete to the best of my knowledge and belief.

A. G. Suarez

Name
Drilling Clerk

Position
El Paso Natural Gas Co.

Company
September 5, 1974

Date

I hereby certify that the well location shown on this plat was plotted from field notes of actual surveys made by me or under my supervision, and that the same is true and correct to the best of my knowledge and belief.

Date Surveyed

April 24, 1974

Registered Professional Engineer
and/or Land Surveyor

Fred B. Kerr Jr.
Fred B. Kerr Jr.

Certificate No.

3950

0 330 660 990 1320 1650 1980 2310 2640 2970 3300 3630 3960 4290 4620 4950 5280 5610 5940 6270 6600

LOCATION AND EQUIPMENT LAY-OUT

SAN JUAN 27-4 UNIT No. 111

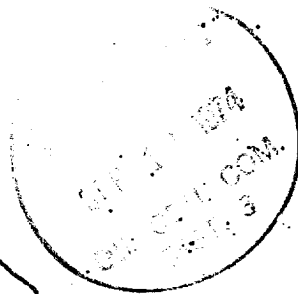
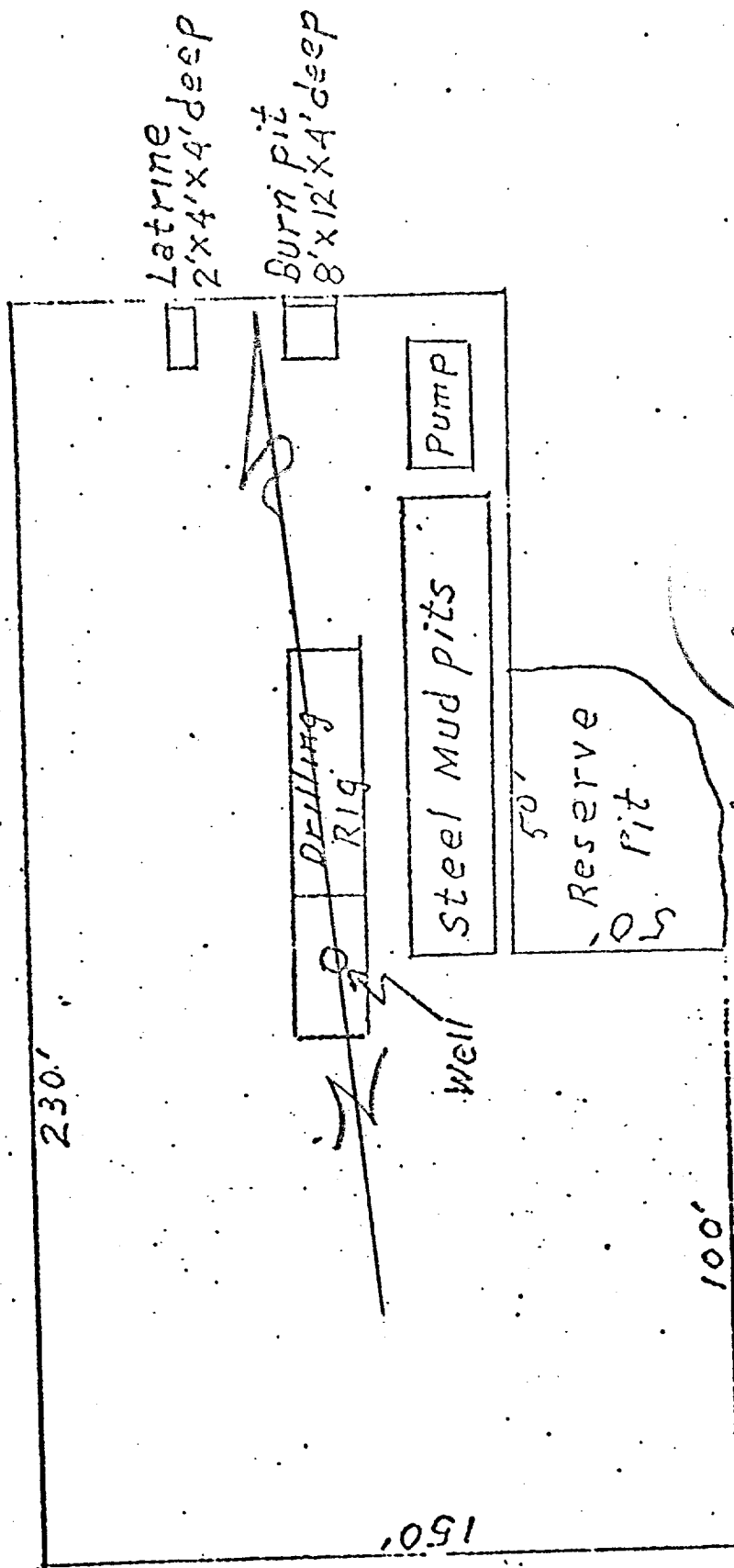

San Juan 27-4 Unit # 111
 SW 1/4 Sec. 28, T-27-N, R-4-W

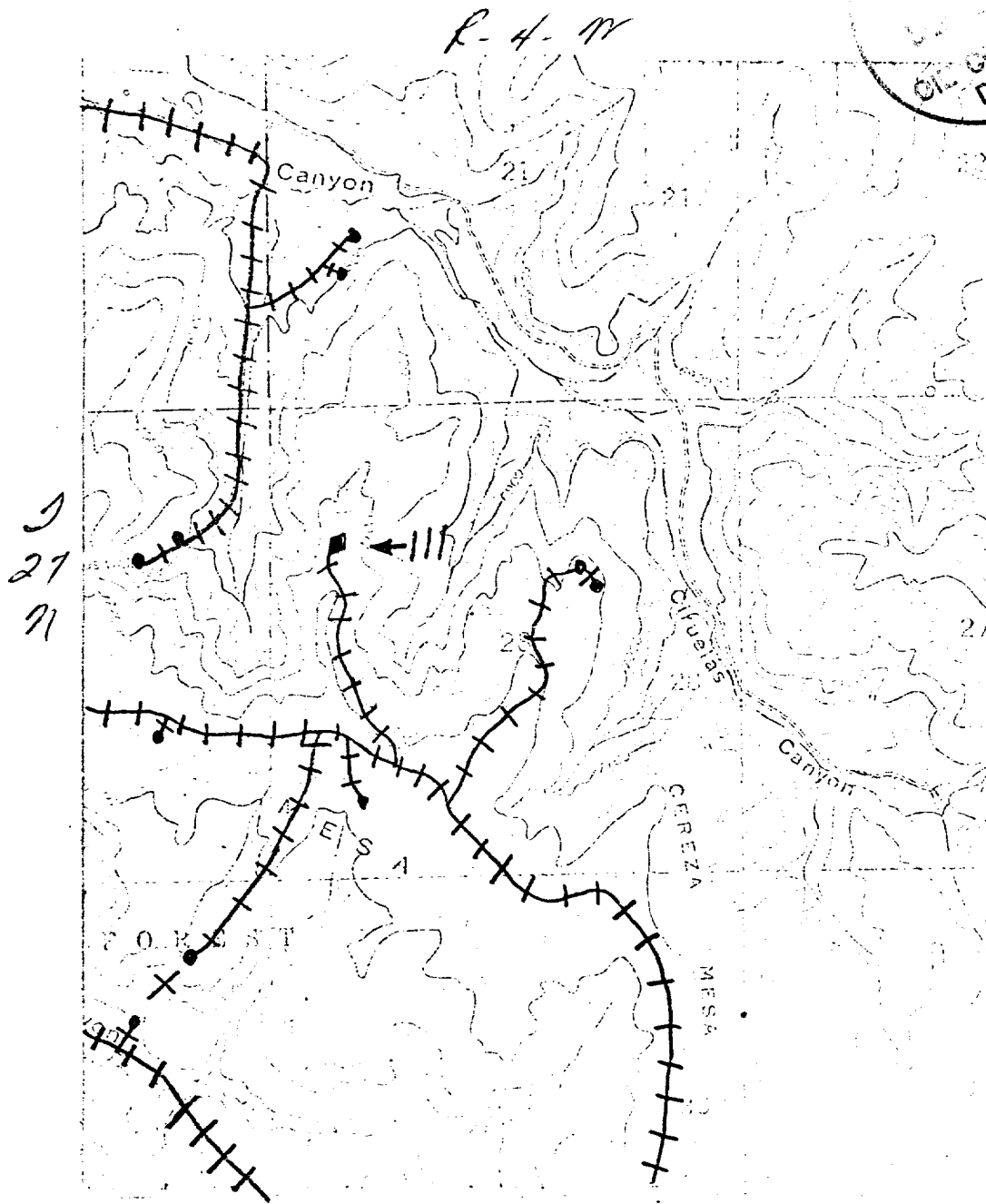

LEGEND OF RIGHT-OF-WAYS

EXISTING ROADS	—
EXISTING PIPELINES	- - - - -
EXISTING ROAD & PIPELINE	- . - . -
PROPOSED ROADS	—
PROPOSED PIPELINES	+ + + + +
PROPOSED ROAD & PIPELINE	+ + + + +