

UNITED STATES
DEPARTMENT OF THE INTERIOR
GEOLOGICAL SURVEY

30-039-21077

APPLICATION FOR PERMIT TO DRILL, DEEPEN, OR PLUG BACK

1a. TYPE OF WORK DRILL <input checked="" type="checkbox"/> DEEPEN <input type="checkbox"/> PLUG BACK <input type="checkbox"/>		5. LEASE DESIGNATION AND SERIAL NO. SF 080673	
b. TYPE OF WELL OIL WELL <input type="checkbox"/> GAS WELL <input checked="" type="checkbox"/> OTHER <input type="checkbox"/>		6. IF INDIAN, ALLOTTEE OR TRIBE NAME	
2. NAME OF OPERATOR El Paso Natural Gas Company		7. UNIT AGREEMENT NAME San Juan 27-4 Unit	
3. ADDRESS OF OPERATOR PO Box 990, Farmington, NM 87401		8. FARM OR LEASE NAME San Juan 27-4 Unit	
4. LOCATION OF WELL (Report location clearly and in accordance with any State requirements.)* At surface 1550'N, 1717'E		9. WELL NO. 125	
14. DISTANCE IN MILES AND DIRECTION FROM NEAREST TOWN OR POST OFFICE*		10. FIELD AND POOL, OR WILDCAT Blanco Mesa Verde Undesignated Pic. Cliffs	
15. DISTANCE FROM PROPOSED* LOCATION TO NEAREST PROPERTY OR LEASE LINE, FT. (Also to nearest drlg. unit line, if any)		11. SECTION, TOWNSHIP, RANGE, AND SURVEY OR AREA Sec. 8, T-27-N, R-4-W NMPM	
16. NO. OF ACRES IN LEASE		12. COUNTY OR PARISH Rio Arriba	
17. NO. OF ACRES ASSIGNED TO THIS WELL 160 + 320.00		13. STATE NM	
18. DISTANCE FROM PROPOSED LOCATION* TO NEAREST WELL, DRILLING, COMPLETED, OR APPLIED FOR, ON THIS LEASE, FT.		19. PROPOSED DEPTH 6400'	
20. ROTARY OR CABLE TOOLS Rotary		21. ELEVATIONS (Show whether DF, RT, GR, etc.) 6968'GR	
22. APPROX. DATE WORK WILL START*		23. PROPOSED CASING AND CEMENTING PROGRAM	

SIZE OF HOLE	SIZE OF CASING	WEIGHT PER FOOT	SETTING DEPTH	QUANTITY OF CEMENT
13 3/8"	9 5/8"	32.3#	200'	224 cu.ft. to circulate
8 3/4"	7"	20.0#	4170'	203 cu.ft. to cover Ojo Alamo
6 1/4"	4 1/2"	10.5#	4020-6400'	389 cu.ft. to fill to intermediate casing

Selectively perforate and sandwater fracture the Mesa Verde and Pictured Cliffs formations and isolate production using a packer.

A double gate blow out preventer equipped with blind and pipe rams rated at 3000 psi working pressure and 6000 psi test will be used while drilling this well.

The E/2 of Section 8 is dedicated to this well.

IN ABOVE SPACE DESCRIBE PROPOSED PROGRAM: If proposal is to deepen or plug back, give data on present productive zone and proposed new productive zone. If proposal is to drill or deepen directionally, give pertinent data on subsurface locations and measured and true vertical depths. Give blowout preventer program, if any.

24. SIGNED Al. J. Suico TITLE Drilling Clerk DATE April 8, 1975
(This space for Federal or State office use)

PERMIT NO. _____ APPROVAL DATE _____

APPROVED BY SM TITLE _____ DATE _____

CONDITIONS OF APPROVAL, IF ANY:

*See Instructions On Reverse Side

W MEXICO OIL CONSERVATION COMMISSION
WELL LOCATION AND ACREAGE DEDICATION PLAT

Form C-102
Supersedes C-128
Effective 1-1-65

All distances must be from the outer boundaries of the Section.

Operator EL PASO NATURAL GAS COMPANY			Lease SAN JUAN 27-4 UNIT (SF-080673)		Well No. 125
Unit Letter G	Section 8	Township 27-N	Range 4-W	County RIO ARriba	
Actual Footage Location of Well: 1550 feet from the NORTH line and 1717 feet from the EAST line					
Ground Level Elev. 6968	Producing Formation MESA VERDE PICTURED CLIFFS		Pool BLANCO MESA VERDE UNDESIGNATED PICTURED CLIFFS	Dedicated Acreage: 320.00 Acres	

1. Outline the acreage dedicated to the subject well by colored pencil or hatchure marks on the plat below.
2. If more than one lease is dedicated to the well, outline each and identify the ownership thereof (both as to working interest and royalty).
3. If more than one lease of different ownership is dedicated to the well, have the interests of all owners been consolidated by communitization, unitization, force-pooling, etc?

☒ Yes ☐ No If answer is "yes," type of consolidation unitization

If answer is "no," list the owners and tract descriptions which have actually been consolidated. (Use reverse side of this form if necessary.)

No allowable will be assigned to the well until all interests have been consolidated (by communitization, unitization, forced-pooling, or otherwise) or until a non-standard unit, eliminating such interests, has been approved by the Commission. **NOTE: THIS PLAT IS REISSUED TO SHOW NAME CHANGE FROM #95 TO #125.**

PRODUCING FORMATION
CHANGED FROM DAKOTA TO
PICTURED CLIFFS-MESA
VERDE.

SECTION 8

SF-080673

CERTIFICATION

I hereby certify that the information contained herein is true and complete to the best of my knowledge and belief.

Original
D. G. Brisco

Name
Drilling Clerk
Position
El Paso Natural Gas Co.
Company
April 8, 1975
Date

I hereby certify that the well location shown on this plat was plotted from field notes of actual surveys made by me or under my supervision, and that the same is true and correct to the best of my knowledge and belief.

Date Surveyed
OCTOBER 8, 1968

Registered Professional Engineer
and/or Land Surveyor

[Signature]
Certificate No. **1760**

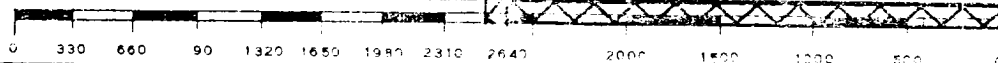

El Paso Natural Gas Company

El Paso, Texas 79978

April 8, 1975

ADDRESS REPLY TO
POST OFFICE BOX 990
FARMINGTON NEW MEXICO 87401

Mr. Jerry Long
U. S. Geological Survey
Post Office Box 1809
Durango, Colorado 81301

Re: Application for Permit to Drill
San Juan 27-4 Unit #125
SWNE/4 Section 8, T-27-N, R-4-W
Blanco Mesa Verde - ~~Undesignated~~ Pictured Cliffs
Tapacito

Dear Mr. Long:

AS #95
This location was originally approved for a Basin Dakota well. It is requested that it be changed to a dual completion in the Pictured Cliffs and Mesa Verde formations.

The location plat, right-of-way plat and other associated items will be the same as for the approved Dakota location. The pipe program and cement volumes will be changed as shown on the attached Form 9-331 C. The dedicated acreage will be as shown on the attached "Location and Acreage Dedication Plat".

If any other information is needed for you to approve this change, please notify me.

Yours truly,

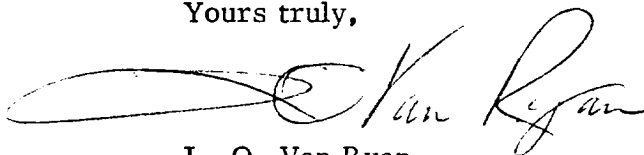

L. O. Van Ryan
Chief Division Drilling Engineer

LOVR:pb

atts.

