

30-039-21101

UNITED STATES  
DEPARTMENT OF THE INTERIOR  
GEOLOGICAL SURVEY

## APPLICATION FOR PERMIT TO DRILL, DEEPEN, OR PLUG BACK

1a. TYPE OF WORK DRILL <input checked="" type="checkbox"/> DEEPEN <input type="checkbox"/> PLUG BACK <input type="checkbox"/>		5. LEASE DESIGNATION AND SERIAL NO. NM 03733
b. TYPE OF WELL OIL WELL <input type="checkbox"/> GAS WELL <input checked="" type="checkbox"/> OTHER <input type="checkbox"/> SINGLE ZONE <input type="checkbox"/> MULTIPLE ZONE <input checked="" type="checkbox"/>		6. IF INDIAN, ALLOTTEE OR TRIBE NAME
2. NAME OF OPERATOR Caulkins Oil Company		7. UNIT AGREEMENT NAME
3. ADDRESS OF OPERATOR Post Office Box 780, Farmington, New Mexico		8. FARM OR LEASE NAME Breech
4. LOCATION OF WELL (Report location clearly and in accordance with any State requirements) At surface 1490 from the North 1520 from the west At proposed prod. zone Same		9. WELL NO. 352
14. DISTANCE IN MILES AND DIRECTION FROM NEAREST TOWN OR POST OFFICE* 32 miles southeast of Blanco, New Mexico		10. FIELD AND POOL, OR WILDCAT South Blanco-Otero Chac. ext
15. DISTANCE FROM PROPOSED* LOCATION TO NEAREST PROPERTY OR LEASE LINE, FT. (Also to nearest drlg. unit line, if any) 1122		11. SEC., T., R., M., OR BLK. AND SURVEY OR AREA Section 24 26N 7W
16. NO. OF ACRES IN LEASE 2400		12. COUNTY OR PARISH Rio Arriba
17. NO. OF ACRES ASSIGNED TO THIS WELL 160		13. STATE New Mexico
18. DISTANCE FROM PROPOSED LOCATION* TO NEAREST WELL, DRILLING, COMPLETED, OR APPLIED FOR, ON THIS LEASE, FT. 3010		19. PROPOSED DEPTH 3700
20. ROTARY OR CABLE TOOLS Rotary		21. ELEVATIONS (Show whether DF, RT, GR, etc.) 6516 Ground
22. APPROX. DATE WORK WILL START* June 18, 1975		

23. PROPOSED CASING AND CEMENTING PROGRAM				
SIZE OF HOLE	SIZE OF CASING	WEIGHT PER FOOT	SETTING DEPTH	QUANTITY OF CEMENT
12 3/4	8 5/8	24	120	Sufficient to circulate
7 7/8	4 1/2	10.5	3700	Approx. 400 sacks.

It is proposed to drill well to approx. 3700'. 4 1/2" casing will be run to TD and cemented with sufficient cement to cover Alamo Sand. After cement sets 120 hrs or more, casing will be perforated opposite Chacra Sand and then sand water fraced with approx. 50,000# sand. Bridge plug will be set above Chacra perforations and then Pictured Cliffs will be perforated and sand water fraced. Bridge plug will be drilled out then permanent type production packer will be set at approx. 3500'. 1 1/4" 2.4# IJ tubing will be run to production packer for Chacra production. 1" non EUE 10 rd thd tubing will be run to top of Pictured Cliffs pay.

A pressure operated double blowout preventor will be in use at all times while drilling below 120'.

IN ABOVE SPACE DESCRIBE PROPOSED PROGRAM: If proposal is to deepen or plug back, give data on present productive zone and proposed new productive zone. If proposal is to drill or deepen directionally, give pertinent data on subsurface locations and measured and true vertical depths. Give blowout preventer program, if any.

24. SIGNED Charles J. Jorgensen TITLE Superintendent DATE May 18, 1975  
(This space for Federal or State office use)

PERMIT NO. \_\_\_\_\_ APPROVAL DATE \_\_\_\_\_

APPROVED BY 21 TITLE \_\_\_\_\_ DATE \_\_\_\_\_  
CONDITIONS OF APPROVAL, IF ANY: \_\_\_\_\_

CAULKINS OIL COMPANY  
Post Office Box 780  
Farmington, New Mexico

May 19, 1975

United States Dept. of the Interior  
Geological Survey  
Post Office Box 1809  
Durango, Colorado 81301

Gentlemen:

Following is our 12 point development plan for surface use on our well number 352, located in NW 1/4 of Section 24 26N 6W, Rio Arriba County, New Mexico. COM. 3

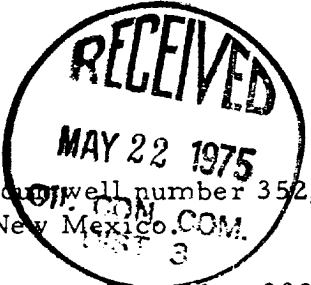
- 
- (1) Existing road now being used to service Caulkins Oil Company well number 382 will be used.
  - (2) Approx 2200' of new road will be required for this location. See topo map attached.
  - (3) (4) See topo map attached.
  - (5) (8) (9) No tank batteries, airstrip or camp.
  - (6) Water will be hauled from Caulkins Oil Company water hole located at bridge in Largo Canyon.
  - (7) All cuttings, trash, garbage and etc. will be confined to reserve pit shown on attached layout plat.
  - (10) Surface vegetation is sage brush and Native Grama. Some Cedar trees will be cleared for road.
  - (11) Reserve pit will be cleaned up and leveled, then complete location area will be reseeded with BLM approved seed mixture.
  - (12) Location will be on gentle hillside. Approx. 6' cut on high side of location will be required.

Yours very truly,

*Charles E. Verquer*  
CAULKINS OIL COMPANY

NEW MEXICO COMMISSION  
WELL LOCATION AND ACREAGE DEDICATION PLAT

Form C-126  
Supersedes C-126  
Effective 1-1-65

All distances must be from the outer boundaries of the Section.

Operator <b>Caulkins Oil Co.</b>			Lease <b>NM 03733</b>		Well No. <b>352</b>
Unit Letter <b>F</b>	Section <b>24</b>	Township <b>26 North</b>	Range <b>7 West</b>	County <b>Rio Arriba</b>	
Actual Footage Location of Well: <b>1490</b> feet from the <b>North</b> line and <b>1520</b> feet from the <b>West</b> line					
Ground Level Elev. <b>6516</b>	Producing Formation <b>Pictured Cliffs-Chacra</b>		Pool <b>South Blanco - Otero Chacra</b>		Dedicated Acreage <b>EXT 160</b> Acres

1. Outline the acreage dedicated to the subject well by colored pencil or hatchure marks on the plat below.
2. If more than one lease is dedicated to the well, outline each and identify the ownership thereof (both as to working interest and royalty).
3. If more than one lease of different ownership is dedicated to the well, have the interests of all owners been consolidated by communitization, unitization, force-pooling, etc?

☐ Yes ☐ No If answer is "yes," type of consolidation \_\_\_\_\_

If answer is "no," list the owners and tract descriptions which have actually been consolidated. (Use reverse side of this form if necessary.) \_\_\_\_\_

No allowable will be assigned to the well until all interests have been consolidated (by communitization, unitization, forced-pooling, or otherwise) or until a non-standard unit, eliminating such interests, has been approved by the Commission.

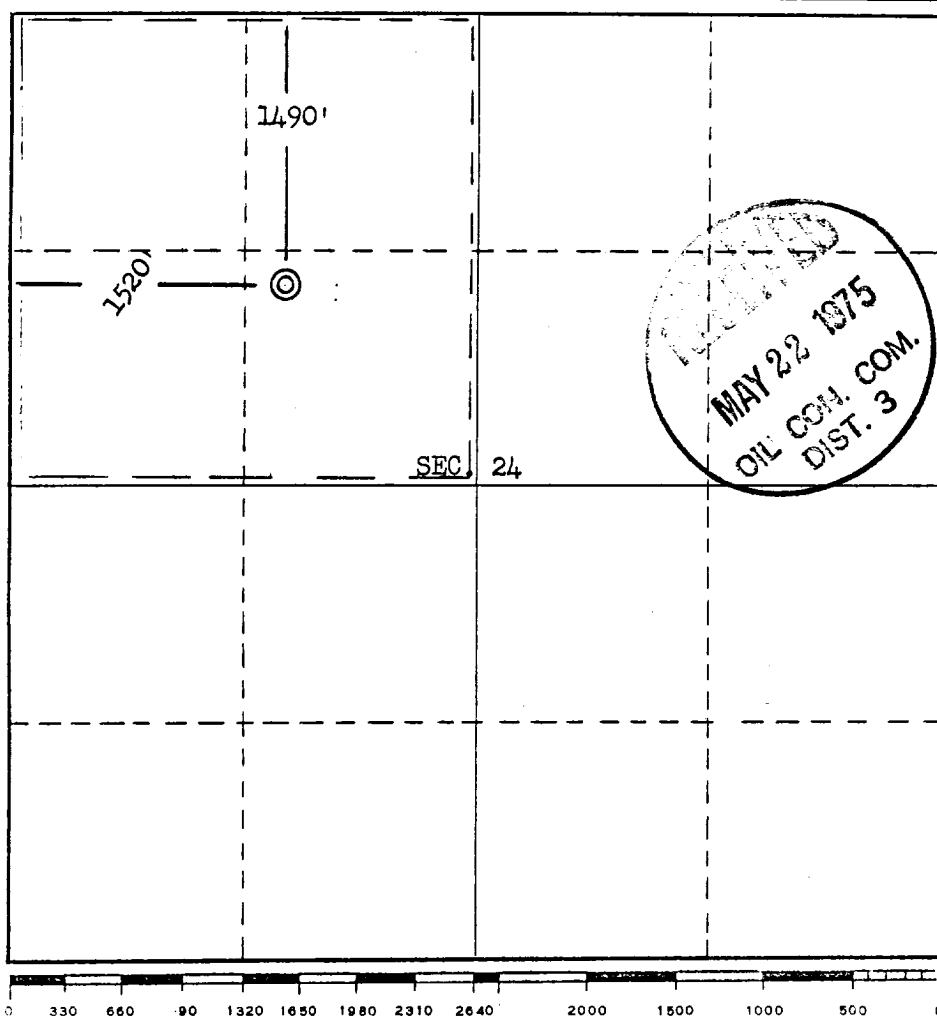

CERTIFICATION

I hereby certify that the information contained herein is true and complete to the best of my knowledge and belief.

Name Charles E. Vergues  
Position **Superintendent**

Company **Caulkins Oil Company**

Date **May 16, 1975**

REGISTERED LAND SURVEYOR  
I certify that the well location shown on this plat was plotted from field notes of actual surveys made by me or under my supervision, and that the same are true and correct to the best of my knowledge and belief.  
Reg. No. **3602**  
NEW MEXICO  
ERNEST V. ECHOHAWK

Date Surveyed **May 12, 1975**  
Registered Professional Engineer and/or Land Surveyor

E. V. Echohawk  
Certificate No. **3602**  
**E.V. Echohawk LS**

This is a detailed topographic map of a region in New Mexico, featuring the Pecos River and surrounding terrain. The map includes contour lines, a grid, and labels for 'Mesa', 'CANYON', 'LARGO', and 'INDIAN RESERVATION'. A prominent road or path is marked with a thick line, and various landmarks like 'BM 6172' are noted. The map is oriented with North at the top. The Pecos River flows from the upper left towards the center. To the right of the river, there is a large area labeled 'INDIAN RESERVATION'. The map shows a complex network of roads, trails, and boundaries. Contour lines indicate elevation, with labels such as 6000, 6200, and 6400. A grid system is overlaid on the map, with letters and numbers marking specific locations. The word 'CANYON' is written vertically in several places, and 'LARGO' is written horizontally. 'Mesa' is labeled in the upper left. 'INDIAN RESERVATION' is written in large letters at the bottom. A thick line, possibly a road or path, runs from the upper left towards the center. Various landmarks and points of interest are marked with dots and labels, including 'BM 6172' and 'BM 6173'. The map is a black and white line drawing, typical of a topographic map.

NORTH

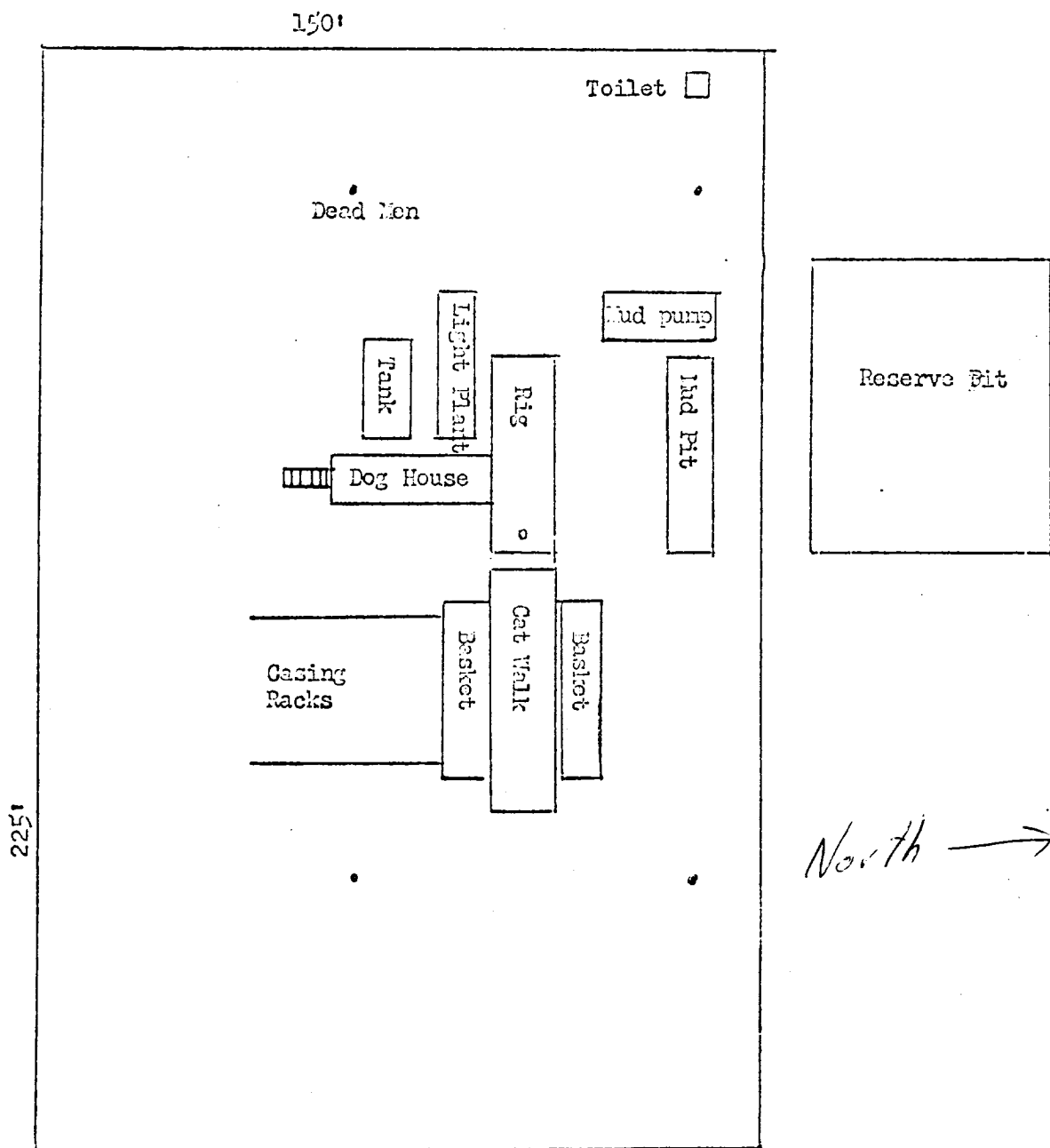

Scale - 33 1/3 feet per inch

Well Number 352

Located in NW 1/4 Section 24 26N 7W