

UNITED STATES
DEPARTMENT OF THE INTERIOR
GEOLOGICAL SURVEY

API 30-039-21212

5. LEASE DESIGNATION AND SERIAL NO.
NM 03547

6. IF INDIAN, ALLOTTEE OR TRIBAL NAME

7. UNIT AGREEMENT NAME

8. FARM OR LEASE NAME
Breech F

9. WELL NO.
504

10. FIELD AND POOL, OR WILDCAT
South Blanco - PC

11. SEC., T., R., M., OR BLM.
AND SURVEY OR AREA
Section 33 27N 6W

12. COUNTY OR PARISH
Rio Arriba

13. STATE
New Mex.

APPLICATION FOR PERMIT TO DRILL, DEEPEN, OR PLUG BACK

1a. TYPE OF WORK
DRILL ☒ DEEPEN ☐ PLUG BACK ☐b. TYPE OF WELL
OIL WELL ☐ GAS WELL ☒ OTHER ☐
SINGLE ZONE ☒ MULTIPLE ZONE ☐

2. NAME OF OPERATOR

Caulkins Oil Company

3. ADDRESS OF OPERATOR

Post Office Box 780, Farmington, New Mexico

4. LOCATION OF WELL (Report location clearly and in accordance with any State requirements.)

At surface
930' from the North and 970' from the EastAt proposed prod. zone
Same

14. DISTANCE IN MILES AND DIRECTION FROM NEAREST TOWN OR POST OFFICE*

35 miles South East of Blanco, New Mexico

16. DISTANCE FROM PROPOSED*

LOCATION TO NEAREST
PROPERTY OR LEASE LINE, FT.
(Also to nearest drig. unit line, if any)

930

16. NO. OF ACRES IN LEASE

1600

17. NO. OF ACRES ASSIGNED
TO THIS WELL

160

18. DISTANCE FROM PROPOSED LOCATION*
TO NEAREST WELL, DRILLING, COMPLETED,
OR APPLIED FOR, ON THIS LEASE, FT.

100'

19. PROPOSED DEPTH

3325

20. ROTARY OR CABLE TOOLS

Rotary

21. ELEVATIONS (Show whether DF, RT, GR, etc.)

6687 Ground

22. APPROX. DATE WORK WILL START*

May 1, 1976

23.

PROPOSED CASING AND CEMENTING PROGRAM

SIZE OF HOLE	SIZE OF CASING	WEIGHT PER FOOT	SETTING DEPTH	QUANTITY OF CEMENT
12 3/4	8 5/8	24	100	Sufficient to circulate
6 3/4	2 7/8	6.5	3325	Approx. 400 sacks.

It is proposed to drill well to approx. 3325'. 2 7/8" casing will be run to TD and cemented with sufficient cement to cover Alamo Sand. After cement sets 120 hrs. or more, 2 7/8" will be perforated opposite Pictured Cliffs Sand and Then Sand Water Fraced.

1" Non EUE 10 rd thd. tubing will be run to top of Pictured Cliffs Perforations.

A pressure operated blowout preventor will be in use at all times while drilling below 100'.

IN ABOVE SPACE DESCRIBE PROPOSED PROGRAM: If proposal is to deepen or plug back, give data on present productive zone and proposed new productive zone. If proposal is to drill or deepen directionally, give pertinent data on subsurface locations and measured and true vertical depths. Give blowout preventer program, if any.

24.

SIGNED

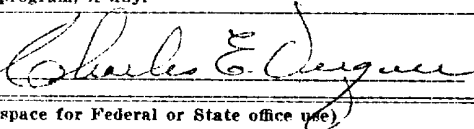

TITLE Superintendent

DATE April 2, 1976

(This space for Federal or State office use)

PERMIT NO.

APPROVAL DATE

APPROVED BY

TITLE

DATE

CONDITIONS OF APPROVAL, IF ANY:



APR 2 1976

*See Instructions On Reverse Side

NEW MEXICO OIL CONSERVATION COMMISSION
WELL LOCATION AND ACREAGE DEDICATION PLAT

Form O-102
Supersedes O-108
Effective 1-1-65

All distances must be from the outer boundaries of the Section.

Operator Caulkins Oil Company			Lease NM 03547 <i>Breed</i>		Well No. 504
Tract Letter A	Section 33	Township 27 North	Range 6 West	County Rio Arriba	
Actual Footage Location of Well:					
930 feet from the North line and		970 feet from the East line			
Ground Level Elev. 6687	Producing Formation Pictured Cliffs	Pool South Blanco	Dedicated Acreage: 160		Acres

1. Outline the acreage dedicated to the subject well by colored pencil or hachure marks on the plat below.
2. If more than one lease is dedicated to the well, outline each and identify the ownership thereof (both as to working interest and royalty).
3. If more than one lease of different ownership is dedicated to the well, have the interests of all owners been consolidated by communitization, unitization, force-pooling, etc?

☐ Yes ☐ No If answer is "yes," type of consolidation _____

If answer is "no," list the owners and tract descriptions which have actually been consolidated. (Use reverse side of this form if necessary.) _____

No allowable will be assigned to the well until all interests have been consolidated (by communitization, unitization, forced-pooling, or otherwise) or until a non-standard unit, eliminating such interests, has been approved by the Commission.

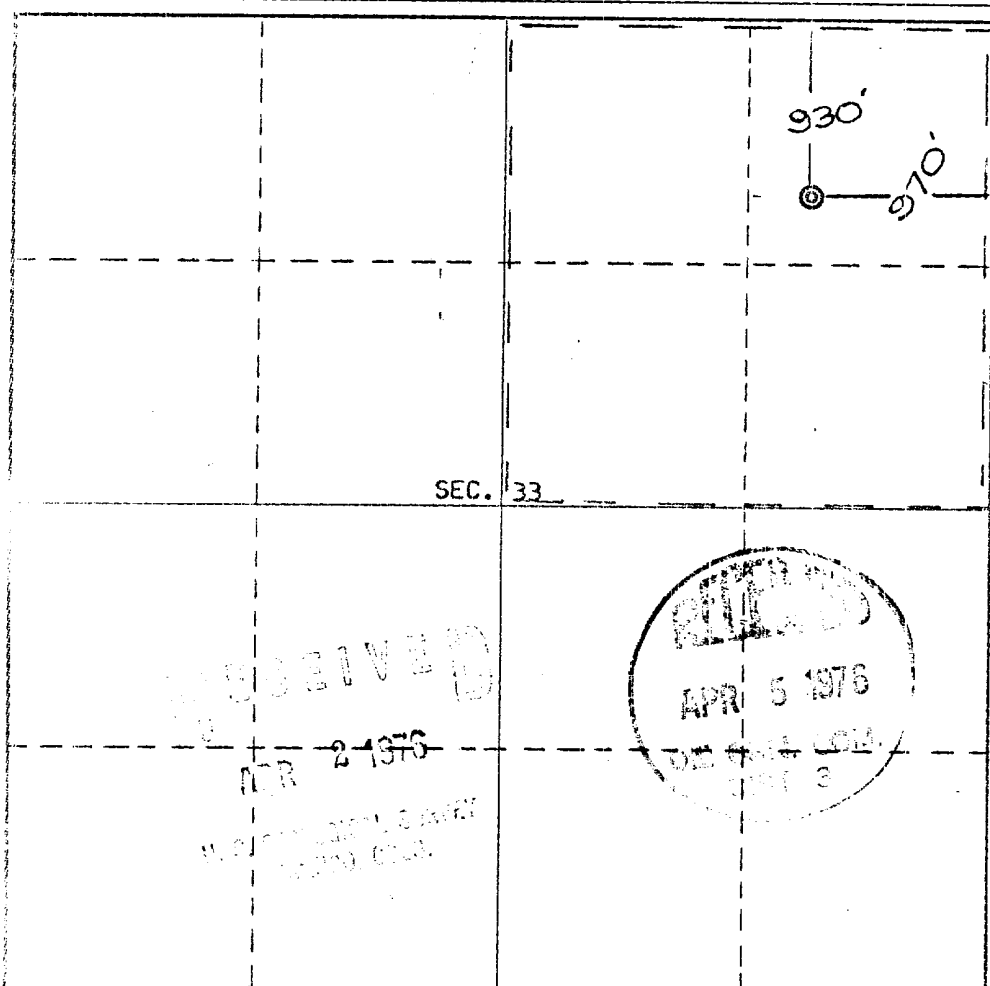

CERTIFICATION

I hereby certify that the information contained herein is true and complete to the best of my knowledge and belief.

Name *Charles E. Echowark*
Position
Superintendent

Company
Caulkins Oil Company

Date
April 2, 1976

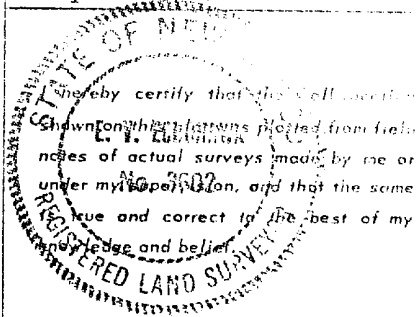

Date Surveyed
March 23, 1976

Registered Professional Engineer
and/or Land Surveyor

E. V. Echowark
Certificate No. **3602**
E. V. Echowark L.S.

240 560 90 1320 1650 1980 2310 2640 2000 1500 1000 500 0

CAULKINS OIL COMPANY
Post Office Box 780
Farmington, New Mexico

April 2, 1976

United States Dept. of the Interior
Geological Survey
Post Office Box 1809
Durango, Colorado 81301

Gentlemen:

Following is our 12 point development plan for surface use on our well No 504, located in NE 1/4 of section 33 27N 6W.

- (1) Existing road to Well No. 4 in Section 33 27N 6W will be used.
- (2) (5) 8 (9) No new roads, tanks, airstrip or camp.
- (3) (4) See Topo Map.
- (6) Water will be hauled from Caulkins Water hole in section 3 26N 6W.
- (7) All cuttings, trash, garbage and etc. will be confined to reserve pit.
- (10) Layout plat for location and pit attached.
- (11) Reserve pit will be leveled and cleaned up then complete area reseeded.
- (12) This well to be drilled on existing Dakota-Mesa Verde Well location. Pit will be built on area distrubed when first well drilled.

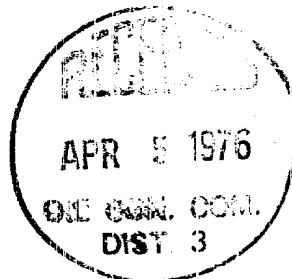

Yours very truly,

Charles E. Dargatzis
Caulkins Oil Company

APR 2 1976

UNITED STATES GEOLOGICAL SURVEY
DURANGO, COLORADO

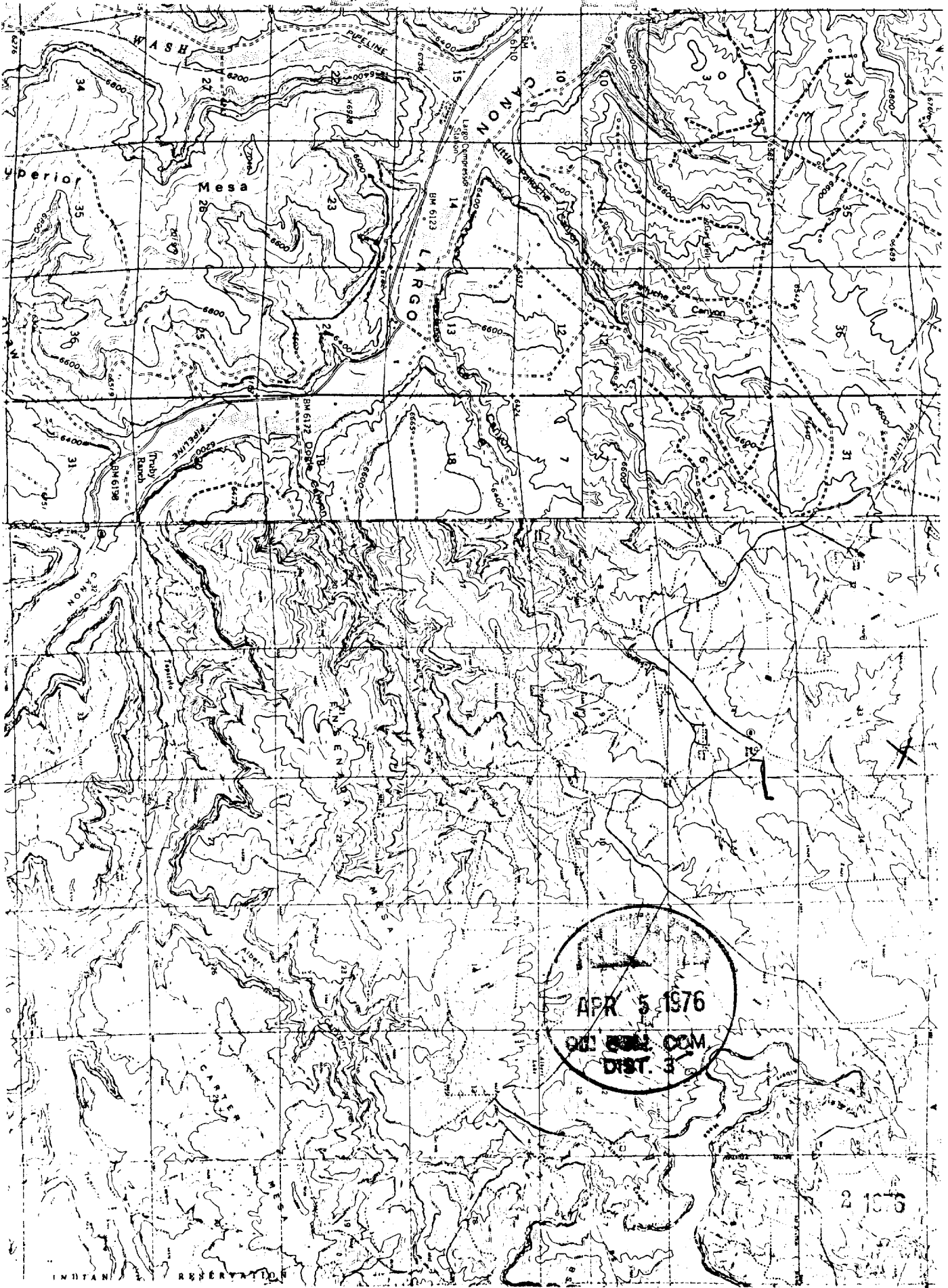

150'

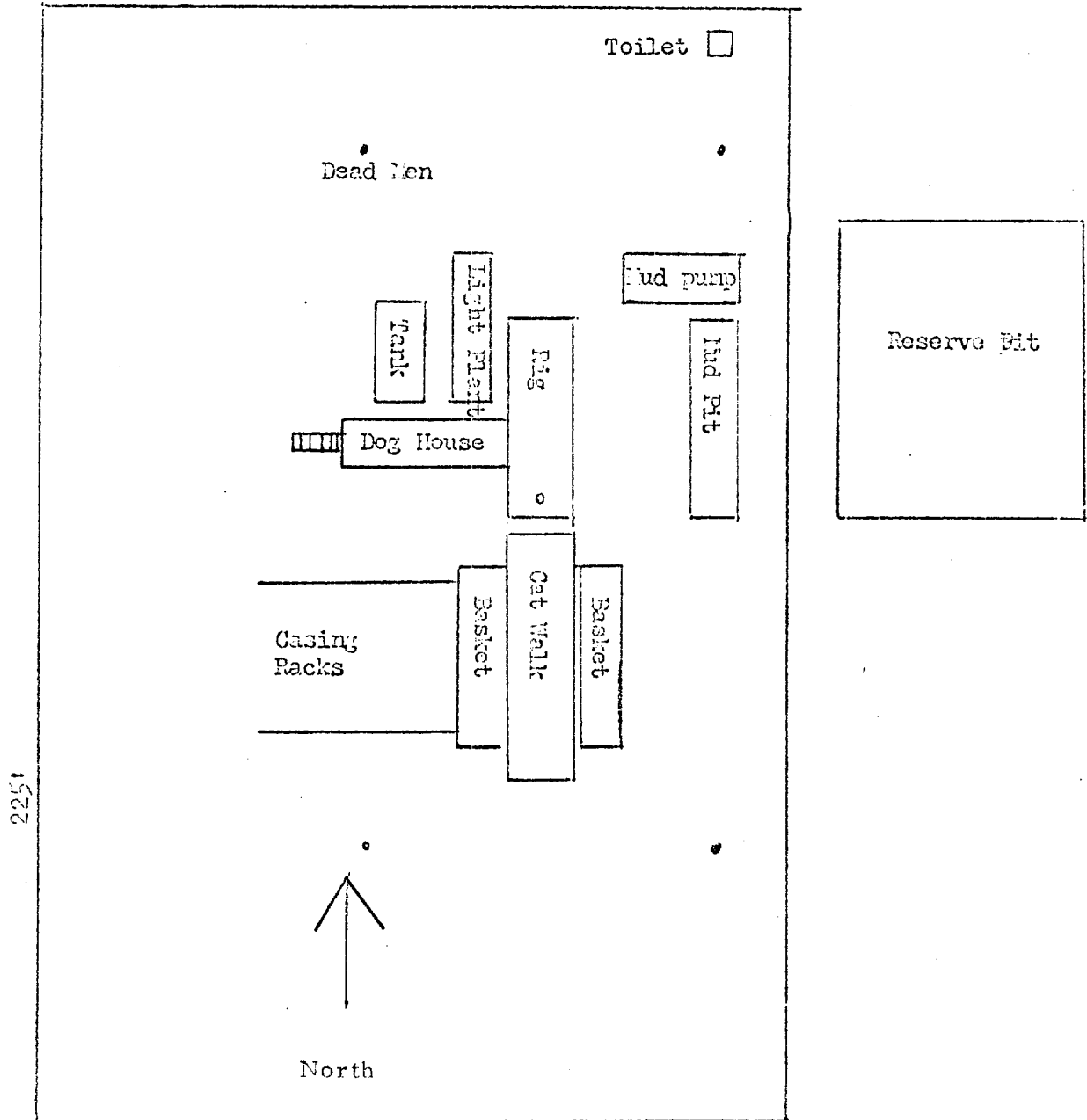

Scale - 33 1/3 feet per inch

Well Number 504

Located NE 1/4 Section 33 27N 6W

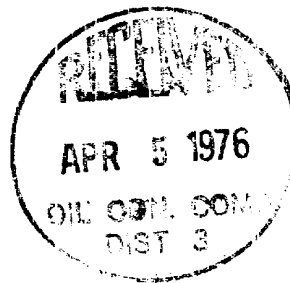

APR 2 1976
H. J. ...
...