

District I  
P.O. Box 1880, Hobbs, NM

District II  
P.O. Drawer DD, Artesia, NM 88221

District III  
1000 Rio Brazos Rd, Aztec, NM 87410

State of New Mexico  
Energy, Minerals and Natural Resources Department

SUBMIT 1 COPY TO  
APPROPRIATE  
DISTRICT OFFICE  
AND 1 COPY TO  
SANTA FE OFFICE

OIL CONSERVATION DIVISION

2040 South Pacheco Street  
Santa Fe, New Mexico 87505

JUN 23 1998

PIT REMEDIATION AND CLOSURE REPORT

Operator: PNM Gas Services (Caulkins) Telephone: 324-3764

Address: 603 W. Elm Street Farmington, NM 87401

Facility or Well Name: Breech F #44

Location: Unit M Sec 34 T 27N R 6W County Rio Arriba

Pit Type: Separator ☒ Dehydrator ☐ Other

Land Type: BLM ☒ State ☐ Fee ☐ Other

Pit Location: Pit dimensions: length 20 width 20 depth 3

(Attach diagram) Reference: wellhead ☒ other

Footage from reference: 40'

Direction from reference: 85 Degrees ☒ East North ☐  
of ☐ West South ☒

Depth to Ground Water:

(Vertical distance from contaminants to  
seasonal high water elevation of ground  
water)

Less than 50 feet (20 points)  
50 feet to 95 feet (10 points)  
Greater than 100 feet (0 points) 0

Wellhead Protection Area:

(Less than 200 feet from a private  
domestic water source, or, less than 1,000  
feet from all other water sources)

Yes (20 points)  
No (0 points) 0

Distance to Surface Water:

(Horizontal distance to perennial lakes,  
ponds, rivers, streams, creeks, irrigation  
canals and ditches)

Less than 200 feet (20 points)  
200 feet to 1,000 feet (10 points)  
Greater than 1,000 feet (0 points) 0

RANKING SCORE (TOTAL POINTS): 0

Breach F #44

Date Remediation Started: 9/15/97

Date Completed: 9/15/97

Remediation Method: Excavation ☒

Approx. Cubic Yard 148

(Check all appropriate sections)

Landfarmed ☒

Amount Landfarmed (cubic yds) 148

Other \_\_\_\_\_

Remediation Location: Onsite ☒

Offsite \_\_\_\_\_

(i.e., landfarmed onsite, name and location of offsite facility)

Backfill Material Location: \_\_\_\_\_

## General Description of Remedial Action:

Excavated contaminated soil to pit size id 20' X 20' X 10' and landfarmed soil onsite within a bermed area at a depth of 6" to 12". Soil was aerated by plowing until soil met regulatory levels.

Ground Water Encountered:

No ☒Yes ☐

Depth \_\_\_\_\_

## Final Pit Closure Sampling:

Sample Location 5 pt composite-4 s de walls and center of pit bottom

(if multiple samples, attach sample result and diagram of sample locations and depths.)

Sample depth 7' walls and 10' bottom.

Sample date 9/15/97

Sample time 2:00:00 PM

## Sample Results

Benzene (ppm) &lt; 0.0010

Total BTEX (ppm) 0.0010

Field headspace (ppm) \_\_\_\_\_

TPH (ppm) &lt; 5.00

Method 8015A

Vertical Extent (ft) \_\_\_\_\_

Risk Assessment form attached

Yes ☐No ☐

Ground Water Sample:

Yes ☐No ☒

(If yes, see attached Groundwater Site Summary Report)

I HEREBY CERTIFY THAT THE INFORMATION ABOVE IS TRUE AND COMPLETE TO THE BEST OF MY KNOWLEDGE AND MY BELIEF

DATE January 27, 1998

SIGNATURE



PRINTED NAME AND TITLE

Denver Bearden  
Administrator III

Breech F#44

9/15/97

Caulkins O:1

Sec. 34, 27N, 6W, m

start of excavation:

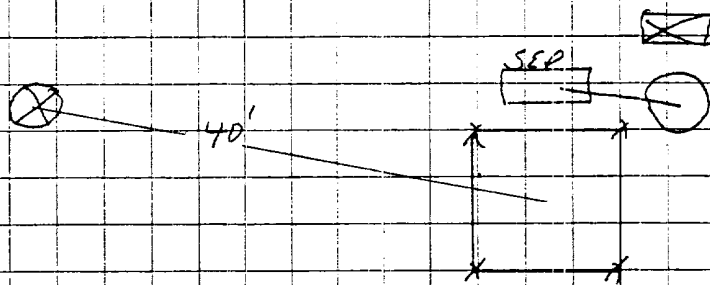

End of excavation:

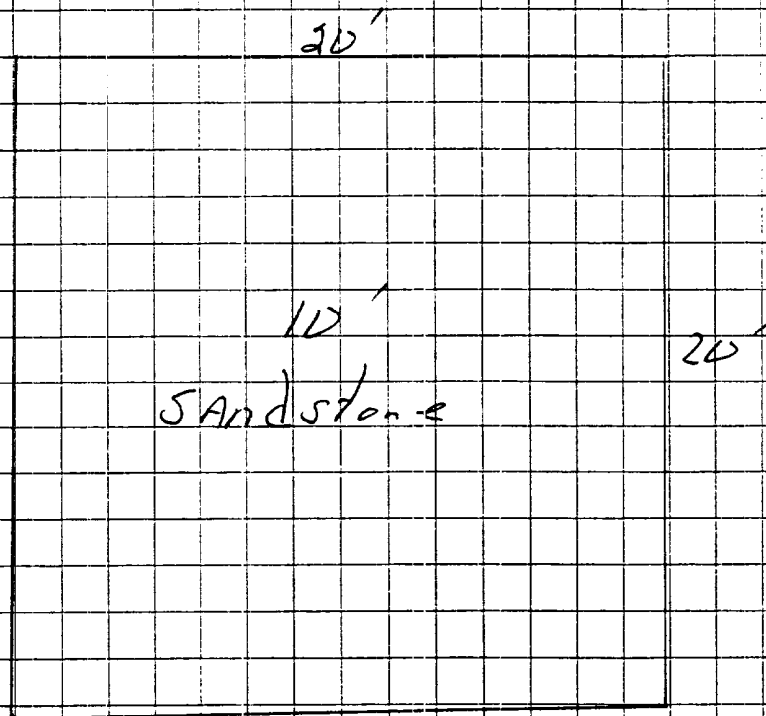

OFF: (505) 325-5667



LAB: (505) 325-1556

### ANALYTICAL REPORT

Attn: *Denver Bearden*  
Company: *PNM Gas Services*  
Address: *603 W. Elm*  
City, State: *Farmington, NM 87401*

Date: *24-Sep-97*  
COC No.: *5690*  
Sample No.: *16194*  
Job No.: *2-1000*

Project Name: *PNM Gas Services - Breech F #44*  
Project Location: *9709151400; Composite, Walls @ 7' and Bottom @ 10'*  
Sampled by: *GC* Date: *15-Sep-97* Time: *14:00*  
Analyzed by: *DC/HR* Date: *22-Sep-97*  
Sample Matrix: *Soil*

#### Laboratory Analysis

Parameter	Results as Received	Unit of Measure	Limit of Quantitation	Unit of Measure
<i>Diesel Range Organics (C10 - C28)</i>	ND	mg/kg	5	mg/kg

ND - Not Detected at Limit of Quantitation

#### Quality Assurance Report

DRO QC No.: 0555-STD

#### Continuing Calibration Verification

Parameter	Method Blank	Unit of Measure	True Value	Analyzed Value	RPD	RPD Limit
<i>Diesel Range (C10 - C28)</i>	ND	ppm	200	184	8.5	15%

#### Matrix Spike

Parameter	1- Percent Recovered	2 - Percent Recovered	Limit	RPD	RPD Limit
<i>Diesel Range (C10-C28)</i>	88	87	(70-130)	1	20%

Method - *SW-846 EPA Method 8015A mod. - Nonhalogenated Volatile Hydrocarbons by Gas Chromatography*

Approved by: *[Signature]*  
Date: *9/24/97*

P.O. BOX 2606 • FARMINGTON, NM 87499

- TECHNOLOGY BLENDING INDUSTRY WITH THE ENVIRONMENT -

OFF: (505) 325-5667



LAB: (505) 325-1556

## ANALYTICAL REPORT

Attn: *Denver Bearden*  
Company: *PNM Gas Services*  
Address: *603 W. Elm*  
City, State: *Farmington, NM 87401*

Date: *29-Sep-97*  
COC No.: *5690*  
Sample No.: *16194*  
Job No.: *2-1000*

Project Name: *PNM Gas Services - Breech F #44*  
Project Location: *9709151400; Composite, Walls @ 7' and Bottom @ 10'*  
Sampled by: *GC* Date: *15-Sep-97* Time: *14:00*  
Analyzed by: *DC* Date: *19-Sep-97*  
Sample Matrix: *Soil*

### Laboratory Analysis

Parameter	Results as Received	Unit of Measure	Limit of Quantitation	Unit of Measure
<i>Benzene</i>	ND	ug/kg	1	ug/kg
<i>Toluene</i>	ND	ug/kg	1	ug/kg
<i>Ethylbenzene</i>	ND	ug/kg	1	ug/kg
<i>m,p-Xylene</i>	1	ug/kg	1	ug/kg
<i>o-Xylene</i>	ND	ug/kg	1	ug/kg
<i>TOTAL</i>	1	ug/kg		

ND - Not Detected at Limit of Quantitation

**Method** - SW-846 EPA Method 8020A Aromatic Volatile Organics by Gas Chromatography

Approved by: *[Signature]*  
Date: *9/29/97*

↑  
N

10-1-97 @ 0915  
Breech F #44  
Caulkins  
(P) 34-27N-6W  
Rio Arriba  
Sample # 9710010915  
Land farm field head space: 4.3 ppm

2'-12"

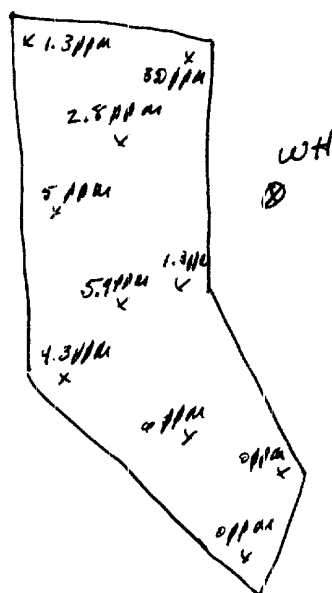

OFF: (505) 325-5667



LAB: (505) 325-1556

### ANALYTICAL REPORT

Attn: *Denver Bearden*  
Company: *PNM Gas Services*  
Address: *603 W. Elm*  
City, State: *Farmington, NM 87401*

Date: *6-Oct-97*  
COC No.: *5676*  
Sample No.: *16466*  
Job No.: *2-1000*

Project Name: *PNM Gas Services - Breach F #44*  
Project Location: *9710010915; Composite - Landfarm*  
Sampled by: *RH* Date: *1-Oct-97* Time: *9:15*  
Analyzed by: *DC/HR* Date: *2-Oct-97*  
Sample Matrix: *Soil*

#### Laboratory Analysis

Parameter	Results as Received	Unit of Measure	Limit of Quantitation	Unit of Measure
<i>Diesel Range Organics (C10 - C28)</i>	<i>27</i>	<i>mg/kg</i>	<i>5</i>	<i>mg/kg</i>

ND - Not Detected at Limit of Quantitation

#### Quality Assurance Report

DRO QC No.: 0555-STD

#### Continuing Calibration Verification

Parameter	Method Blank	Unit of Measure	True Value	Analyzed Value	RPD	RPD Limit
<i>Diesel Range (C10 - C28)</i>	<i>ND</i>	<i>ppm</i>	<i>200</i>	<i>188</i>	<i>6.4</i>	<i>15%</i>

#### Matrix Spike

Parameter	1- Percent Recovered	2 - Percent Recovered	Limit	RPD	RPD Limit
<i>Diesel Range (C10-C28)</i>	<i>91</i>	<i>89</i>	<i>(70-130)</i>	<i>2</i>	<i>20%</i>

Method - *SW-846 EPA Method 8015A mod. - Nonhalogenated Volatile Hydrocarbons by Gas Chromatography*

Approved by: *[Signature]*  
Date: *10/6/97*

P.O. BOX 2606 • FARMINGTON, NM 87499

- TECHNOLOGY BLENDING INDUSTRY WITH THE ENVIRONMENT -