

UNITED STATES  
DEPARTMENT OF THE INTERIOR  
GEOLOGICAL SURVEY

## APPLICATION FOR PERMIT TO DRILL, DEEPEN, OR PLUG BACK

## 1a. TYPE OF WORK

DRILL ☒DEEPEN ☐PLUG BACK ☐

## b. TYPE OF WELL

OIL  
WELL ☐GAS  
WELL ☒

OTHER

SINGLE  
ZONE ☐MULTIPLE  
ZONE ☐

## 2. NAME OF OPERATOR

Jerome P. McHugh

## 3. ADDRESS OF OPERATOR

Box 234, Farmington, NM 87401

## 4. LOCATION OF WELL (Report location clearly and in accordance with any State requirements.)

At surface

1640' FNL - 1000' FEL

At proposed prod. zone

## 14. DISTANCE IN MILES AND DIRECTION FROM NEAREST TOWN OR POST OFFICE\*

30 miles south of Dulce, NM

## 15. DISTANCE FROM PROPOSED\*

LOCATION TO NEAREST  
PROPERTY OR LEASE LINE, FT.  
(Also to nearest drig. unit line, if any)

1000'

## 16. NO. OF ACRES IN LEASE

## 17. NO. OF ACRES ASSIGNED

TO THIS WELL  
32018. DISTANCE FROM PROPOSED LOCATION\*  
TO NEAREST WELL, DRILLING, COMPLETED,  
OR APPLIED FOR, ON THIS LEASE, FT.Approx  
1 1/2 mile

## 19. PROPOSED DEPTH

6200'

## 20. ROTARY OR CABLE TOOLS

Rotary

## 21. ELEVATIONS (Show whether DF, RT, GR, etc.)

7184' GR

## 22. APPROX. DATE WORK WILL START\*

5-15-77

## 23.

## PROPOSED CASING AND CEMENTING PROGRAM

SIZE OF HOLE	SIZE OF CASING	WEIGHT PER FOOT	SETTING DEPTH	QUANTITY OF CEMENT
12-1/4"	8-5/8"	32.30#	200'	200 sx
7-7/8"	4-1/2"	10.5#	6200'	1000 sx (2 stages)

Plan to drill well with mud thru Mesaverde formation, set 4-1/2" casing and cement to surface in two stages, selectively perforate and frac Mesaverde formation, clean out after frac, run 1-1/4" tubing and complete well.

Will use hydraulic blowout preventer furnished by rig while drilling, Shaffer double-gate manual BOP while completing, and 600 series screwed API wellhead.

NMERB Requirement: Gas not dedicated at this time.

IN ABOVE SPACE DESCRIBE PROPOSED PROGRAM: If proposal is to deepen or plug back, give data on present productive zone and proposed new productive zone. If proposal is to drill or deepen directionally, give pertinent data on subsurface locations and measured and true vertical depths. Give blowout preventer program, if any.

## 24.

SIGNED

Thomas A. Dugan

TITLE

Petroleum Engineer

DATE

4-18-77

(This space for Federal or State office use)

PERMIT NO.

APPROVAL DATE

APPROVED BY

TITLE

DATE

CONDITIONS OF APPROVAL, IF ANY:

ekal

APR 18 1977

\*See Instructions On Reverse Side

**NEW MEXICO OIL CONSERVATION COMMISSION  
WELL LOCATION AND ACREAGE DEDICATION PLAT**

Form C-102  
Supersedes C-128  
Effective 1-1-65

All distances must be from the outer boundaries of the Section.

Operator <b>Jerome P. McHugh</b>			Lease <b>Chris</b>		Well No. <b>3</b>
Unit Letter <b>H</b>	Section <b>21</b>	Township <b>27 North</b>	Range <b>3 West</b>	County <b>Rio Arriba</b>	
Actual Footage Location of Well: <b>1640.</b> feet from the <b>North</b> line and <b>1000</b> feet from the <b>East</b> line					
Ground Level Elev. <b>7184</b>	Producing Formation <b>Mesaverde</b>		Pool <b>Blanco</b>		Dedicated Acreage: <b>320</b> Acres

1. Outline the acreage dedicated to the subject well by colored pencil or hachure marks on the plat below.
2. If more than one lease is dedicated to the well, outline each and identify the ownership thereof (both as to working interest and royalty).
3. If more than one lease of different ownership is dedicated to the well, have the interests of all owners been consolidated by communitization, unitization, force-pooling, etc?

☐ Yes   ☐ No   If answer is "yes," type of consolidation \_\_\_\_\_

If answer is "no," list the owners and tract descriptions which have actually been consolidated. (Use reverse side of this form if necessary.) \_\_\_\_\_

No allowable will be assigned to the well until all interests have been consolidated (by communitization, unitization, forced-pooling, or otherwise) or until a non-standard unit, eliminating such interests, has been approved by the Commission.

**CERTIFICATION**

I hereby certify that the information contained herein is true and complete to the best of my knowledge and belief.

Name  
**Thomas A. Dugan**  
Position  
**Petroleum Engineer**  
Company  
**Jerome P. McHugh**

Date  
**4-18-77**

I hereby certify that the well location shown on this plat was plotted from field notes of actual surveys made by me or under my supervision and that the same are true and correct to the best of my knowledge and belief.

Date Surveyed  
**April 5, 1977**

Registered Professional Engineer and/or Land Surveyor

*E.V. Echohawk*  
Certificate No. **3602**

**E.V. Echohawk LS**

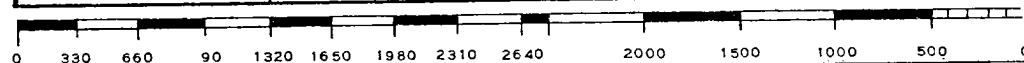
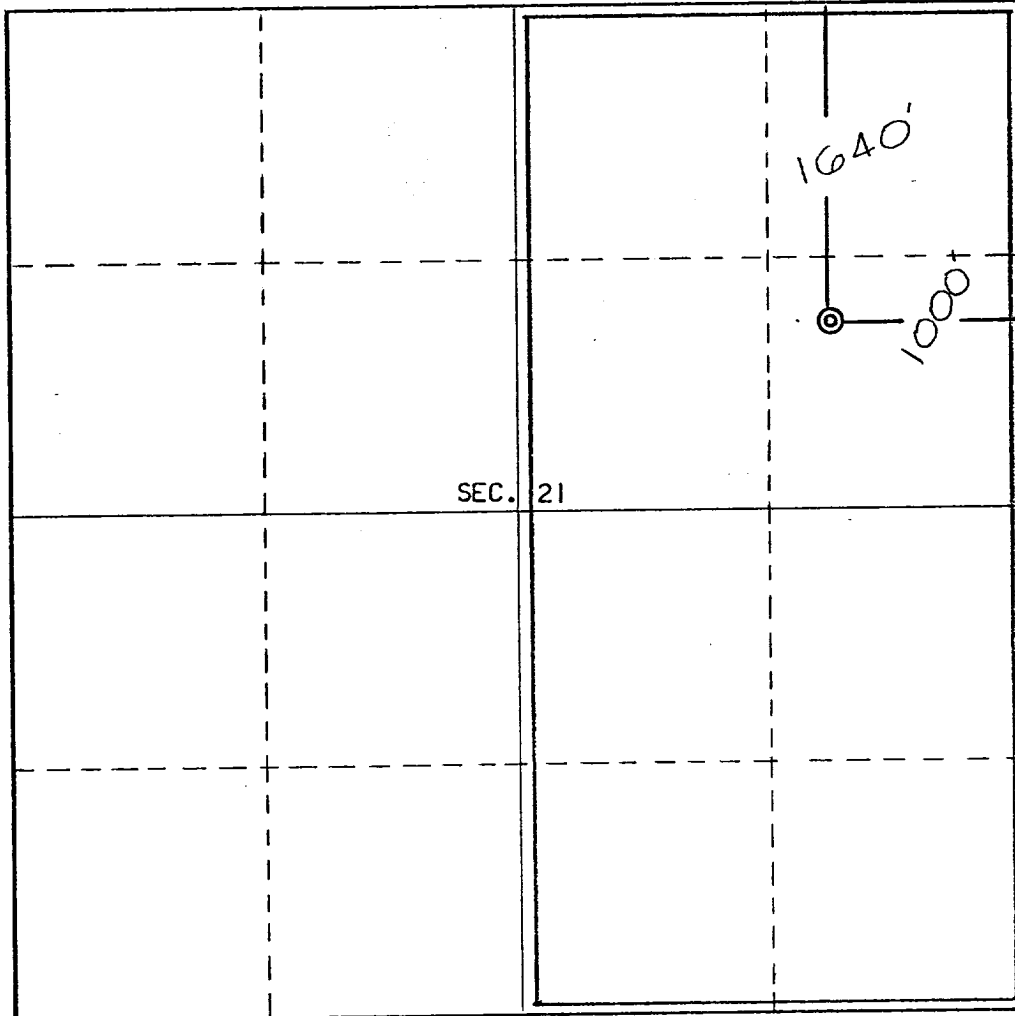

DEVELOPMENT PLAN

Jerome P. McHugh

Chris #3

1. Existing roads are shown on attached plat.
2. Planned access from existing road approximately 200' to new location. Will leave natural grass and small vegetation on roadway. Will remove large brush or trees from road. Do not plan to make road grade or bar ditches. Will bottom-out any arroyo we cross and not install culverts.
3. Location of well: 1640' FNL - 1000' FEL  
Section 21, T27N, R3W  
Rio Arriba County, New Mexico
4. One additional well(s) planned on this lease at this time.
5. Separator and flow line will be located within 50' of wellhead.
6. Water will be secured from Companero Arroyo or La Jara Wash.
7. Waste materials will be buried on location or in reserve pit.
8. No permanent camp is planned; trailer house will be used on location while drilling.
9. Do not plan to build airstrip.
10. See attached plat for proposed location layout.
11. Will clean up location, fill and level pits, level ruts in road, reseed location and road with Seed Mixture #2 and paint equipment with #34127.  
Pinon Juniper Green
12. Operator's Representative:  
Thomas A. Dugan  
Box 234  
Farmington, New Mexico 87401
13. Certification: The following statement must be signed by the lessee's or operator's field representative who is identified in Item #12 of the Plan:

I hereby certify that I, or persons under my direct supervision, have inspected the proposed drillsite and access route; that I am familiar with the conditions which presently exist; that the statements made in this Plan are, to the best of my knowledge, true and correct; and, that the work associated with the operations proposed herein will be performed by \_\_\_\_\_

Jerome P. McHugh

and its contractors and subcontractors in conformity with this Plan and the terms and conditions under which it is approved.

Date: 4-18-77

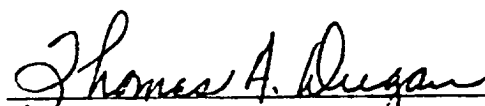
  
Thomas A. Dugan  
Professional Petroleum Engineer

Jerome P. McHugh

Chris #3

Proposed Location Layout

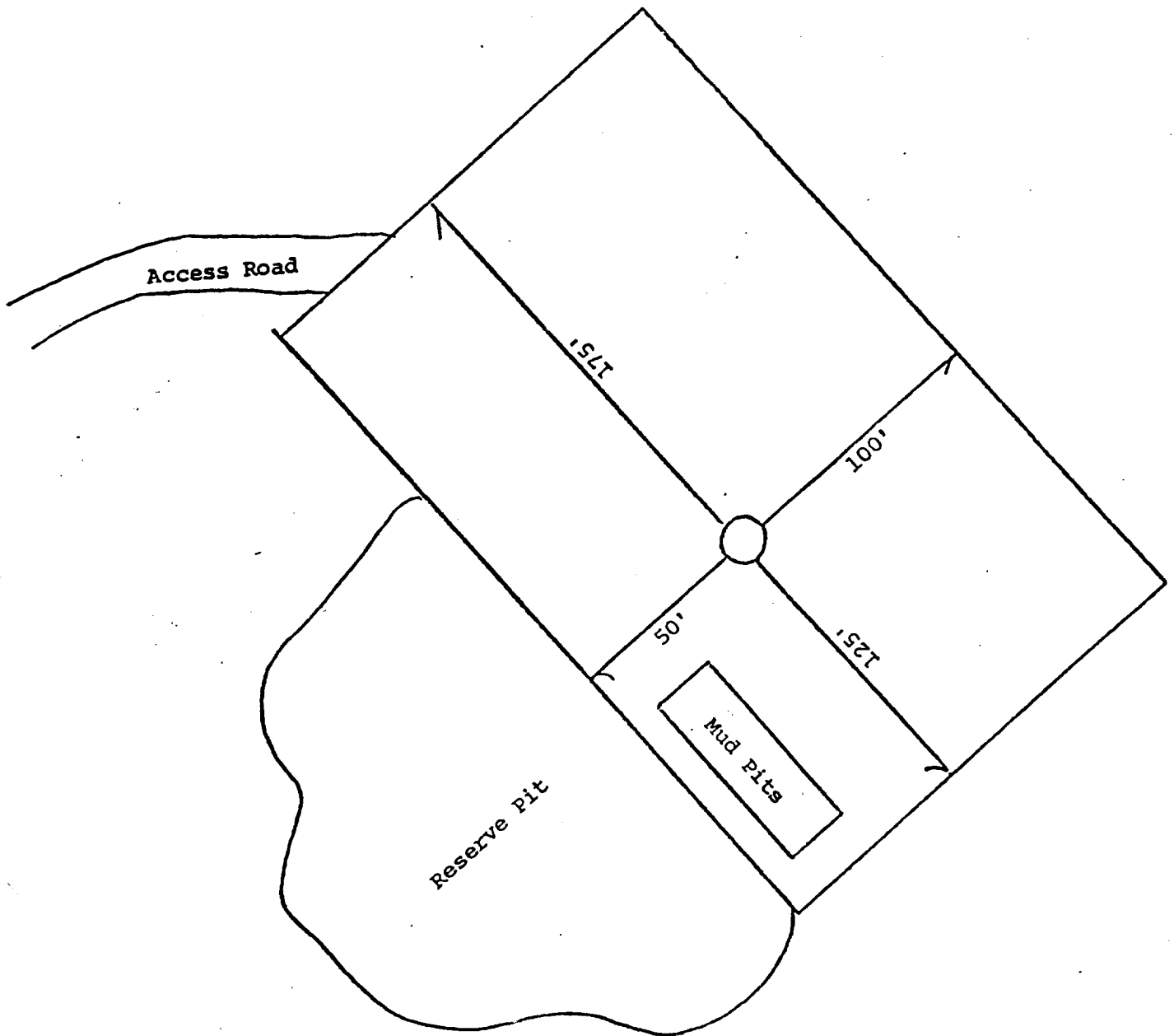

N  
↑

4053  
2 040 000  
FEET

15 MI. TO N. MEX. 17

T. 28 N.

T. 27 N.

4251

35.

4050

11

4349

4557 11 SE  
CLEAVRY CANYON

4037

T  
27  
N

