

UNITED STATES
DEPARTMENT OF THE INTERIOR
GEOLOGICAL SURVEY

APPLICATION FOR PERMIT TO DRILL, DEEPEN, OR PLUG BACK

1a. TYPE OF WORK

DRILL ☒DEEPEN ☐PLUG BACK ☐

b. TYPE OF WELL

OIL
WELL ☐GAS
WELL ☒

OTHER

SINGLE
ZONE ☐MULTIPLE
ZONE ☒

2. NAME OF OPERATOR

Southland Royalty Company

3. ADDRESS OF OPERATOR

P. O. Drawer 570, Farmington, New Mexico 87401

4. LOCATION OF WELL (Report location clearly and in accordance with any State requirements.*)

At surface

940' FSL & 1150' FWL

At proposed prod. zone

14. DISTANCE IN MILES AND DIRECTION FROM NEAREST TOWN OR POST OFFICE*

43 miles southwest of Dulce, New Mexico

10. DISTANCE FROM PROPOSED*

LOCATION TO NEAREST
PROPERTY OR LEASE LINE, FT.
(Also to nearest drlg. unit line, if any)

16. NO. OF ACRES IN LEASE

17. NO. OF ACRES ASSIGNED
TO THIS WELL

141.76 / 301.76

18. DISTANCE FROM PROPOSED LOCATION*
TO NEAREST WELL, DRILLING, COMPLETED,
OR APPLIED FOR, ON THIS LEASE, FT.

19. PROPOSED DEPTH

6473'

20. ROTARY OR CABLE TOOLS

Rotary

21. ELEVATIONS (Show whether DF, RT, GR, etc.)

7211' GR

22. APPROX. DATE WORK WILL START*

October 1, 1978

23.

PROPOSED CASING AND CEMENTING PROGRAM

SIZE OF HOLE	SIZE OF CASING	WEIGHT PER FOOT	SETTING DEPTH	QUANTITY OF CEMENT
12-1/4"	9-5/8"	32.30#	200'	130 cu. ft.
8-3/4"	7"	20.00#	3950'	253 cu. ft.
8-3/4"	7"	23.00#	3950'-4348'	
6-1/4"	4-1/2"	10.50#	4198'-6473'	370 cu. ft.
	1-1/2"	2.90#	4198'	
	2-3/8"	4.7#	6473'	

Surface formation is San Jose.

Top of Ojo Alamo sand is at 2625'.

Fresh water mud will be used to drill from surface to intermediate total depth.

An air system will be used to drill from intermediate depth to total depth.

It is anticipated an IES and GR-Density log be run at intermediate depth.

It is anticipated a GR-Induction and GR-Density log be run at total depth.

No poisonous gases or abnormal pressures are anticipated in this well.

It is expected that this well be drilled before November 1, 1978. This depends
on time required for approvals, rig availability and the weather.

Gas is not dedicated.

IN ABOVE SPACE DESCRIBE PROPOSED PROGRAM: If proposal is to deepen or plug back, give data on present productive zone and proposed new productive zone. If proposal is to drill or deepen directionally, give pertinent data on subsurface locations and measured and true vertical depths. Give blowout preventer program, if any.

24.

SIGNED

TITLE District Production Manager DATE August 9, 1978

(This space for Federal or State office use)

PERMIT NO.

APPROVAL DATE

APPROVED BY

TITLE

CONDITIONS OF APPROVAL, IF ANY:

or 3rd

RECEIVED

AUG 14 1978

NEW MEXICO OIL CONSERVATION COMMISSION
WELL LOCATION AND ACREAGE DEDICATION PLAT

Form O-102
Supersedes O-101
Effective 1-1-75

All distances must be from the outer boundaries of the Section.

Operator SOUTHLAND ROYALTY COMPANY		Lease Jicarilla 447		Well No. #1
Unit Letter N	Section 19	Township 27N	Range 3W	County Rio Arriba
Actual Footage Location of Well: 940 feet from the South line and 1150 feet from the West line				
Ground Level Elev. 7211	Producing Formation Pictured Cliffs-Mesaverde	Pool Tanque Mesa-Blanco	Dec. 147.76 Area: 301.76	

1. Outline the acreage dedicated to the subject well by colored pencil or hatchure marks on the plat below.
2. If more than one lease is dedicated to the well, outline each and identify the ownership thereof (both as to working interest and royalty).
3. If more than one lease of different ownership is dedicated to the well, have the interests of all owners been consolidated by communitization, unitization, force-pooling, etc?

☐ Yes ☐ No If answer is "yes," type of consolidation _____

If answer is "no," list the owners and tract descriptions which have actually been consolidated. (Use reverse side of this form if necessary.) _____

No allowable will be assigned to the well until all interests have been consolidated (by communitization, unitization, forced-pooling, or otherwise) or until a non-standard unit, eliminating such interests, has been approved by the Commission.

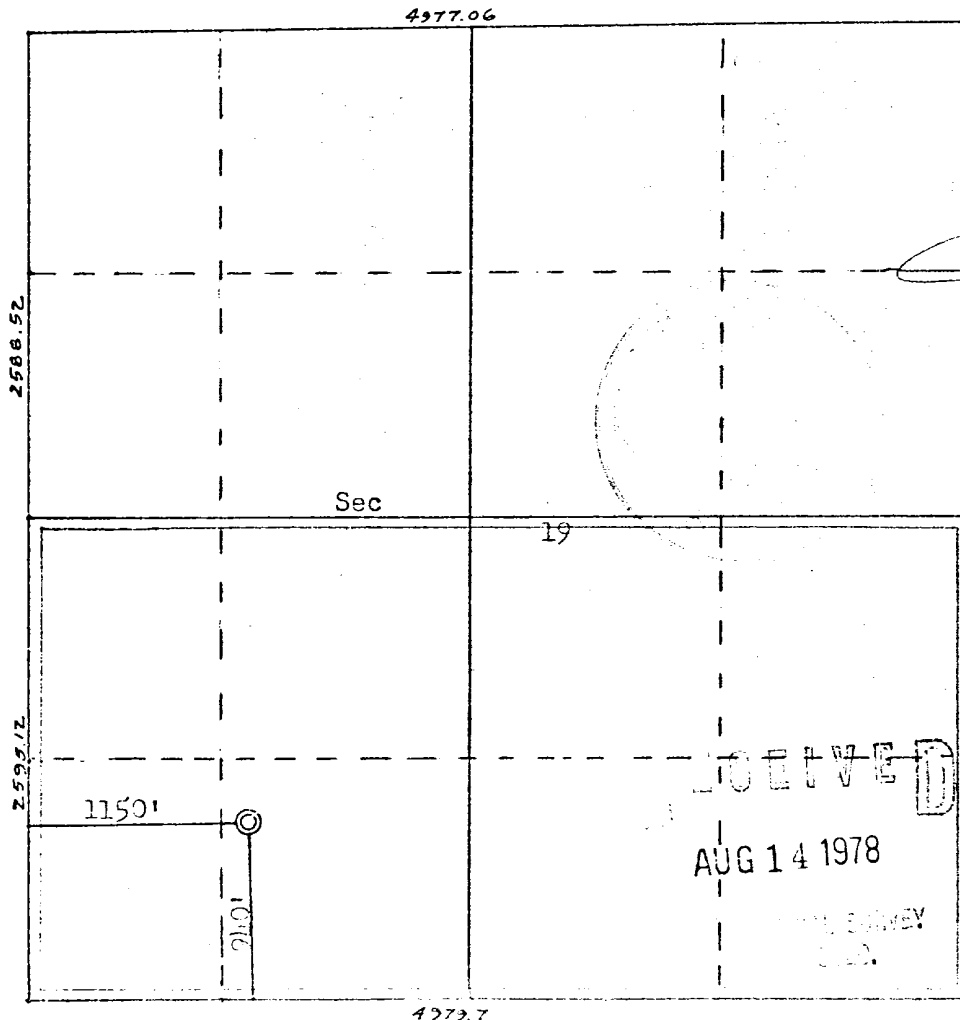

CERTIFICATION

I hereby certify that the information contained herein is true and complete to the best of my knowledge and belief.

Name: *[Signature]*
Position: **District Production Manager**
Company: **Southland Royalty Company**
Date: **August 9, 1978**

I hereby certify that the well location shown on this plat was plotted from field notes of actual surveys made by me or under my supervision, and that the same is true and correct to the best of my knowledge and belief.

Date Surveyed: **July 6, 1978**
Registered Professional Engineer and Land Surveyor: *[Signature]*
Certificate No.: **2050**

DRILLING SCHEDULE - JICARILLA 447 #1

Location: 940' FSL & 1150'FWL, Section 19, T27N, R3W, Rio Arriba, New Mexico

Field: Choza Mesa Pictured Cliffs/Blanco Mesa Verde Elevation: 7211' GL
7223' KB

Geology: Formation Tops: Ojo Alamo 2625' Cliff House 5873'
Pictured Cliffs 3948' Total Depth 6473'
Intermediate 4348'

Logging Program: IES & GR Density @ Intermediate.
GR Induction & GR Density @ Total Depth.

Coring Program: None

Natural Gauges: Gauge @ last connection above Cliff House & @ TD.
Also gauge any noticeable increases in gas. Record
all gauges in tour book & turn in on morning report.

Drilling: Contractor -
SRC Representative:

Tool Pusher:
SRC Ans. Svc. 325-1841
Dispatch No. 325-73917

Mud Program: Fresh water mud to Intermediate.
Air from Intermediate to TD.

AUG 14 1978

Materials: Casing Program:

Hole Size	Depth	Casing Size	Wt. & Grade
12 1/4"	200'	9 5/8"	32.30# H-40
8 3/4"	3950'	7"	20.00# K-55
	3950'-4348'	7"	23.00 K-55
6 1/4"	4198'-6473'	4 1/2"	10.5# K-55

Float Equipment: 9 5/8" surface casing - Pathfinder type "A" guide shoe.

7" intermediate casing - Pathfinder type "A" guide shoe. Howco self-fill insert float valve. Five Pathfinder rigid centralizers. Run float 2 joints above shoe. Run centralizers every other joint above shoe.

4 1/2" liner - Pathfinder type "AP" guide shoe. Prod. #2017-1-050. Pathfinder type "AP" flapper float collar. Prod. #2008-2-000.

Wellhead Equipment: Rector 9 5/8" X 10", 600# casing head.
10", 600# X 6", 600# tubing head with dual hanger
for 2 3/8" X 1 1/2".

Drilling Schedule - Jicarilla 447 #1
Page 2

Cementing: 9 5/8" surface casing - 110 sx Cl "B" w/1/4# gel flake/sk & 3% CaCl₂ (130 cu.ft.). WOC - 12 hrs. Test to 600 psi prior to drilling out.

7" intermediate casing -145 sx 50/50 poz w/6% gel (7.2 gal water/sk), followed by 70 sx Cl "B" w/2% CaCl₂ (253 cu.ft.). If lost circulation is encountered during drilling, add 1/4 cu.ft. of fine gilsonite/sk. WOC - 12 hrs. Run temp survey after 8 hrs. Test to 1000 psi before drilling out.

4 1/2" liner - Precede cement with 20 bbls. gel water. Cement with 250 sx 50/50 poz w/6% gel & 0.6% Halad 9 (370 cu.ft.).

L. O. Van Ryan

CCP/kde

8-7-78



Southland Royalty Company

August 9, 1978

United States Geological Survey
P. O. Box 1809
Durango, Colorado

Attention: Blowout Preventer Plan

Dear Sir:

All drilling and completion rigs will be equipped with 6" or larger double gate hydraulic blowout preventers and a hydraulic operated closing unit with steel lines.

The preventer is 3000# working pressure and 6000# test.

All crews will be thoroughly trained in the operation of this preventer. The preventer will be tested frequently enough to insure proper operation.

Yours truly,

L. O. Van Ryan
District Production Manager

LOVR/dg

RECEIVED

AUG 14 1978

WILLIS DAWNEY
SPEECH

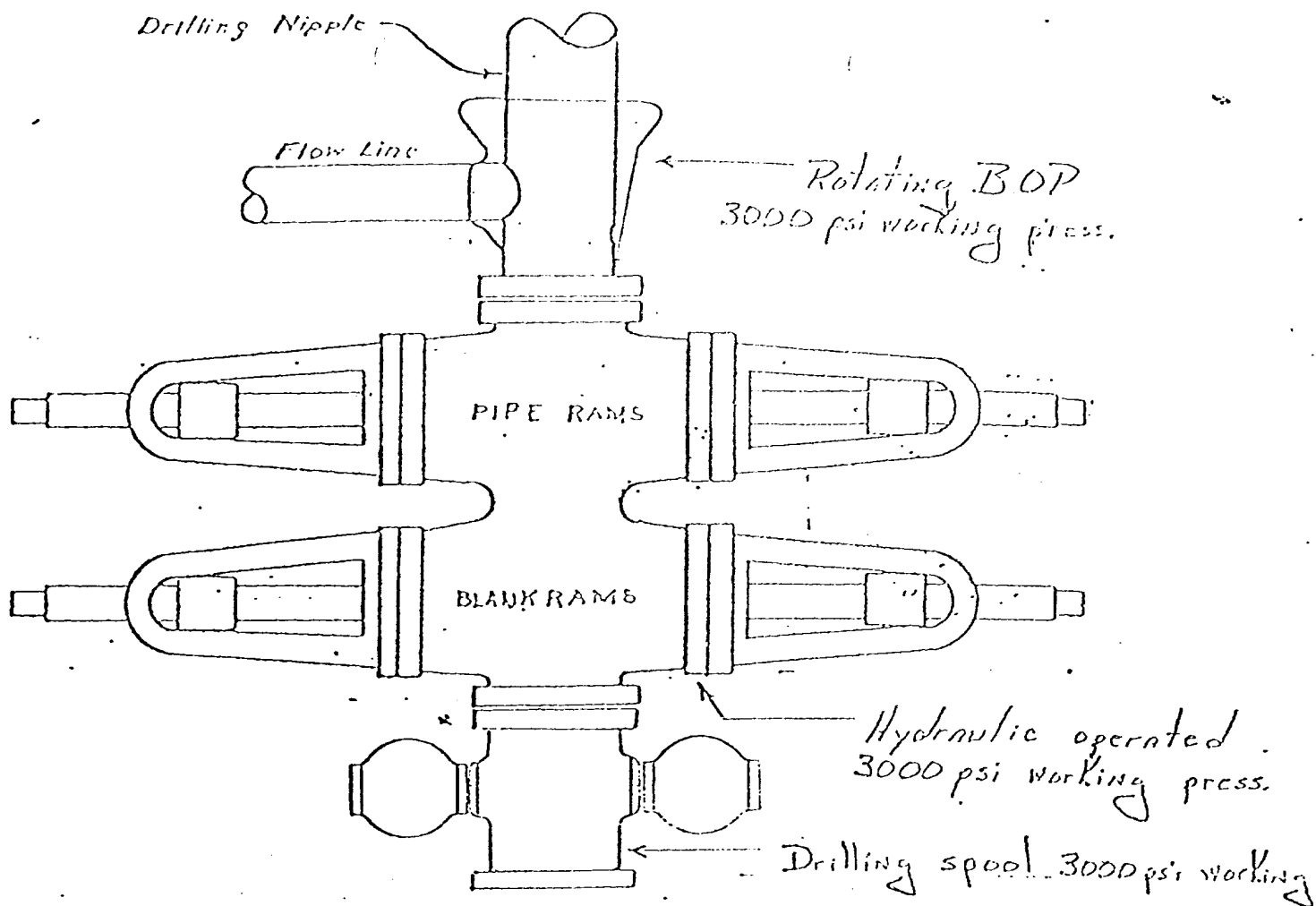

Preventers and spools are to have
through bore of 6" - 3000# PSI or larger.

RECEIVED

AUG 14 1978

U.S. DEPT. OF ENERGY
WASHINGTON, D.C.



Southland Royalty Company

August 9, 1978

United States Geological Survey
P. O. Box 1809
Durango, Colorado

Attention: Mr. Jerry Long

Dear Sir:

Enclosed please find map showing existing roads and planned access roads to Southland Royalty Company's Jicarilla 447 #1 well. The location of tank batteries and flow lines will be on location with well. A burn pit will be provided for disposal of trash. Cuttings, drilling fluid and produced fluids will be put into the reserve pit and properly disposed of depending on amount and type of fluids.

Contractor will furnish restroom facilities on location.

There will be no air strips or camps.

Also, enclosed is a location layout showing approximate location of rig, pits, pipe racks and cut required to build this location.

Water supply will be water holes along La Jara Wash. All water will be transported by truck and stored on location.

The location will be restored according to Bureau of Indian Affairs standards. This work will begin when all related construction is finished.

Mr. Max Larson will be Southland Royalty Company's field representative supervising these operations.

Yours truly,

L. O. Van Ryan
District Production Manager

LOVR/dg

RECEIVED
AUG 14 1978



Southland Royalty Company

United States Geological Survey
P. O. Box 1809
Durango, Colorado

Attention: Mr. Jerry Long

Dear Sir:

I hereby certify that I, or persons under my direct supervision, have inspected the proposed drillsite and access route; that I am familiar with the conditions which presently exist; that the statements made in this plan are, to the best of my knowledge, true and correct; and, that the work associated with the operations proposed herein be performed by Southland Royalty Company and its contractors and subcontractors in conformity with this plan and the terms and conditions under which it is approved.

Date: August 9, 1978

Name: CC Parsons

Title: District Engineer

RECEIVED

AUG 14 1978

U.S. SURVEY
DIV.

17-22-3

Location Profile for

SOUTHLAND ROYALTY CO. #1 Jicarilla 447
940 FSL 1150' FWL Sec 19-T27N-R3W
Rio Arriba County, New Mexico

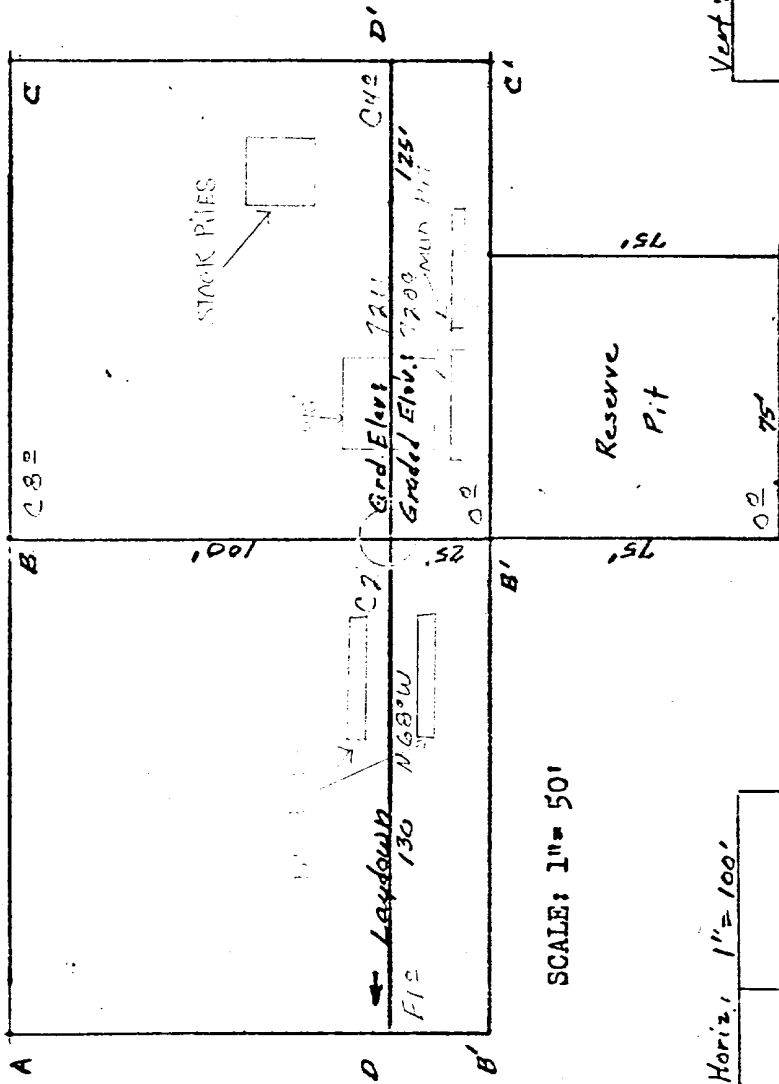

Vert: 1"=40' A-A' & Horiz: 1"=100'

B-B' &

7220					
7210					
7200					

Vert: 1"=40' C-C' & Horiz: 1"=100'

D-D' &

7220					
7210					
7200					

RECEIVED
AUG 14 1978
KERR



- EXISTING LOCATIONS
- * PROPOSED LOCATION
- EXISTING ROADS
- PROPOSED ROAD

Vicinity Map for
 SOUTHLAND ROYALTY CO. #1 Jicarilla 447
 940' FSL 1150' FWL Sec 19-T27N-R3W
 RIO ARriba COUNTY, NEW MEXICO



STATE OF NEW MEXICO
ENERGY AND MINERALS DEPARTMENT
OIL CONSERVATION DIVISION
AZTEC DISTRICT OFFICE

JERRY APODACA
GOVERNOR

NICK FRANKLIN
SECRETARY

August 30, 1978

1000 RIO BRAZOS ROAD
AZTEC, NEW MEXICO 87410
(505) 334-8178

NWU 3- 752

Southland Royalty Co.
P. O. Drawer 570
Farmington, NM

SUBJECT: NON-STANDARD GAS PRORATION UNIT CONSISTING OF 141.76
ACRES IN THE Tapacito Pictured Cliffs ext. GAS
POOL DESCRIBED AS FOLLOWS:

TOWNSHIP 27 NORTH, RANGE 3 WEST, NMPM

SECTION: 19 SW/4

By authority granted me by Rule 5(B) of Order R-1670, as amended, the above-described acreage has been approved as a non-standard gas proration unit to be dedicated to the Jicarilla 447
well no. 1, located 940/S; 1150/W of said
Section 19.

Al Kende
Supervisor, District #3

xc: Oil Conservation Commission
Santa Fe, New Mexico



STATE OF NEW MEXICO
ENERGY AND MINERALS DEPARTMENT
OIL CONSERVATION DIVISION
AZTEC DISTRICT OFFICE

JERRY APODACA
GOVERNOR

NICK FRANKLIN
SECRETARY

August 30, 1978

1000 RIO BRAZOS ROAD
AZTEC, NEW MEXICO 87410
(505) 334-8178

NWU 3- 753

Southland Royalty Co.
P. O. Drawer 570
Farmington, NM

SUBJECT: NON-STANDARD GAS PRORATION UNIT CONSISTING OF 301.76
ACRES IN THE Blanco Mesaverde GAS
POOL DESCRIBED AS FOLLOWS:

TOWNSHIP 27 NORTH, RANGE 3 WEST, NMPM

SECTION: 19 S/2

By authority granted me by Rule 5(B) of Order R-1670, as amended, the above-described acreage has been approved as a non-standard gas proration unit to be dedicated to the Jicarilla 447
well no. 1, located 940/S; 1150/W of said
Section 19.

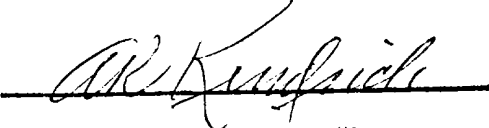
Supervisor, District #3

xc: Oil Conservation Commission
Santa Fe, New Mexico