

UNITED STATES
DEPARTMENT OF THE INTERIOR
GEOLOGICAL SURVEY30-639-21987
5. LEASE DESIGNATION AND SERIAL NO.
Joint Venture

APPLICATION FOR PERMIT TO DRILL, DEEPEN, OR PLUG BACK

1a. TYPE OF WORK
DRILL ☒ DEEPEN ☐ PLUG BACK ☐b. TYPE OF WELL
OIL WELL ☐ GAS WELL ☒ OTHER ☐ SINGLE ZONE ☐ MULTIPLE ZONE ☐2. NAME OF OPERATOR
Palmer Oil & Gas Company3. ADDRESS OF OPERATOR
P. O. Box 2564, Billings, Montana 591034. LOCATION OF WELL (Report location clearly and in accordance with any State requirements.)*
At surface NE $\frac{1}{4}$ SW $\frac{1}{4}$ 1450 FSL, 1450 FWL

K At proposed prod. zone same

14. DISTANCE IN MILES AND DIRECTION FROM NEAREST TOWN OR POST OFFICE*
Approx. 27 miles North of Ojito15. DISTANCE FROM PROPOSED*
LOCATION TO NEAREST
PROPERTY OR LEASE LINE, FT.
(Also to nearest drig. unit line, if any) 1450

16. NO. OF ACRES IN LEASE

Joint Venture

17. NO. OF ACRES ASSIGNED
TO THIS WELL

w/320

18. DISTANCE FROM PROPOSED LOCATION*
TO NEAREST WELL, DRILLING, COMPLETED,
OR APPLIED FOR, ON THIS LEASE, FT.

19. PROPOSED DEPTH

6350'

20. ROTARY OR CABLE TOOLS

Rotary

21. ELEVATIONS (Show whether DF, RT, GR, etc.)

7301' GR.

22. APPROX. DATE WORK WILL START*

February 1, 1979

23. PROPOSED CASING AND CEMENTING PROGRAM

SIZE OF HOLE	SIZE OF CASING	WEIGHT PER FOOT	SETTING DEPTH	QUANTITY OF CEMENT
12-1/4"	9-5/8" (new)	36#	300'	300 sacks
8-3/4"	7" (new)	20#	4050'	250 sacks
6-1/4"	4-1/2" (new)	10.5#	6350'	600 sacks

- Palmer Oil & Gas Company will drill a 6350' Mesaverde test in the NE $\frac{1}{4}$ SW $\frac{1}{4}$ of Section 16-T27N-R2W.
- Well to be drilled by rotary tools. Set 300' of 9-5/8" casing and cement to surface; drill 8-3/4" hole to 4050' and set 7" casing. Air drill 4,050' to T.D. and run 4 $\frac{1}{2}$ " casing.
- IES and Porosity Logs will be run at T.D. All potential zones will be analyzed from surface to total depth, and if potentially commercial, 4 $\frac{1}{2}$ " casing or liner will be set, cemented and perforated.
- After perforating, the productive zones will be fractured, if necessary.
- Survey plat attached.
- Spacing unit will be W $\frac{1}{2}$ of Section 16.
- Gas is not dedicated.

IN ABOVE SPACE DESCRIBE PROPOSED PROGRAM: If proposal is to deepen or plug back, give data on present productive zone and proposed new productive zone. If proposal is to drill or deepen directionally, give pertinent data on subsurface locations and measured and true vertical depths. Give blowout preventer program, if any.

24.

SIGNED

Robert D. Ballantyne
Robert D. Ballantyne

TITLE

Drilling Superintendent

DATE 12/20/78

PERMIT NO.

APPROVAL DATE

APPROVED BY

TITLE

DATE

CONDITIONS OF APPROVAL, IF ANY:

ok Frank

**NEW MEXICO OIL CONSERVATION COMMISSION
WELL LOCATION AND ACREAGE DEDICATION PLAT**

Form C-102
Supersedes C-128
Effective 1-1-65

All distances must be from the outer boundaries of the Section.

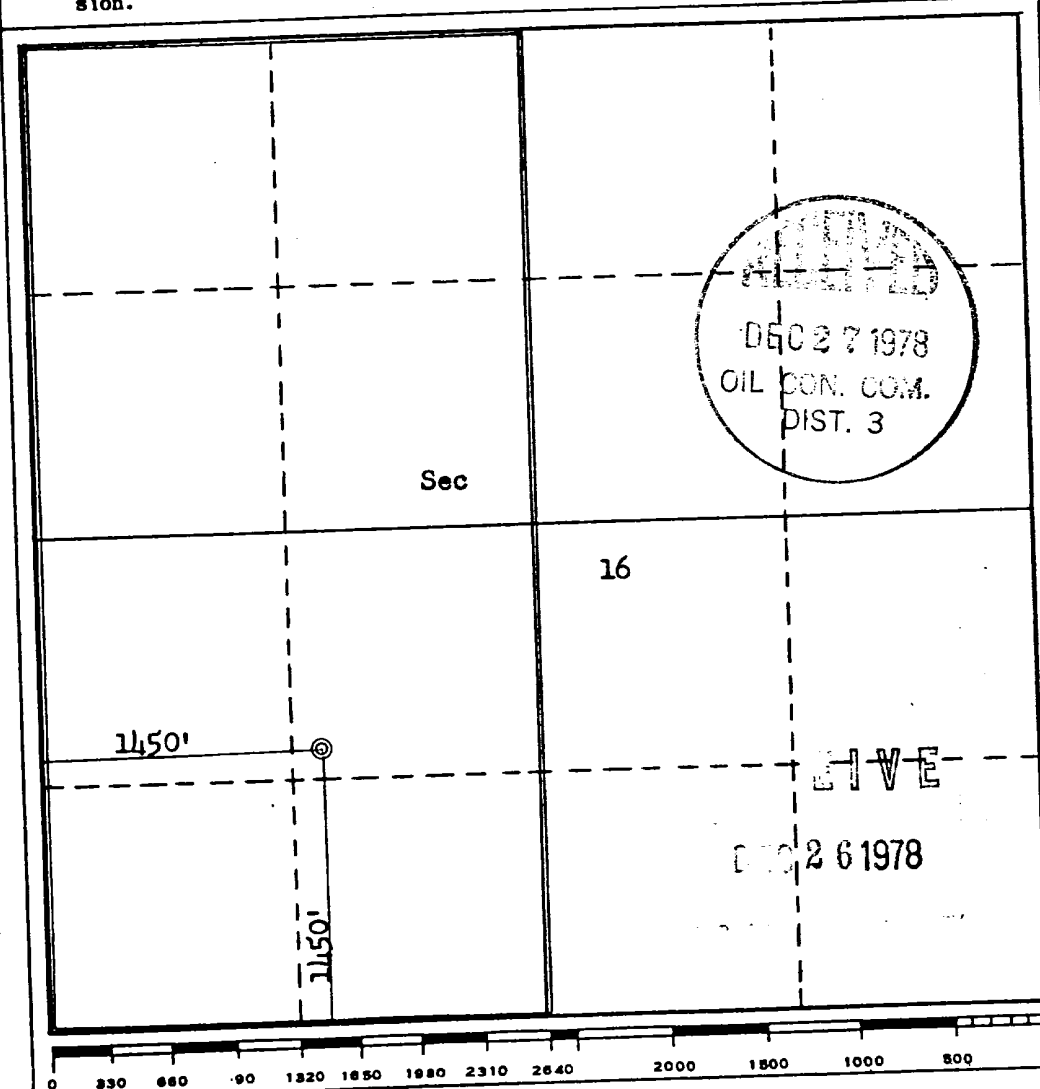
Operator PALMER OIL & GAS COMPANY			Lease APACHE JVA		Well No. 6
Unit Letter K	Section 16	Township 27N	Range 2W	County Rio Arriba	
Actual Footage Location of Well: 1450 feet from the South line and 1450 feet from the West line					
Ground Level Elev. 7301	Producing Formation Mesaverde		Pool Blanco-Mesaverde ext ✓		Dedicated Acreage: 320 Acres

1. Outline the acreage dedicated to the subject well by colored pencil or hachure marks on the plat below.
2. If more than one lease is dedicated to the well, outline each and identify the ownership thereof (both as to working interest and royalty).
3. If more than one lease of different ownership is dedicated to the well, have the interests of all owners been consolidated by communitization, unitization, force-pooling, etc?

☐ Yes ☐ No If answer is "yes," type of consolidation _____

If answer is "no," list the owners and tract descriptions which have actually been consolidated. (Use reverse side of this form if necessary.) _____

No allowable will be assigned to the well until all interests have been consolidated (by communitization, unitization, forced-pooling, or otherwise) or until a non-standard unit, eliminating such interests, has been approved by the Commission.



CERTIFICATION

I hereby certify that the information contained herein is true and complete to the best of my knowledge and belief.

Robert D Ballantyne

Name

Robert D. Ballantyne

Position

Drilling Superintendent

Company

Palmer Oil & Gas Company

Date

December 20, 1978

I hereby certify that the well location shown on this plat was plotted from field notes of actual surveys made by me or under my supervision, and that the same is true and correct to the best of my knowledge and belief.

Date Surveyed

December 8, 1978

Registered Professional Engineer and/or Land Surveyor

Fred B. Kerr, Jr.

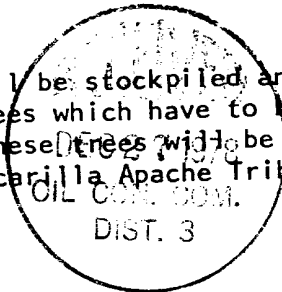
Certificate No. **B. KERR, JR.**

3950

TWELVE POINT PLAN OF DEVELOPMENT

For Surface Use for Palmer Oil & Gas Company's
Apache JVA #6
NE $\frac{1}{4}$ SW $\frac{1}{4}$ Section 16-T27N-R2W
Rio Arriba County, New Mexico

1. Existing roads including location of the exit from the main highway.
Existing roads include the main road which runs along the southern boundary of the Jicarilla Apache Reservation, turn north on good gravel road two miles to a fork, then right for $1\frac{1}{2}$ miles, go south, past dry hole for half a mile to location. See Appendix 1, Pages 92, 93, and 94 of Environmental Study dated October 10, 1976, and maps #1 and #2.
2. Planned access road.
See Topographic Map #1.
Access road will be bladed and not more than 25' wide.
3. Location of wells.
See map #3.
4. Location of tank batteries, production facilities and production gathering and service lines.
If this well is productive, it would be gas; therefore, the facilities would be the wellhead, tanks for oil and condensate, 10' x 10' water pit if necessary, separator and gas line to the well. The tanks and separator would be set within 150' of the well and the gas line would run adjacent and parallel to roads.
5. Location and type of water supply.
No arrangement has been made at this time.
6. Source of construction materials.
All construction material such as gravel, sand timbers, etc. will be purchased and hauled to the location. No water, sand or gravel will be used from this land.
7. Methods for handling waste disposal.
 - 1) Cuttings will be buried 3' below the surface.
 - 2) Drilling fluids will be left in a fenced, open pit to evaporate.
 - 3) Produced oil or condensate (if any) will be stored in a tank.
 - 4) Portable toilet to be provided.
 - 5) Trash will be burned in burn pit.
 - 6) After pit area is sufficiently dry, cuttings will be pushed into pit and sub-soil will be placed on any remaining fluid and cuttings, then top soil, if any, will be placed over both pit and location area.
8. Ancillary facilities.
No camps or airstrips will be used.
9. Wellsite layout.
See Plat #3. Top soil, if any, will be stockpiled and reused. Pits will not be lined. If there are any trees which have to be destroyed in building the location or access road, these trees will be counted by BIA and Palmer's representative and the Jicarilla Apache Tribe will be compensated for same.



NOV 26 1978

10. Plans for restoration of surface.

Upon completion of the well, all pits will be backfilled and top soil replaced and recontoured back to the original terrain. Pits will be backfilled as soon as they evaporate enough to permit such work. Should it be necessary to protect livestock or wild game, pits will be fenced and maintained until clean-up operations are commenced. Should oil accumulate on the pit, it will be removed and buried six feet deep or overhead flagging will be employed to protect wildlife.

11. Other information.

- 1) Topography - Drillsite and access low valley profile. See Pages 92, 93, and 94 of Environmental Study.
- 2) Vegetation - Sparse grass, sagebrush.
- 3) Land use - Land is used for grazing with no reservoir or water on this site. There are no known archaeological, cultural, or historical sites on this site. We have permission from Mr. Bill Allen, who's with the BIA in Albuquerque, New Mexico and whose phone number is 505-766-3374, to have an archaeologist present at the time the dirt work is started rather than do the survey prior to the approval of the drilling permit, do to snow cover. BIA will accept the San Juan Campus of the New Mexico State University which is at Farmington, for this survey. Mr. George Nalor, phone #505-325-7556, or Dr. Ned Salmon, phone #505-632-2013, will do the archaeology work.

12. Lessee's or operator's representative.

Elledge Consulting and Production Company
1701 Bloomfield Highway
Farmington, New Mexico 87401

Harold W. Elledge, President

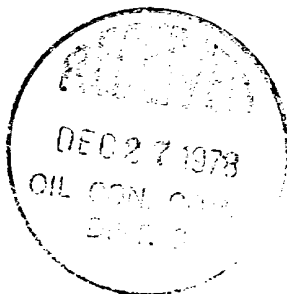
Office Phone (505)327-1181

OR

Robert D. Ballantyne
P. O. Box 2564
Billings, Montana 59103

Office Phone (406)248-3151
Home Phone (406)656-1304

13. I hereby certify that I, or persons under my direct supervision, have inspected the proposed drillsite and access route; that I am familiar with the conditions which presently exist; that the statements made in this plan are, to the best of my knowledge, true and correct; and, that the work associated with the operations proposed herein will be performed by Four Corners Drilling Co. and its contractors and sub-contractors in conformity with this plan and the terms and conditions under which it is proposed.



Robert D. Ballantyne
Robert D. Ballantyne

LIVE

DEC 26 1978

SEVEN POINT WELL CONTROL PLAN

PALMER OIL & GAS COMPANY
Apache JVA #6
NE $\frac{1}{4}$ SW $\frac{1}{4}$ Section 16-T27N-R2W
Rio Arriba County, New Mexico

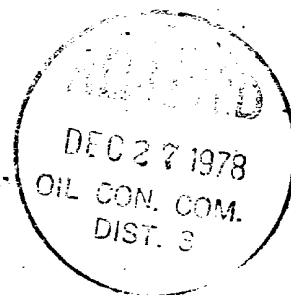
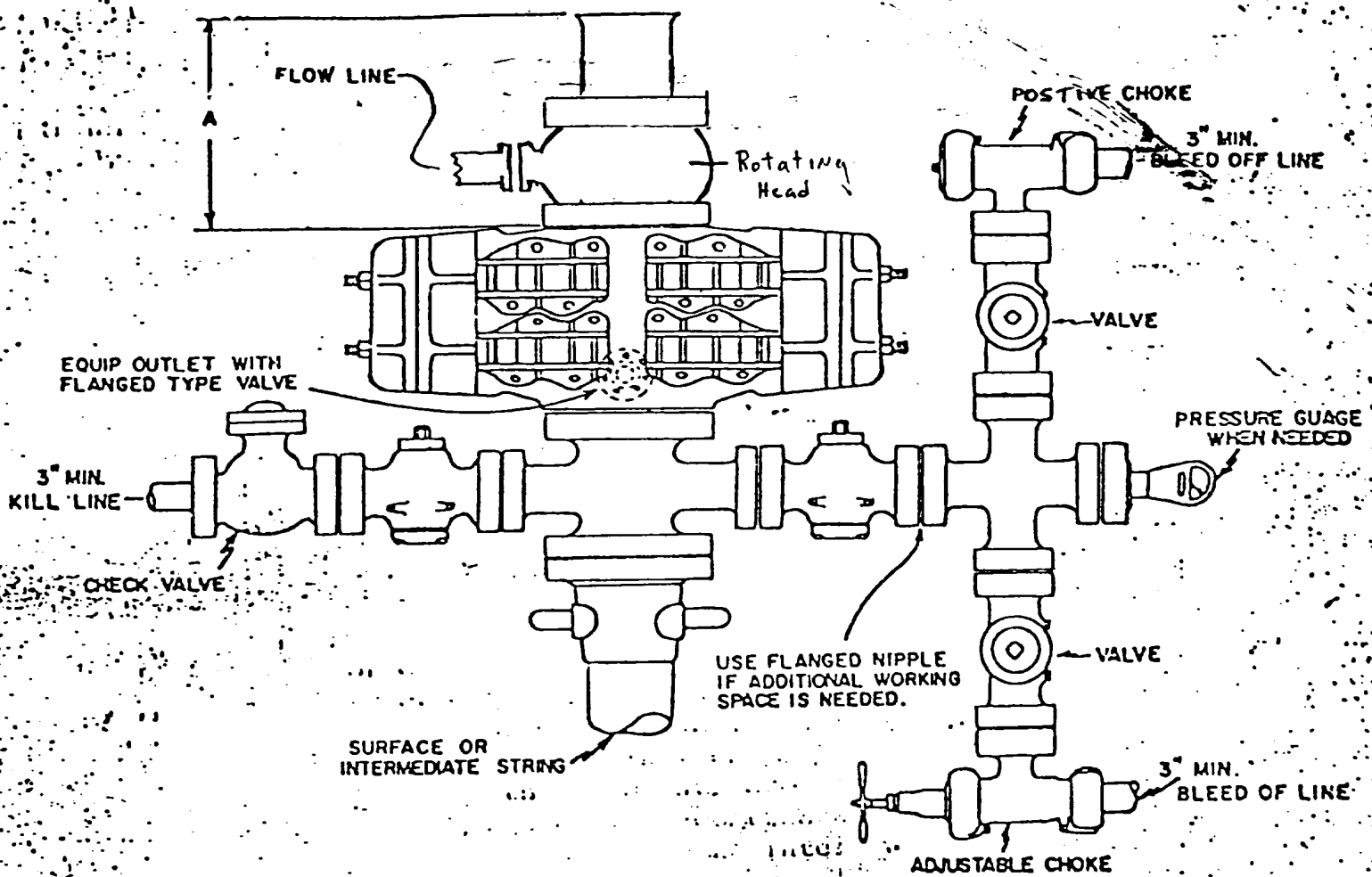
1. Surface Casing: 9-5/8" 36#/ft., Grade K-55, Short T&C, set at 300' and cemented with pump and plug method back to surface.
2. Casinghead Flange: 10" 900 S adapted to 1500 psig W. P. Larkin (or equivalent) casinghead with two 2" 1500 psi L. P. outlets.
3. 7" intermediate casing will be set to approximately 4,050' to case off any possible water from the Picture Cluff formation so as the remaining hole can be air drilled.
4. Blowout Preventor: A 10" 3000 psig W. P. Double gate hydraulic Shaffer BOP (or equivalent) with drill pipe rams and blind rams. All fill, kill, and choke lines will be minimum of 2" 2000 psi working pressure. The rams will be closed daily and checked for proper operation.
5. Auxillary Equipment: a) Drill pipe floats will be allowed at contractor's discretion; b) Visual and manual monitoring of mud system will be maintained.
6. Anticipated bottom hole pressure is less than 1800 psi at 6350' or a gradient of .277 psi/ft.
7. Well will be drilled with water base mud system with 8.8 - 9.0 ppg weight 35-45 seconds viscosity to 4,050' - Air drilling from 4,050' to T.D.

PALMER OIL & GAS COMPANY

Robert D Ballantyne
Robert D. Ballantyne

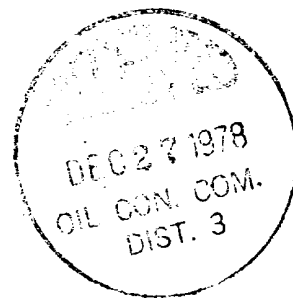


LIVE
DEC 26 1978



LIVE

DEC 26 1978



Proposed well 9A is to be located 2,050 feet from
the north line and 800 feet from the west line of section 16

LIVE

DEC 26 1978

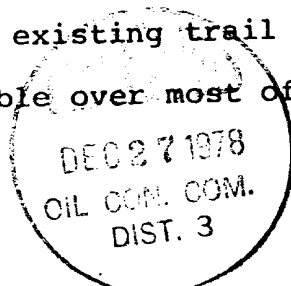
at an elevation of approximately 7,235 feet. The well will thus lie just north of the main Leavry Canyon road and access



Figure 33
Looking North Across the Proposed 9A Location

to the location will be directly from that road. If this well proves productive, it will be connected to the existing gathering system by approximately 100 feet of pipeline running south to the flow line from well 8B along the Leavry Canyon road.

Proposed well 9B will lie 1,300 feet from the south line and 1,400 feet from the east line of section 16. This well will lie alongside an existing trail south of Leavry Canyon. This trail is usable over most of its length at



LIVE

DEC 26 1978

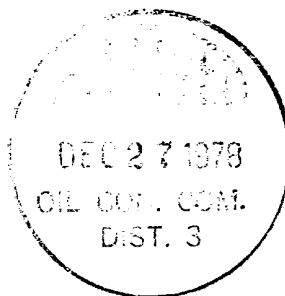
Appendix I

Page -94-

the present time but it will be necessary to rebuild the Leavry Canyon crossing before building the location. This trail continues on to the 8B location and will also be used as the access route for that well. If the 9B location proves productive, it will be connected to the 83 flow line which crosses the edge of this location.

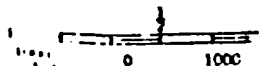
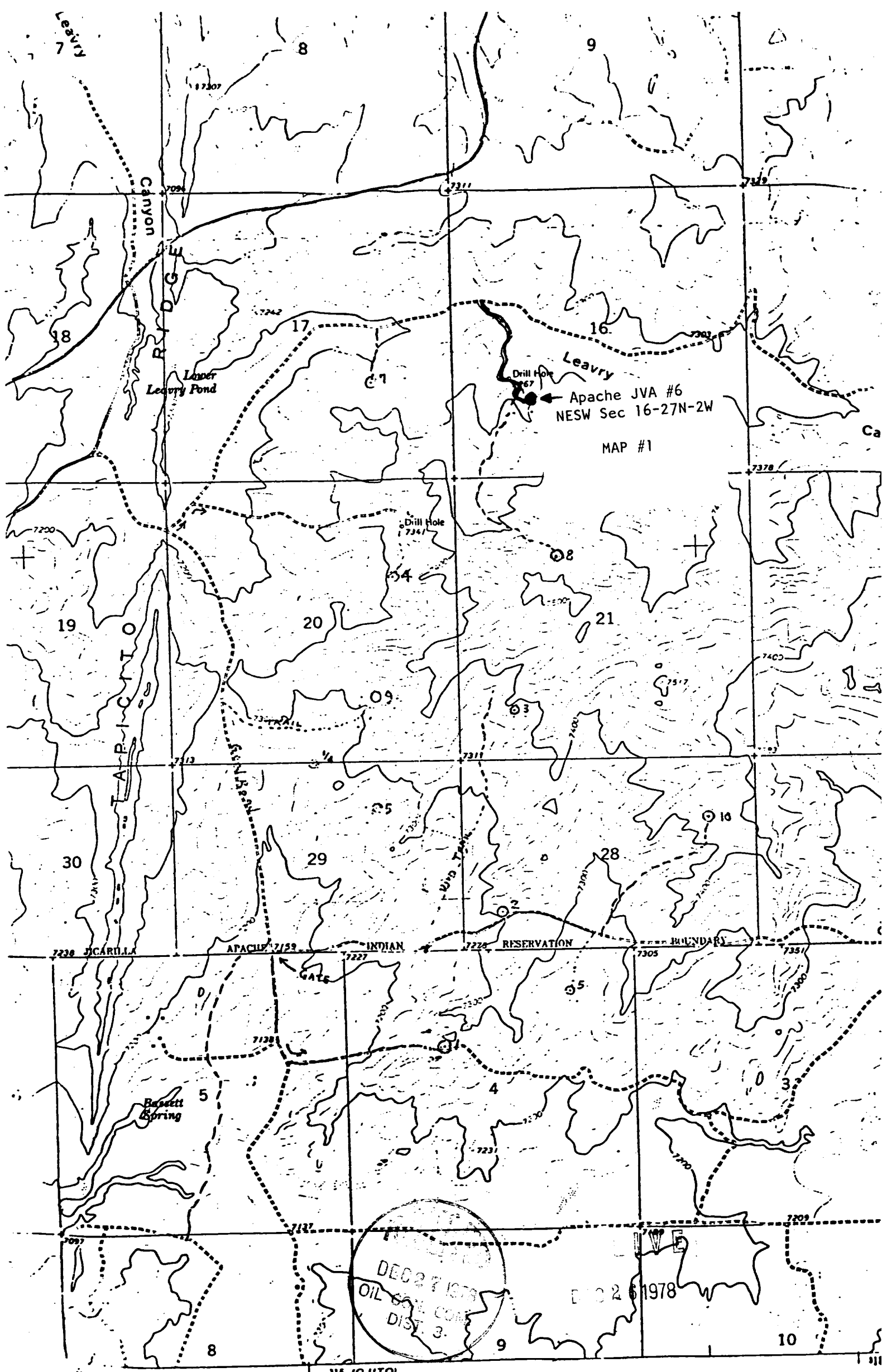


Figure 34
Looking North Across the Proposed 9B Location



FIVE

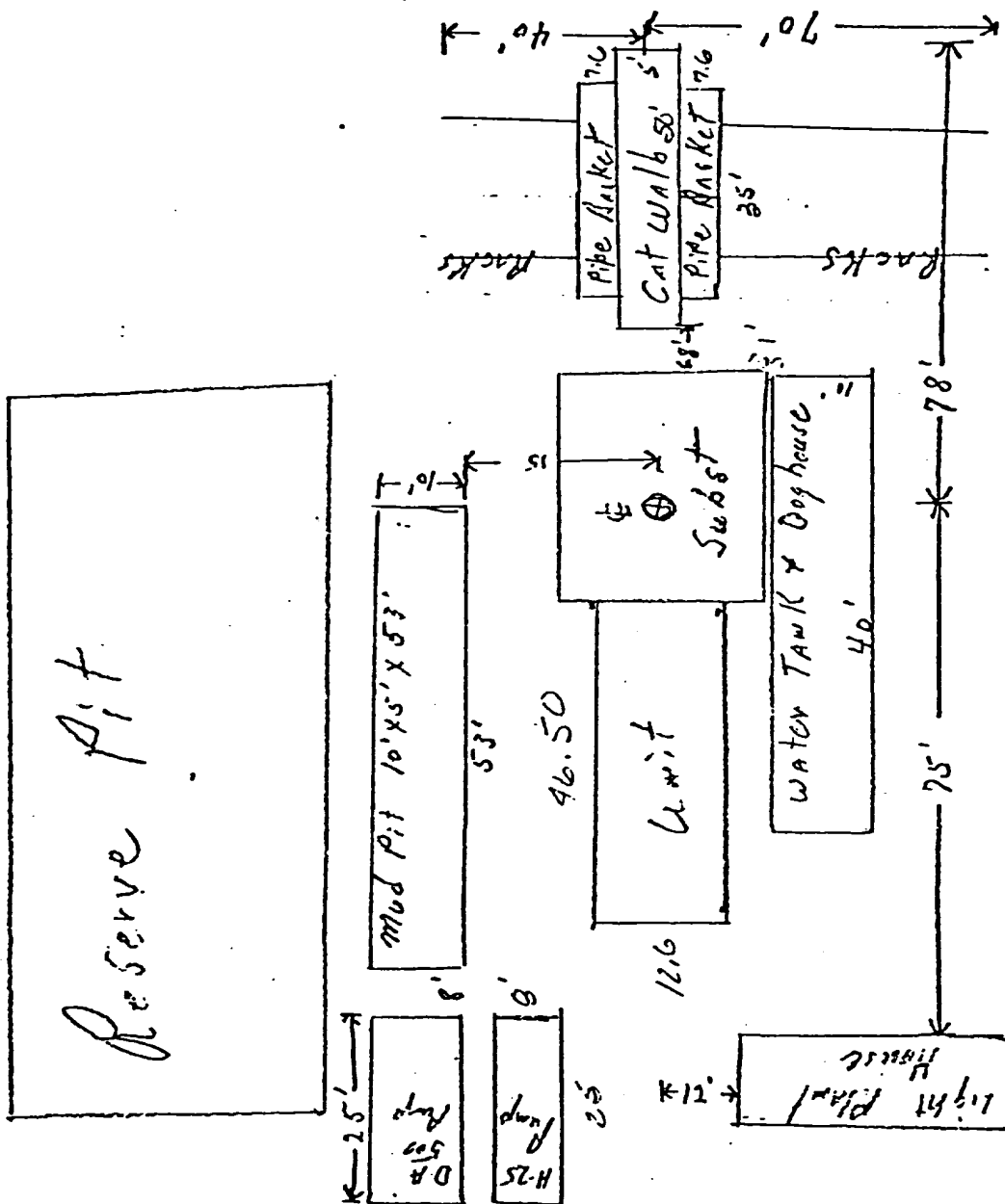
DEC 26 1978



1:24,000
SCALE 1:24,000
0 1000
3000 4000

Vicinity Map for
PALMER OIL & GAS CO. #6 APACHE JVA
1450' FSL 1450' FWL Sec 16-T27N-R2W

TELEPHONE: (505) 327-1122



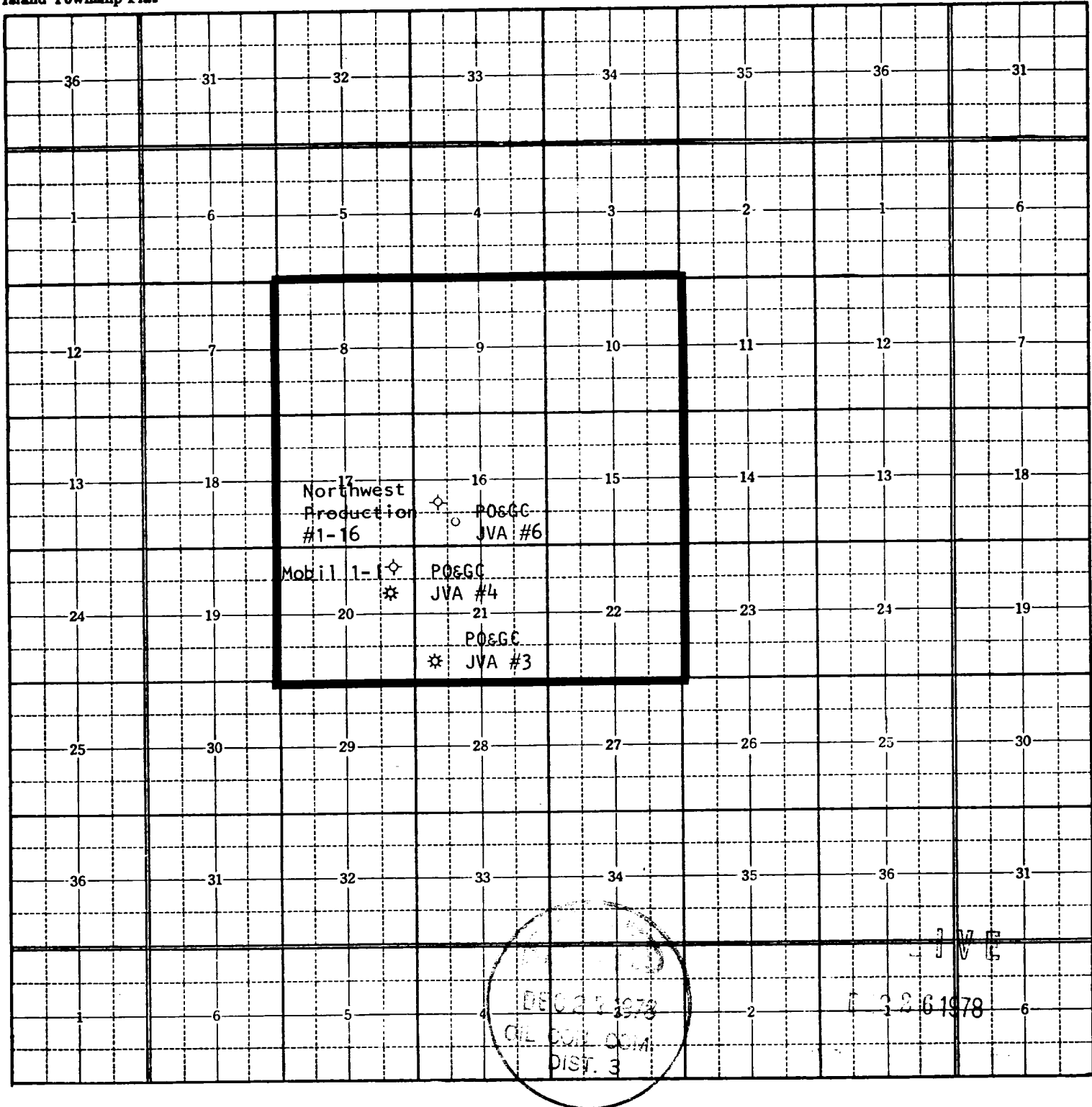
PLAT #3

DEC 27 1978
OIL CON. COM.
DIST. 3

FIVE
 DEC 26 1978

Township 27N, Range 2W, County Rio Arriba, State New Mexico

Island Township Plat



JVA #6
T27N-R2W, Sec. 16
NE $\frac{1}{4}$ SW $\frac{1}{4}$

Map # 3