



STATE OF NEW MEXICO  
ENERGY AND MINERALS DEPARTMENT  
OIL CONSERVATION DIVISION  
AZTEC DISTRICT OFFICE

1000 RIO BRAZOS ROAD  
AZTEC, NEW MEXICO 87410  
(505) 334-6178

OIL CONSERVATION DIVISION  
BOX 2088  
SANTA FE, NEW MEXICO 87501

DATE 5-8-86

RE: Proposed MC \_\_\_\_\_  
Proposed DHC X \_\_\_\_\_  
Proposed NSL \_\_\_\_\_  
Proposed SWD \_\_\_\_\_  
Proposed WFX \_\_\_\_\_  
Proposed PMX \_\_\_\_\_

Gentlemen:

I have examined the application dated 4-11-86  
for the Columbia Energy Corp. NCRA #1E G-22-26N-7W  
Operator NCRA #1E Lease and Well No. G-22-26N-7W

and my recommendations are as follows:

Approve  
\_\_\_\_\_  
\_\_\_\_\_  
\_\_\_\_\_  
\_\_\_\_\_

Yours truly,

Eric Busch



# *Columbus Energy Corp.*

P. O. BOX 2038  
FARMINGTON, NEW MEXICO 87499  
(505) 632-8056

April 3, 1986

RECEIVED  
APR 11 1986  
OIL CON. DIV.  
DIST. 3

Richard L. Stamets  
New Mexico Oil Conservation Division  
P. O. Box 2088  
Santa Fe, New Mexico 87501

Re: Application for Administrative Approval of Downhole  
Commingle for Columbus Energy Corporation  
NCRA 1E, Basin Dakota/Blanco Mesaverde Dual  
1550' FNL & 1850' FEL  
Sec 22, T26N, R7W, Rio Arriba Co., New Mexico

Dear Mr. Stamets:

Columbus Energy Corporation hereby requests authorization to downhole commingle the Basin Dakota and Blanco Mesaverde formations within the above referenced well. The gas streams are already commingled (Admin. Order # R-6426).

We would like to allocate 91.5% gas and 77% oil to the Dakota; 8.5% gas and 23% oil to the Mesaverde, based on cumulative production history. From 1980 to present the Dakota produced approximately .742 BCF and 6,020 BO. The Mesaverde produced approximately 68 MMCF and 1,800 BO, using the subtraction method.

The ownership, working interest, royalty and overriding royalty are common for both zones.

A hole in the 1-1/2" Dakota string will require the pulling and replacement of sections of this string. Both zones will be produced through this single string of tubing.

Enclosed please find requested information.

Yours very truly,

COLUMBUS ENERGY CORPORATION

*Wayne L. Converse*

Wayne L. Converse  
District Engineer

WLC/dc

Enclosures

cc: N. M. Oil Conservation Division, Aztec  
BLM, Farmington



NEW MEXICO OIL CONSERVATION COMMISSION  
WELL LOCATION AND ACREAGE DEDICATION PLAT

Form O  
Supersedes  
Effective

All distances must be from the outer boundaries of the Section.

Operator <b>CONSOLIDATED OIL AND GAS, INC.</b>		Lease <b>NCRA</b>		Well No. <b>1-E</b>	
Unit Letter <b>G</b>	Section <b>22</b>	Township <b>26 NORTH</b>	Range <b>7 WEST</b>	County <b>RIO ARriba</b>	
Actual Footage Location of Well:					
<b>1550</b> feet from the <b>NORTH</b> line and		<b>1850</b> feet from the <b>EAST</b> line			
Ground Level Elev. <b>6928</b>	Producing Formation <b>Dakota</b>	Pool <b>Basin Dakota</b>	Dedicated Acreage: <b>320.00</b> Acres		

1. Outline the acreage dedicated to the subject well by colored pencil or hatchure marks on the plat below.
2. If more than one lease is dedicated to the well, outline each and identify the ownership thereof (both as to working interest and royalty).
3. If more than one lease of different ownership is dedicated to the well, have the interests of all owners been consolidated by communitization, unitization, force-pooling, etc?

☒ Yes ☐ No If answer is "yes," type of consolidation Communitization

If answer is "no," list the owners and tract descriptions which have actually been consolidated. (Use reverse side of this form if necessary.)

No allowable will be assigned to the well until all interests have been consolidated (by communitization, unitization, forced-pooling, or otherwise) or until a non-standard unit, eliminating such interests, has been approved by the Commission.

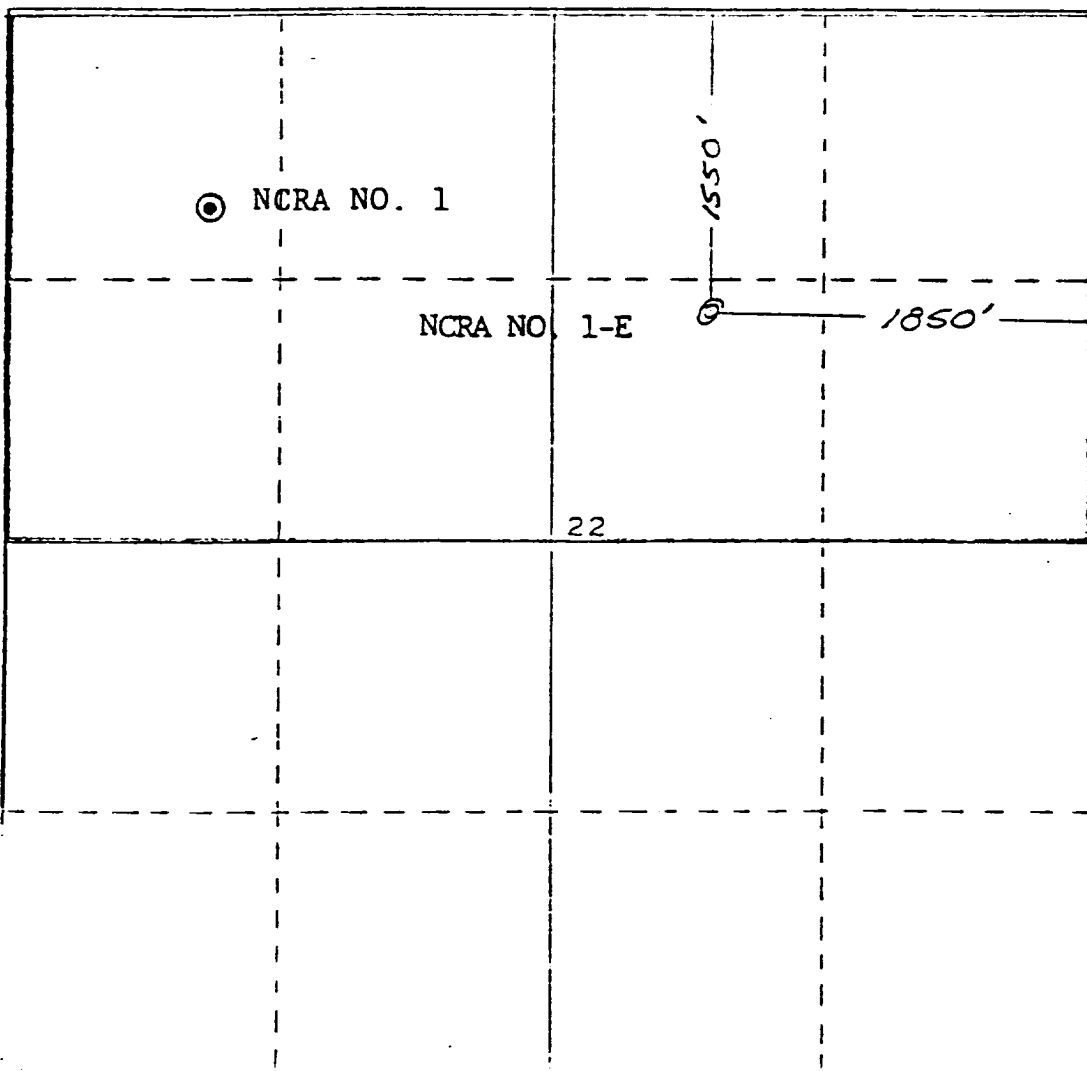

CERTIFICATION

I hereby certify that the information contained herein is true and complete to the best of my knowledge and belief.

*C. M. Parham*

Name

**C. M. Parham**

Position

**Senior Production Engineer**

Company

**Consolidated Oil & Gas, Inc.**

Date

**August 16, 1979**

I hereby certify that the location shown on the plat was plotted from field notes of actual surveys made by me under my supervision 1463 at the site is true and correct to the best of my knowledge and belief.

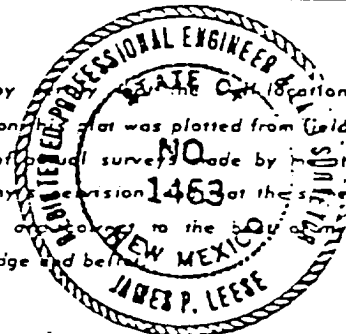

Date Surveyed

**30 May 1979**

Registered Professional Engineer and Surveyor

*James P. Leese*  
**James P. Leese**

All measurements must be from the outer boundaries of the property

Lessor <b>CONSOLIDATED OIL AND GAS, INC.</b>		Lease <b>NCRA</b>		Well No. <b>1-E</b>
Section <b>G</b>	Section <b>22</b>	Township <b>26 NORTH</b>	Range <b>7 WEST</b>	County <b>RIO ARriba</b>
Well Footage Location of Well:				
<b>1550</b>	feet from the	<b>NORTH</b>	line and	<b>1850</b>
				feet from the
				<b>EAST</b>
and Level Elev. <b>5928</b>	Producing Formation <b>Mesaverde</b>		Pool <b>Blanco Mesaverde</b>	Dedicated Acreage: <b>320.00</b> Acres

1. Outline the acreage dedicated to the subject well by colored pencil or hachure marks on the plat below.
2. If more than one lease is dedicated to the well, outline each and identify the ownership thereof (both as to working interest and royalty).
3. If more than one lease of different ownership is dedicated to the well, have the interests of all owners been consolidated by communitization, unitization, force-pooling, etc?

☒ Yes ☐ No If answer is "yes," type of consolidation Communitization

If answer is "no," list the owners and tract descriptions which have actually been consolidated. (Use reverse side of this form if necessary.)

No allowable will be assigned to the well until all interests have been consolidated (by communitization, unitization, forced-pooling, or otherwise) or until a non-standard unit, eliminating such interests, has been approved by the Commission.

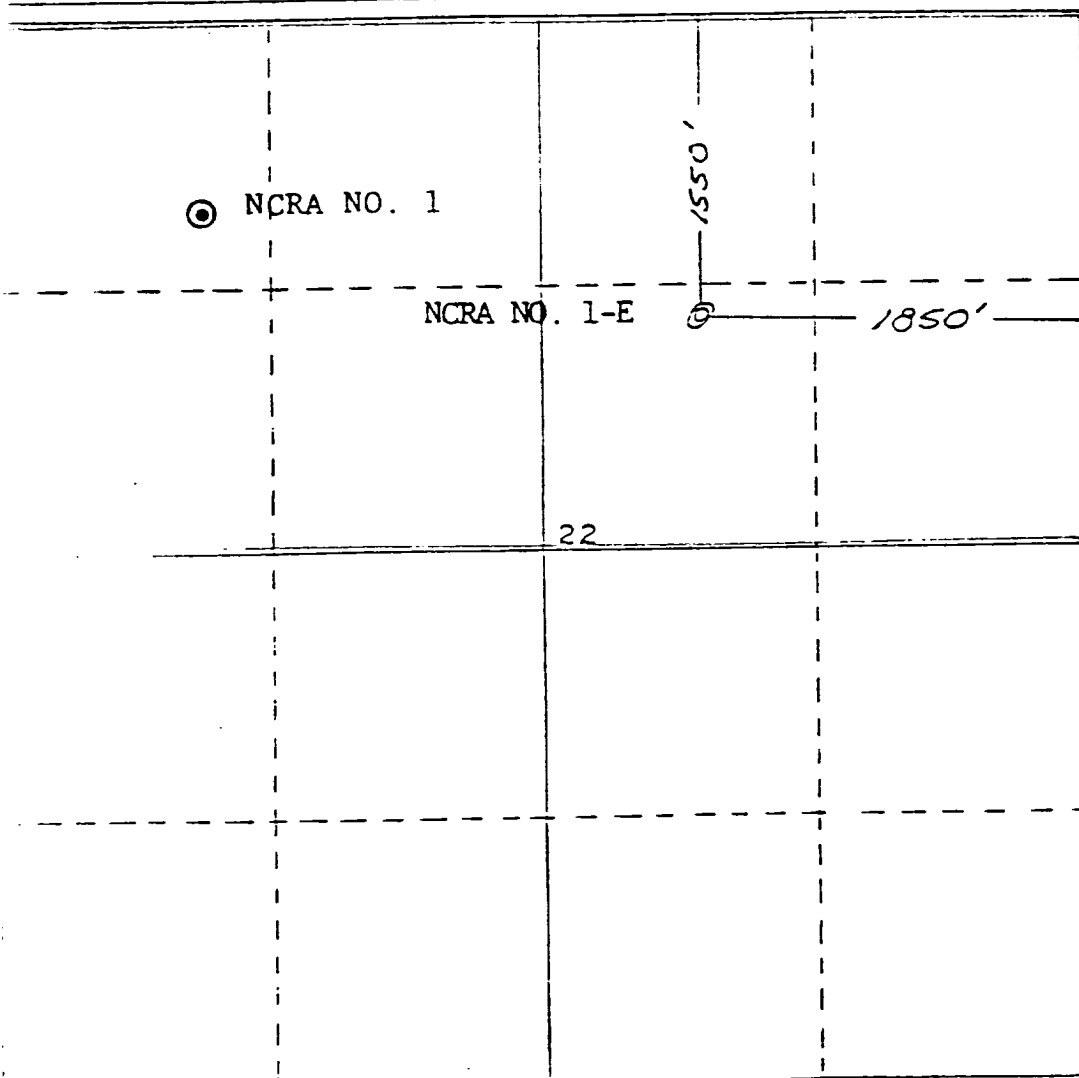

#### CERTIFICATION

I hereby certify that the information contained herein is true and complete to the best of my knowledge and belief.

*C. M. Parham*

Name  
**C. M. Parham**

Position  
**Senior Production Engineer**

Company  
**Consolidated Oil & Gas, Inc.**

Date  
**August 16, 1979**

I hereby certify that the location shown on the plat was plotted from field notes of a survey made by me under my commission 1463 at the time is true and correct to the best of my knowledge and belief.

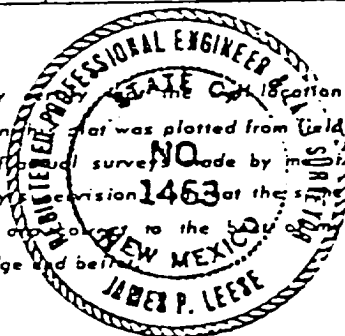

Date Surveyed  
**30 May 1979**

Registered Professional Engineer  
and Surveyor

*James P. Lease*  
**James P. Lease**

Certificate No. **1162**

Columbus Energy Corporation  
Well Completion Schematic for  
Commingling Application

Elevation: 6941' KB  
6928' GL

NCRA 1E  
Sec 22, T26N, R7W  
Rio Arriba Co., NM  
April 3, 1986

8-5/8", 24#, casing @ 370'  
Cmt w/ 300 sx Cl "B" w/  
2% CaCl<sub>2</sub>, 1/4# cello-  
flake/sx. Cmt top at  
surface.

13-3/4" hole to 373'

Cmt stage collar @ 5605'  
Cmt 2nd stage w/ 165 sx  
65/35 pozmix w/ 12% gel.  
Tail-in w/ 200 sx 50/50  
pozmix w/ 4% gel and .6%  
FLA. Cmt top at 4150'.

1-1/4" tbg @ 5382'

Mesaverde perf  
interval: 5307-5512'  
(20 holes)

5-1/2", 15.5# K-55 casing  
@ 7500'. Cmt 1st stage  
w/ 100 sx 65/35 pozmix  
w/ 12% gel. Tail-in w/  
165 sx 50/50 pozmix w/  
4% gel and .6% FLA.  
Cmt top at 6520'.

Baker Retrieval-a-D  
pkr @ 7320'

1-1/2" tbg @ 7453'

Dakota perf interval:  
7354-7493' (18 holes)

PBTD @ 7511'- FC  
Clean out to 7513'

7-7/8" hole to 7560'  
Drillers TD - 7560'  
Loggers TD - 7541'

NOTE - Dakota gas is metered then placed back  
in the casing to help lift produced fluids

NCRA 1E  
Sec 22, T26N, R7W

RE: Rule 303C, Para. 2, Requirement (d)

We would like to request an exception to rule 303C, Para. 2, Requirement (d). A current (within 30 days) 24 hour productivity test of the Dakota and Mesaverde zones would not reflect accurate production potential due to the leak in the Dakota tubing string. Gas from the Dakota is metered and placed back in the casing to help lift produced fluids from the Mesaverde. The Mesaverde is currently incapable of producing gas on its own without assistance from the Dakota.

NCRA 1E  
Sec 22, T26N, R7W

RE: Rule 303C, Para. 2, Requirement (e)

We are submitting production decline curves for the Basin Dakota and Blanco Mesaverde. Because of the sporadic nature of the gas takes, we do not believe these to be representative of the actual decline in each formation.



WELL NO	426N07H226000K	LOC A TRAIL	226 26N	07HCONSOLIDATED OIL GAS INC NCRA	WELL NAME	IE
STATE	NEMMEXICO	FIELD NO	8004974BASIN DAKOTA (PRORATED GAS)	OPERATOR	DK	
DIST NO	4	COUNTY OR PARISH	RIO ARriba	DATE 1ST	112279	05-80
DATE COM	112279	DATE 1ST	112279	DATE 2ND	05-80	
PROD	91460	TEST DATE	120 6 25 80	POTENTIAL	1 402	2092
174222	1648	6 1 81	547	1652		
181769	3130	3 31 82	565	1662		
97101	4956	4 9 83	496	1372		
121462						
7110						
7420						
7110						
7420						
7110						
7420						
7110						
7420						
7110						
7420						
7110						
7420						
7110						
7420						
7110						
7420						
7110						
7420						
7110						
7420						
7110						
7420						
7110						
7420						
7110						
7420						
7110						
7420						
7110						
7420						
7110						
7420						
7110						
7420						
7110						
7420						
7110						
7420						
7110						
7420						
7110						
7420						
7110						
7420						
7110						
7420						
7110						
7420						
7110						
7420						
7110						
7420						
7110						
7420						
7110						
7420						
7110						
7420						
7110						
7420						
7110						
7420						
7110						
7420						
7110						
7420						
7110						
7420						
7110						
7420						
7110						
7420						
7110						
7420						
7110						
7420						
7110						
7420						
7110						
7420						
7110						
7420						
7110						
7420						
7110						
7420						
7110						
7420						
7110						
7420						
7110						
7420						
7110						
7420						
7110						
7420						
7110						
7420						
7110						
7420						
7110						
7420						
7110						
7420						
7110						
7420						
7110						
7420						
7110						
7420						
7110						
7420						
7110						
7420						
7110						
7420						
7110						
7420						
7110						
7420						
7110						
7420						
7110						
7420						
7110						
7420						
7110						
7420						
7110						
7420						
7110						
7420						
7110						
7420						
7110						
7420						
7110						
7420						
7110						
7420						
7110						
7420						
7110						
7420						
7110						
7420						
7110						
7420						
7110						
7420						
7110						
7420						
7110						
7420						
7110						
7420						
7110						
7420						
7110						
7420						
7110						
7420						
7110						
7420						
7110						
7420						
7110						
7420						
7110						
7420						
7110						
7420						
7110						
7420						
7110						
7420						
7110						
7420						
7110						
7420						
7110						
7420						
7110						
7420						
7110						
7420						
7						



NDRA 1E  
Sec 22, T26N, R7W

RE: Rule 303C, Para. 2, Requirement (f)

Due to the economics involved in acquiring measured bottom-hole pressures with a hole in the production tubing, we are submitting the latest Packer Leakage Test which did not fail in 1985.

This form is not to  
be used for reporting  
packer leakage tests  
in Southeast New Mexico

## NORTHWEST NEW MEXICO PACKER-LEAKAGE TEST

for CONSOLIDATED OIL & GAS, INC. Lease N.C.R.A. Well No. 1-EUnit G Sec. 22 Twp. 26 Rge. 7 County RIO ARRIBA

	NAME OF RESERVOIR OR POOL	TYPE OF PROD. (Oil or Gas)	METHOD OF PROD. (Flow or Art. Lift)	PROD. MEDIUM (Tbg. or Cag.)
Location	MESA VERDE	GAS	FLOW	TBG
Location	DAKOTA	GAS	FLOW	TBG

## PRE-FLOW SHUT-IN PRESSURE DATA

Hour, date shut-in	Length of time shut-in	SI press. psig	Stabilized? (Yes or No)
9-20-85	3 Days	1142	Yes
Hour, date shut-in	Length of time shut-in	SI press. psig	Stabilized? (Yes or No)
9-20-85	3 Days	1301	Yes

## FLOW TEST NO. 1

Shut-in at (hour, date)* 9-23-85				Zone producing (Upper or Lower)	Lower
TIME (hour, date)	LAPSED TIME SINCE*	PRESSURE		PROD. ZONE TEMP.	REMARKS
		Upper Completion	Lower Completion		
9-21		1141	1300		Both Zones Shut-In
9-22		1141	1301		" "
9-23		1142	1301		" "
9-24	1 Day	1142	1042		Lower Zone Flowing
9-25	2 Days	1142	1168		" " (Well line freeze)

Production rate during test

BOPD based on \_\_\_\_\_ Bbls. in \_\_\_\_\_ Hours.  
588 MCFPD; Tested thru (Orifice or Meter): \_\_\_\_\_ Meter

## MID-TEST SHUT-IN PRESSURE DATA

Hour, date shut-in	Length of time shut-in	SI press. psig	Stabilized? (Yes or No)
Hour, date shut-in	Length of time shut-in	SI press. psig	Stabilized? (Yes or No)

RECEIVED  
OCT 07 1985  
OIL CON. DIV.  
DIST. 3

NCRA 1E  
Sec 22, T26N, R7W

RE: Rule 303C, Para. 2, Requirement (g)

We would like to request an exception to Rule 303C, Para. 2, Requirement (g). Analysis of fluids taken from this well in both zones would not be representative of reservoir fluids in each zone due to the tubing leak. We have not observed any problems with emulsions or precipitates forming in the surface facilities. The gas from these two zones have been commingled since August of 1980. The following data is representative of the produced fluids in this well:

	GAS (s.g.)	OIL (API)	B.S. & W. (%)
DAKOTA	.624	53.2	0.4
MESAVERDE	.688	46.2	0.2

NOTE - Water analysis from the Candado 1E Basin Dakota/  
Blanco Mesaverde well is submitted as a representative  
water sample of these two formations. The Candado 1E  
is located at 1993' FSL and 1600' FEL, Sec 15, R26N, R7W.

UNICHEM INTERNATIONAL

1215 Basin Road

P.O. Box 421

FARMINGTON, N.M. 87401

COMPANY: COLUMBUS ENERGY

DATE: 4-9-86

FIELD, LEASE AND WELL: CANDADO 1E MESA VERDE

SAMPLING POINT: WELLHEAD

DATE SAMPLED: 3-27-86

SPECIFIC GRAVITY: 1.009

TOTAL DISSOLVED SOLIDS: 14,335

PH = 7.04

		ME/L	MG/L
CATIONS			
CALCIUM	(CA)+2	5.6	112.0
MAGNESIUM	(MG)+2	4.4	53.4
SODIUM	(NA), CALC.	221.0	5101.0

ANIONS			
BICARBONATE	(C)3)-1	13.4	817.0
CARBONATE	(CO3)-2		
HYDROXIDE	(OH)-1		
SULFATE	(SO4)-2	38.5	1850.0
CHLORIDES	(CL)-1	180.0	6400.0

DISSOLVED GASES			
CARBON DIOXIDE	(CO2)		
HYDROGEN SULFIDE	(H2S)		
OXYGEN	(O2)		
IRON	(FE)		61.0
BARIUM	(BA)+2		0.2
MANGANESE	(MN)		
IONIC STRENGTH = 0.26			
SCALING INDEX		TEMP	
		86°F 30°C	120°F 48.8°C
CARBONATE INDEX		-0.25	0.142
CALCIUM CARBONATE SCALING		UNLIKELY	LIKELY
SULFATE INDEX		-27.0	-28.0
CALCIUM SULFATE SCALING		UNLIKELY	UNLIKELY

U N I C H E M   I N T E R N A T I O N A L

1215 Basin Road

P.O. Box 421

FARMINGTON, N.M. 87401

COMPANY: COLUMBUS ENERGY

DATE: 4-9-86

FIELD, LEASE AND WELL: CANDADO 1E DAKOTA

SAMPLING POINT: WELLHEAD

DATE SAMPLED: 3-27-86

SPECIFIC GRAVITY: 1.009

TOTAL DISSOLVED SOLIDS: 15,092

PH = 7.95

		ME/L	MG/L
CATIONS			
CALCIUM	(CA)+2	1.6	32.0
MAGNESIUM	(MG)+2	2.4	29.1
SODIUM	(NA), CALC.	245.0	5632.0

ANIONS			
BICARBONATE	(C)3)-1	21.0	1281.0
CARBONATE	(CO3)-2		
HYDROXIDE	(OH)-1		
SULFATE	(SO4)-2	0	0
CHLORIDES	(CL)-1	228.0	8100.0

DISSOLVED GASES			
CARBON DIOXIDE	(CO2)		
HYDROGEN SULFIDE	(H2S)		
OXYGEN	(O2)		
IRON	(FE)		35.1
BARIUM	(BA)+2	0.25	17.3
MANGANESE	(MN)		
IONIC STRENGTH = 0.255			

SCALING INDEX

CARBONATE INDEX

CALCIUM CARBONATE SCALING

SULFATE INDEX

CALCIUM SULFATE SCALING

TEMP.

86°F 30°C

0.310

LIKELY

-45.0

UNLIKELY

120°F 48.8°C

0.711

LIKELY

-46.0

UNLIKELY

U N I C H E M   I N T E R N A T I O N A L

1215 Basin Road

P.O. Box 421

FARMINGTON, N.M. 87401

COMPANY: COLUMBUS ENERGY

DATE: 4-9-86

FIELD, LEASE AND WELL: 50% CANDADO 1E MESA VERDE/50% CANDADO 1E DAKOTA

SAMPLING POINT: WELLHEAD

DATE SAMPLED: 3-27-86

SPECIFIC GRAVITY: 1.009

TOTAL DISSOLVED SOLIDS: 14,764

PH = 7.495

		ME/L	MG/L
CATIONS			
CALCIUM	(CA)+2	3.6	72.1
MAGNESIUM	(MG)+2	3.4	41.4
SODIUM	(NA), CALC.	233.0	5367.0

ANIONS			
BICARBONATE	(C)3)-1	17.2	1049.0
CARBONATE	(CO3)-2		
HYDROXIDE	(OH)-1		
SULFATE	(SO4)-2	19.2	925.0
CHLORIDES	(CL)-1	204.0	7300.0

DISSOLVED GASES			
CARBON DIOXIDE	(CO2)		
HYDROGEN SULFIDE	(H2S)		
OXYGEN	(O2)		
IRON	(FE)		48.0
BARIUM	(BA)+2	0.12	8.7
MANGANESE	(MN)		
IONIC STRENGTH 0.258			

	TEMP.	
SCALING INDEX	86° F 30° C	120° F 48.8° C
CARBONATE INDEX	0.115	0.517
CALCIUM CARBONATE SCALING	LIKELY	LIKELY
SULFATE INDEX	-36.0	-36.0
CALCIUM SULFATE SCALING	UNLIKELY	UNLIKELY



NCRA 1E  
Sec 22, T26N, R7W

RE: Rule 303C, Para. 2, Requirement (h)

We believe production will not decrease by commingling the Dakota and Mesaverde formations. The well has continued to produce satisfactorily despite existing line pressures and periods of shut-in due to no demand. We do anticipate that production will remain the same or increase with additional gas volumes helping to lift produced liquids in the wellbore. Gas production from both zones is already commingled downhole (Admin. Order # R-6426). Specific gravity of the Dakota and Mesaverde gas stream is .624 with a heating value of 1084 BTU. The price of gas from both zones is currently \$2.75/MCF, so commingling has not reduced the sum of the values of the individual streams. Allocation of produced amounts is determined by the subtraction method.

NCRA 1E  
Sec 22, T26N, R7W

RE: Rule 303C, Para. 2, Requirement (i)

We would like to allocate 91.5% gas and 77% oil to the Dakota and 8.5% gas and 23% oil to the Mesaverde formations, based on previous well production since 1980. Percent of allocation was arrived from the total production from each zone from 1980 to January 1986. Oil production from the Mesaverde has increased in the recent production history of this well. This is due primarily to the hole in the Dakota tubing string.

TOTAL PRODUCTION

	GAS (Mcf)	OIL (Bbls)	GOR
DAKOTA	742,138	6,019	123,300
* MESAVERDE	68,410	1,800	38,006

PERCENT ALLOCATION

	GAS (%)	OIL (%)
DAKOTA	91.5	77
MESAVERDE	8.5	23

\* Measurement of the Mesaverde stream is determined by the subtraction method after the Dakota stream has been metered.

NCRA 1E  
Sec 22, T26N, R7W

RE: Rule 303C, Para. 2, Requirement (j)

Letters of intent to commingle this well were sent to the attached list of offset operators. The Bureau of Land Management also received a copy. Sample copies of the letter and waiver are included.

El Paso Energy Corporation  
List of Offset Operators

NCRA 1E

Caulkins Oil Company  
1600 Broadway, Suite 2100  
Denver, Colorado 80202

Depco Incorporated  
1000 Petroleum Bldg  
Denver, Colorado 80202

El Paso Natural Gas Company  
P. O. Box 990  
Farmington, New Mexico 87499

W.B. Hamilton Estate  
1220 Hamilton Bldg.  
Wichita Falls, Texas 76301

Curtis J. Little  
P. O. Box 1258  
Farmington, New Mexico 87499

National Cooperative Refinery Associates  
2215 Wilco Bldg.  
Midland, Texas 79701

Turner Production Company  
1 Energy Ste 852  
4925 Grnvl Av  
Dallas, Texas 75206  
-----

Bureau of Land Management  
Caller Service 4104  
Farmington, New Mexico 87499



# *Columbus Energy Corp.*

P. O. BOX 2038  
FARMINGTON, NEW MEXICO 87499  
(505) 632-8056

April 3, 1986

Caulkins Oil Company  
1600 Broadway, Suite 2100  
Denver, Colorado 80202

Re: Waiver for Administrative Approval of Downhole Commingling  
for Columbus Energy Corporation NCRA 1E, Basin Dakota &  
Blanco Mesaverde Dual, 1550' FNL & 1850' FEL, Sec 22, T26N,  
R7W, Rio Arriba Co., New Mexico

Gentlemen:

Columbus Energy Corporation is applying to the New Mexico Oil Conservation Division, as outlined in NMOC Rule 303C, for administrative commingle of the Dakota and Mesaverde zones in the subject well. We are notifying your office of our intent, and would like you to sign and return one copy of the Waiver of Objection in each of the self addressed envelopes.

Please mail the waivers to Richard L. Stamets, New Mexico Oil Conservation Division, P. O. Box 2088, Santa Fe, New Mexico 87501 and Wayne L. Converse, Columbus Energy Corporation, P. O. Box 2038, Farmington, New Mexico 87499.

If you have any questions concerning this request, please contact Wayne L. Converse at 505-632-8056.

Yours very truly,

COLUMBUS ENERGY CORPORATION

Wayne L. Converse  
District Engineer

WLC/dc

Enclosures

cc: N. M. Oil Conservation Division, Santa Fe  
N. M. Oil Conservation Division, Aztec  
BLM, Farmington



# *Columbus Energy Corp.*

P. O. BOX 2038  
FARMINGTON, NEW MEXICO 87499  
(505) 632-8056

April 3, 1986

Depco Incorporated  
1000 Petroleum Bldg  
Denver, Colorado 80202

Re: Waiver for Administrative Approval of Downhole Commingling  
for Columbus Energy Corporation NCRA 1E, Basin Dakota &  
Blanco Mesaverde Dual, 1550' FNL & 1850' FEL, Sec 22, T26N,  
R7W, Rio Arriba Co., New Mexico

Gentlemen:

Columbus Energy Corporation is applying to the New Mexico Oil Conservation Division, as outlined in NMDCD Rule 303C, for administrative commingle of the Dakota and Mesaverde zones in the subject well. We are notifying your office of our intent, and would like you to sign and return one copy of the Waiver of Objection in each of the self addressed envelopes.

Please mail the waivers to Richard L. Stamets, New Mexico Oil Conservation Division, P. O. Box 2088, Santa Fe, New Mexico 87501 and Wayne L. Converse, Columbus Energy Corporation, P. O. Box 2038, Farmington, New Mexico 87499.

If you have any questions concerning this request, please contact Wayne L. Converse at 505-632-8056.

Yours very truly,

COLUMBUS ENERGY CORPORATION

Wayne L. Converse  
District Engineer

WLC/dc

Enclosures

cc: N. M. Oil Conservation Division, Santa Fe  
N. M. Oil Conservation Division, Aztec  
BLM, Farmington



# *Columbus Energy Corp.*

P O BOX 2038  
FARMINGTON, NEW MEXICO 87499  
(505) 632-8056

April 3, 1986

El Paso Natural Gas Company  
P. O. Box 990  
Farmington, New Mexico 87499

Re: Waiver for Administrative Approval of Downhole Commingling  
for Columbus Energy Corporation NCRA 1E, Basin Dakota &  
Blanco Mesaverde Dual, 1550' FNL & 1850' FEL, Sec 22, T26N,  
R7W, Rio Arriba Co., New Mexico

Gentlemen:

Columbus Energy Corporation is applying to the New Mexico Oil Conservation Division, as outlined in NMOCD Rule 303C, for administrative commingle of the Dakota and Mesaverde zones in the subject well. We are notifying your office of our intent, and would like you to sign and return one copy of the Waiver of Objection in each of the self addressed envelopes.

Please mail the waivers to Richard L. Stamets, New Mexico Oil Conservation Division, P. O. Box 2088, Santa Fe, New Mexico 87501 and Wayne L. Converse, Columbus Energy Corporation, P. O. Box 2038, Farmington, New Mexico 87499.

If you have any questions concerning this request, please contact Wayne L. Converse at 505-632-8056.

Yours very truly,

COLUMBUS ENERGY CORPORATION

Wayne L. Converse  
District Engineer

WLC/dc

Enclosures

cc: N. M. Oil Conservation Division, Santa Fe  
N. M. Oil Conservation Division, Aztec  
BLM, Farmington



# *Columbus Energy Corp.*

P. O. BOX 2038  
FARMINGTON, NEW MEXICO 87499  
(505) 632-8056

April 3, 1986

W.B. Hamilton Estate  
1220 Hamilton Bldg.  
Wichita Falls, Texas 76301

Re: Waiver for Administrative Approval of Downhole Commingling  
for Columbus Energy Corporation NCRA 1E, Basin Dakota &  
Blanco Mesaverde Dual, 1550' FNL & 1850' FEL, Sec 22, T26N,  
R7W, Rio Arriba Co., New Mexico

Gentlemen:

Columbus Energy Corporation is applying to the New Mexico Oil Conservation Division, as outlined in NMOCDD Rule 303C, for administrative commingle of the Dakota and Mesaverde zones in the subject well. We are notifying your office of our intent, and would like you to sign and return one copy of the Waiver of Objection in each of the self addressed envelopes.

Please mail the waivers to Richard L. Stamets, New Mexico Oil Conservation Division, P. O. Box 2088, Santa Fe, New Mexico 87501 and Wayne L. Converse, Columbus Energy Corporation, P. O. Box 2038, Farmington, New Mexico 87499.

If you have any questions concerning this request, please contact Wayne L. Converse at 505-632-8056.

Yours very truly,

COLUMBUS ENERGY CORPORATION

Wayne L. Converse  
District Engineer

WLC/dc

Enclosures

cc: N. M. Oil Conservation Division, Santa Fe  
N. M. Oil Conservation Division, Aztec  
BLM, Farmington





# *Columbus Energy Corp.*

P. O. BOX 2038  
FARMINGTON, NEW MEXICO 87499  
(505) 632-8056

April 3, 1986

Curtis J. Little  
P. O. Box 1258  
Farmington, New Mexico 87499

Re: Waiver for Administrative Approval of Downhole Commingling  
for Columbus Energy Corporation NCRA 1E, Basin Dakota &  
Blanco Mesaverde Dual, 1550' FNL & 1850' FEL, Sec 22, T26N,  
R7W, Rio Arriba Co., New Mexico

Gentlemen:

Columbus Energy Corporation is applying to the New Mexico Oil Conservation Division, as outlined in NMOCDD Rule 303C, for administrative commingle of the Dakota and Mesaverde zones in the subject well. We are notifying your office of our intent, and would like you to sign and return one copy of the Waiver of Objection in each of the self addressed envelopes.

Please mail the waivers to Richard L. Stamets, New Mexico Oil Conservation Division, P. O. Box 2088, Santa Fe, New Mexico 87501 and Wayne L. Converse, Columbus Energy Corporation, P. O. Box 2038, Farmington, New Mexico 87499.

If you have any questions concerning this request, please contact Wayne L. Converse at 505-632-8056.

Yours very truly,

COLUMBUS ENERGY CORPORATION

Wayne L. Converse  
District Engineer

WLC/dc

Enclosures

cc: N. M. Oil Conservation Division, Santa Fe  
N. M. Oil Conservation Division, Aztec  
BLM, Farmington



# *Columbus Energy Corp.*

P. O. BOX 2038  
FARMINGTON, NEW MEXICO 87499  
(505) 632-8056

April 3, 1986

National Cooperative Refinery Associates  
2215 Wilco Bldg.  
Midland, Texas 79701

Re: Waiver for Administrative Approval of Downhole Commingling  
for Columbus Energy Corporation NCRA 1E, Basin Dakota &  
Blanco Mesaverde Dual, 1550' FNL & 1850' FEL, Sec 22, T26N,  
R7W, Rio Arriba Co., New Mexico

Gentlemen:

Columbus Energy Corporation is applying to the New Mexico Oil Conservation Division, as outlined in NMOCD Rule 303C, for administrative commingle of the Dakota and Mesaverde zones in the subject well. We are notifying your office of our intent, and would like you to sign and return one copy of the Waiver of Objection in each of the self addressed envelopes.

Please mail the waivers to Richard L. Stamets, New Mexico Oil Conservation Division, P. O. Box 2088, Santa Fe, New Mexico 87501 and Wayne L. Converse, Columbus Energy Corporation, P. O. Box 2038, Farmington, New Mexico 87499.

If you have any questions concerning this request, please contact Wayne L. Converse at 505-632-8056.

Yours very truly,

COLUMBUS ENERGY CORPORATION

Wayne L. Converse  
District Engineer

WLC/dc

Enclosures

cc: N. M. Oil Conservation Division, Santa Fe  
N. M. Oil Conservation Division, Aztec  
BLM, Farmington



# *Columbus Energy Corp.*

P. O. BOX 2038

FARMINGTON, NEW MEXICO 87499

(505) 632-8056

April 3, 1986

Turner Production Company  
1 Energy Ste 852  
4925 Grnvl Av  
Dallas, Texas 75206

Re: Waiver for Administrative Approval of Downhole Commingling  
for Columbus Energy Corporation NCRA 1E, Basin Dakota &  
Blanco Mesaverde Dual, 1550' FNL & 1850' FEL, Sec 22, T26N,  
R7W, Rio Arriba Co., New Mexico

Gentlemen:

Columbus Energy Corporation is applying to the New Mexico Oil Conservation Division, as outlined in NMOC Rule 303C, for administrative commingle of the Dakota and Mesaverde zones in the subject well. We are notifying your office of our intent, and would like you to sign and return one copy of the Waiver of Objection in each of the self addressed envelopes.

Please mail the waivers to Richard L. Stamets, New Mexico Oil Conservation Division, P. O. Box 2088, Santa Fe, New Mexico 87501 and Wayne L. Converse, Columbus Energy Corporation, P. O. Box 2038, Farmington, New Mexico 87499.

If you have any questions concerning this request, please contact Wayne L. Converse at 505-632-8056.

Yours very truly,

COLUMBUS ENERGY CORPORATION

Wayne L. Converse  
District Engineer

WLC/dc

Enclosures

cc: N. M. Oil Conservation Division, Santa Fe  
N. M. Oil Conservation Division, Aztec  
BLM, Farmington

WAIVER OF OBJECTION AND  
CONSENT TO COMMINGLE THE  
DUAL COMPLETION

FOR COLUMBUS ENERGY CORPORATION

THE UNDERSIGNED, as an offset operator/lease holder of a lease

near NCRA 1E, DK/MV Dual  
1550' FNL & 1850' FEL  
Sec 22, T26N, R7W  
Rio Arriba Co., New Mexico

Does hereby acknowledge receipt of the letter requesting approval  
of commingling of the above captioned well.

The undersigned hereby waives any objection to this application  
and voluntarily consents to the commingling of the above captioned  
well.

SIGNED: \_\_\_\_\_

NAME: \_\_\_\_\_

TITLE: \_\_\_\_\_

FIRM: \_\_\_\_\_

DATE: \_\_\_\_\_

Please find enclosed self addressed envelopes. Mail one copy to  
Richard L. Stamets, New Mexico Oil Conservation Division, P. O. Box  
2088, Santa Fe, New Mexico 87501 and Wayne L. Converse, Columbus  
Energy Corporation, P. O. Box 2038, Farmington, New Mexico 87499.