

UNITED STATES
DEPARTMENT OF THE INTERIOR
GEOLOGICAL SURVEY

30-039-22299

APPLICATION FOR PERMIT TO DRILL, DEEPEN, OR PLUG BACK

1a. TYPE OF WORK

DRILL ☒DEEPEN ☐PLUG BACK ☐

b. TYPE OF WELL

OIL
WELL ☐GAS
WELL ☒

OTHER

SINGLE
ZONE ☐MULTIPLE
ZONE ☒

2. NAME OF OPERATOR

El Paso Natural Gas Company

3. ADDRESS OF OPERATOR

PO Box 289, Farmington, NM 87401

4. LOCATION OF WELL (Report location clearly and in accordance with any State requirements.)*

At surface

860'S, 1790'E

At proposed prod. zone

same

14. DISTANCE IN MILES AND DIRECTION FROM NEAREST TOWN OR POST OFFICE*

30 miles east of Blanco, NM

15. DISTANCE FROM PROPOSED*

LOCATION TO NEAREST
PROPERTY OR LEASE LINE, FT.
(Also to nearest drg. unit line, if any)

832'

16. NO. OF ACRES IN LEASE

Unit

17. NO. OF ACRES ASSIGNED
TO THIS WELL

160 7 E 320.00

18. DISTANCE FROM PROPOSED LOCATION*
TO NEAREST WELL, DRILLING, COMPLETED,
OR APPLIED FOR, ON THIS LEASE, FT.

2500'

19. PROPOSED DEPTH

5805'

20. ROTARY OR CABLE TOOLS

Rotary

21. ELEVATIONS (Show whether DF, RT, GR, etc.)

6480'GL

22. APPROX. DATE WORK WILL START*

23.

PROPOSED CASING AND CEMENTING PROGRAM

SIZE OF HOLE	SIZE OF CASING	WEIGHT PER FOOT	SETTING DEPTH	QUANTITY OF CEMENT
13 3/4"	9 5/8"	36.0#	200'	224 cu.ft. to circulate
8 3/4"	7"	20.0#	3435'	240 cu.ft. to cover Ojo Alamo
6 1/4"	4 1/2" liner	10.5#	3285-5805'	440 cu.ft. to circ. liner

This location has been approved for a Pictured Cliffs well, the San Juan 28-6 Unit #217. It is now planned to drill this well as a Pictured Cliffs - Mesa Verde dual as follows:
Selectively perforate and sandwater fracture the Mesa Verde and Pictured Cliffs formation.

A 3000 psi WP and 6000 psi test double gate preventer equipped with blind and pipe rams will be used for blow out prevention on this well.

This gas is dedicated.

The E/2 of Section 8 is dedicated to this well.

IN ABOVE SPACE DESCRIBE PROPOSED PROGRAM: If proposal is to deepen or plug back, give data on present productive zone and proposed new productive zone. If proposal is to drill or deepen directionally, give pertinent data on subsurface locations and measured and true vertical depths. Give blowout preventer program, if any.

24.

SIGNED

*D. G. Buices*APPROVED
AS AMENDED

TITLE Drilling Clerk

DATE 1-23-80

(This space for Federal or State office use)

PERMIT NO.

FEB 25 1980

APPROVAL DATE

APPROVED BY

JAMES F. SIMS
DISTRICT ENGINEER

DATE

CONDITIONS OF APPROVAL, IF ANY:

DRILLING OPERATIONS AUTHORIZED ARE
SUBJECT TO COMPLIANCE WITH ATTACHED
"GENERAL REQUIREMENTS"

*See Instructions On Reverse Side

FEB 07 1980
U. S. GEOLOGICAL SURVEY
FARMINGTON, COLO.

NEW MEXICO OIL CONSERVATION COMMISSION
WELL LOCATION AND ACREAGE DEDICATION PLAT

Form C-107
Supersedes C-120
Effective 1-1-65

All distances must be from the outer boundaries of the Section.

Operator EL PASO NATURAL GAS COMPANY			Lease SAN JUAN 28-6 UNIT (NM-03583)		Well No. 22A
Unit Letter 0	Section 8	Township 27N	Range 6W	County Rio Arriba	

Actual Postage Location of Well:

860	feet from the South	line and	1790	feet from the East	line
Ground Level Elev. 6480	Producing Formation Mesa Verde		Foot Blanco Mesa Verde	Dedicated Acreage: 320.00	
	Pictured Cliffs		South Blanco Pictured Cliffs Ext.	160.00	

1. Outline the acreage dedicated to the subject well by colored pencil or hachure marks on the plat below.
2. If more than one lease is dedicated to the well, outline each and identify the ownership thereof (both as to working interest and royalty).
3. If more than one lease of different ownership is dedicated to the well, have the interests of all owners been consolidated by communitization, unitization, force-pooling, etc?

☒ Yes ☐ No If answer is "yes," type of consolidation Unitization

If answer is "no," list the owners and tract descriptions which have actually been consolidated. (Use reverse side of this form if necessary.)

No allowable will be assigned to the well until all interests have been consolidated (by communitization, unitization, forced-pooling, or otherwise) or until a non-standard unit, eliminating such interests, has been approved by the Commission.

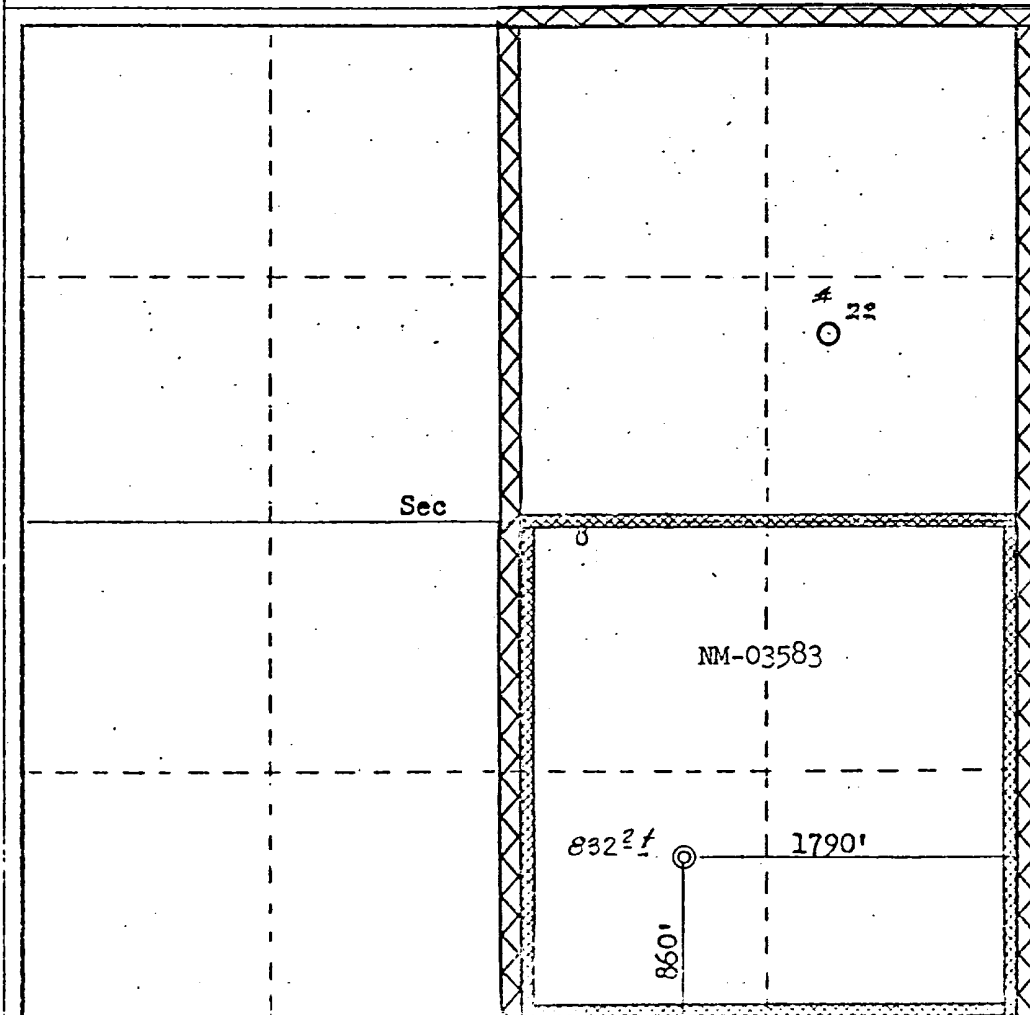

CERTIFICATION

I hereby certify that the information contained herein is true and complete to the best of my knowledge and belief.

A. H. Dices

Name

Drilling Clerk

Position

El Paso Natural Gas Co.

Company

January 23, 1980

Date

I hereby certify that the well location shown on this plat was plotted from field notes or records made by me or under my supervision, and that the same is true and correct to the best of my knowledge and belief.

RECEIVED
FEB 26 1980
OIL CON. COM.
DIST. 3

Date received

July 22, 1978

Inspector of the State of New Mexico and of the Land Office

Fred B. Kerr Jr.

Continued

3950

