

NO. OF COPIES RECEIVED	6
DISTRIBUTION	
SANTA FE	1
FILE	1
U.S.G.S.	2
LAND OFFICE	1
OPERATOR	1

NEW MEXICO OIL CONSERVATION COMMISSION

Form C-101
Revised 1-4-65

5A. Indicate Type of Lease	
STATE <input checked="" type="checkbox"/>	FEE <input type="checkbox"/>
5. State Oil & Gas Lease No.	
E 290-3	

APPLICATION FOR PERMIT TO DRILL, DEEPEN, OR PLUG BACK

1a. Type of Work		7. Unit Agreement Name	
DRILL <input checked="" type="checkbox"/> DEEPEN <input type="checkbox"/> PLUG BACK <input type="checkbox"/>		San Juan 27-5 Unit	
b. Type of Well		8. Farm or Lease Name	
OIL WELL <input type="checkbox"/> GAS WELL <input checked="" type="checkbox"/> OTHER <input type="checkbox"/> SINGLE ZONE <input type="checkbox"/> MULTIPLE ZONE <input checked="" type="checkbox"/>		San Juan 27-5 Unit	
2. Name of Operator		9. Well No.	
El Paso Natural Gas Company		8A	
3. Address of Operator		10. Field and Pool, or Wildcat	
PO Box 289, Farmington, NM 87401		So. Blanco Mesa Verde	
4. Location of Well		12. County	
UNIT LETTER <u>E</u> LOCATED <u>1830</u> FEET FROM THE <u>North</u> LINE		Rio Arriba	
AND <u>840</u> FEET FROM THE <u>West</u> LINE OF SEC. <u>32</u> TWP. <u>27N</u> RGE. <u>5W</u> NMPM			
		19. Proposed Depth	
		5875'	
		19A. Formation	
		PC & MV	
		20. Rotary or C.T.	
		Rotary	
21. Elevations (Show whether DF, RT, etc.)		21B. Drilling Contractor	
6547' GR			
21A. Kind & Status Plug. Bond		22. Approx. Date Work will start	
statewide			

23.

PROPOSED CASING AND CEMENT PROGRAM

SIZE OF HOLE	SIZE OF CASING	WEIGHT PER FOOT	SETTING DEPTH	SACKS OF CEMENT	EST. TOP
13 3/4"	9 5/8"	36.0#	200'	224 cu.ft.	circulated
8 3/4"	7"	20.0#	3590'	218 cu.ft.	top Ojo Alamo
6 1/4"	4 1/2"	10.5#	3440-5875'	425 cu.ft.	circ.liner

Selectively perforate and sandwater fracture the Pictured Cliffs and Mesa Verde formations.

A 3000 psi WP and 6000 psi test double gate preventer equipped with blind and pipe rams will be used for blow out prevention on this well.

This gas is dedicated.

APPROVAL VALID
FOR 90 DAYS UNLESS
DRILLING COMMENCED,

EXPIRES 6-16-80

The W/2 of Section 32 is dedicated to this well.

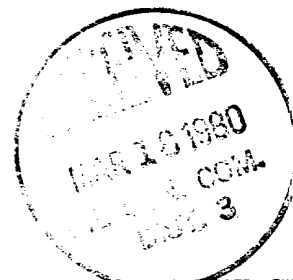

IN ABOVE SPACE DESCRIBE PROPOSED PROGRAM: IF PROPOSAL IS TO DEEPEN OR PLUG BACK, GIVE DATA ON PRESENT PRODUCTIVE ZONE AND PROPOSED NEW PRODUCTIVE ZONE. GIVE BLOWOUT PREVENTER PROGRAM, IF ANY.

I hereby certify that the information above is true and complete to the best of my knowledge and belief.

Signed Frank T. Chavez Title Drilling Clerk Date March 18, 1980

(This space for State Use)

APPROVED BY Original Signed by FRANK T. CHAVEZ TITLE SUPERVISOR DISTRICT # 3 DATE MAR 18 1980

CONDITIONS OF APPROVAL, IF ANY:

All distances must be from the outer boundaries of the Section.

Operator EL PASO NATURAL GAS COMPANY			Lease SAN JUAN 27-5 UNIT (E-290-3)		Well No. 8-A
Unit Letter E	Section 32	Township 27N	Range 5W	County Rio Arriba	
Actual Footage Location of Well: 1830 feet from the North line and 840 feet from the West line					
Ground Level Elev. 5547	Producing Formation Mesa Verde - Pictured Cliffs		Pool go. Blanco Pictured Cliffs Blanco Mesa Verde		Dedicated Acreage: 160.0 & 320.0 Acres

1. Outline the acreage dedicated to the subject well by colored pencil or hachure marks on the plat below.
2. If more than one lease is dedicated to the well, outline each and identify the ownership thereof (both as to working interest and royalty).
3. If more than one lease of different ownership is dedicated to the well, have the interests of all owners been consolidated by communitization, unitization, force-pooling, etc?

☒ Yes ☐ No If answer is "yes," type of consolidation Unitization

If answer is "no," list the owners and tract descriptions which have actually been consolidated. (Use reverse side of this form if necessary.)

No allowable will be assigned to the well until all interests have been consolidated (by communitization, unitization, forced-pooling, or otherwise) or until a non-standard unit, eliminating such interests, has been approved by the Commission.

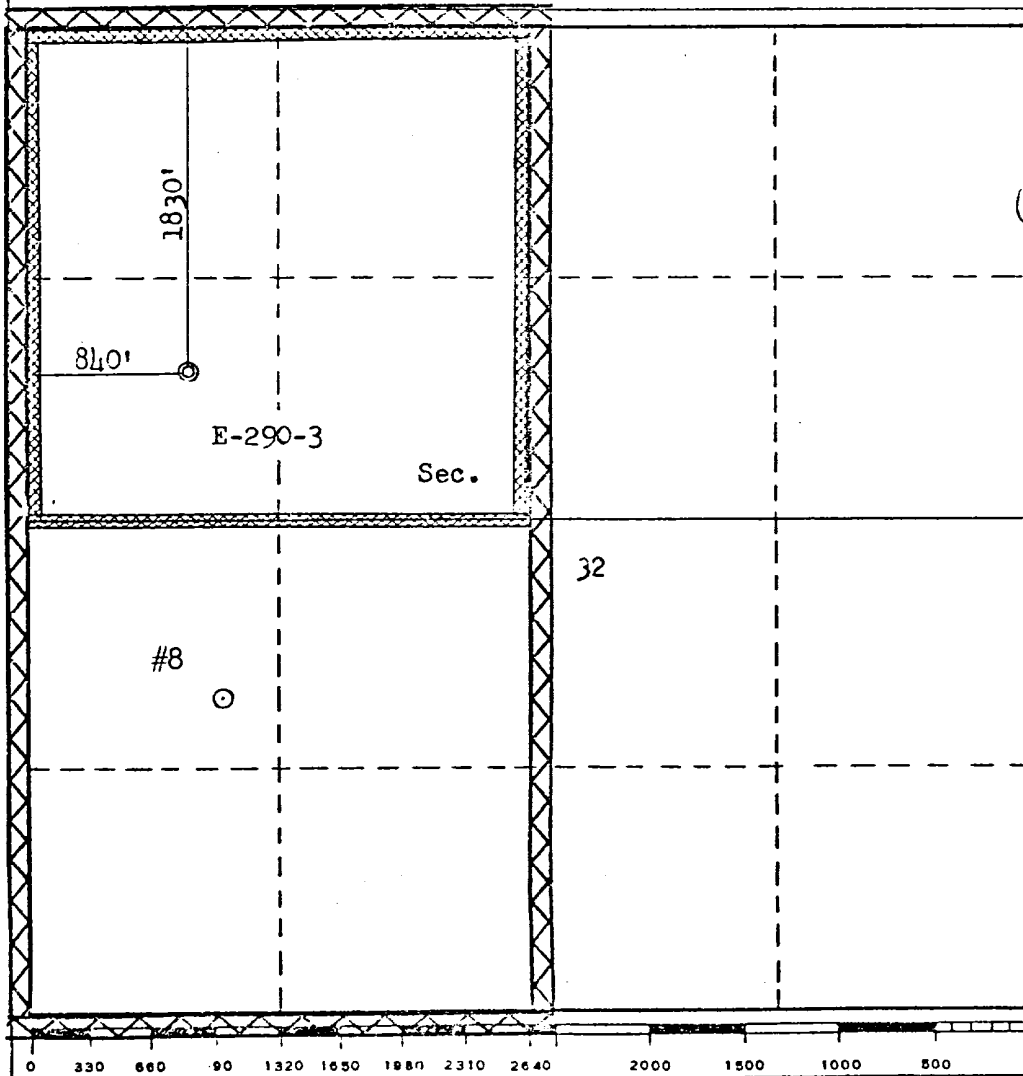

CERTIFICATION

I hereby certify that the information contained herein is true and complete to the best of my knowledge and belief.

[Signature]
Name

Drilling Clerk

Position

El Paso Natural Gas Co.

Company

March 18, 1980

Date

I hereby certify that the well location shown on this plat was plotted from field notes of actual surveys made by me or under my supervision, and that the same is true and correct to the best of my knowledge and belief.

Date Surveyed

August 11, 1979

Registered Professional Engineer
and/or Land Surveyor

[Signature]
Fred B. Kerr Jr.

Certificate No.

3950

NO. OF COPIES RECEIVED	
DISTRIBUTION	
SANTA FE	
FILE	
U.S.G.S.	
LAND OFFICE	
OPERATOR	

NEW MEXICO OIL CONSERVATION COMMISSION

Form C-103
Supersedes Old
C-102 and C-103
Effective 1-1-65

5a. Indicate Type of Lease State <input checked="" type="checkbox"/> Fee <input type="checkbox"/>
5. State Oil & Gas Lease No. E-290-3
7. Unit Agreement Name San Juan 27-5 Unit
8. Farm or Lease Name San Juan 27-5 Unit
9. Well No. 8A (PM)
10. Field and Pool, or Wildcat Blanco PC & Blanco MV
12. County Rio Arriba

SUNDRY NOTICES AND REPORTS ON WELLS
(DO NOT USE THIS FORM FOR PROPOSALS TO DRILL OR TO DEEPEN OR PLUG BACK TO A DIFFERENT RESERVOIR. USE "APPLICATION FOR PERMIT -" (FORM C-101) FOR SUCH PROPOSALS.)

1. OIL WELL <input type="checkbox"/> GAS WELL <input checked="" type="checkbox"/> OTHER <input type="checkbox"/>
2. Name of Operator El Paso Natural Gas Company
3. Address of Operator Box 289, Farmington, New Mexico 87401
4. Location of Well UNIT LETTER <u>E</u> , <u>1830'</u> FEET FROM THE <u>North</u> LINE AND <u>840</u> FEET FROM THE <u>West</u> LINE, SECTION <u>32</u> TOWNSHIP <u>27N</u> RANGE <u>5W</u> NMPM.
15. Elevation (Show whether DF, RT, GR, etc.) 6547' GL

16. Check Appropriate Box To Indicate Nature of Notice, Report or Other Data

NOTICE OF INTENTION TO:	SUBSEQUENT REPORT OF:
PERFORM REMEDIAL WORK <input type="checkbox"/>	REMEDIAL WORK <input type="checkbox"/>
TEMPORARILY ABANDON <input type="checkbox"/>	COMMENCE DRILLING OPNS. <input type="checkbox"/>
PULL OR ALTER CASING <input type="checkbox"/>	CASING TEST AND CEMENT JOBS <input type="checkbox"/>
OTHER <u>PERMIT TO DRILL EXTENSION</u> <input checked="" type="checkbox"/>	OTHER <input type="checkbox"/>
PLUG AND ABANDON <input type="checkbox"/>	ALTERING CASING <input type="checkbox"/>
CHANGE PLANS <input type="checkbox"/>	PLUG AND ABANDONMENT <input type="checkbox"/>

17. Describe Proposed or Completed Operations (Clearly state all pertinent details, and give pertinent dates, including estimated date of starting any proposed work) SEE RULE 1103.

IT IS ANTICIPATED THAT THE "PERMIT TO DRILL" WILL EXPIRE BEFORE THIS WELL CAN
BE SPUDDED; THEREFORE, AN EXTENSION IS REQUESTED.

APPROVAL FOR
FOR 90 DAYS
DRILLING COMPLETION
EXPIRES 9-14-80

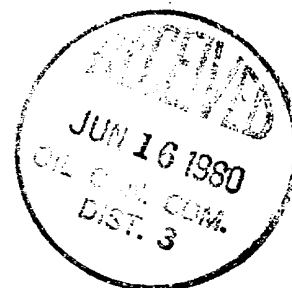

18. I hereby certify that the information above is true and complete to the best of my knowledge and belief.

SIGNED <u>D. G. Lewis</u>	TITLE <u>Drilling Clerk</u>	DATE <u>June 16, 1980</u>
APPROVED BY <u>Signed by FRANK T. CHAVEZ</u>	TITLE <u>SUPERVISOR DISTRICT # 3</u>	DATE <u>JUN 16 1980</u>

CONDITIONS OF APPROVAL, IF ANY: