

NO. OF COPIES RECEIVED	6
DISTRIBUTION	
SANTA FE	1
FILE	1
U.S.G.S.	2
LAND OFFICE	1
OPERATOR	1

NEW MEXICO OIL CONSERVATION COMMISSION

Form C-101
Revised 1-1-65

5A. Indicate Type of Lease
STATE <input checked="" type="checkbox"/> FEE <input type="checkbox"/>
5. State Oil & Gas Lease No.
E-29028

APPLICATION FOR PERMIT TO DRILL, DEEPEN, OR PLUG BACK

1a. Type of Work		7. Unit Agreement Name	
b. Type of Well DRILL <input checked="" type="checkbox"/> DEEPEN <input type="checkbox"/> PLUG BACK <input type="checkbox"/> OIL WELL <input type="checkbox"/> GAS WELL <input checked="" type="checkbox"/> OTHER <input type="checkbox"/> SINGLE ZONE <input checked="" type="checkbox"/> MULTIPLE ZONE <input type="checkbox"/>		Rincon Unit	
2. Name of Operator		8. Farm or Lease Name	
El Paso Natural Gas Company		Rincon Unit	
3. Address of Operator		9. Well No.	
PO Box 289, Farmington, NM 87401		21A	
4. Location of Well UNIT LETTER D LOCATED 1170 FEET FROM THE North LINE AND 845 FEET FROM THE West LINE OF SEC. 16 TWP. 27N RGE. 6W NMPM		10. Field and Pool, or Wildcat	
		Blanco Mesa Verde	
		12. County	
		Rio Arriba	
		19. Proposed Depth	
		5970'	
		19A. Formation	
		Mesa Verde	
		20. Rotary or C.T.	
		Rotary	
21. Elevations (Show whether DF, RT, etc.)		21B. Drilling Contractor	
6646' GR			
21A. Kind & Status Plug. Bond		22. Approx. Date Work will start	
statewide			

23.

PROPOSED CASING AND CEMENT PROGRAM

SIZE OF HOLE	SIZE OF CASING	WEIGHT PER FOOT	SETTING DEPTH	SACKS OF CEMENT	EST. TOP
13 3/4"	9 5/8"	36.0#	200'	224 cu.ft.	circulated
8 3/4"	7"	20.0#	3650'	247 cu.ft.	top Ojo Alamo
6 1/4"	4 1/2"	10.5#	3500-5970'	450 cu.ft.	circ. liner

Selectively perforate and sandwater fracture the Mesa Verde formation.

A 3000 psi WP and 6000 psi test double gate preventer equipped with blind and pipe rams will be used for blow out prevention on this well.

This gas is dedicated.

APPROVAL VALID
FOR 90 DAYS UNLESS
DRILLING COMMENCED,

EXPIRES 6-16-80

The W/2 of Section 16 is dedicated to this well.

IN ABOVE SPACE DESCRIBE PROPOSED PROGRAM: IF PROPOSAL IS TO DEEPEN OR PLUG BACK, GIVE DATA ON PRESENT PRODUCTIVE ZONE, AND PROPOSED NEW PRODUCTIVE ZONE. GIVE BLOWOUT PREVENTER PROGRAM, IF ANY.

I hereby certify that the information above is true and complete to the best of my knowledge and belief.

Signed Frank T. Chavez Title Drilling Clerk Date March 18, 1980

(This space for State Use)

APPROVED BY Original Signed by FRANK T. CHAVEZ TITLE SUPERVISOR DISTRICT # 3 DATE MAR 18 1980

CONDITIONS OF APPROVAL, IF ANY:

All distances must be from the outer boundaries of the Section

Operator EL PASO NATURAL GAS COMPANY			Lease RINCON UNIT (E-290-28)		Well No. 21-A
Unit Letter D	Section 16	Township 27N	Range 6W	County Rio Arriba	
Actual Footage Location of Well: 1170 feet from the North line and 845 feet from the West line					
Ground Level Elev. 6646	Producing Formation Mesa Verde	Pool Blanco Mesa Verde		Dedicated Acreage: 320.00 Acres	

1. Outline the acreage dedicated to the subject well by colored pencil or hachure marks on the plat below.
2. If more than one lease is dedicated to the well, outline each and identify the ownership thereof (both as to working interest and royalty).
3. If more than one lease of different ownership is dedicated to the well, have the interests of all owners been consolidated by communitization, unitization, force-pooling, etc?

☒ Yes ☐ No If answer is "yes," type of consolidation Unitization

If answer is "no," list the owners and tract descriptions which have actually been consolidated. (Use reverse side of this form if necessary.) _____

No allowable will be assigned to the well until all interests have been consolidated (by communitization, unitization, forced-pooling, or otherwise) or until a non-standard unit, eliminating such interests, has been approved by the Commission.

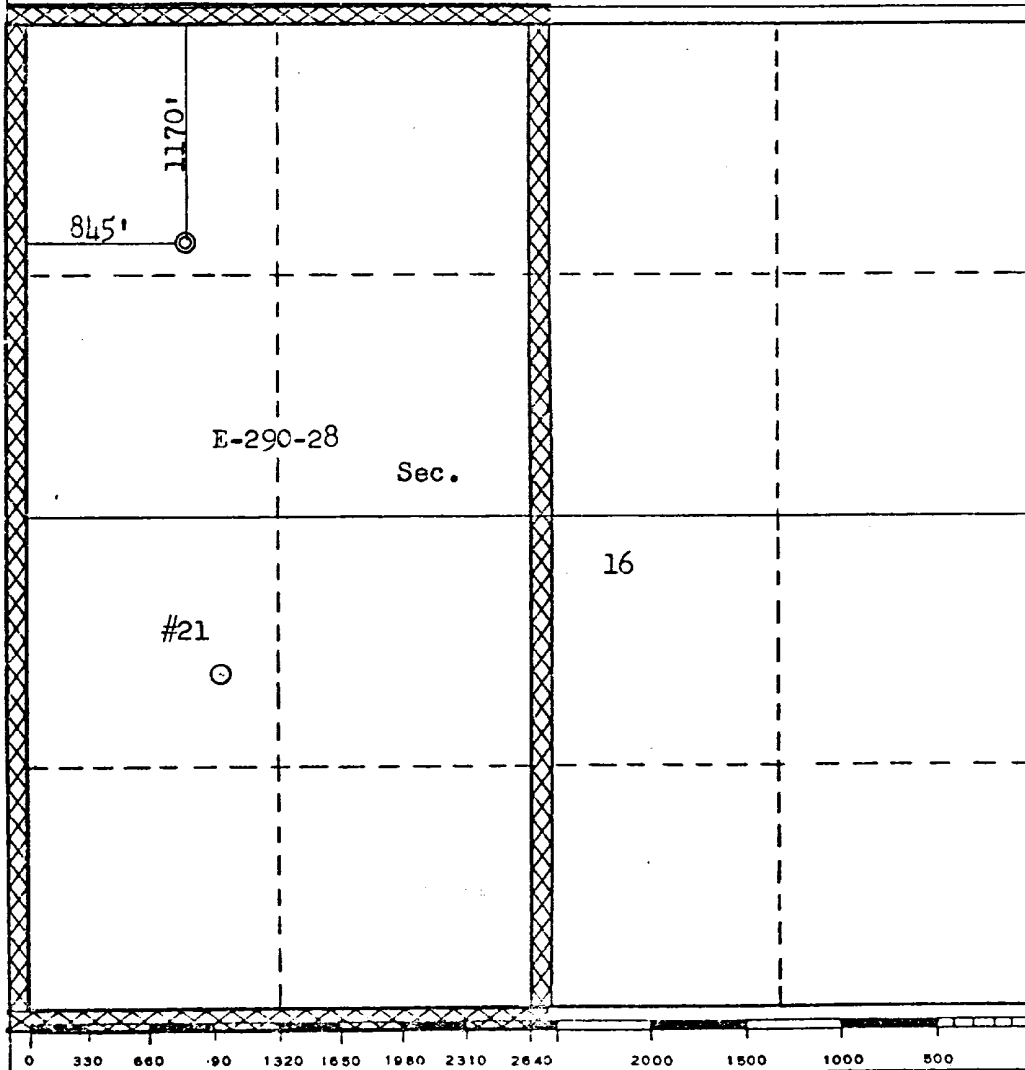

CERTIFICATION

I hereby certify that the information contained herein is true and complete to the best of my knowledge and belief.

[Signature]

Name
Drilling Clerk

Position
El Paso Natural Gas Co.

Company
March 18, 1980

Date

RECEIVED
I hereby certify that the well location shown on this plat was located from field notes of actual surveys made by me or under my supervision, and that the same is true and correct to the best of my knowledge and belief.

Date Surveyed
August 15, 1979

Registered Professional Engineer and/or Land Surveyor

[Signature]
Fred B. Kerr Jr.

Certificate No.
3950

NO. OF COPIES RECEIVED	3
DISTRIBUTION	
SANTA FE	1
FILE	1
U.S.G.S.	
LAND OFFICE	
OPERATOR	1

NEW MEXICO OIL CONSERVATION COMMISSION

Form C-100
Supersedes Old
C-102 and C-103
Effective 1-1-65

3d. Indicate Type of Lease State <input checked="" type="checkbox"/> Fee <input type="checkbox"/>
5. State Oil & Gas Lease No. E-29028
7. Unit Agreement Name Rincon Unit
8. Farm or Lease Name Rincon Unit
9. Well No. 21A
10. Field and Pool, or Wildcat Blanco Mesa Verde
12. County Rio Arriba

SUNDRY NOTICES AND REPORTS ON WELLS <small>(DO NOT USE THIS FORM FOR PROPOSALS TO DRILL OR TO DEEPEN OR PLUG BACK TO A DIFFERENT RESERVOIR. USE "APPLICATION FOR PERMIT -" (FORM C-101) FOR SUCH PROPOSALS.)</small>	
1. OIL WELL <input type="checkbox"/> GAS WELL <input checked="" type="checkbox"/> OTHER <input type="checkbox"/>	
2. Name of Operator El Paso Natural Gas Company	
3. Address of Operator Box 289, Farmington, New Mexico 87401	
4. Location of Well UNIT LETTER <u>D</u> <u>1170</u> FEET FROM THE <u>North</u> LINE AND <u>845</u> FEET FROM <u>West</u> LINE, SECTION <u>16</u> TOWNSHIP <u>27-N</u> RANGE <u>6-W</u> NMPM.	
15. Elevation (Show whether DF, RT, GR, etc.) 6646' GL	

Check Appropriate Box To Indicate Nature of Notice, Report or Other Data

NOTICE OF INTENTION TO:		SUBSEQUENT REPORT OF:	
PERFORM REMEDIAL WORK <input type="checkbox"/>	PLUG AND ABANDON <input type="checkbox"/>	REMEDIAL WORK <input type="checkbox"/>	ALTERING CASING <input type="checkbox"/>
TEMPORARILY ABANDON <input type="checkbox"/>	CHANGE PLANS <input type="checkbox"/>	COMMENCE DRILLING OPNS. <input checked="" type="checkbox"/>	PLUG AND ABANDONMENT <input type="checkbox"/>
PULL OR ALTER CASING <input type="checkbox"/>	OTHER <input type="checkbox"/>	CASING TEST AND CEMENT JOBS <input checked="" type="checkbox"/>	

12. Describe Proposed or Completed Operations (Clearly state all pertinent details, and give pertinent dates, including estimated date of starting any proposed work) SEE RULE 1103.

4-18-80: Spudded well. Drilled surface hole. Ran 5 joints 9 5/8", 36#, KS surface casing 215' set at 228'. Cemented w/224 cu. ft. cement. Circulated to surface. WOC 12 hours;held 600#/30 minutes.



12. I hereby certify that the information above is true and complete to the best of my knowledge and belief.

SIGNED F. T. Chavez TITLE Drilling Clerk DATE April 21, 1980

APPROVED BY Original Signed by FRANK T. CHAVEZ TITLE SUPERVISOR DISTRICT # 3 DATE MAY 1 1980

CONDITIONS OF APPROVAL, IF ANY:

NO. OF COPIES RECEIVED	3
DISTRIBUTION	
SANTA FE	1
FILE	1
U.S.G.S.	
LAND OFFICE	
OPERATOR	1

NEW MEXICO OIL CONSERVATION COMMISSION

Form C-103
Supersedes Old
C-102 and C-103
Effective 1-1-65

5a. Indicate Type of Lease State <input checked="" type="checkbox"/> Fee <input type="checkbox"/>
5. State Oil & Gas Lease No. E-29028
7. Unit Agreement Name Rincon Unit
8. Farm or Lease Name Rincon Unit
9. Well No. 21A
10. Field and Pool, or Wildcat Blanco Mesa Verde
12. County Rio Arriba

SUNDRY NOTICES AND REPORTS ON WELLS
(DO NOT USE THIS FORM FOR PROPOSALS TO DRILL OR TO DEEPEN OR PLUG BACK TO A DIFFERENT RESERVOIR. USE "APPLICATION FOR PERMIT -" (FORM C-101) FOR SUCH PROPOSALS.)

1. OIL WELL <input type="checkbox"/> GAS WELL <input checked="" type="checkbox"/> OTHER <input type="checkbox"/>
2. Name of Operator El Paso Natural Gas Company
3. Address of Operator Box 289, Farmington, New Mexico 87401
4. Location of Well UNIT LETTER <u>D</u> , <u>1170</u> FEET FROM THE <u>North</u> LINE AND <u>845</u> FEET FROM THE <u>West</u> LINE, SECTION <u>16</u> TOWNSHIP <u>27-N</u> RANGE <u>6-W</u> NMPM.
15. Elevation (Show whether DF, RT, GR, etc.) 6646' GL

Check Appropriate Box To Indicate Nature of Notice, Report or Other Data

NOTICE OF INTENTION TO:		SUBSEQUENT REPORT OF:	
PERFORM REMEDIAL WORK <input type="checkbox"/>	PLUG AND ABANDON <input type="checkbox"/>	REMEDIAL WORK <input type="checkbox"/>	ALTERING CASING <input type="checkbox"/>
TEMPORARILY ABANDON <input type="checkbox"/>	CHANGE PLANS <input type="checkbox"/>	COMMENCE DRILLING OPNS. <input checked="" type="checkbox"/>	PLUG AND ABANDONMENT <input type="checkbox"/>
PULL OR ALTER CASING <input type="checkbox"/>	OTHER <input type="checkbox"/>	CASING TEST AND CEMENT JOBS <input checked="" type="checkbox"/>	OTHER <input type="checkbox"/>

17. Describe Proposed or Completed Operations (Clearly state all pertinent details, and give pertinent dates, including estimated date of starting any proposed work) SEE RULE 1103.

4-23-80: TD 3642'. Ran 84 joints 7", 20#, K-55 intermediate casing 3631' set at 3642'. Cemented w/ 247 cu. ft. cement. WOC 12 hours; held 1200#/30 minutes. Top of cement 2300'.

4-28-80: TD 5983'. Ran 79 joints 4 1/2", 10.5#, K-55 casing liner 2483' set 3500-5983'. Float collar set at 5965'. Cemented w/ 431 cu. ft. cement. WOC 18 hours.



18. I hereby certify that the information above is true and complete to the best of my knowledge and belief.

SIGNED D. G. Lises TITLE Drilling Clerk DATE May 1, 1980

APPROVED BY Original Signed by FRANK I. CHAVEZ TITLE SUPERVISOR DISTRICT # 3 DATE MAY 2 1980

CONDITIONS OF APPROVAL, IF ANY:

NO. OF COPIES RECEIVED	
DISTRIBUTION	
SANTA FE	
FILE	
U.S.G.S.	
LAND OFFICE	
OPERATOR	

NEW MEXICO OIL CONSERVATION COMMISSION

Form C-103
Supersedes Old
C-102 and C-103
Effective 1-1-65

5a. Indicate Type of Lease	
State <input checked="" type="checkbox"/>	Fee <input type="checkbox"/>
5. State Oil & Gas Lease No.	
E-290-28	

SUNDRY NOTICES AND REPORTS ON WELLS

(DO NOT USE THIS FORM FOR PROPOSALS TO DRILL OR TO DEEPEN OR PLUG BACK TO A DIFFERENT RESERVOIR.
USE "APPLICATION FOR PERMIT --" (FORM C-101) FOR SUCH PROPOSALS.)

1. OIL WELL <input type="checkbox"/> GAS WELL <input checked="" type="checkbox"/> OTHER <input type="checkbox"/>	7. Unit Agreement Name Rincon Unit
2. Name of Operator El Paso Natural Gas Company	8. Farm or Lease Name Rincon Unit
3. Address of Operator Box 289, Farmington, New Mexico 87401	9. Well No. 21 A
4. Location of Well UNIT LETTER <u>D</u> , <u>1170</u> FEET FROM THE <u>North</u> LINE AND <u>845</u> FEET FROM THE <u>West</u> LINE, SECTION <u>16</u> TOWNSHIP <u>27-N</u> RANGE <u>6-W</u> NMPM.	10. Field and Pool, or Wildcat Blanco Mesa Verde
15. Elevation (Show whether DF, RT, GR, etc.) 6646' GL	12. County R.A.

16. Check Appropriate Box To Indicate Nature of Notice, Report or Other Data

NOTICE OF INTENTION TO:

SUBSEQUENT REPORT OF:

PERFORM REMEDIAL WORK <input type="checkbox"/>	PLUG AND ABANDON <input type="checkbox"/>	REMEDIAL WORK <input type="checkbox"/>	ALTERING CASING <input type="checkbox"/>
TEMPORARILY ABANDON <input type="checkbox"/>	CHANGE PLANS <input type="checkbox"/>	COMMENCE DRILLING OPNS. <input type="checkbox"/>	PLUG AND ABANDONMENT <input type="checkbox"/>
PULL OR ALTER CASING <input type="checkbox"/>	OTHER <input type="checkbox"/>	CASING TEST AND CEMENT JOB <input checked="" type="checkbox"/>	OTHER <u>Perf. & Frac.</u> <input checked="" type="checkbox"/>

17. Describe Proposed or Completed Operations (Clearly state all pertinent details, and give pertinent dates, including estimated date of starting any proposed work) SEE RULE 1103.

6-14-80: PBTB 5965'. Tested casing to 3500#, OK. Perfed Point Lookout 5515,5532,5540, 5558,5561,5565,5568,5572, 5601,5628,5659,5681,5692,5817,5837,5862,5886,5910,5931' W/1 SPZ. Fraced w/ 47,000# 20/40 sand, 94,000 gal. wtr. Flushed w/ 7266 gal. wtr.

Perfed C.H. & Men. 4880,4982,5008,5030,5041,5046,5056,5062, 5078,5083,5088,5097, 5212,5264,5319,5327,5333' W/1 SPZ. Fraced w/ 50,000# 20/ 40 sand, 100,000 gal. wtr. Flushed w/ 6888 gal. wtr.



18. I hereby certify that the information above is true and complete to the best of my knowledge and belief.

SIGNED [Signature] TITLE Drilling Clerk DATE June 16, 1980

APPROVED BY Original Signed by FRANK T. CHAVEZ TITLE SUPERVISOR DISTRICT 3 DATE JUN 19 1980

CONDITIONS OF APPROVAL, IF ANY: