

District I *In Trust*
P.O. Box 1980, Hobbs, NM
DISTRICT I OIL & GAS INSPECTOR
District II
P.O. Drawer 00, Artesia,
NM 88221 JAN 27 1999

State of New Mexico
Energy, Minerals and Natural Resources Dept.

OIL CONSERVATION DIVISION
2040 S. Pacheco
Santa Fe, New Mexico 87504

SUBMIT 1 COPY TO
APPROPRIATE
DISTRICT OFFICE
AND 1 COPY TO
SANTA FE OFFICE

District III
1000 Rio Brazos Rd, Aztec,
NM 87410

PIT REMEDIATION AND CLOSURE REPORT

Operator: Caulkins Oil Company Telephone: (505) 632-1544
Address: P.O. Box 340, Bloomfield, NM 87413
Facility or Well Name: Breech "F" 4-M
Location: Unit or Qtr/Qtr I Sec 33 T 27N R 6W County Rio Arriba
Pit Type: Separator X Dehydrator Other
Land Type: BLM X, State , Fee , Other

Pit Location: Pit dimensions: length 27', width 27', depth 12'
(Attach diagram)
References: wellhead X, other
Footage from reference: 186'
Direction from reference: 37 Degrees X East North X
of
 West South

Depth to Ground Water: (Vertical distance from contaminants to seasonal high water elevation of ground water)	Less than 50 feet	(20 points)	
	50 feet to 99 feet	(10 points)	
	Greater than 100 feet	(0 points)	<u>0</u>

Wellhead Protection Area: (Less than 200 feet from a private domestic water source, or; less than 1000 feet from all other water sources)	Yes	(20 points)	
	No	(0 points)	<u>0</u>

Distance to Surface Water: (Horizontal distance to perennial lakes, ponds, rivers, streams, creeks, irrigation canals and ditches)	Less than 200 feet	(20 points)	
	200 feet to 1000 feet	(10 points)	
	Greater than 1000 feet	(0 points)	<u>0</u>

RANKING SCORE (TOTAL POINTS): 0

Date Remediation Started: 4-97 Date Completed: 9-15-97

Remediation Method: Excavation X Approx. cubic yards 324
Check all appropriate sections) Landfarmed X Insitu Bioremediation ____
Other _____

Remediation Location: Onsite X Offsite _____
(ie. landfarmed onsite,
name and location of
offsite facility) _____

General Description of Remedial Action: Aeration and Dilution

Ground Water Encountered: No X Yes ____ Depth _____

Final Pit: Sample Location Bottom of pit and landfarm
Closure Sampling: _____
(if multiple samples,
attach sample results
and diagram of sample
Sample depth 14'
Sample date 8-13-97 Sample time 12:30 p.m.
Benzene (ppm) _____
Total BTEX (ppm) ND
Field headspace (ppm) _____
TPH Landfarm: 357.3 ppm Pit 14.8 ppm

Ground Water Sample: Yes ____ No X (If yes, attach sample results)

I HEREBY CERTIFY THAT THE INFORMATION ABOVE IS TRUE AND COMPLETE TO THE BEST OF MY KNOWLEDGE AND BELIEF.

DATE October 6, 1998

SIGNATURE Robert L. Verquer PRINTED NAME
AND TITLE ROBERT L. VERQUER, SUPERINTENDENT

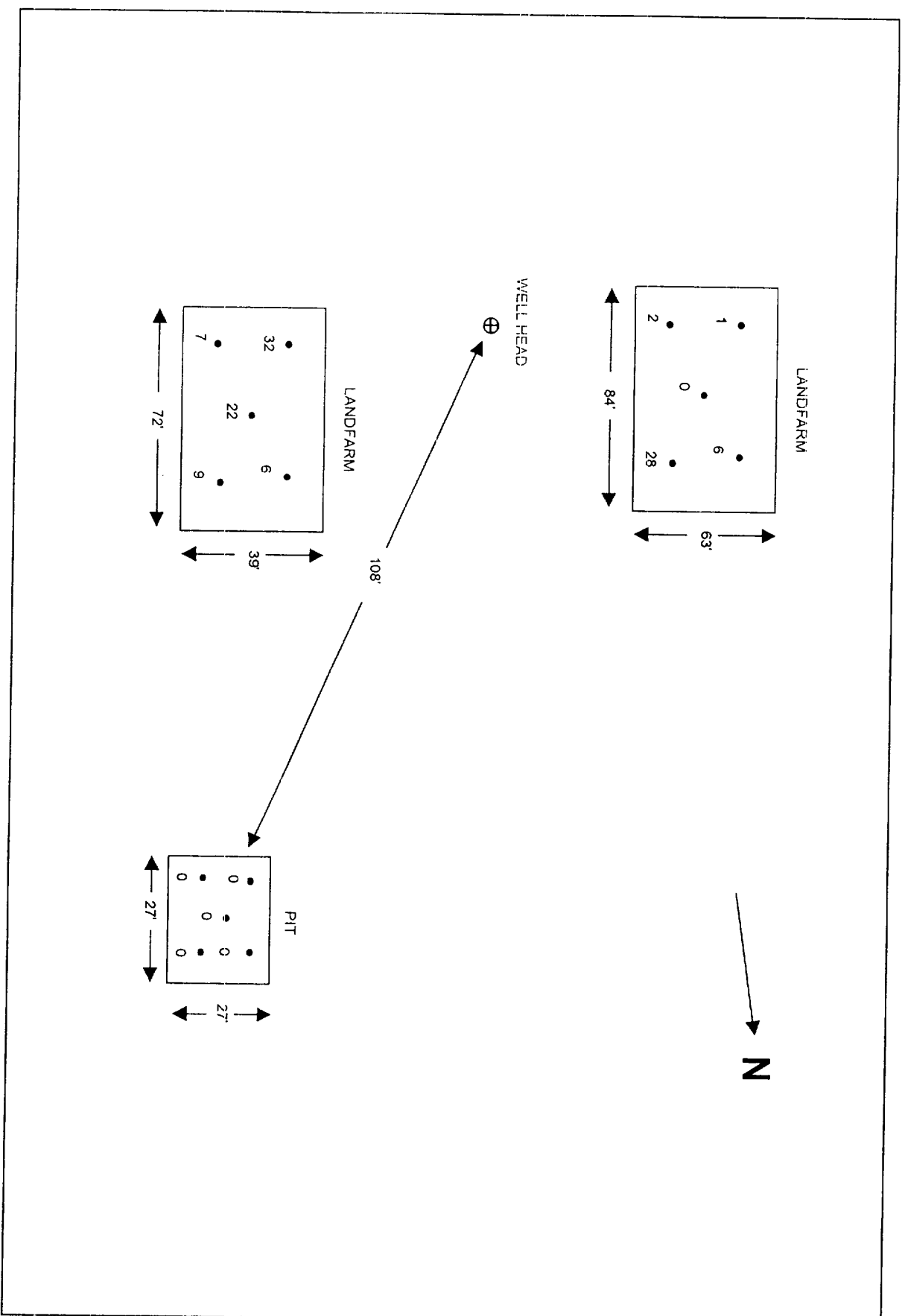

ANAITAS ENVIRONMENTAL LABS
Operated under contract by:
CDS Laboratories
75 Suttle Street
PO Box 2605
Durango, CO 81302

Phone: (970)-247-4220
Fax : (970)-247-4227

Report Date: 09/17/97

ANALYSIS REPORT

Attn:

CAULKINS OIL CO
PO BOX 340
BLOOMFIELD, NM 87413

Our Lab #: A97-133164 (7642)
Sample ID: BREECH F 4M (LAND FARM)
Date Login: 08/19/97
Date Rec'd: 08/18/97

COLLECTION INFORMATION

Date/Time/By: 08/13/97 1230
Location:

Lab#	Testname	Result	Units
A97-133164	BENZENE	0.193	ppm
	ETHYL BENZENE	< 0.125	ppm
	TOLUENE	< 0.125	ppm
	XYLENE (TOTAL)	< 0.250	ppm
	Diesel Range Organics	346	ppm
	Gasoline Range Organics	11.3	ppm

Approved By: Cynthia Mer Checked By: DZ

ANAITAS ENVIRONMENTAL LABS
Operated under contract by:
CDS Laboratories
75 Suttle Street
PO Box 2605
Durango, CO 81302

Phone: (970)-247-4220
Fax : (970)-247-4227

Report Date: 09/17/97

ANALYSIS REPORT

Attn:

CAULKINS OIL CO
PO BOX 340
BLOOMFIELD, NM 87413

Our Lab #: A97-133165 (7642)
Sample ID: BREECH F 4M (PIT BOTTOM)
Date Login: 08/19/97
Date Rec'd: 08/18/97

COLLECTION INFORMATION

Date/Time/By: 08/13/97 1230
Location:

Lab#	Testname	Result	Units
A97-133165	BENZENE	0.155	ppm
	ETHYL BENZENE	< 0.125	ppm
	TOLUENE	< 0.125	ppm
	XYLENE (TOTAL)	< 0.250	ppm
	Diesel Range Organics	4	ppm
	Gasoline Range Organics	10.8	ppm

Approved By:

Cynthia Prew

Checked By:

DZ

WELL NAME: Breech F 4-M

CAULKINS OIL
SITE SECURITY DIAGRAM

