

UNITED STATES  
DEPARTMENT OF THE INTERIOR  
GEOLOGICAL SURVEY

## SUNDRY NOTICES AND REPORTS ON WELLS

(Do not use this form for proposals to drill or to deepen or plug back to a different reservoir. Use Form 9-331-C for such proposals.)

1. oil ☐ well gas ☒ well other ☐
2. NAME OF OPERATOR  
Mobil Producing TX. & N.M. Inc.
3. ADDRESS OF OPERATOR 77046  
9 Greenway Plaza, Suite 2700, Houston, TX
4. LOCATION OF WELL (REPORT LOCATION CLEARLY. See space 17 below.)  
AT SURFACE: 790' FNL & 890' FWL, Sec. 24, T27N,  
AT TOP PROD. INTERVAL: Same as surface R3W  
AT TOTAL DEPTH: Same as surface

16. CHECK APPROPRIATE BOX TO INDICATE NATURE OF NOTICE,  
REPORT, OR OTHER DATA

REQUEST FOR APPROVAL TO:	SUBSEQUENT REPORT OF:
TEST WATER SHUT-OFF <input type="checkbox"/>	<input type="checkbox"/>
FRACTURE TREAT <input type="checkbox"/>	<input type="checkbox"/>
SHOOT OR ACIDIZE <input type="checkbox"/>	<input type="checkbox"/>
REPAIR WELL <input type="checkbox"/>	<input type="checkbox"/>
PULL OR ALTER CASING <input type="checkbox"/>	<input type="checkbox"/>
MULTIPLE COMPLETE <input type="checkbox"/>	<input type="checkbox"/>
CHANGE ZONES <input type="checkbox"/>	<input type="checkbox"/>
ABANDON* <input type="checkbox"/>	<input type="checkbox"/>
(other) <input type="checkbox"/> Change well number	

17. DESCRIBE PROPOSED OR COMPLETED OPERATIONS (Clearly state all pertinent details, and give pertinent dates, including estimated date of starting any proposed work. If well is directionally drilled, give subsurface locations and measured and true vertical depths for all markers and zones pertinent to this work.)\*

This Sundry Notice is being submitted to change the acreage dedicated to the subject well from the W/2 of Sec. 24 to the N/2 of Sec. 24. Since this well is no longer on acreage dedicated to Well #7, the well number is being changed from 7A to 8.

Subsurface Safety Valve: Manu. and Type \_\_\_\_\_ Set @ \_\_\_\_\_ Ft.

18. I hereby certify that the foregoing is true and correct

SIGNED J.A. Morris TITLE Regulatory Engineering Supervisor DATE March 1, 1982

(This space for Federal or State office use)

APPROVED BY \_\_\_\_\_ TITLE \_\_\_\_\_ DATE \_\_\_\_\_  
CONDITIONS OF APPROVAL, IF ANY:

NMOCC

\*See Instructions on Reverse Side

5. LEASE

6. IF INDIAN, ALLOTTEE OR TRIBE NAME

Jicarilla Contract #94

7. UNIT AGREEMENT NAME

8. FARM OR LEASE NAME

Jicarilla F

9. WELL NO.

8

10. FIELD OR WILDCAT NAME

Blanco Mesa Verde Gas

11. SEC., T., R., M., OR BLK. AND SURVEY OR AREA

Sec. 24, T27N, R3W

12. COUNTY OR PARISH 13. STATE

Rio Arriba

New Mexico

14. API NO.

15. ELEVATIONS (SHOW DF, KDB, AND WD)  
7075'-GR

(NOTE: Report results of multiple completion or zone change on Form 9-330.)

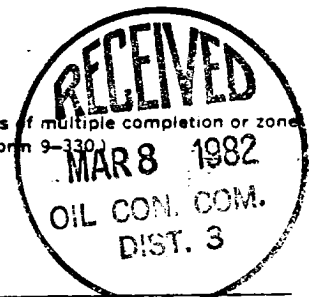

ACCEPTED FOR RECORD

MAR 05 1982

FARMINGTON DISTRICT

BY ELS

## Instructions

**General:** This form is designed for submitting proposals to perform certain well operations, and reports of such operations when completed, as indicated, on Federal and Indian lands pursuant to applicable Federal law and regulations, and, if approved or accepted by any State, on all lands in such State, pursuant to applicable State law and regulations. Any necessary special instructions concerning the use of this form and the number of copies to be submitted, particularly with regard to local, area, or regional procedures and practices, either are shown below or will be issued by, or may be obtained from, the local Federal and/or State office.

**Item 4:** If there are no applicable State requirements, locations on Federal or Indian land should be described in accordance with Federal requirements. Consult local State or Federal office for specific instructions.

**Item 17:** Proposals to abandon a well and subsequent reports of abandonment should include such special information as is required by local Federal and/or State offices. In addition, such proposals and reports should include reasons for the abandonment; data on any former or present productive zones, or other zones with present significant fluid contents not sealed off by cement or otherwise; depths (top and bottom) and method of placement of cement plugs; mud or other material placed below, between and above plugs; amount, size, method of parting of any casing, liner or tubing pulled and the depth to top of any left in the hole; method of closing top of well; and date well site conditioned for final inspection looking to approval of the abandonment.

**NEW MEXICO OIL CONSERVATION COMMISSION  
WELL LOCATION AND ACREAGE DEDICATION PLAT**

Form O-102  
Supersedes O-128  
Effective 1-1-65

All distances must be from the outer boundaries of the Section

Operator <b>Mobil Producing TX. &amp; N.M. Inc.</b>			Lease <b>Jicarilla F</b>		Well No. <b>8</b>
Unit Letter <b>D</b>	Section <b>24</b>	Township <b>27 N</b>	Range <b>3W</b>	County <b>Rio Arriba</b>	
Actual Footage Location of Well: <b>790</b> feet from the <b>North</b> line and <b>890</b> feet from the <b>West</b> line					
Ground Level Elev. <b>7075</b>	Producing Formation <b>Mesaverde</b>		Pool <b>Blanco Mesaverde</b>		Dedicates Acreage: <b>320</b> Acres

1. Outline the acreage dedicated to the subject well by colored pencil or hachure marks on the plat below.
2. If more than one lease is dedicated to the well, outline each and identify the ownership thereof (both as to working interest and royalty).
3. If more than one lease of different ownership is dedicated to the well, have the interests of all owners been consolidated by communitization, unitization, force-pooling, etc?

☐ Yes ☐ No If answer is "yes," type of consolidation \_\_\_\_\_

If answer is "no," list the owners and tract descriptions which have actually been consolidated (Use reverse side of this form if necessary.) \_\_\_\_\_

No allowable will be assigned to the well until all interests have been consolidated (by communitization, unitization, forced-pooling, or otherwise) or until a non-standard unit, eliminating such interests, has been approved by the Commission.

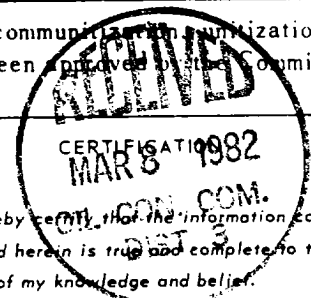
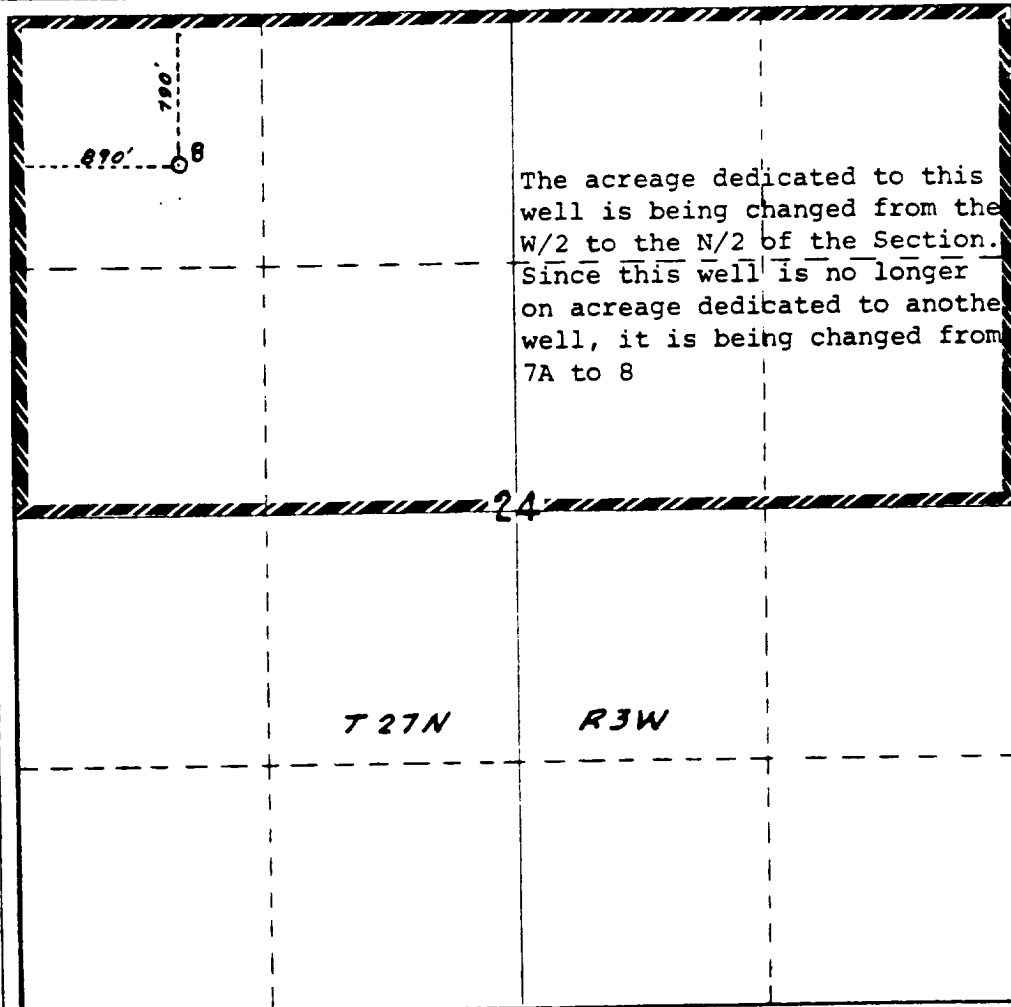

I hereby certify that the information contained herein is true and complete to the best of my knowledge and belief.

*J.A. Morris*  
Name

**J.A. Morris**  
Position **Regulatory Engineering Supervisor**  
Company

**Mobil Producing TX. & N.M. Inc.**

Date  
**March 1, 1982**

I hereby certify that the well location shown on this plat was plotted from field notes of actual surveys made by me or under my supervision, and that the same is true and correct to the best of my knowledge and belief.

Date Surveyed

Registered Professional Engineer and/or Land Surveyor

Certificate No.

NEW MEXICO OIL CONSERVATION COMMISSION  
WELL LOCATION AND ACREAGE DEDICATION PLAT

Form D-101  
Supersedes C-128  
Effective 1-1-65

All distances must be from the outer boundaries of the Section

Operator <b>Mobil Producing TX. &amp; N.M. Inc.</b>		Lease <b>Jicarilla F</b>		Well No. <b>7</b>
Unit Letter <b>M</b>	Section <b>24</b>	Township <b>27N</b>	Range <b>3W</b>	County <b>Rio Arriba</b>
Actual Footage Location of Well: <b>990</b> feet from the <b>South</b> line and <b>990</b> feet from the <b>West</b> line				
Ground Level Elev. <b>7185'</b>	Producing Formation <b>Mesaverde</b>	Pool <b>Blanco Mesaverde</b>	Dedicated Acreage: <b>320</b> Acres	

1. Outline the acreage dedicated to the subject well by colored pencil or hachure marks on the plat below.
2. If more than one lease is dedicated to the well, outline each and identify the ownership thereof (both as to working interest and royalty).
3. If more than one lease of different ownership is dedicated to the well, have the interests of all owners been consolidated by communitization, unitization, force-pooling, etc?

☐ Yes ☐ No If answer is "yes," type of consolidation: \_\_\_\_\_

If answer is "no," list the owners and tract descriptions which have actually been consolidated. (Use reverse side of this form if necessary.) \_\_\_\_\_

No allowable will be assigned to the well until all interests have been consolidated (by communitization, unitization, forced-pooling, or otherwise) or until a non-standard unit, eliminating such interests, has been approved by the Commission.

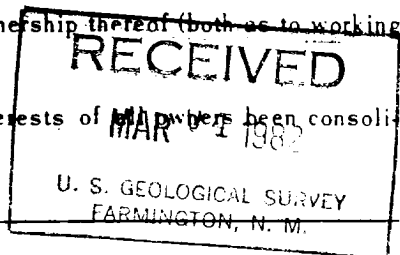

The acreage dedicated to this well is being changed from the W/2 of the Section to the S/2

T 27 N

R 3 W

24

990'  
990'

7

CERTIFICATION

I hereby certify that the information contained herein is true and complete to the best of my knowledge and belief.

*J.A. Morris*

Name

J.A. Morris

Position Regulatory

Engineering Supervisor

Company

Mobil Producing TX. & N.M. Inc.

Date

March 1, 1982

I hereby certify that the well location shown on this plat was plotted from field notes of actual surveys made by me or under my supervision, and that the same is true and correct to the best of my knowledge and belief.

Date Surveyed

Registered Professional Engineer and/or Land Surveyor

Certificate No.

0 330 660 990 1320 1650 1980 2310 2640 2000 1500 1000 500 0