

**OIL CONSERVATION DIVISION**  
P.O. Box 2088  
Santa Fe, New Mexico 87504-2088

**Submit original and 4 copies to the  
concerned district office.**

**APPLICATION FOR APPROVAL TO USE AN ALTERNATE GAS MEASUREMENT METHOD**  
Rule 403.B(1) or (2)

Operator Name: Curtis J. Little Operator No. 5493  
Operator Address: P.O. Box 1258 Farmington, NM 87499-1258  
Lease Name: Foster #2 Type: State        Federal X Fed         
Location: M - 17 - 26N - 7W  
Pool: Blanco PC South  
Requested Effective Time Period: Beginning August 1, 1995 Ending Indefinitely

**APPROVAL PROCEDURE: RULE 403.B.(1).**

- 1) A list of the wells (including well name, number, ULSTR location, and API No.) included in this application.
- 2) A one year production history of each well included in this application (showing the annual and daily volumes).
- 3) The established or agreed-upon daily producing rate for each well and the effective time period.
- 4) Designate wells to be equipped with a flow device (required for wells capable of producing 5 MCF per day or more).
- 5) The gas transporter(s) connected to each well.

RECEIVED  
MAR 21 1993

**APPROVAL PROCEDURE: RULE 403.B.(2)**

**A separate application is required for each Central Point Delivery (CPD).**

- 1) An ownership plat showing a description of the lease and all of the wells to be produced through this CPD.
  - a) List the wells which will be metered separately, including API No.
  - b) List the wells which will not be metered separately, including API No.
- 2) Describe the proposed method of allocating production from non-metered wells.
- 3) A one year production history of the wells which will not be metered showing the annual and daily volumes.
- 4) The gas transporter(s) connected to this CPD.

**Applicant will be responsible for filing OCD Form C-111 for the CPD.**

**OPERATOR**

I hereby certify that the rules and regulations of the Oil Conservation Division have been complied with and that the information given above is true and complete to the best of my knowledge and belief.

**Signatures:**

**OIL CONSERVATION DIVISION**

This approval may be cancelled at anytime that operating conditions indicate that re-tests may be necessary to prevent waste and protect correlative results.

Approved Until: \_\_\_\_\_ Further Notice

Br. ORIGINAL SIGNED BY ERNIE BUSCH

Title: DEPUTY OIL & GAS INSPECTOR, DIST. #3

EPNG Meter # 94300  
 Well Foster  
 No. 2  
 API # 30-039-70015  
 Location M 17 26N 7W  
 Pool Name Blanco PC South  
 Type of Lease Federal  
 Transporter El Paso Natural Gas Co.

Meter	Runs Date	Well Name	Prod. MCF @ 15.025	Days Produced	Avg Daily MCF
94300	Jul-94	Foster #2	559	31	18
94300	Aug-94	Foster #2	420	31	14
94300	Sep-94	Foster #2	287	30	10
94300	Oct-94	Foster #2	489	31	16
94300	Nov-94	Foster #2	456	30	15
94300	Dec-94	Foster #2	398	31	13
94300	Jan-95	Foster #2	447	31	14
94300	Feb-94	Foster #2	377	28	13
94300	Mar-94	Foster #2	398	31	13
94300	Apr-94	Foster #2	420	30	14
94300	May-94	Foster #2	431	31	14
94300	Jun-95	Foster #2	380	30	13

# TIME CALCULATED VOLUME

## ALTERNATIVE METHOD SCHEMATIC

PRIMARY ELEMENT AND DIFFERENTIAL SWITCH/HOUR METER  
USED FOR FLOW TIME DETECTION AND ANNUAL TEST

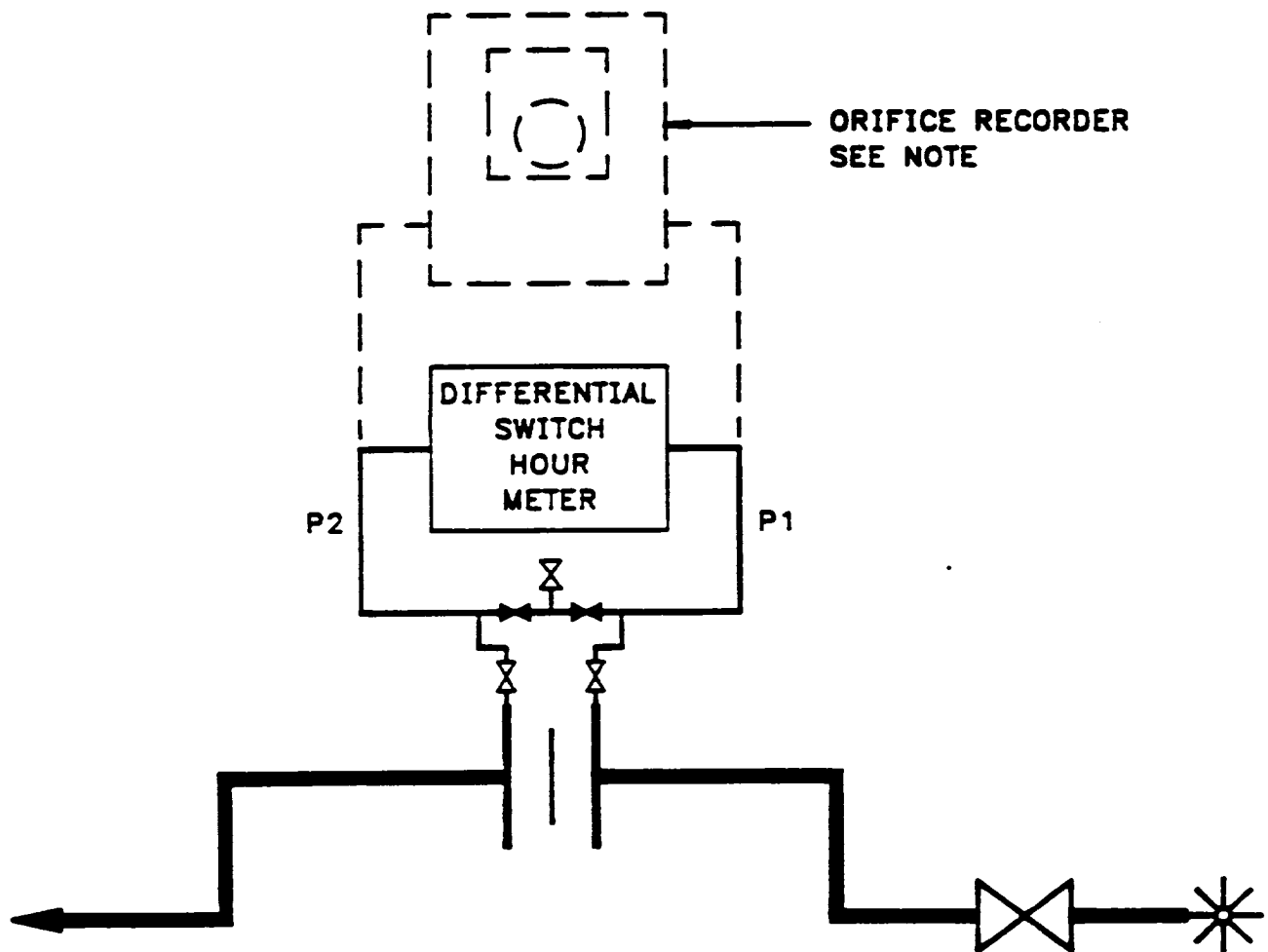

NOTE:  
ORIFICE RECORDER TEMPORARILY INSTALLED  
ONLY TO CONDUCT 16 DAY ANNUAL TEST

### "Time Calculated Volume" Formula

a. Flow Meter Hours X Average MCF Hourly Flow Rate = Volume (MCF)  
Volume (MCF) X BTU Factor = MMBTU (dth) for Period Indicated

b. Example: 1971 (Hours) X .31 (MCF) = 611 MCF  
611 MCF X 1097 BTU = 670 MMBTU (dth) for the Period Indicated



All distances must be from the outer boundaries of the Section.

Operator <b>CURTIS J. LITTLE</b>			Lease <b>FOSTER</b>		Well No. <b>2</b>
Unit Letter <b>M</b>	Section <b>17</b>	Township <b>26N</b>	Range <b>7W</b>	County <b>Rio Arriba</b>	
Actual Footage Location of Well: <b>860</b> feet from the <b>South</b> line and <b>790</b> feet from the <b>West</b> line					
Ground Level Elev. <b>6223</b>	Producing Formation <b>Pictured Cliffs</b>		Pool <b>Blanco PC, South Ext.</b>		Dedicated Acreage: <b>160</b> Acres

1. Outline the acreage dedicated to the subject well by colored pencil or hachure marks on the plat below.
2. If more than one lease is dedicated to the well, outline each and identify the ownership thereof (both as to working interest and royalty).
3. If more than one lease of different ownership is dedicated to the well, have the interests of all owners been consolidated by communitization, unitization, force-pooling, etc?

☒ Yes ☐ No If answer is "yes," type of consolidation \_\_\_\_\_

If answer is "no," list the owners and tract descriptions which have actually been consolidated. (Use reverse side of this form if necessary.) \_\_\_\_\_

No allowable will be assigned to the well until all interests have been consolidated (by communitization, unitization, forced-pooling, or otherwise) or until a non-standard unit, eliminating such interests, has been approved by the Commission.

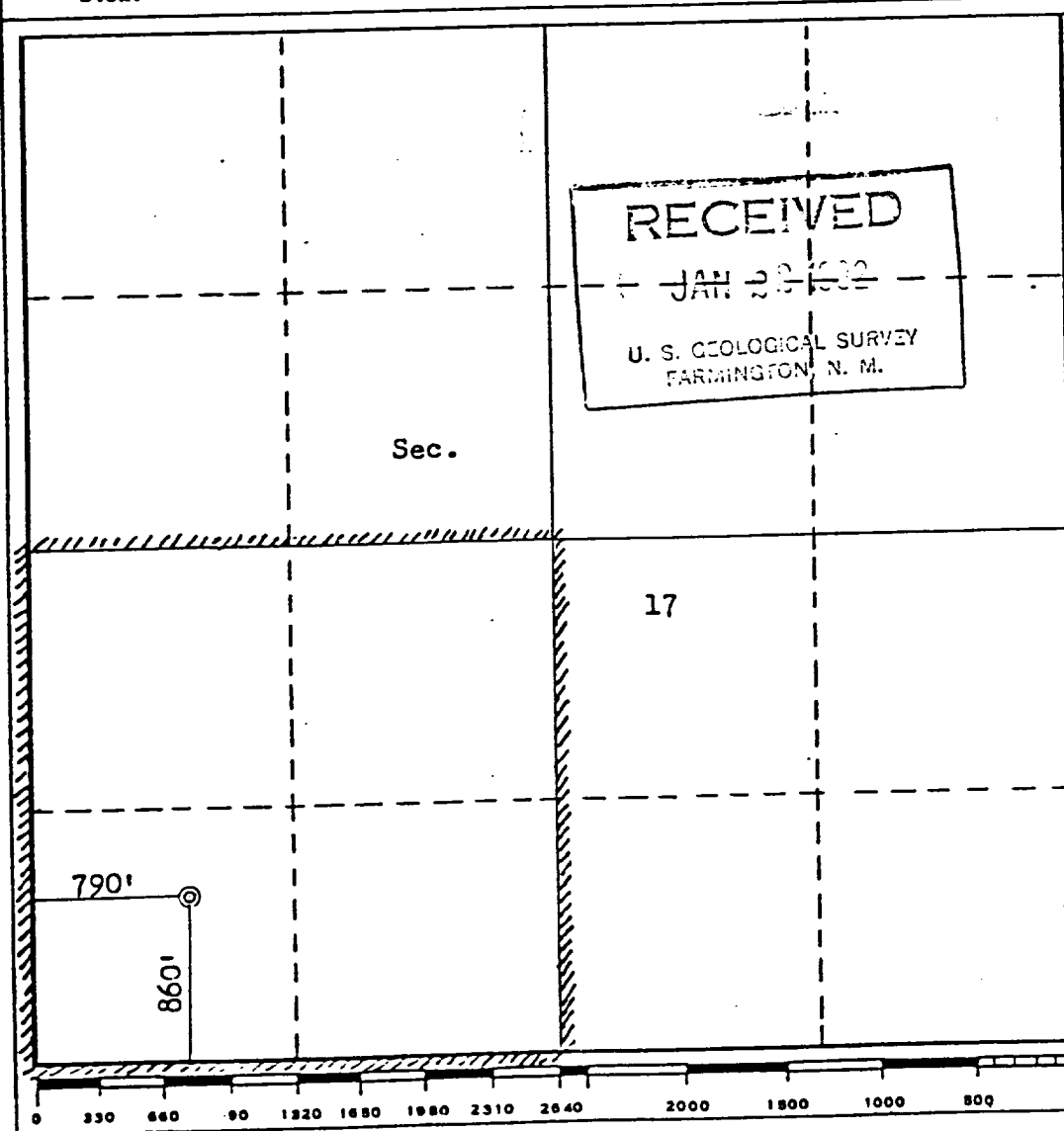

#### CERTIFICATION

I hereby certify that the information contained herein is true and complete to the best of my knowledge and belief.

*Curtis J. Little*  
Name

Curtis J. Little

Position  
Operator

Company  
Curtis J. Little

Date  
December 7, 1981

I hereby certify that the well location shown on this plat was plotted from field notes of actual surveys made by me or under my supervision, and that the same is true and correct to the best of my knowledge and belief.

Date Surveyed

December 10, 1981

Registered Professional Engineer and/or Land Surveyor

*Fred B. Kerr Jr.*  
Fred B. Kerr Jr.

Certificate No.

3950

F. B. KERR, JR.