

UNITED STATES
DEPARTMENT OF THE INTERIOR
BUREAU OF LAND MANAGEMENT

APPLICATION FOR PERMIT TO DRILL, DEEPEN, OR PLUG BACK

1a. TYPE OF WORK DRILL <input checked="" type="checkbox"/> DEEPEN <input type="checkbox"/> PLUG BACK <input type="checkbox"/>		7. UNIT AGREEMENT NAME Rincon Unit		
b. TYPE OF WELL OIL WELL <input type="checkbox"/> GAS WELL <input checked="" type="checkbox"/> OTHER <input type="checkbox"/>		8. FARM OR LEASE NAME Rincon Unit		
2. NAME OF OPERATOR Union Oil Company of California		9. WELL NO. 258		
3. ADDRESS OF OPERATOR 1004 N. Big Spring St. #635, Midland, TX 79701-3340		10. FIELD AND POOL, OR WILDCAT Basin Fruitland Coal		
4. LOCATION OF WELL (Report location clearly and in accordance with any State requirements.) At surface 1505' FNL and 915' FEL, Sec 17, T27N, R6W At proposed prod. zone Same		11. SEC., T., R., M., OR BLK. AND SURVEY OR AREA Sec 17, T27N, R6W		
14. DISTANCE IN MILES AND DIRECTION FROM NEAREST TOWN OR POST OFFICE* Approximately 40 miles southeast of Bloomfield, N.M.		12. COUNTY OR PARISH Rio Arriba		
13. DISTANCE FROM PROPOSED* LOCATION TO NEAREST PROPERTY OR LEASE LINE, FT. (Also to nearest drig. unit line, if any) 915'		13. STATE N.M.		
18. NO. OF ACRES IN LEASE 600		17. NO. OF ACRES ASSIGNED TO THIS WELL E/320		
19. PROPOSED DEPTH 3224'		20. ROTARY OR CABLE TOOLS Rotary		
21. ELEVATIONS (Show whether DF, RT, GR, etc.) 6514' GL		22. APPROX. DATE WORK WILL START* ASAP		
23. PROPOSED CASING AND CEMENTING PROGRAM This action is subject to technical and procedural review pursuant to 43 CFR 3185.3 and appeal pursuant to 43 CFR 3185.4				
SIZE OF HOLE	SIZE OF CASING	WEIGHT PER FOOT	SETTING DEPTH	QUANTITY OF CEMENT
12-1/4"	8-5/8"	24 #	225'	175 sacks to surface
7-7/8"	5-1/2"	17 #	3224'	410 sacks to surface

Proposed Drilling Program

MIRU. Drill 12-1/4" hole with spud mud to 225'. Survey. Rig up and run casing and cement as outlined in attached drilling plan. WOC @ 18 hours. NUBOP, choke, and kill line (2000#) and test same plus casing. Drill out with 7-7/8" hole from 225' to T.D. with fresh water mud. Run surveys @ 500' intervals or first bit trip succeeding 500'. At T.D. log with DISFL, GR, SP, FDC, CNL-GR. Run and cement casing as outlined in attached drilling plan. RDMOL

RECEIVED

FEB 20 1990

OIL CON. DIV.

DIST. 3

IN ABOVE SPACE DESCRIBE PROPOSED PROGRAM: If proposal is to drill or deepen directionally, give pertinent data on present productive zone and proposed new productive zone. If proposal is to drill or deepen directionally, give pertinent data on present productive zone and proposed new productive zone. Give blowout preventer program, if any.

24. SIGNED Chris Russell TITLE Agent for UNOCAL DATE 10/27/89

(This space for Federal or State office use)

PERMIT NO. _____ APPROVAL DATE _____

APPROVED BY _____ TITLE _____

CONDITIONS OF APPROVAL, IF ANY:

NMOCD

APPROVED
AS AMENDED

FEB 14 1990

AREA MANAGER

*See Instructions On Reverse Side

Submit to Appropriate
District Office
State Lease - 4 copies
Fee Lease - 3 copies

State of New Mexico
Energy, Minerals and Natural Resources Department

Form C-102
Revised 1-1-89

OIL CONSERVATION DIVISION

P.O. Box 2088
Santa Fe, New Mexico 87504-2088

DISTRICT I

P.O. Box 1980, Hobbs, NM 88240

DISTRICT II

P.O. Drawer DD, Artesia, NM 88210

DISTRICT III

1000 Rio Brazos Rd., Aztec, NM 87410

WELL LOCATION AND ACREAGE DEDICATION PLAT

All Distances must be from the outer boundaries of the section

Operator Unocal, Inc.			Lease Rincon		Well No. Unit #258	
Unit Letter H	Section 17	Township T.27 N.	Range R.6 W.	County Rio Arriba	NMPM	
Actual Footage Location of Well: 1505' feet from the North line and 915' feet from the East line						
Ground level Elev. 6514'	Producing Formation Fruitland Coal		Pool Basin Fruitland Coal		Dedicated Acreage: 320 Acres	

1. Outline the acreage dedicated to the subject well by colored pencil or hatchure marks on the plat below.
2. If more than one lease is dedicated to the well, outline each and identify the ownership thereof (both as to working interest and royalty).
3. If more than one lease of different ownership is dedicated to the well, have the interest of all owners been consolidated by communitization, unitization, force-pooling, etc.?
☒ Yes ☐ No If answer is "yes" type of consolidation Unitization
If answer is "no" list the owners and tract descriptions which have actually been consolidated. (Use reverse side of this form if necessary.)
No allowable will be assigned to the well until all interests have been consolidated (by communitization, unitization, forced-pooling, or otherwise) or until a non-standard unit, eliminating such interest, has been approved by the Division.

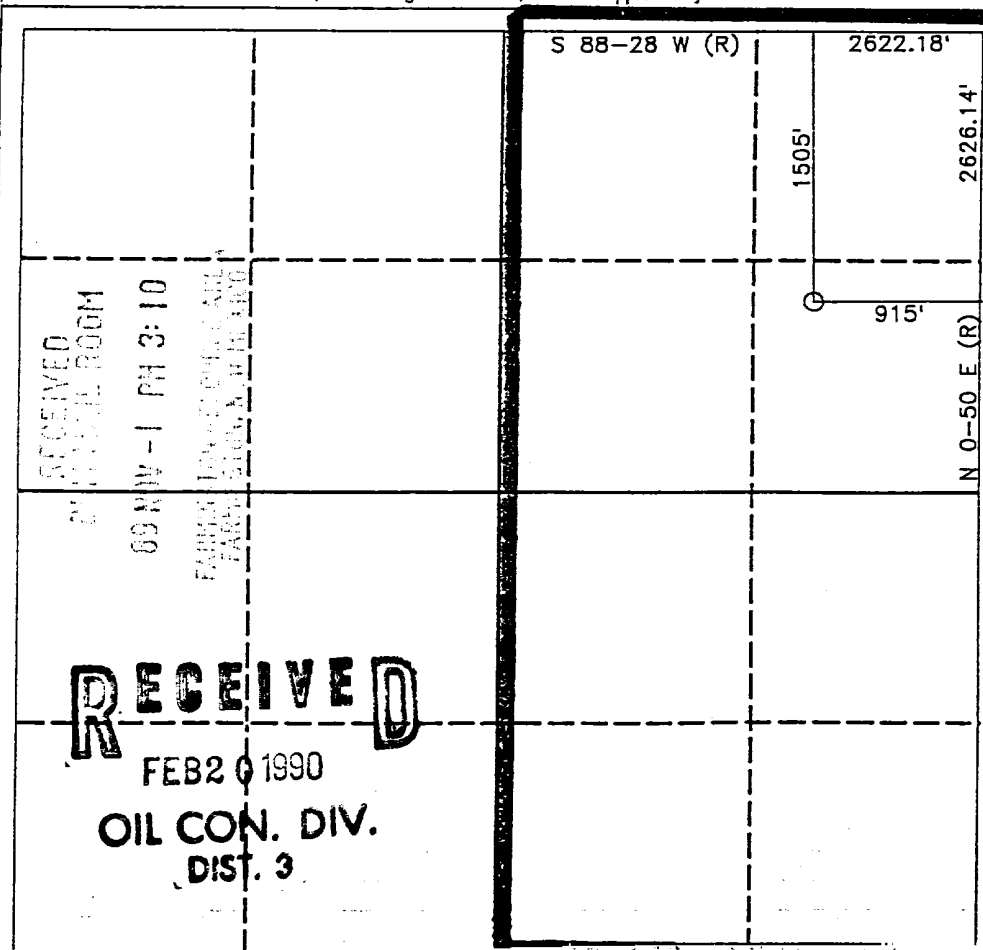

OPERATOR CERTIFICATION

I hereby certify that the information contained herein is true and complete to the best of my knowledge and belief.

Signature
Chris Russell
Printed Name
Agent
Position
UNOCAL
Company
10/27/89
Date

SURVEYOR CERTIFICATION

I hereby certify that the well location shown on this plat was plotted from field notes of actual surveys made by me or under my supervision, and that the same is true and correct to the best of my knowledge and belief.

Date Surveyed
10-28-89
Signature of Seal of Professional Surveyor of Mexico
R. Howard Baggett
9879
Certificate No.
9879
Registered Professional Land Surveyor