

Submit to Appropriate
District Office
State Lease - 4 copies
Fee Lease - 3 copies

DISTRICT I
P.O. Box 1980, Hobbs, NM 88240

DISTRICT II
P.O. Drawer DD, Artesia, NM 88210

DISTRICT III
1000 Rio Brazos Rd., Aztec, NM 87410

State of New Mexico
Energy, Minerals and Natural Resources Department

OIL CONSERVATION DIVISION

P.O. Box 2088
Santa Fe, New Mexico 87504-2088

WELL LOCATION AND ACREAGE DEDICATION PLAT
All Distances must be from the outer boundaries of the section

acreage from w/2
40 1/2
RECEIVED
MAIL ROOM
50 MAR -5 AM 8:05
FARMINGTON, NEW MEXICO

Operator Unocal, Inc.		Lease Rincon		Well No. Unit #255	
Unit Letter N	Section 20	Township T.27 N.	Range R.6 W.	County NMPM	Rio Arriba
Actual Footage Location of Well: 1185 feet from the South line and 1840 feet from the West line					
Ground level Elev. 6475'	Producing Formation Fruitland Coal		Pool Fruitland Coal	Dedicated Acreage: 320 Acres	

- Outline the acreage dedicated to the subject well by colored pencil or hachure marks on the plat below.
- If more than one lease is dedicated to the well, outline each and identify the ownership thereof (both as to working interest and royalty).
- If more than one lease of different ownership is dedicated to the well, have the interest of all owners been consolidated by communitization, unitization, force-pooling, etc.?
☐ Yes ☐ No If answer is "yes" type of consolidation _____
If answer is "no" list the owners and tract descriptions which have actually been consolidated. (Use reverse side of this form if necessary).
No allowable will be assigned to the well until all interests have been consolidated (by communitization, unitization, forced-pooling, or otherwise) or until a non-standard unit, eliminating such interest, has been approved by the Division.

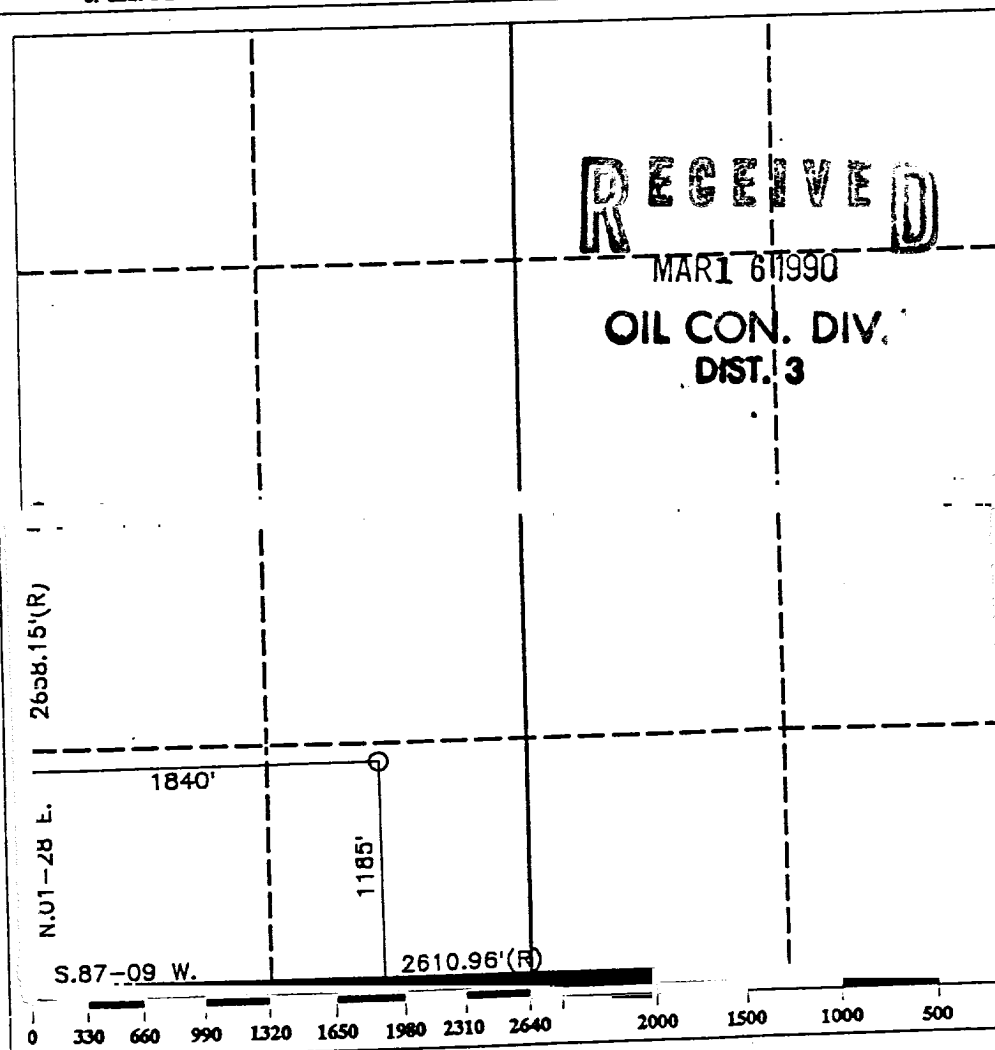

OPERATOR CERTIFICATION

I hereby certify that the information contained herein is true and complete to the best of my knowledge and belief.

Signature Chris Russell
Printed Name Chris Russell
Position Agent
Company Union Oil Co. of Cal.
Date 3/5/90

SURVEYOR CERTIFICATION

I hereby certify that the well location shown on this plat was plotted from field notes of actual surveys made by me or under my supervision, and that the same is true and correct to the best of my knowledge and belief.

Date Surveyed 10-06-89
Signature & Seal of Professional Surveyor Howard Daggett
Certificate No. 9679
Registered Professional Land Surveyor