

UNITED STATES
DEPARTMENT OF THE INTERIOR
BUREAU OF LAND MANAGEMENT

SUBMIT IN TRIPLICATE*
(Other instructions on re-
verse side)

Form approved.
Budget Bureau No. 1004-0135
Expires August 31, 1985

SUNDRY NOTICES AND REPORTS ON WELLS

(Do not use this form for proposals to drill or to deepen or plug back to a different reservoir.
Use "APPLICATION FOR PERMIT—" for such proposals.)

1. OIL WELL <input type="checkbox"/> GAS WELL <input checked="" type="checkbox"/> OTHER		7. UNIT AGREEMENT NAME RINCON UNIT
2. NAME OF OPERATOR Union Oil of California, Inc.		8. FARM OR LEASE NAME RINCON
3. ADDRESS OF OPERATOR P.O. Box 2074, Farmington, NM 87401		9. WELL NO. #250
4. LOCATION OF WELL (Report location clearly and in accordance with any State requirements.* See also space 17 below.) At surface 1465' FNL, 890' FEL, SEC 28, T27N, R6W		10. FIELD AND POOL, OR WILDCAT Fruitland Coal
14. PERMIT NO.		11. SEC., T., R., M., OR BLK. AND SURVEY OR AREA 28, T27N, R6W
15. ELEVATIONS (Show whether DF, RT, GR, etc.) 6558 GL		12. COUNTY OR PARISH Rio Arriba
		13. STATE NM

16. Check Appropriate Box To Indicate Nature of Notice, Report, or Other Data

NOTICE OF INTENTION TO:		SUBSEQUENT REPORT OF:	
TEST WATER SHUT-OFF <input type="checkbox"/>	PULL OR ALTER CASING <input type="checkbox"/>	WATER SHUT-OFF <input type="checkbox"/>	REPAIRING WELL <input type="checkbox"/>
FRACTURE TREAT <input type="checkbox"/>	MULTIPLE COMPLETE <input type="checkbox"/>	FRACTURE TREATMENT <input type="checkbox"/>	ALTERING CASING <input type="checkbox"/>
SHOOT OR ACIDIZE <input type="checkbox"/>	ABANDON* <input type="checkbox"/>	SHOOTING OR ACIDIZING <input type="checkbox"/>	ABANDONMENT* <input type="checkbox"/>
REPAIR WELL <input type="checkbox"/>	CHANGE PLANS <input checked="" type="checkbox"/>	(Other) <input type="checkbox"/>	

(Note: Report results of multiple completion on Well Completion or Recompletion Report and Log form.)

17. DESCRIBE PROPOSED OR COMPLETED OPERATIONS. (Clearly state all pertinent details, and give pertinent dates, including estimated date of starting any proposed work. If well is directionally drilled, give subsurface locations and measured and true vertical depths for all markers and zones pertinent to this work.)*

1. Attached please find new acreage dedication.
2. Change casing from 5-1/2" to 4-1/2" K-55, 10 1/2#. Cement volumes will be increased in order to circulate cement to surface.

RECEIVED
MAR 16 1990
OIL CON. DIV.
DIST. 3

RECEIVED
MAR 16 1990
AM 8:05
FARMINGTON RESOURCE AREA
BUREAU OF LAND MANAGEMENT
U.S. DEPARTMENT OF THE INTERIOR

18. I hereby certify that the foregoing is true and correct

SIGNED Chris Russell TITLE Agent

(This space for Federal or State office use)

APPROVED BY _____
CONDITIONS OF APPROVAL, IF ANY:

TITLE _____

DATE 3/5/90

Approved MAR 07 1990

K. J. Townsend

FOR
Chief, Branch of
Mineral Resources
Farmington Resource Area

*See Instructions on Reverse Side

Submit to Appropriate
District Office
State Lease - 4 copies
Fee Lease - 3 copies

State of New Mexico
Energy, Minerals and Natural Resources Department

OIL CONSERVATION DIVISION

P.O. Box 2088
Santa Fe, New Mexico 87504-2088

DISTRICT I
P.O. Box 1980, Hobbs, NM 88240

DISTRICT II
P.O. Drawer DD, Artesia, NM 88210

DISTRICT III
1000 Rio Brazos Rd., Aztec, NM 87410

WELL LOCATION AND ACREAGE DEDICATION PLAT

All Distances must be from the outer boundaries of the section

Operator Unocal, Inc.		Lease Rincon		Well No. Unit #250
Unit Letter H	Section 28	Township T.27 N.	Range R. 6 W.	County Rio Arriba
Actual Footage Location of Well: 1465 feet from the North line and 890 feet from the East line				
Ground level Elev. 6568	Producing Formation Fruitland Coal	Pool Fruitland Coal	Dedicated Acreage: 320 Acres	
<p>1. Outline the acreage dedicated to the subject well by colored pencil or hatchure marks on the plat below.</p> <p>2. If more than one lease is dedicated to the well, outline each and identify the ownership thereof (both as to working interest and royalty).</p> <p>3. If more than one lease of different ownership is dedicated to the well, have the interest of all owners been consolidated by communization, unitization, force-pooling, etc.? <input type="checkbox"/> Yes <input type="checkbox"/> No If answer is "yes" type of consolidation _____</p> <p>If answer is "no" list the owners and tract descriptions which have actually been consolidated. (Use reverse side of this form if necessary.) _____</p> <p>No allowable will be assigned to the well until all interests have been consolidated (by communization, unitization, forced-pooling, or otherwise) or until a non-standard unit, eliminating such interest, has been approved by the Division.</p>				

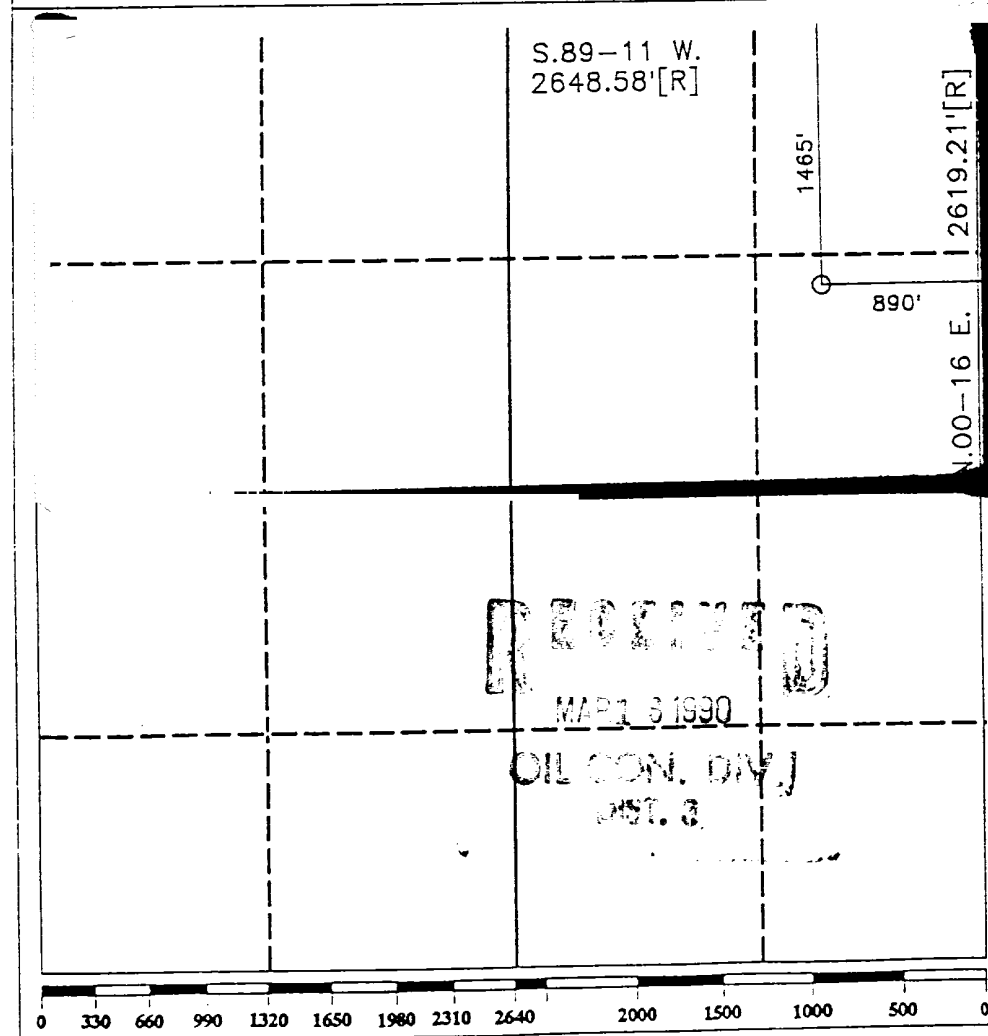

OPERATOR CERTIFICATION	
I hereby certify that the information contained herein is true and complete to the best of my knowledge and belief.	
Signature <i>Chris Russell</i>	
Printed Name Chris Russell	
Position Agent	
Company UNOCAL, Inc.	
Date 3/5/90	
SURVEYOR CERTIFICATION	
I hereby certify that the well location shown on this plat was plotted from field notes of actual surveys made by me or under my supervision, and that the same is true and correct to the best of my knowledge and belief.	
Date Surveyed 10-16-88	
Signature <i>R. Howard Daggett</i>	
Professional Surveyor Seal R. Howard Daggett 967	
Certificate No. 989	
Registered Professional Land Surveyor	