

Submit to Appropriate
District Office
State Lease - 6 copies
Fee Lease - 5 copies

State of New Mexico
Energy, Minerals and Natural Resources Department

Form C-101
Revised 1-1-89

DISTRICT I
P.O. Box 1980, Hobbs, NM 88240

DISTRICT II
P.O. Drawer DD, Artesia, NM 88210

DISTRICT III
1000 Rio Brazos Rd., Aztec, NM 87412

RECEIVED
OIL CONSERVATION DIVISION
MAR 30 1990
P.O. Box 2088
Santa Fe, New Mexico 87504-2088

OIL CON. DIV.
DIST. 3

API NO. (assigned by OCD on New Wells)

30-039-24665

5. Indicate Type of Lease

STATE ☒

FEE ☐

6. State Oil & Gas Lease No.

E-290-3

APPLICATION FOR PERMIT TO DRILL, DEEPEN, OR PLUG BACK

1a. Type of Work: DRILL <input checked="" type="checkbox"/> RE-ENTER <input type="checkbox"/> DEEPEN <input type="checkbox"/> PLUG BACK <input type="checkbox"/>		7. Lease Name or Unit Agreement Name Rincon Unit			
b. Type of Well: OIL WELL <input type="checkbox"/> GAS WELL <input checked="" type="checkbox"/> OTHER <input type="checkbox"/> SINGLE ZONE <input type="checkbox"/> MULTIPLE ZONE <input type="checkbox"/>		8. Well No. 262			
2. Name of Operator Union Oil Co. of California		9. Pool name or Wildcat Basin Fruitland Coal			
3. Address of Operator P.O. Box 2074, Farmington, N.M. 87401					
4. Well Location Unit Letter <u>K</u> : <u>2405</u> Feet From The <u>South</u> Line and <u>1615</u> Feet From The <u>West</u> Line Section <u>32</u> Township <u>27</u> North Range <u>6</u> West NMPM Rio Arriba County					
10. Proposed Depth 3233'		11. Formation Fruitland Coal			
12. Rotary or C.T. Rotary					
13. Elevations (Show whether DF, RT, GR, etc.) 6603' GR		14. Kind & Status Plug. Bond Current N.W.			
15. Drilling Contractor Arapahoe		16. Approx. Date Work will start Spring 1990			
17. PROPOSED CASING AND CEMENT PROGRAM <u>W/320</u>					
SIZE OF HOLE	SIZE OF CASING	WEIGHT PER FOOT	SETTING DEPTH	SACKS OF CEMENT	EST. TOP
12 1/4"	8 5/8"	24.0 #	225'	175 sacks	surface
7 7/8"	4 1/2"	10.5 #	T.D.	410 sacks	surface

Proposed Drilling Program

MIRU. Drill 12-1/4" hole with spud mud to 225'. Survey. Rig up and run casing and cement as outlined in attached drilling plan. WOC @ 18 hours. NUBOP, choke, and kill line (2000#) and test same plus casing. Drill out with 7-7/8" hole from 225' to T.D. with fresh water mud. Run surveys @ 500' intervals or first bit trip succeeding 500'. At T.D. log with DISFL, GR, SP, FDC, CNL-GR. Run and cement casing as outlined in attached drilling plan. RDMOL.

APPROVAL EXPIRES 9-30-90
UNLESS DRILLING IS COMMENCED.
SPUD NOTICE MUST BE SUBMITTED
WITHIN 10 DAYS

IN ABOVE SPACE DESCRIBE PROPOSED PROGRAM: IF PROPOSAL IS TO DEEPEN OR PLUG BACK, GIVE DATA ON PRESENT PRODUCTIVE ZONE AND PROPOSED NEW PRODUCTIVE ZONE. GIVE BLOWOUT PREVENTER PROGRAM, IF ANY.

I hereby certify that the information above is true and complete to the best of my knowledge and belief.

SIGNATURE

Chris Russell

TITLE Agent

DATE 3/30/90

TYPE OR PRINT NAME

TELEPHONE NO.

(This space for State Use)

APPROVED BY

B. J. G.

TITLE

DATE

MAR 30 1990

CONDITIONS OF APPROVAL, IF ANY:

Submit to Appropriate
District Office
State Lease - 4 copies
Fee Lease - 3 copies

State of New Mexico
Energy, Minerals and Natural Resources Department

Form C-102
Revised 1-1-89

OIL CONSERVATION DIVISION

P.O. Box 2088
Santa Fe, New Mexico 87504-2088

DISTRICT I
P.O. Box 1980, Hobbs, NM 88240

DISTRICT II
P.O. Drawer DD, Artesia, NM 88210

DISTRICT III
1000 Rio Brazos Rd., Aztec, NM 87410

WELL LOCATION AND ACREAGE DEDICATION PLAT

All Distances must be from the outer boundaries of the section

Operator UNION OIL CO. OF CALIFORNIA			Lease RINCON UNIT		Well No. 262
Unit Letter K	Section 32	Township T.27 N.	Range R.6 W.	County RIO ARriba COUNTY	
Actual Footage Location of Well: 2405 feet from the SOUTH line of 1615 feet from the WEST line					
Ground level Elev. 6603	Producing Formation FRUITLAND COAL		Pool BASIN FRUITLAND COAL		Dedicated Acreage: 320 Acres

- Outline the acreage dedicated to the subject well by colored pencil or hatchure marks on the plat below.
- If more than one lease is dedicated to the well, outline each and identify the ownership thereof (both as to working interest and royalty).
- If more than one lease of different ownership is dedicated to the well, have the interest of all owners been consolidated by communitization, unitization, force-pooling, etc.?
☒ Yes ☐ No If answer is "yes" type of consolidation UNITIZATION
If answer is "no" list the owners and tract descriptions which have actually been consolidated. (Use reverse side of this form if necessary.)
No allowable will be assigned to the well until all interests have been consolidated (by communitization, unitization, forced-pooling, or otherwise) or until a non-standard unit, eliminating such interest, has been approved by the Division.

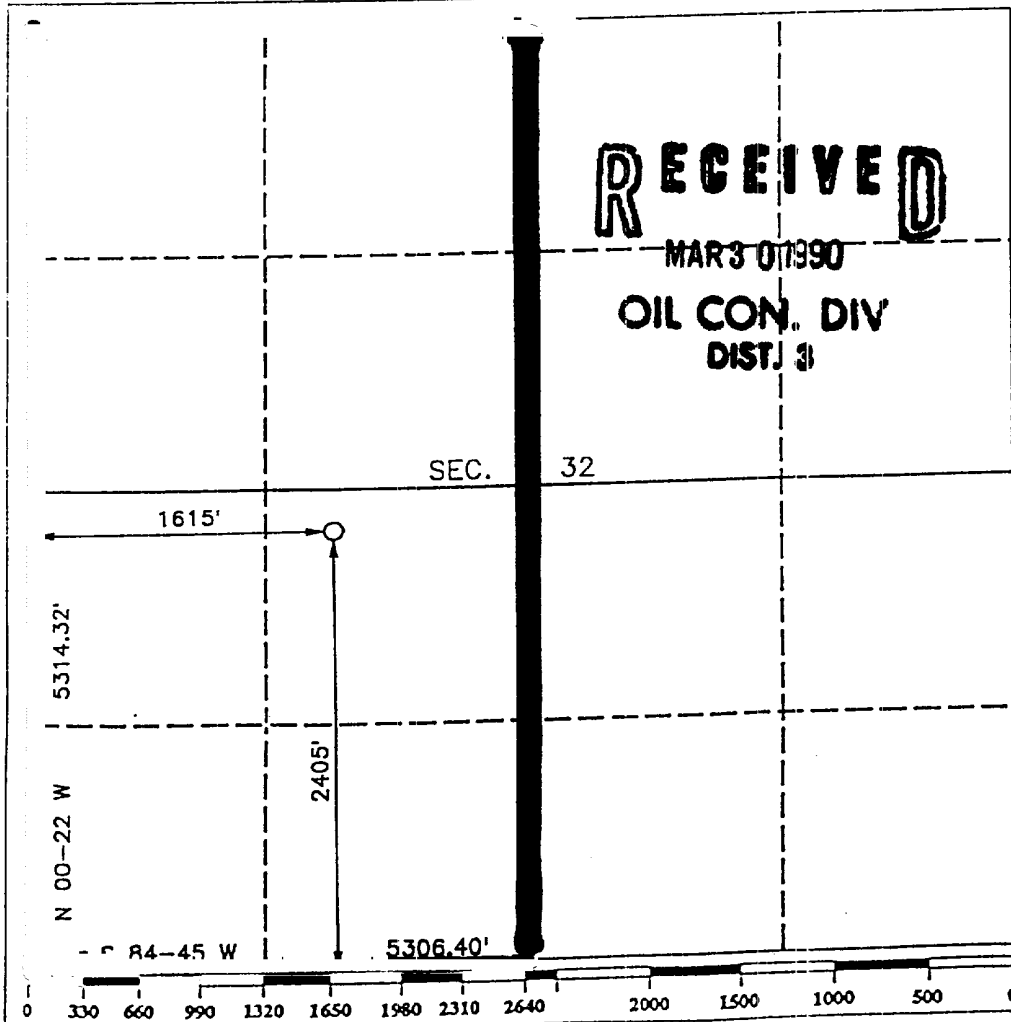

OPERATOR CERTIFICATION

I hereby certify that the information contained herein is true and complete to the best of my knowledge and belief.

Signature Chris Russell
Printed Name **Chris Russell**
Position **AGENT**
Company **UNOCA**
Date **3/30/90**

SURVEYOR CERTIFICATION

I hereby certify that the well location shown on this plat was plotted from field notes of actual surveys made by me or under my supervision, and that the same is true and correct to the best of my knowledge and belief.

Date Surveyed **MARCH 17 1990**
Signature & Seal of MEXICO
Professional Surveyor
R. HOWARD DAGGLE
Certificate No. **9678**
Registered Professional
Land Surveyor