

RECEIVED

MAY 24 1990

OIL CON. DIV.  
DIST. 3

UNITED STATES  
DEPARTMENT OF THE INTERIOR  
BUREAU OF LAND MANAGEMENT

30-039-24773

APPLICATION FOR PERMIT TO DRILL, DEEPEN, OR PLUG BACK		
1a. TYPE OF WORK DRILL	5. LEASE NUMBER SF-079366	
1b. TYPE OF WELL GAS	6. IF INDIAN, ALL. OR TRIBE NAME	
2. OPERATOR UNION OIL CO. OF CAL.	7. UNIT AGREEMENT NAME RINCON UNIT	
3. ADDRESS OF OPERATOR P O BOX 2074 FARMINGTON, NM, 87401 (505)-325-8786	8. FARM OR LEASE NAME RINCON Unit	
4. LOCATION OF WELL 1369' FNL, 1015' FEL	9. WELL NO. 263	
	10. FIELD, POOL, OR WILDCAT BASIN FRUITLAND COAL	
14. DISTANCE FROM NEAREST TOWN 40 Miles SE of Bloomfield	11. SEC. 19, T. 27N, R. 6W	12. COUNTY Rio Arriba
	13. STATE New Mex.	15. DISTANCE FROM PROPOSED LOCATION TO NEAREST PROPERTY OR LEASE LINE 1015'
16. ACRES IN LEASE 2558.72	17. ACRES ASSIGNED TO WELL 2/320	18. DISTANCE FROM PROPOSED LOCATION TO NEAREST WELL DRILLING, COMPLETED OR APPLIED FOR ON THIS LEASE: 764'
19. PROPOSED DEPTH 3113'	20. ROTARY OR CABLE TOOLS This action is subject to technical and procedural review pursuant to 43 CFR 3165.3 and appeal pursuant to 43 CFR 3165.4. Rotary	
21. ELEVATIONS (DF, FT, GR, ETC.) 6483' GL	22. APPROX. DATE WORK WILL BEGIN DRILLING OPERATIONS AUTHORIZED ARI Spring 1990 SUBJECT TO COMPLIANCE WITH ATTACH GENERAL REQUIREMENTS.	
23. PROPOSED CASING AND CEMENTING PROGRAM SEE ATTACHED DRILLING PLAN		
24. AUTHORIZED BY: <u>Chris Runell</u> 3/23/90 AGENT DATE		
PERMIT NO. _____ APPROVAL DATE _____ APPROVED BY _____ TITLE _____ DATE _____		
NOTE: THIS FORMAT IS ISSUED IN LIEU OF BLM FORM 3160		

NMOCD

APPROVED  
AS AMENDED  
MAY 10 1990  
AREA MANAGER

1000

1. The first step is to identify the problem or goal. This involves understanding the current situation and what needs to be achieved.

the 1990s, the number of people in the world who are illiterate has increased from 1.2 billion to 1.5 billion. The number of illiterate people in the world is expected to reach 1.7 billion by the year 2015. The number of illiterate people in the world is expected to reach 1.7 billion by the year 2015.

Submit to Appropriate  
District Office  
State Lease - 4 copies  
Fee Lease - 3 copies

DISTRICT I  
P.O. Box 1980, Hobbs, NM 88240

DISTRICT II  
P.O. Drawer DD, Artesia, NM 88210

DISTRICT III  
1000 Rio Brazos Rd., Aztec, NM 87410

State of New Mexico  
Energy, Minerals and Natural Resources Department

OIL CONSERVATION DIVISION

P.O. Box 2088  
Santa Fe, New Mexico 87504-2088

Form C-102  
Revised 1-1-89

WELL LOCATION AND ACREAGE DEDICATION PLAT

All Distances must be from the outer boundaries of the section

Operator <b>UNION OIL CO. OF CALIFORNIA</b>		Lease <b>RINCON UNIT</b>		Well No. <b>263</b>
Unit Letter <b>H</b>	Section <b>19</b>	Township <b>T.27 N.</b>	Range <b>R.6 W.</b>	County <b>RIO ARriba COUNTY</b>
Actual Footage Location of Well: <b>1369</b> feet from the <b>NORTH</b> line and <b>1015</b> feet from the <b>EAST</b> line				
Ground level Elev. <b>6483</b>	Producing Formation <b>FRUITLAND COAL</b>		Pool <b>BASIN FRUITLAND COAL</b>	Dedicated Acreage: <b>320</b> Acres

- Outline the acreage dedicated to the subject well by colored pencil or hatchure marks on the plat below.
- If more than one lease is dedicated to the well, outline each and identify the ownership thereof (both as to working interest and royalty).
- If more than one lease of different ownership is dedicated to the well, have the interest of all owners been consolidated by communitization, unitization, force-pooling, etc.?  
☒ Yes ☐ No If answer is "yes" type of consolidation Unitization  
If answer is "no" list the owners and tract descriptions which have actually been consolidated. (Use reverse side of this form if necessary.)  
No allowable will be assigned to the well until all interests have been consolidated (by communitization, unitization, forced-pooling, or otherwise) or until a non-standard unit, eliminating such interest, has been approved by the Division.

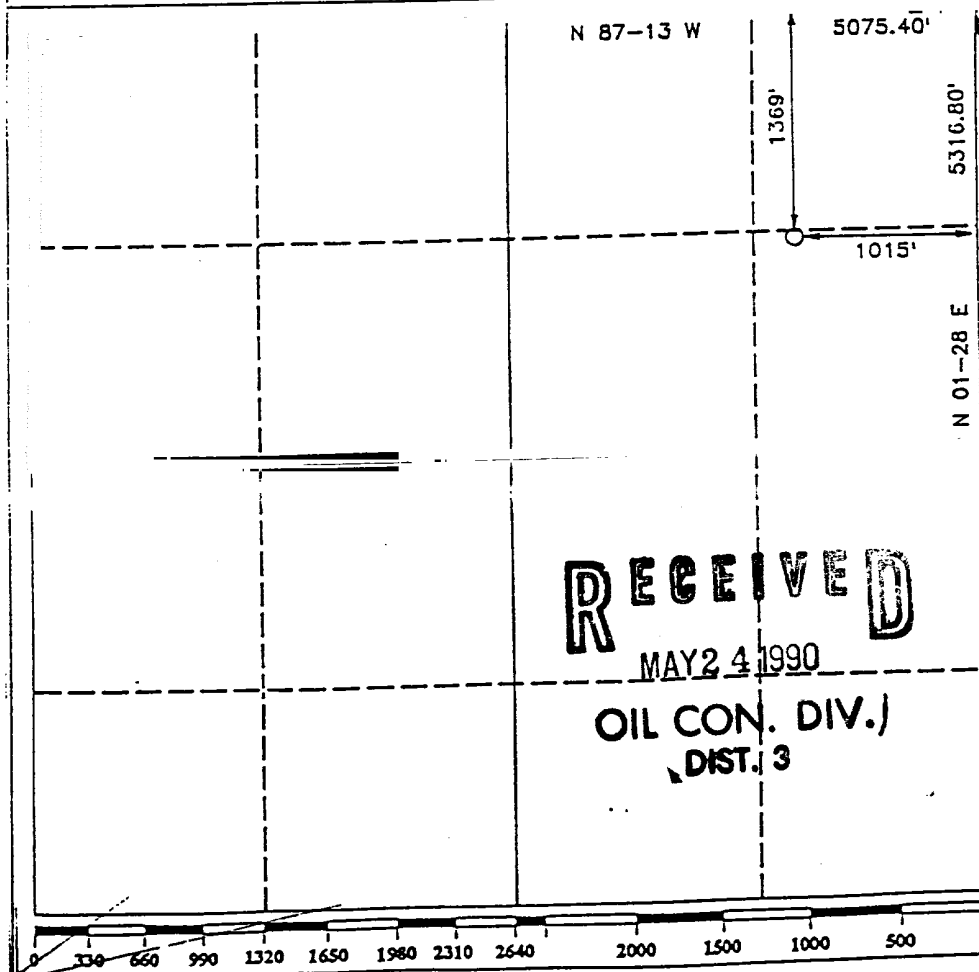

OPERATOR CERTIFICATION

I hereby certify that the information contained herein is true and complete to the best of my knowledge and belief.

Signature Chris Russell  
Printed Name Chris Russell  
Position AGENT  
Company UNOCAL  
Date 3/23/90

SURVEYOR CERTIFICATION

I hereby certify that the well location shown on this plat was plotted from field notes of actual surveys made by me or under my supervision, and that the same is true and correct to the best of my knowledge and belief.

Date Surveyed MARCH 16, 1990  
Signature & Seal of Professional Surveyor  
R. HOWARD DAGGETT  
Certificate No. 9079  
Registered Professional Land Surveyor

Testing Procedure:

The BOP and related equipment will be tested to 2000 psi in accordance with the provisions of Onshore Oil and Gas Order No. 2.

BOP's will be operationally tested daily, and each test will be logged in the IADC Daily Drilling Report.

Blooie line:

The blooie line and related equipment will meet all requirements of Onshore Oil and Gas Order No. 2.

4. CASING AND CEMENTING PROGRAM

<u>SURFACE CASING</u>						
<u>AGE</u>	<u>Depth</u>	<u>Hole Size</u>	<u>Size</u>	<u>Weight</u>	<u>Grade</u>	<u>Thread</u>
New	0-225'	12-1/4"	8-5/8"	24.0#	K-55	ST&C

<u>INTERMEDIATE CASING</u>						
<u>Age</u>	<u>Depth</u>	<u>Hole Size</u>	<u>Size</u>	<u>Weight</u>	<u>Grade</u>	<u>Thread</u>
New	0-TD	7-7/8"	4-1/2"	10.5#	K-55	ST&C

MINIMUM SAFETY FACTORS

Collapse: 1.0  
Tension: 1.8  
Burst: 1.0

Cementing Program:

1. The 8-5/8" surface casing will be cemented to the surface with 175 sacks of class "B" cement with 2% CaCl<sub>2</sub> and 1/4# per sack flocele.
2. The 4-1/2" production casing will be cemented in 2 stages with the DV tool set at 2900'. 1st stage will be cemented with 85 sacks class "H" cement with .95% Flo-Lock-1, 18% Thrifty Lite, 3% KCL, 3# Hi-seal.  
2nd stage will be cemented with 325 sacks pacesetter lite with 6% gel, 1/3# cello-seal. .8% CF-1, 3# Hi-seal followed with 50 sacks class "C" cement. Actual cement volumes will be calculated from open hole logs and will be designed to circulate to surface.

