

RECEIVED

JUN 18 1990

OIL CON. DIV.  
DIST. 3

UNITED STATES  
DEPARTMENT OF THE INTERIOR  
BUREAU OF LAND MANAGEMENT

30-039-24800

APPLICATION FOR PERMIT TO DRILL, DEEPEN, OR PLUG BACK

1a. TYPE OF WORK DRILL		5. LEASE NUMBER SF-079364	
1b. TYPE OF WELL GAS		6. IF INDIAN, ALL. OR TRIBE NAME	
2. OPERATOR UNION OIL CO. OF CAL.		7. UNIT AGREEMENT NAME RINCON UNIT	
3. ADDRESS OF OPERATOR P O BOX 2074 FARMINGTON, NM, 87401 (505)-325-8786		8. FARM OR LEASE NAME RINCON	
4. LOCATION OF WELL 1708' FNL, 957' FEL,		9. WELL NO. 259	
10. FIELD, POOL, OR WILDCAT BASIN FRUITLAND COAL		11. SEC. 29, T. 27N, R. 6W	
14. DISTANCE FROM NEAREST TOWN 40 Miles SE of Bloomfield		12. COUNTY Rio Arriba	13. STATE New Mex.
15. DISTANCE FROM PROPOSED LOCATION TO NEAREST PROPERTY OR LEASE LINE 957'		16. ACRES IN LEASE <del>2560.64</del> 2605.33	17. ACRES ASSIGNED TO WELL E / 320
18. DISTANCE FROM PROPOSED LOCATION TO NEAREST WELL DRILLING, COMPLETED OR APPLIED FOR ON THIS LEASE: 1256'		19. PROPOSED DEPTH 3297'	20. ROTARY OR CABLE TOOLS DRILLING OPERATIONS AUTHORIZED ARE SUBJECT TO COMPLIANCE WITH ATTACHED "GENERAL REQUIREMENTS".
21. ELEVATIONS (DF, FT, GR, ETC.) 6667' GR		22. APPROX. DATE WORK WILL BEGIN Spring 1990	
23. PROPOSED CASING AND CEMENTING PROGRAM SEE ATTACHED DRILLING PLAN		This action is subject to technical and procedural review pursuant to 43 CFR 3165.3 and appeal pursuant to 43 CFR 3165.4.	
24. AUTHORIZED BY: <u>Chris Russell</u> AGENT		4/18/90 DATE	

PERMIT NO. \_\_\_\_\_ APPROVAL DATE \_\_\_\_\_

APPROVED BY \_\_\_\_\_ TITLE \_\_\_\_\_ DATE \_\_\_\_\_ **APPROVED**

NOTE: THIS FORMAT IS ISSUED IN LIEU OF BLM FORM 3160-3

JUN 13 1990  
AREA MANAGER

State of New Mexico  
Energy, Minerals and Natural Resources Department

Form C-102  
Revised 1-1-89

OIL CONSERVATION DIVISION

P.O. Box 2088  
Santa Fe, New Mexico 87504-2088

Appropriate  
Office  
Lease - 4 copies  
Lease - 3 copies

DISTRICT I  
P.O. Box 1980, Hobbs, NM 88240

DISTRICT II  
P.O. Drawer DD, Artesia, NM 88210

DISTRICT III  
1000 Rio Brazos Rd., Aztec, NM 87410

WELL LOCATION AND ACREAGE DEDICATION PLAT

All Distances must be from the outer boundaries of the section

Operator <b>UNION OIL CO. OF CALIFORNIA</b>			Lease <b>RINCON UNIT</b>		Well No. <b>259</b>
Unit Letter <b>H</b>	Section <b>29</b>	Township <b>T.27 N.</b>	Range <b>R.6 W.</b>	County <b>RIO ARRIBA COUNTY</b>	
Actual Footage Location of Well: <b>1708</b> feet from the <b>NORTH</b> line and <b>957</b> feet from the <b>EAST</b> line					
Ground level Elev. <b>6667</b>	Producing Formation <b>FRUITLAND COAL</b>		Pool <b>BASIN FRUITLAND COAL</b>		Dedicated Acreage: <b>320</b> Acres

- Outline the acreage dedicated to the subject well by colored pencil or hatchure marks on the plat below.
- If more than one lease is dedicated to the well, outline each and identify the ownership thereof (both as to working interest and royalty).
- If more than one lease of different ownership is dedicated to the well, have the interest of all owners been consolidated by communitization, unitization, force-pooling, etc.?  
☐ Yes ☐ No If answer is "yes" type of consolidation \_\_\_\_\_  
If answer is "no" list the owners and tract descriptions which have actually been consolidated. (Use reverse side of this form if necessary).  
No allowable will be assigned to the well until all interests have been consolidated (by communitization, unitization, forced-pooling, or otherwise) or until a non-standard unit, eliminating such interest, has been approved by the Division.

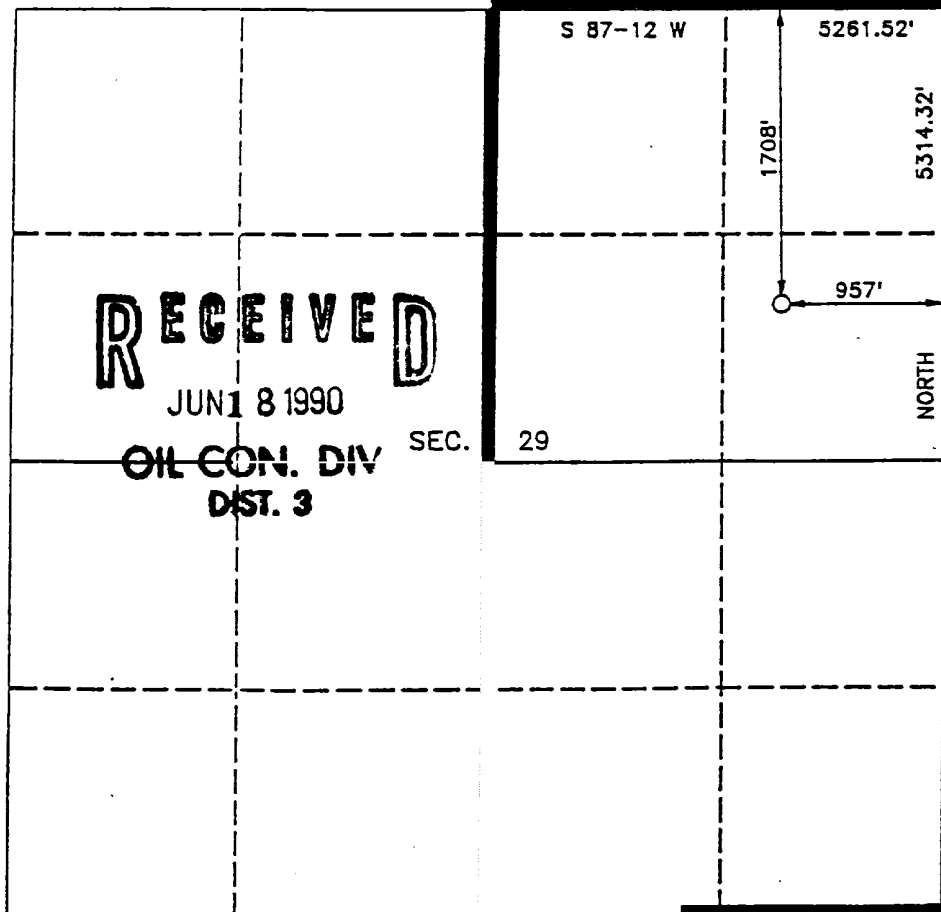

OPERATOR CERTIFICATION

I hereby certify that the information contained herein is true and complete to the best of my knowledge and belief.

Signature  
**Chris Russell**  
Printed Name  
**Chris Russell**  
Position  
**AGENT**  
Company  
**UNOCAL**  
Date  
**4/18/90**

SURVEYOR CERTIFICATION

I hereby certify that the well location shown on this plat was plotted from field notes of actual surveys made by me or under my supervision, and that the same is true and correct to the best of my knowledge and belief.

Date Surveyed  
**APR 18 1990**  
Signature & Seal  
Professional Surveyor  
**R. HOWARD DAGGETT**  
Certificate No.  
**9673**  
Registered Professional  
Land Surveyor