

UNITED STATES
DEPARTMENT OF THE INTERIOR
BUREAU OF LAND MANAGEMENT

RECEIVED
BLM

92 FEB -4 AM 10:41

30-039-25158
APPLICATION FOR PERMIT TO DRILL, DEEPEN, OR PLUG BACK

FARMINGTON, N.M.

1a. TYPE OF WORK
DRILL
1b. TYPE OF WELL
GAS

RECEIVED

FEB 18 1992

OIL CON. DIV.

2. OPERATOR
MERIDIAN OIL INC. DIST. 3

14538
3. ADDRESS & PHONE NO. OF OPERATOR
P O BOX 4289
FARMINGTON, NM 87499

4. LOCATION OF WELL
1270' FNL 1140' FEL

5. LEASE NUMBER
SF-079363
6. IF INDIAN, ALL. OR TRIBE NAME

7. UNIT AGREEMENT NAME
SAN JUAN 28-6 UNIT

8. FARM OR LEASE NAME
SAN JUAN 28-6 UNIT 7462

9. WELL NO.
427

10. FIELD, POOL, OR WILDCAT
BASIN 71629 FRUITLAND COAL

11. SEC. T. R. M OR BLK.
A SEC. 13 T27N R06W NMPM

14. DISTANCE IN MILES FROM NEAREST TOWN
10 MILES SO GOBERNADOR

12. COUNTY
RIO ARRIBA
13. STATE
NM

15. DISTANCE FROM
PROPOSED LOCATION 1140'
TO NEAREST PROPERTY
OR LEASE LINE.

16. ACRES IN LEASE 17. ACRES ASSIGNED TO WELL
320.00

18. DISTANCE FROM
PROPOSED LOCATION
TO NEAREST WELL DR. 400'
COMPL., OR APPLIED
FOR ON THIS LEASE.

19. PROPOSED DEPTH 20. ROTARY OR CABLE TOOLS
3256' ROTARY

21. ELEVATIONS (DF, FT, GR, ETC.)
6457' GL

22. APPROX. DATE WORK WILL START

23. PROPOSED CASING AND CEMENTING PROGRAM

*SEE OPERATIONS PLAN

24. AUTHORIZED BY: 
REG. DRILLING ENGR.

1/30/92
DATE

PERMIT NO. _____ APPROVAL DATE _____

APPROVED
AS AMENDED

APPROVED BY _____ TITLE _____ DATE _____

FEB 18 1992

AREA MANAGER

NOTE: THIS FORMAT IS ISSUED IN LIEU OF US BLM FORM 3160-3

ARCH REPORT SUBMITTED 10/31/91

NMOCD

Submit to Appropriate
District Office
State Lease - 4 copies
Fee Lease - 3 copies

State of New Mexico
Energy, Minerals and Natural Resources Department

Form C-182
Revised 1-1-89

OIL CONSERVATION DIVISION

P.O. Box 2088
Santa Fe, New Mexico 87504-2088

RECEIVED
BLM

92 FEB -4 AM 10:41

618 SAN JUAN, N.M.

DISTRICT I
P.O. Box 1980, Hobbs, NM 88240

DISTRICT II
P.O. Drawer DD, Artesia, NM 88210

DISTRICT III
1000 Rio Brazos Rd., Aztec, NM 87410

WELL LOCATION AND ACREAGE DEDICATION PLAT

All Distances must be from the outer boundaries of the section

Operator	Meridian Oil Inc.	Lease	San Juan 28-6 Unit	Well No.	427
Unit Letter	A	Section	13	Township	27 North
				Range	6 West
				County	NMPM Rio Arriba

Actual Footage Location of Well:

1270	feet from the North	line and	1140	feet from the East	line
Ground level Elev.	6457'	Producing Formation	Fruitland Coal	Pool	Basin
				Dedicated Acreage:	320 Acres

- Outline the acreage dedicated to the subject well by colored pencil or highlighter marks on the plat below.
- If more than one lease is dedicated to the well, outline each and identify the ownership thereof (both as to working interest and royalty).
- If more than one lease of different ownership is dedicated to the well, have the interest of all owners been consolidated by communitization, unitization, force-pooling, etc.?
☒ Yes ☐ No If answer is "yes" type of consolidation unitization
If answer is "no" list the owners and tract descriptions which have actually been consolidated. (Use reverse side of this form if necessary.)
No allowable will be assigned to the well until all interests have been consolidated (by communitization, unitization, forced-pooling, or otherwise) or until a non-standard unit, eliminating such interest, has been approved by the Division.

OPERATOR CERTIFICATION

I hereby certify that the information contained herein is true and complete to the best of my knowledge and belief.

Peggy Bradford
Signature

Peggy Bradford
Printed Name

Regulatory Affairs
Position

Meridian Oil Inc.
Company

1-22-92
Date

SURVEYOR CERTIFICATION

I hereby certify that the well location shown on this plat was taken from field notes of actual survey made by me or under my supervision, and that the same is true and correct to the best of my knowledge and belief.

10-16-91
Date Surveyed

Neal C. Edwards
Signature

Professional Surveyor

6857
Certificate No.

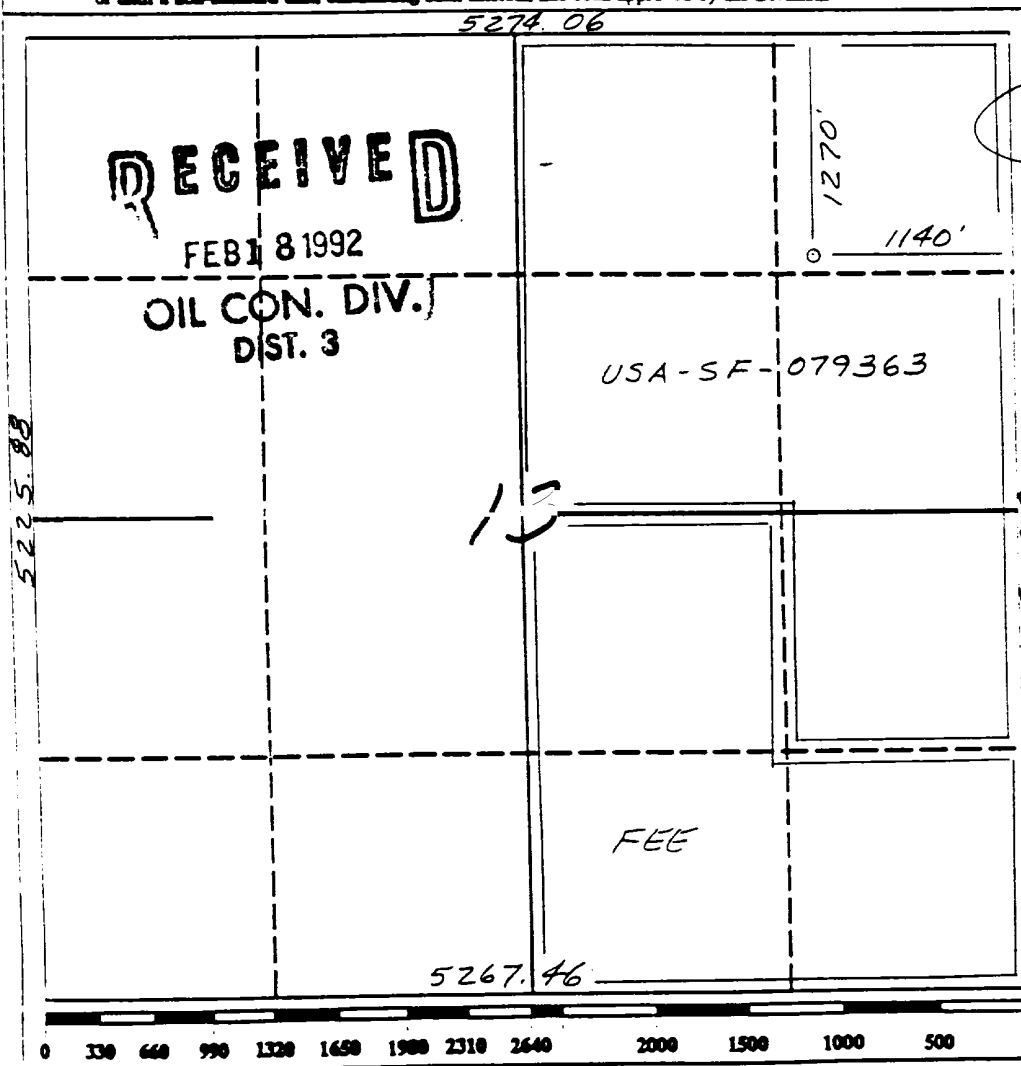

WELL NAME: San Juan 28-6 Unit No. 427
 Section 13, T-27-N, R-6-W
 Basin-Fruitland Coal

1270' FNL - 1140' FEL
 Rio Arriba New Mexico
 Elevation 6457'

Formation Tops: Surface- San Jose
 Ojo Alamo- 2602
 Kirtland- 2697
 Fruitland- 2947
 Fruitland Coal Top- 3023
 Fruitland Coal Base- 3211
 Pictured Cliffs- 3213

Total Depth- 3256

Logging Program: Mud logs from 2947 to total depth.

Mud Program:	Interval	Type	Weight	Visc.	Fl. Loss
	0 - 200	Spud	8.4 - 8.9	40-50	no control
	200 - 3256	Non-dispersed	8.4 - 9.5	30-60	no control

Casing Program:	Hole Size	Depth Interval	Csg. Size	Weight	Grade
	12 1/4"	0 - 200	8 5/8"	24.0#	K-40
	7 7/8"	0 - 3256	4 1/2"	10.5#	K-55

Tubing Program:					
		0 - 3256	2 3/8"	4.7#	J-55

Float Equipment: 8 5/8" surface casing - saw tooth guide shoe. Centralizers will be run in accordance with Onshore Order #2.

4 1/2" production casing - float shoe on bottom. Three centralizers run every other joint above shoe. Two turbolizing type centralizers - one below and one into the base of the Ojo Alamo @ 2602'. Standard centralizers thereafter every fourth joint up to the base of the surface pipe.

Wellhead Equipment: 8 5/8" x 4 1/2" x 2 3/8" x 11" 3000 psi xmas tree assembly.

Cementing:

8 5/8" surface casing - cement with 211 sacks of class "B" cement with 1/4# flocele/sack and 3% calcium chloride (248 cu ft. of slurry, 200% excess to circulate to surface). WOC 12 hours. Test casing to 600 psi for 30 minutes.

4 1/2" production casing - lead with 880 sacks of 65/35 class "B" poz with 6% gel, 2% calcium chloride and 1/2 cu.ft. Perlite/sack (10.3 gallons of water/sack) tail with 100 sacks of class "B" with 2% calcium chloride. (1676 cu.ft. of slurry, 100% excess to circulate to surface). If hole conditions permit, a 600 ft spacer will be run ahead of the cement slurry to avoid mud contamination of the cement. WOC 12 hours. If cement does not circulate to surface, a temperature log will be run after 8 hours to determine TOC.