

District I
1625 N. French Dr., Hobbs, NM 88240
District II
811 South First, Artesia, NM 88210
District III
1000 Rio Brazos Road, Aztec, NM 87410
District IV
2040 South Pacheco, Santa Fe, NM 87505

State of New Mexico
Energy Minerals and Natural Resources

Oil Conservation Division
2040 South Pacheco
Santa Fe, NM 87505

Form C-107
Revised March 17, 1999

Filing Instructions
At Bottom of Page

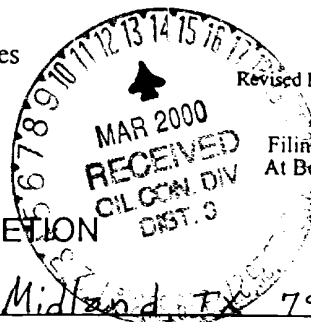

APPLICATION FOR MULTIPLE COMPLETION

Operator Union Oil Company of California - P.O. Box 671 - Midland, TX 79702 Address

Lease Rincon Unit Well No. 127M Unit Ltr. - Sec - Twp - Rge D 28 27N 6W County Rio Arriba

All applicants for multiple completion must complete Items 1 and 2 below.

1. The following facts are submitted:	Upper Zone	Intermediate Zone	Lower Zone
a. Name of Pool and Formation	<u>South Blanco Pictured Cliffs</u>	<u>Blanco Mesa Verde</u>	<u>Basin Dakota</u>
b. Top and Bottom of Pay Section (Perforations)	<u>3200' - 3262'</u>	<u>4884' - 5276'</u>	<u>7424' - 7642'</u>
c. Type of production (Oil or Gas)	<u>Gas</u>	<u>Gas</u>	<u>Gas</u>
d. Method of Production (Flowing or Artificial Lift)	<u>Flowing</u>	<u>Flowing</u>	<u>Flowing</u>
e. Daily Production <input checked="" type="checkbox"/> Actual <input type="checkbox"/> Estimated Oil Bbls. Gas MCF Water Bbls.	<u>0</u> <u>900</u> <u>2</u>	<u>0</u> <u>88</u> <u>0</u>	<u>0</u> <u>366</u> <u>3</u>

2. The following must be attached:

- Diagrammatic Sketch of the Multiple Completion, showing all casing strings, including diameters and setting depths, centralizers and/or turbolizers and location thereof, quantities used and top of cement, perforated intervals, tubing strings, including diameters and setting depth, location and type of packers and side door chokes, and such other information as may be pertinent.
- Plat showing the location of all wells on applicant's lease, all offset wells on offset leases, and the names and addresses of operators of all leases offsetting applicant's lease.
- Electrical log of the well or other acceptable log with tops and bottoms of producing zones and intervals of perforation indicated thereon. (If such log is not available at the time application is filed it shall be submitted as provided by Rule 112-A.)

OPERATOR:

I hereby certify above information is true and complete to best of my knowledge, and belief.

Signature Charlotte Beeson
Printed Name & Title Charlotte Beeson - Regulatory Clerk
Date 3-7-00 Telephone (915) 685-7607

OIL CONSERVATION DIVISION

Approved by ORIGINAL SIGNED BY CHARLIE T. PEYTON

Title DEPUTY OIL & GAS INSPECTOR, DIST. 3

Date MAR 13 2000

NOTE: If the proposed multiple completion will result in an unorthodox well location and/or a non-standard proration unit in one or more of the producing zones, then separate application for approval of the same should be filed simultaneously with this application.

FILING INSTRUCTIONS:

- District Approval -- See rule 112-A-B -- Submit 4 copies of Form C-107 with attachments to appropriate district office.
- Division Director Administrative Approval -- See Rule 112-C -- Submit 2 copies of Form C-107 with attachments to Division office in Santa Fe and 2 copies of Form C-107 with attachments to appropriate district office.
- Multiple completions not qualifying for District or Division Director approval may be set for hearing as outlined in Rule 112-A-E.

**OFFSET OPERATORS
RINCON UNIT #127
850' FNL & 800' FWL
SEC. 28, T27N, R6W
RIO ARRIBA COUNTY, NM**

**Caulkins Oil Co.
P. O. Box 340
Bloomfield, NM 87413**

ASSET GROUP: South Permian
FIELD: Basin Dakota
LEASE/UNIT: Rincon Unit
COUNTY: Rio Arriba

SPRINT
ENERGY 26
New Name. Same Spirit.

DATE: May. 06, 1999
BY: M.C. Phillips
WELL: #127M
STATE: New Mexico

SPUD DATE: 8/17/92
COMP. DATE: 11/08/92
STATUS: Commingled

KB = 6,669'
Elevation = 6,656'
TD = 7,775'
PBD = 7,668'

After

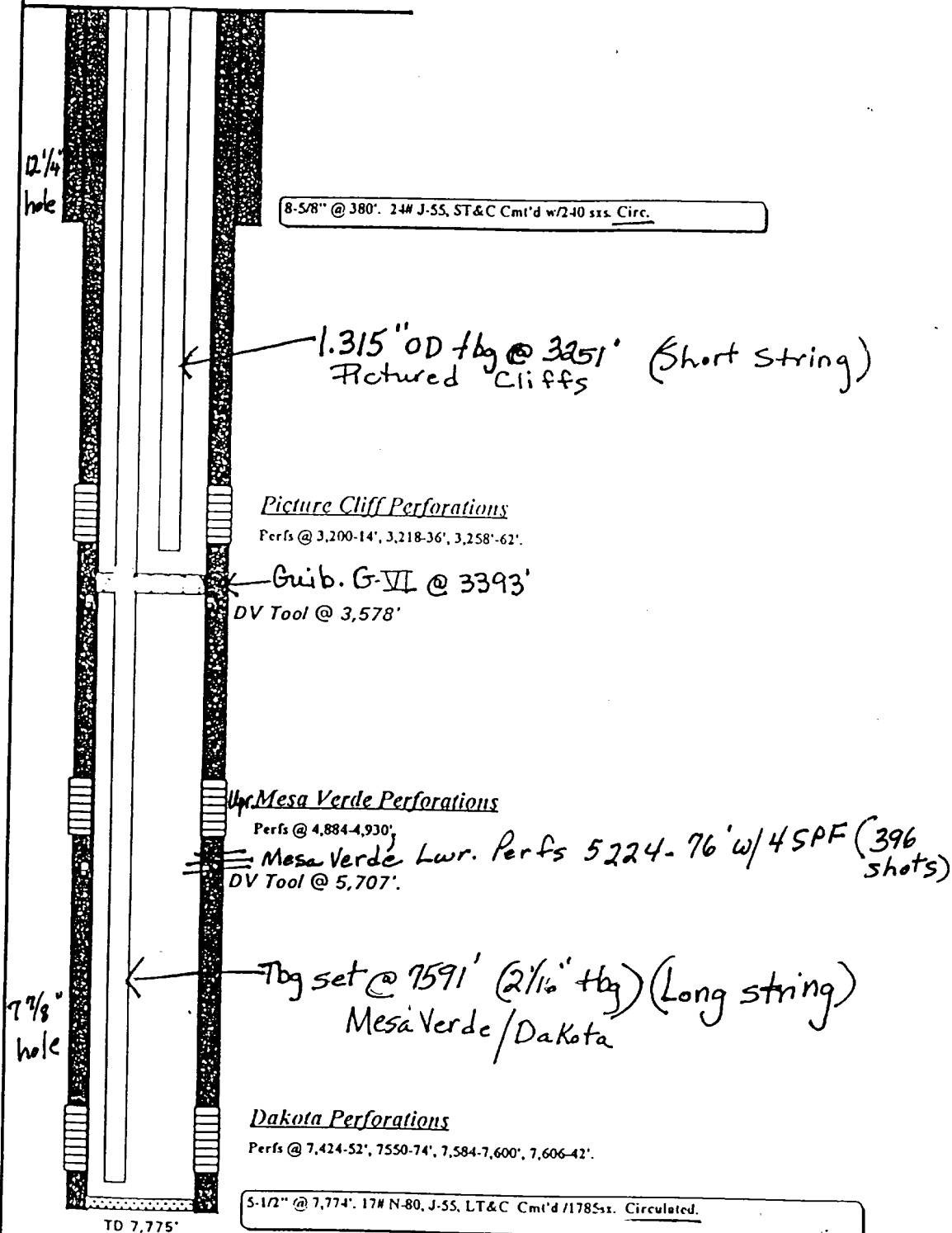

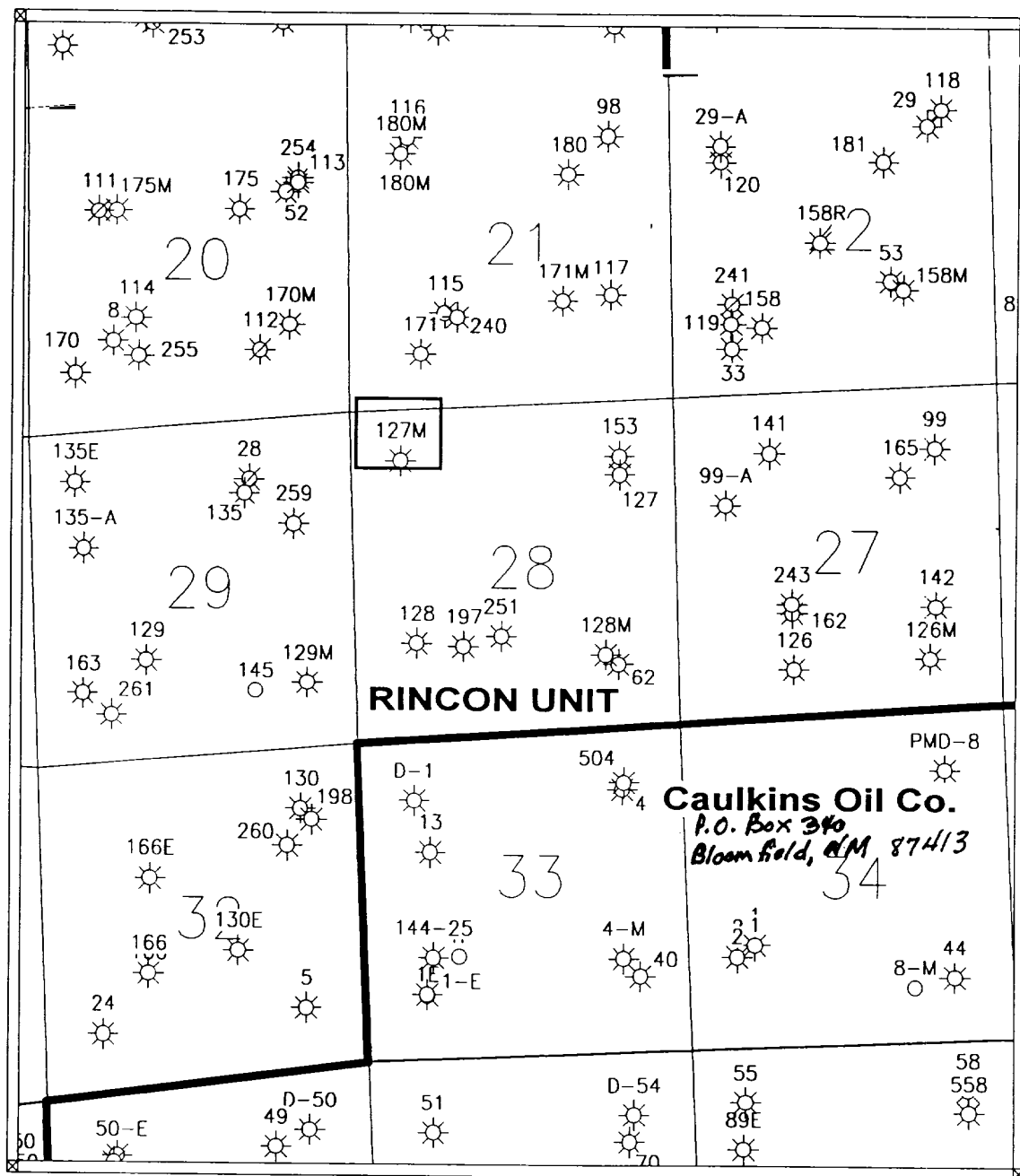

Scale 1:31844.67

1000. 0. 1000. 2000. 3000. 4000. 5000. feet



0.1 0. 0.1 0.2 0.3 0.4 0.5 miles



LOCATOR MAP		
RINCON UNIT NO. 127M		
850' FNL, 800' FWL, SEC. 28, T27N, R6W		
OPERATOR: UNION OIL CO. OF CALIFORNIA		
	Scale 1:31844.67	
HADWELGREN	3/8/19100	127M GR1

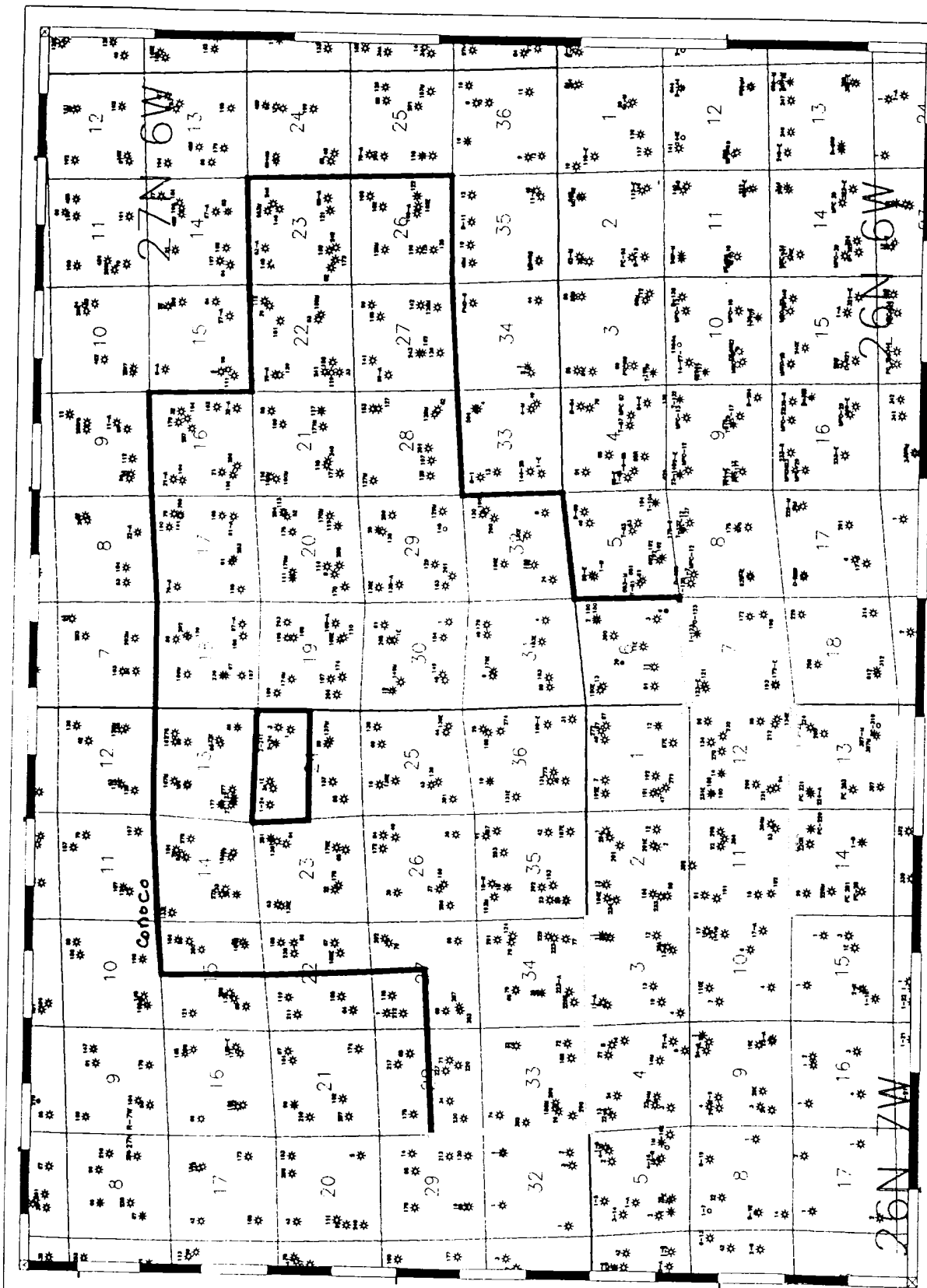

0 1 2 3 4 5 miles

SPIRIT ENERGY

RINCON UNIT
Rio Arriba Co., NM
All Wells

Date Map	Scale	CI	Job
10/20/1999	1:62500	MONK	RNC-DT