

UNITED STATES
DEPARTMENT OF THE INTERIOR

Form approved.
Budget Bureau No. 1004-0136
Expires: December 31, 1991

BUREAU OF LAND MANAGEMENT

APPLICATION FOR PERMIT TO DRILL OR DEEPEN

1a. TYPE OF WORK
DRILL **DEEPEN**

b. TYPE OF WELL
 OIL WELL GAS WELL OTHER SINGLE ZONE MULTIPLE ZONE

2. NAME OF OPERATOR
 Amoco Production Company *778* Attention: Julie L. Acevedo

3. ADDRESS AND TELEPHONE NO.
 P.O. Box 800, Denver, Colorado 80201

4. LOCATION OF WELL (Report location clearly and in accordance with any State requirements. *)
 At surface 1760FSL 1080FEL
 At proposed prod. zone

5. LEASE DESIGNATION AND SERIAL NO.
 SF-079298-B

6. IF INDIAN, ALLOTTEE OR TRIBE NAME

7. UNIT AGREEMENT NAME

8. FARM OR LEASE NAME, WELL NO.
 San Juan 28-7 Unit ¹⁰¹³ #128M

9. API WELL NO.
30-039-25419

10. FIELD AND POOL, OR WILDCAT
56 Mesaverde/Basin Dakota ⁷¹⁵⁹⁹

11. SEC., T., R., M., OR BLK. AND SURVEY OR AREA
 Section 12
 Township 27N Range 7W

12. COUNTY OR PARISH
 Rio Arriba

13. STATE
 New Mexico

14. DISTANCE IN MILES AND DIRECTION FROM NEAREST TOWN OR POST OFFICE*
 43 Miles from Aztec, N.M.

15. DISTANCE FROM PROPOSED* LOCATION TO NEAREST PROPERTY OR LEASE LINE, FT. (Also to nearest drig. unit line, if any)

16. NO. OF ACRES IN LEASE
 640 acres

17. NO. OF ACRES ASSIGNED TO THIS WELL
 E/2 320

18. DISTANCE FROM PROPOSED LOCATION* TO NEAREST WELL, DRILLING, COMPLETED, OR APPLIED FOR, ON THIS LEASE, FT.

19. PROPOSED DEPTH
 7710' TD

20. ROTARY OR CABLE TOOLS
 Rotary

21. ELEVATIONS OF NEAREST DEEPER GRUBS
 6619' GR **This section is subject to technical and procedural review pursuant to 43 CFR 3165.3 and appeal pursuant to 43 CFR 3165.4**

22. APPROX. DATE WORK WILL START*
 05-21-94

23. PROPOSED CASING AND CEMENTING PROGRAM
 DRILLING OPERATIONS AUTHORIZED ARE SUBJECT TO COMPLIANCE WITH ATTACHED "GENERAL REQUIREMENTS".

SIZE OF HOLE	GRADE, SIZE OF CASING	WEIGHT PER FOOT	SETTING DEPTH	QUANTITY OF CEMENT
14 3/4"	11 3/4"	47#	400'	390 cf Cl B W/2% CaCl(Cement to surface)
10 5/8"	8 5/8"	24# & 32#	3558'	2122 cf Cl B (Cement to surface)
7 7/8"	5 1/2"	15.5# or 17#	7710'	1265 cf CL B

Notice of Staking submitted: 04/21/94 as the San Juan 28-7 Unit #128M

Lease Description: T27N - R7W
 Sec.12: All

RECEIVED
 JUN 15 1994

OIL CON. DIV.
 DIST. 3

~~CONFIDENTIAL~~

RECEIVED
 JUN 22 1994 15
 DISTRICT MANAGER

IN ABOVE SPACE DESCRIBE PROPOSED PROGRAM: If proposal is to deepen, give data on present productive zone and proposed new productive zone. If proposal is to drill or deepen directionally, give pertinent data on subsurface locations and measured and true vertical depths. Give blowout preventer program, if any.

24. SIGNED Julie L. Acevedo TITLE Sr. Staff Assistant DATE 04-21-1994

(This space for Federal or State office use)

PERMIT NO. _____ APPROVAL DATE _____

Application approval does not warrant or certify that the applicant holds legal or equitable title to those rights in the subject lease which would entitle the applicant to conduct operations thereunder.

CONDITIONS OF APPROVAL, IF ANY:

APPROVED BY _____ TITLE _____

OK

NMOCD

*See Instructions On Reverse Side

APPROVED AS AMENDED

JUN 09 1994
DISTRICT MANAGER

Title 18 U.S.C. Section 1001, makes it a crime for any person knowingly and willfully to make to any department or agency of the United States any false, fictitious or fraudulent statements or representations as to any matter within its jurisdiction.

Submit to Appropriate District Office
 State Lease - 4 copies
 Fee Lease - 3 copies

State of New Mexico
 Energy, Minerals and Natural Resources Department

Form C-102
 Revised 1-1-89

OIL CONSERVATION DIVISION
 P.O. Box 2088
 Santa Fe, New Mexico 87504-2088

DISTRICT I
 P.O. Box 1980, Hobbs, NM 88240

DISTRICT II
 P.O. Drawer DD, Artesia, NM 88210

DISTRICT III
 1000 Rio Brazos Rd., Aztec, NM 87410

WELL LOCATION AND ACREAGE DEDICATION PLAT
 All Distances must be from the outer boundaries of the section

RECEIVED
 BLM

24 APR 22 AM 10:16

070 W. HOBBS, NM

Operator AMOCO PRODUCTION COMPANY			Lease San Juan 28-7 Unit		Well No. #128M
Unit Letter I	Section 12	Township 27 NORTH	Range 7 WEST	County RIO ARRIBA	
Actual Footage Location of Well: 1760 feet from the SOUTH line and 1080 feet from the EAST line					
Ground level Elev. 6617	Producing Formation Basin Dakota		Pool Basin Dakota	Dedicated Acreage: 320 E/2 Acres	

- Outline the acreage dedicated to the subject well by colored pencil or hachure marks on the plat below.
- If more than one lease is dedicated to the well, outline each and identify the ownership thereof (both as to working interest and royalty).
- If more than one lease of different ownership is dedicated to the well, have the interest of all owners been consolidated by communitization, unitization, force-pooling, etc.?
 Yes No If answer is "yes" type of consolidation _____
 If answer is "no" list the owners and tract descriptions which have actually been consolidated. (Use reverse side of this form if necessary.)
 No allowable will be assigned to the well until all interests have been consolidated (by communitization, unitization, forced-pooling, or otherwise) or until a non-standard unit, eliminating such interest, has been approved by the Division.

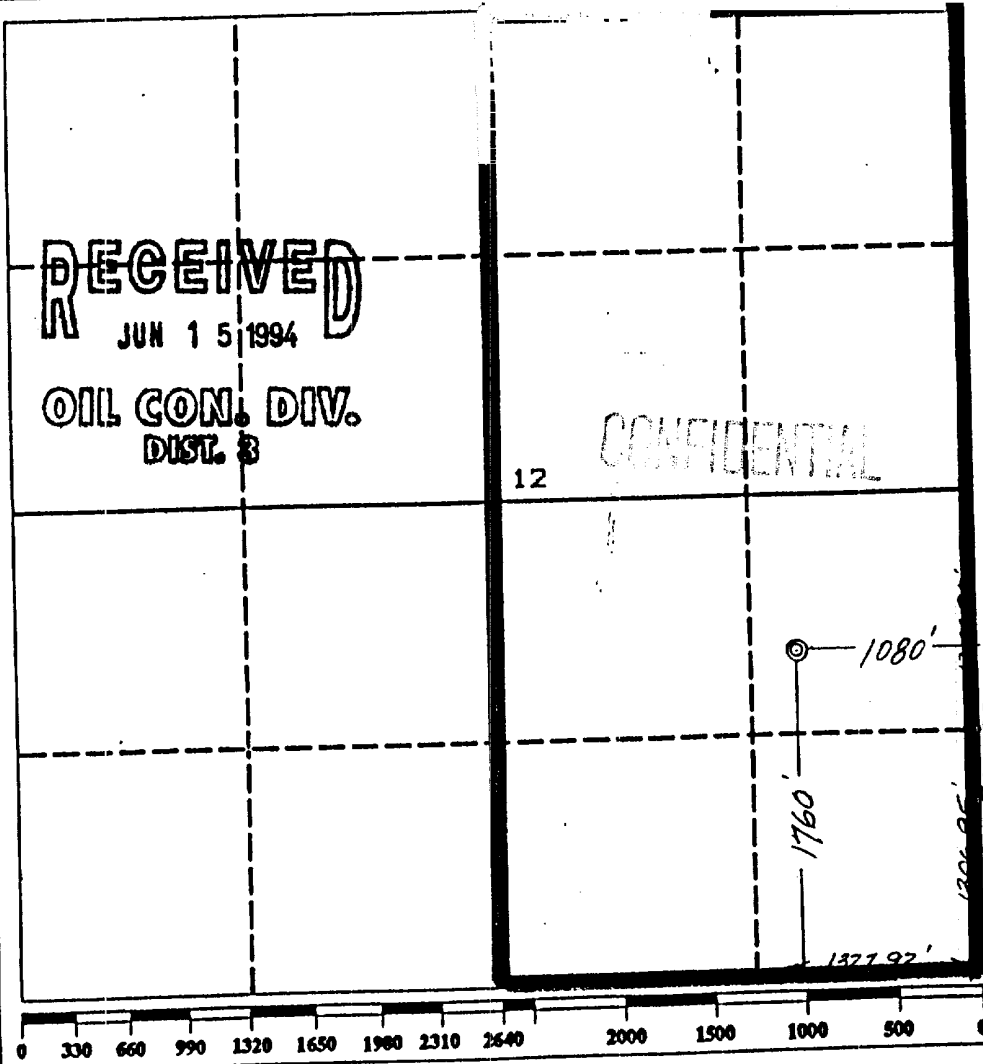

OPERATOR CERTIFICATION

I hereby certify that the information contained herein is true and complete to the best of my knowledge and belief.

Signature: *Julie L. Acevedo*
 Printed Name: Julie L. Acevedo
 Position: Sr. Staff Assistant
 Company: Amoco Production Company
 Date: 4/21/94

SURVEYOR CERTIFICATION

I hereby certify that the well location shown on this plat was plotted from field notes of actual surveys made by me or under my supervision, and that the same is true and correct to the best of my knowledge and belief.

Date Surveyed: April 18, 1994

Signature & Seal of Professional Surveyor

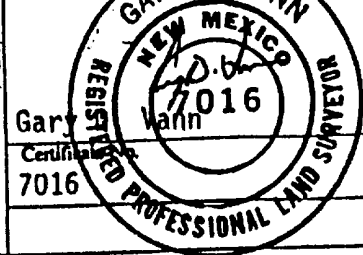

Gary D. Vann
 7016

Submit to Appropriate District Office
 State Lease - 4 copies
 Fee Lease - 3 copies

State of New Mexico
 Energy, Minerals and Natural Resources Department

Form C-102
 Revised 1-1-89

OIL CONSERVATION DIVISION

P.O. Box 2088
 Santa Fe, New Mexico 87504-2088

DISTRICT I
 P.O. Box 1980, Hobbs, NM 88240

DISTRICT II
 P.O. Drawer DD, Artesia, NM 88210

DISTRICT III
 1000 Rio Brazos Rd., Aztec, NM 87410

WELL LOCATION AND ACREAGE DEDICATION PLAT
 All Distances must be from the outer boundaries of the section

Operator AMOCO PRODUCTION COMPANY			Lease San Juan 28-7 Unit		Well No. #128M
Unit Letter I	Section 12	Township 27 NORTH	Range 7 WEST	County NMPM	RIO ARRIBA
Actual Footage Location of Well: 1760 feet from the SOUTH line and 1080 feet from the EAST line					
Ground level Elev. 6619	Producing Formation <i>Mesaville</i>		Pool <i>Mesaville Group</i>		Dedicated Acreage: 320 E/2 Acres

- Outline the acreage dedicated to the subject well by colored pencil or hachure marks on the plat below.
- If more than one lease is dedicated to the well, outline each and identify the ownership thereof (both as to working interest and royalty).
- If more than one lease of different ownership is dedicated to the well, have the interest of all owners been consolidated by communitization, unitization, force-pooling, etc.?

Yes No If answer is "yes" type of consolidation _____

If answer is "no" list the owners and tract descriptions which have actually been consolidated. (Use reverse side of this form if necessary.) _____

No allowable will be assigned to the well until all interests have been consolidated (by communitization, unitization, forced-pooling, or otherwise) or until a non-standard unit, eliminating such interest, has been approved by the Division.

OPERATOR CERTIFICATION
 I hereby certify that the information contained herein is true and complete to the best of my knowledge and belief.

Signature: *Julie L. Acevedo*
 Printed Name: Julie L. Acevedo
 Position: Sr. Staff Assistant
 Company: Amoco Production Company
 Date: 4/21/94

SURVEYOR CERTIFICATION
 I hereby certify that the well location shown on this plat was plotted from field notes of actual surveys made by me or under my supervision, and that the same is true and correct to the best of my knowledge and belief.

Date Surveyed: April 18, 1994
 Signature & Seal of Professional Surveyor: *Gary D. Vann*
 Gary D. Vann
 Registered Professional Land Surveyor
 7016

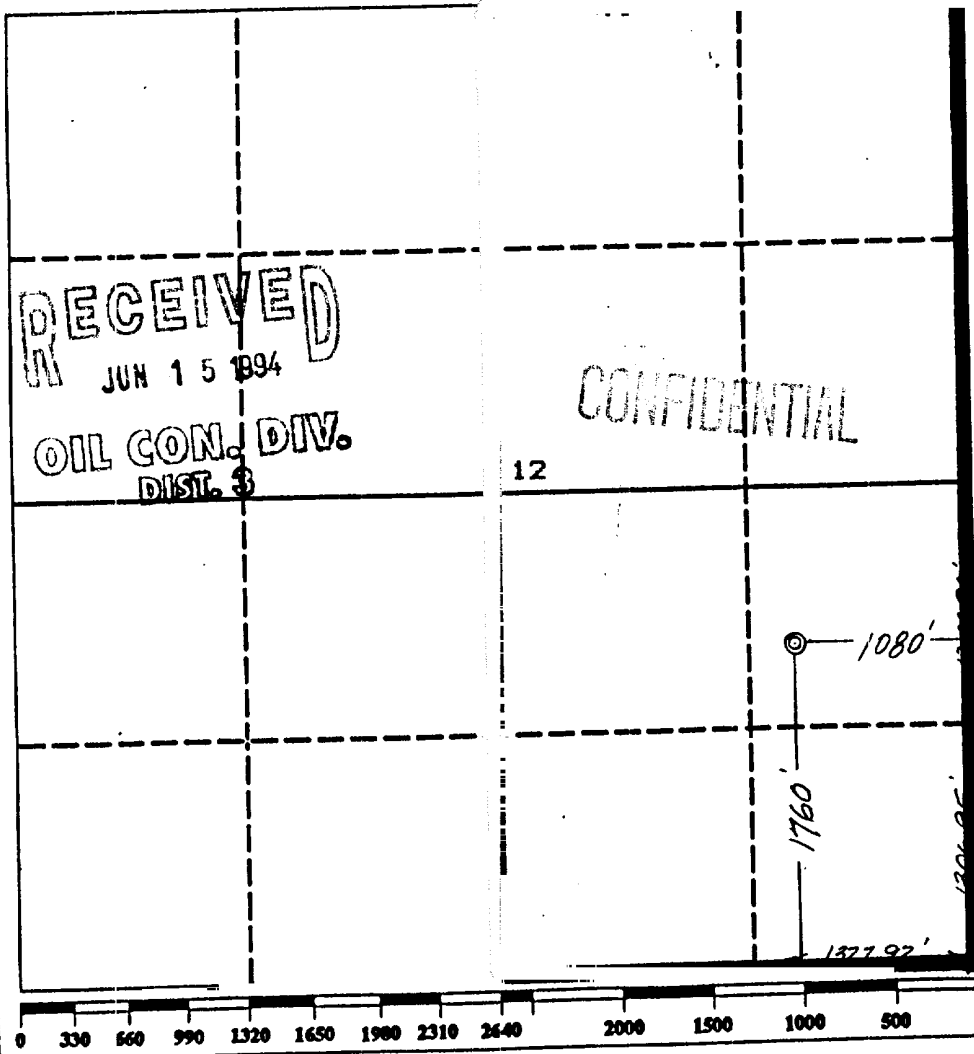

RECEIVED
 JUN 15 1994
 OIL CON. DIV.
 DIST. 3

CONFIDENTIAL

BUN RECORD

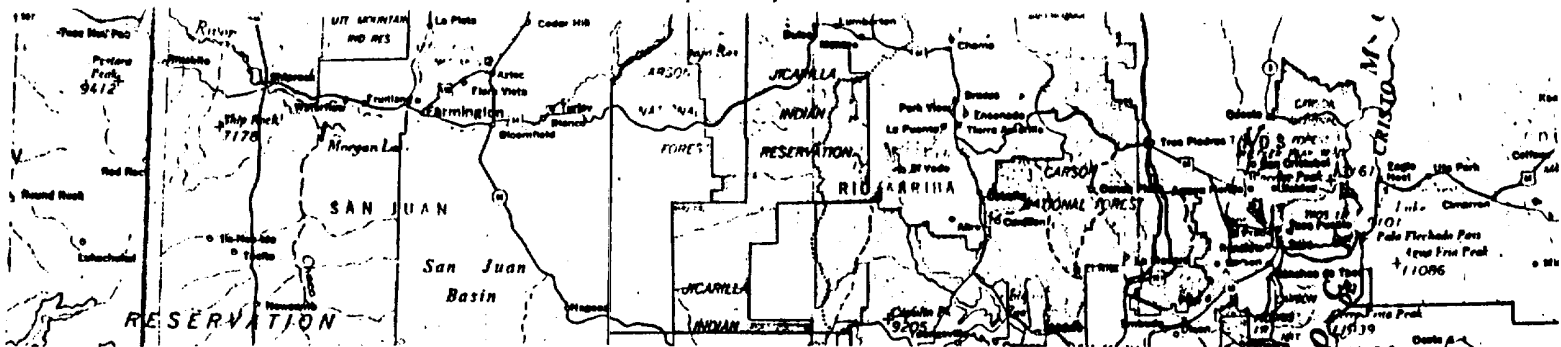

REF. # 50013

1760' F/SL 1080' F/EL

SEC. 12, T27N, R7W, NMPM

RAIL POINT: 186 miles from Marathon Co.

MUD POINT: 43 miles from Aztec, N.M.

CEMENT POINT: 47 miles from Farmington, N.M.

