

UNITED STATES
DEPARTMENT OF THE INTERIOR
BUREAU OF LAND MANAGEMENT

RECEIVED
BLM

94 AUG 24 PM 2:44

APPLICATION FOR PERMIT TO DRILL, DEEPEN, OR PLUG BACK

070 FARMINGTON, NM

1a. Type of Work DRILL	RECEIVED SEP - 2 1994	5. Lease Number SF-079367B
1b. Type of Well GAS		6. If Indian, All. or Tribe
2. Operator MERIDIAN OIL 14538	OIL CON. DIV. DIST. 3	7. Unit Agreement Name San Juan 28-6 Unit
3. Address & Phone No. of Operator PO Box 4289, Farmington, NM 87499 (505) 326-9700		8. Farm or Lease Name 1462 San Juan 28-6 Unit 9. Well Number 157M
4. Location of Well 1150' FSL, 1045' FEL Latitude 36° 32' 29", Longitude 107° 24' 47"		10. Field, Pool, Wildcat 72319 Blanco Mesa Verde/ 71599 Basin Dakota 11. Sec., Twn, Rge, Mer. Sec 25, T-27-N, R-6-W NMPM
14. Distance in Miles from Nearest Town 9 miles to Gobernador		12. County Rio Arriba
		13. State NM
15. Distance from Proposed Location to Nearest Property or Lease Line 1045'		API #: 30-039-25452 ✓
16. Acres in Lease		17. Acres Assigned to Well E/2/320 E/2/320 ✓
18. Distance from Proposed Location to Nearest Well, Drlg, Compl, or Applied for on this Lease 2000'		
19. Proposed Depth 7630'		20. Rotary or Cable Tools Rotary
21. Elevations (DF, FT, GR, Etc.) 6528' GR		22. Approx. Date Work will Start 3rd quarter 1994
23. Proposed Casing and Cementing Program See Operations Plan attached <small>This section is subject to review and procedural review pursuant to 43 CFR 3165.3 and appeal pursuant to 43 CFR 3165.4</small>		DRILLING OPERATIONS AUTHORIZED ARE SUBJECT TO COMPLIANCE WITH ATTACHED "GENERAL REQUIREMENTS"
24. Authorized by: <u>[Signature]</u> Regional Drilling Engineer		Date 8/23/94

PERMIT NO. _____ APPROVAL DATE _____
APPROVED BY _____ TITLE _____ DATE _____

Archaeological Report submitted by Arboles Contract Archaeology Tech Report #533 06-14-94
Threatened and Endangered Species Report to be submitted
NOTE: This format is issued in lieu of U.S. BLM Form 3160-3

**APPROVED
AS AMENDED**

[Handwritten initials]

NMOC D

AUG 31 1994
[Signature]
DISTRICT MANAGER

District I
 PO Box 1980, Hobbs, NM 88241-1980
 District II
 PO Drawer DD, Artesia, NM 88211-0719
 District III
 1000 Rio Brazos Rd., Aztec, NM 87410
 District IV
 PO Box 2088, Santa Fe, NM 87504-2088

State of New Mexico
 Energy, Minerals & Natural Resources Department

Form C-102
 Revised February 21, 1994
 Instructions on back
 Submit to Appropriate District Office
 State Lease - 4 Copies
 Fee Lease - 3 Copies

OIL CONSERVATION DIVISION

PO Box 2088, AUG 24 PM 2:44
 Santa Fe, NM 87504-2088

070 FARMINGTON, NM

AMENDED REPORT

WELL LOCATION AND ACREAGE DEDICATION PLAT

1 API Number 30-039-25452		2 Pool Code 72319/71599		3 Pool Name Blanco Mesa Verde/Basin Dakota	
4 Property Code 7462		5 Property Name San Juan 28-6 Unit			6 Well Number 157M
7 OGRID No. 14538		8 Operator Name MERIDIAN OIL INC.			9 Elevation 6528'

10 Surface Location

UL or lot no.	Section	Township	Range	Lot Idn	Feet from the	North/South line	Feet from the	East/West line	County
P	25	27 N	6 W		1150	South	1045	East	R.A.

11 Bottom Hole Location If Different From Surface

UL or lot no.	Section	Township	Range	Lot Idn	Feet from the	North/South line	Feet from the	East/West line	County

12 Dedicated Acres 320/320	13 Joint or Infill I	14 Consolidation Code	15 Order No.
-------------------------------	-------------------------	-----------------------	--------------

NO ALLOWABLE WILL BE ASSIGNED TO THIS COMPLETION UNTIL ALL INTERESTS HAVE BEEN CONSOLIDATED OR A NON-STANDARD UNIT HAS BEEN APPROVED BY THE DIVISION

16 RECEIVED SEP - 2 1994 OIL CON. DIV. DIST. 3 5222.58'	5297.16'		17 OPERATOR CERTIFICATION I hereby certify that the information contained herein is true and complete to the best of my knowledge and belief Signature: <i>Peggy Bradfield</i> Printed Name: Peggy Bradfield Title: Regulatory Representative Date: 8-15-94	
	25			FEE 2653.40' 18 SURVEYOR CERTIFICATION I hereby certify that the well location shown on this plat was plotted from field notes of actual surveys made by me or under my supervision, and that the same is true and correct to the best of my belief. Date of Survey: 5-14-94 Signature and Seal of Professional Surveyor: <i>[Signature]</i> 6857 Certificate Number
	NM SF-079367-B			
	1045'	1150'		
	5276.70'			

OPERATIONS PLAN

Well Name: San Juan 28-6 Unit #157M
Location: 1150'FSL, 1045'FEL Section 25, T-27-N, R-6-W
 Rio Arriba County, NM
 Latitude 36° 32' 29", Longitude 107° 24' 47"
Formation: Blanco Mesa Verde/Basin Dakota
Elevation: 6528'GL

<u>Formation Tops:</u>	<u>Top</u>	<u>Bottom</u>	<u>Contents</u>
Surface	San Jose	2397'	
Ojo Alamo	2397'	2690'	aquifer
Kirtland	2690'	2937'	
Fruitland	2937'	3170'	gas
Pictured Cliffs	3170'	3340'	gas
Lewis	3340'	3722'	
Intermediate TD	3490'		
Chacra	3722'	4850'	
Mesa Verde	4850'	4850'	gas
Massive Cliff House	4850'	4940'	gas
Menefee	4940'	5377'	gas
Point Lookout	5377'	5877'	gas
Mancos	5877'	6347'	
7" Drilling Liner TD	6077'		
Gallup	6347'	7301'	
Greenhorn	7301'	7361'	
Graneros	7361'	7517'	
Dakota	7517'		gas
TD (4 1/2"liner)	7630'		

Logging Program:

Openhole Wireline Logging -
 DIL/LDT/CNL/Temp/NGT/GR/CAL/FMS

Mud Program:

<u>Interval</u>	<u>Type</u>	<u>Weight</u>	<u>Vis.</u>	<u>Fluid Loss</u>
0- 200'	Spud	8.4-8.9	40-50	no control
200-3490'	LSND	8.4-9.1	30-60	no control
3490'-7630'	Gas	n/a	n/a	n/a

Pit levels will be visually monitored to detect gain or loss of fluid control.

Casing Program:

<u>Hole Size</u>	<u>Depth Interval</u>	<u>Csg.Size</u>	<u>Wt.</u>	<u>Grade</u>
17 1/2"	0' - 200'	13 3/8"	48.0#	K-55
12 1/4"	0' - 3490'	9 5/8"	36.0#	K-55
	9 5/8" stage tool @ 2887'			
8 3/4"	3340' - 6077'	7"	23.0#	K-55 liner
6 1/4"	5827' - 7630'	4 1/2"	11.6#	N-80 liner

Tubing Program:

0' - 5800'	2 3/8"	4.7#	K-55
0' - 7630'	2 3/8"	4.7#	K-55

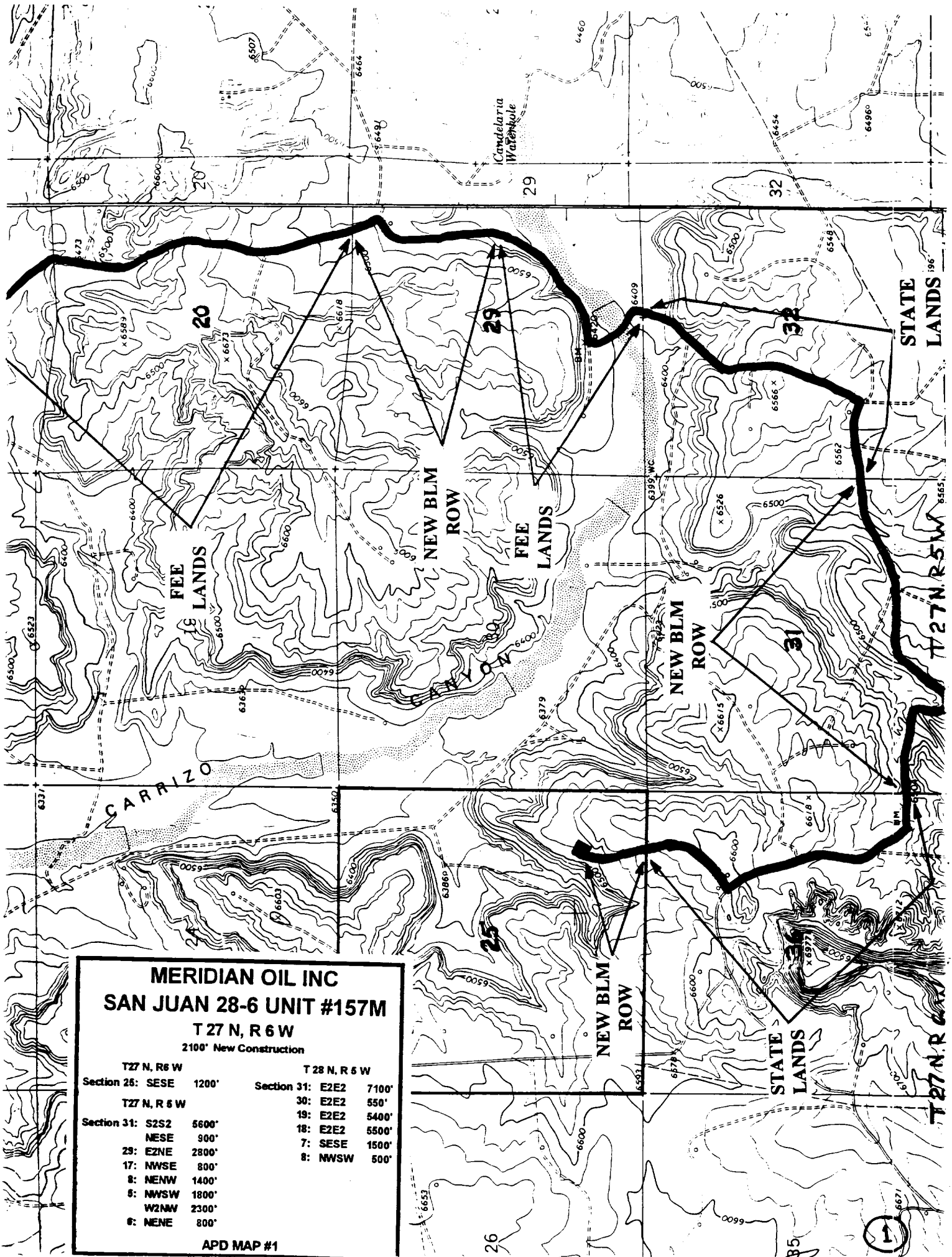

**MERIDIAN OIL INC
SAN JUAN 28-6 UNIT #157M**

T 27 N, R 6 W

2100' New Construction

T 27 N, R 6 W		T 28 N, R 6 W	
Section 26: SESE	1200'	Section 31: E2E2	7100'
T 27 N, R 6 W		30: E2E2	550'
Section 31: S2S2	5600'	19: E2E2	5400'
NESE	900'	18: E2E2	5500'
29: EZNE	2800'	7: SESE	1500'
17: NWSE	800'	8: NWSW	500'
8: NENW	1400'		
5: NWSW	1800'		
W2NW	2300'		
6: NENE	800'		

APD MAP #1

