

DISTRICT I

P.O. Box 1980, Hobbs, NM 88241-1980

DISTRICT II

811 South First St., Artesia, NM 88210-2835

DISTRICT III

1000 Rio Brazos Rd, Aztec, NM 87410-1693

State of New Mexico
Energy, Minerals and Natural Resources Department

OIL CONSERVATION DIVISION

2040 S. Pacheco
Santa Fe, New Mexico 87505-6429

APPLICATION FOR DOWNHOLE COMMINGLING

Form C-107-A
New 3-12-96

APPROVAL PROCESS :

\_X\_ Administrative \_\_\_ Hearing

EXISTING WELLBORE

\_\_\_ YES \_\_\_ x\_ NO

Burlington Resources Oil & Gas Company

PO Box 4289, Farmington, NM 87499

Operator

Address

San Juan 27-4 Unit

139A

B 09-27N-04W

Rio Arriba

Lease

Well No.

Unit Ltr. - Sec - Twp - Rge

County

Spacing Unit Lease Types: (check 1 or more)

OGRID NO. 14538 Property Code 7452 API NO. 30-039-not assigned Federal x State (and/or) Fee

Table with 4 columns: The following facts are submitted in support of downhole commingling, Upper Zone, Intermediate Zone, Lower Zone. Rows include Pool Name, Pay Section, Type of production, Method of Production, Bottomhole Pressure, Oil Gravity, Producing or Shut-in, Production Marginal?, and Fixed Percentage Allocation.

9. If allocation formula is based upon something other than current or past production, or is based upon some other method, submit attachments with supporting data and/or explaining method and providing rate projections or other required data.

10. Are all working, overriding, and royalty interests identical in all commingled zones? Yes x No
If not, have all working, overriding, and royalty interests been notified by certified mail? X Yes No
Have all offset operators been given written notice of the proposed downhole commingling? X Yes No

11. Will cross-flow occur? x Yes No If yes, are fluids compatible, will the formations not be damaged, will any cross-flowed production be recovered, and will the allocation formula be reliable. x Yes No (If No, attach explanation)

12. Are all produced fluids from all commingled zones compatible with each other? x Yes No

13. Will the value of production be decreased by commingling? Yes X No (If Yes, attach explanation)

14. If this well is on, or communitized with, state or federal lands, either the Commissioner of Public Lands or the United States Bureau of Land Management has been notified in writing of this application. X Yes No

15. NMOCD Reference Cases for Rule 303(D) Exceptions: ORDER NO(S). Reference Order

16. ATTACHMENTS:

- \* C-102 for each zone to be commingled showing its spacing unit and acreage dedication.
\* Production curve for each zone for at least one year. (If not available, attach explanation.)
\* For zones with no production history, estimated production rates and supporting data.
\* Data to support allocation method or formula.
\* Notification list of all offset operators.
\* Notification list of working, overriding, and royalty interests for uncommon interest cases.
\* Any additional statements, data, or documents required to support commingling.

I hereby certify that the information above is true and complete to the best of my knowledge and belief.

SIGNATURE Sean Woolverton TITLE: Reservoir Engineer DATE: 06-29-98

TYPE OR PRINT NAME Sean Woolverton TELEPHONE NO. ( 505 ) 326-9700

District I  
 PO Box 1980, Hobbs NM 88241-1980  
 District II  
 PO Drawer 100, Arcoma, NM 87211-0719  
 District III  
 1000 Rio Brazos Rd., Aztec, NM 87410  
 District IV  
 PO Box 2088, Santa Fe, NM 87504-2088

State of New Mexico  
 Energy, Minerals & Natural Resources Department  
**OIL CONSERVATION DIVISION**  
 PO Box 2088  
 Santa Fe, NM 87504-2088

Form C-1  
 Revised February 21, 19  
 Instructions on b:  
 Submit to Appropriate District Off  
 State Lease - 4 Cop  
 Fee Lease - 3 Cop

AMENDED REPO.

**WELL LOCATION AND ACREAGE DEDICATION PLAT**

1 API Number 30-039-		2 Pool Code 72319/71599		3 Pool Name Blanco Mesaverde/Basin Dakota	
4 Property Code 7452		5 Property Name SAN JUAN 27-4 UNIT			6 Well Number # 139A
7 OGRID No. 14538		8 Operator Name BURLINGTON RESOURCES OIL & GAS COMPANY			9 Elevation 7154

10 Surface Location

UL or Lot No.	Section	Township	Range	Lot Idn	Feet from the	North/South line	Feet from the	East/West line	County
B	9	27 N	4 W		610	NORTH	1560	EAST	RIO ARRIE

11 Bottom Hole Location If Different From Surface

UL or lot no.	Section	Township	Range	Lot Idn	Feet from the	North/South line	Feet from the	East/West line	County

12 Dedication Acres MV-E/320 DK-E/320	13 Joint or Infill	14 Consolidation Code	15 Order No.
---	--------------------	-----------------------	--------------

**NO ALLOWABLE WILL BE ASSIGNED TO THIS COMPLETION UNTIL ALL INTEREST HAVE BEEN CONSOLIDATED OR A NON-STANDARD UNIT HAS BEEN APPROVED BY THE DIVISION**

<p>RECEIVED          JUL 8 1998          OIL CON. DIV.          DIST. 3</p>	<p>5274'(R)</p>	<p>610'</p>	<p>1560'</p>	<p>17 OPERATOR CERTIFICATION          I hereby certify that the information contained herein is true and complete to the best of my knowledge and belief.</p> <p>Signature          Peggy Bradfield          Printed Name          Regulatory Administrator          Title          Date</p>
	<p>5280'(R)</p>	<p>9</p>	<p>NMSF - 080668</p>	
	<p>5264'(R)</p>			

San Juan 27-4 Unit #139A  
 Expected Production Curve  
 Blanco Mesaverde

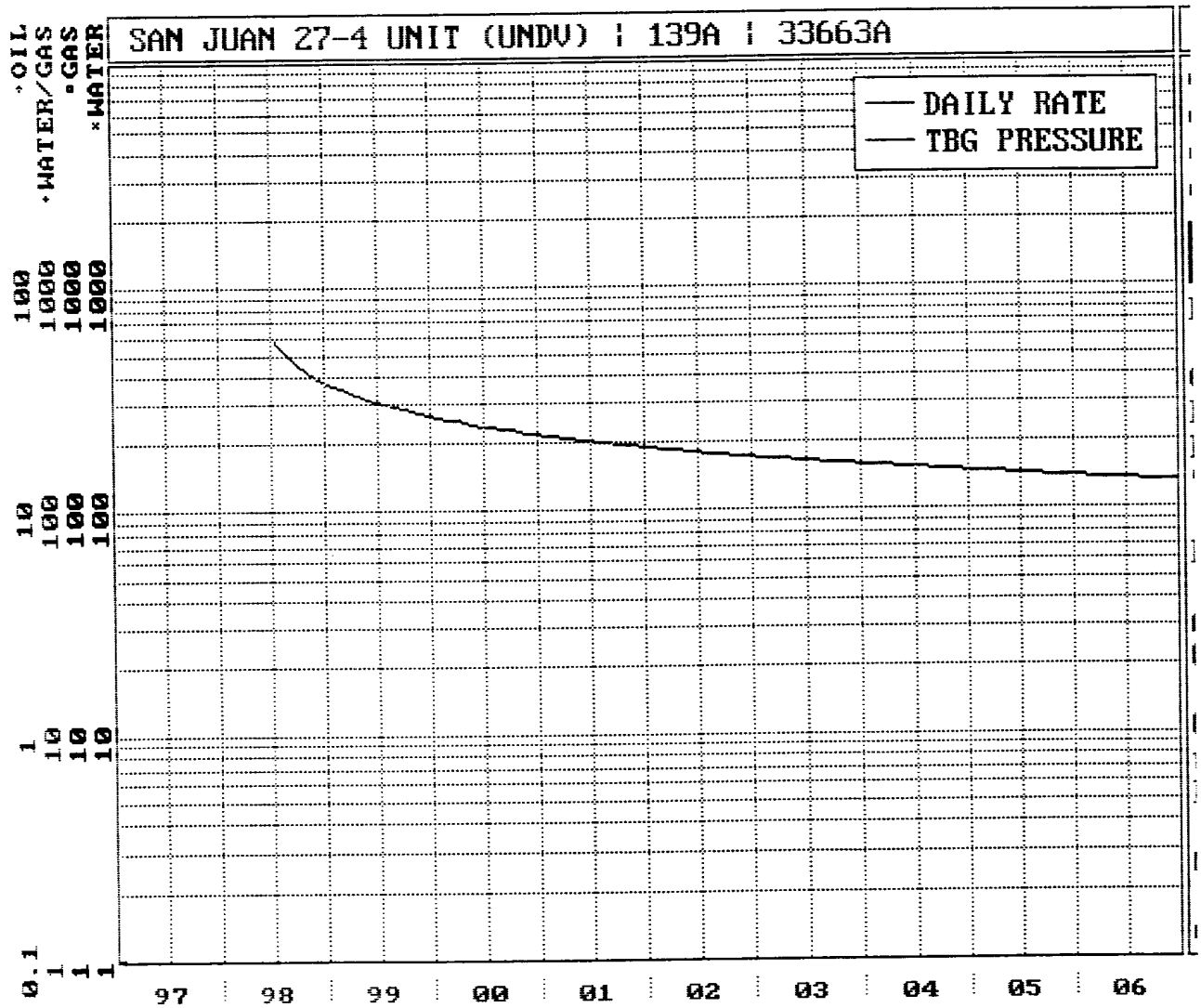

San Juan 27-4 Unit #139A  
Expected Production Curve  
Basin Dakota

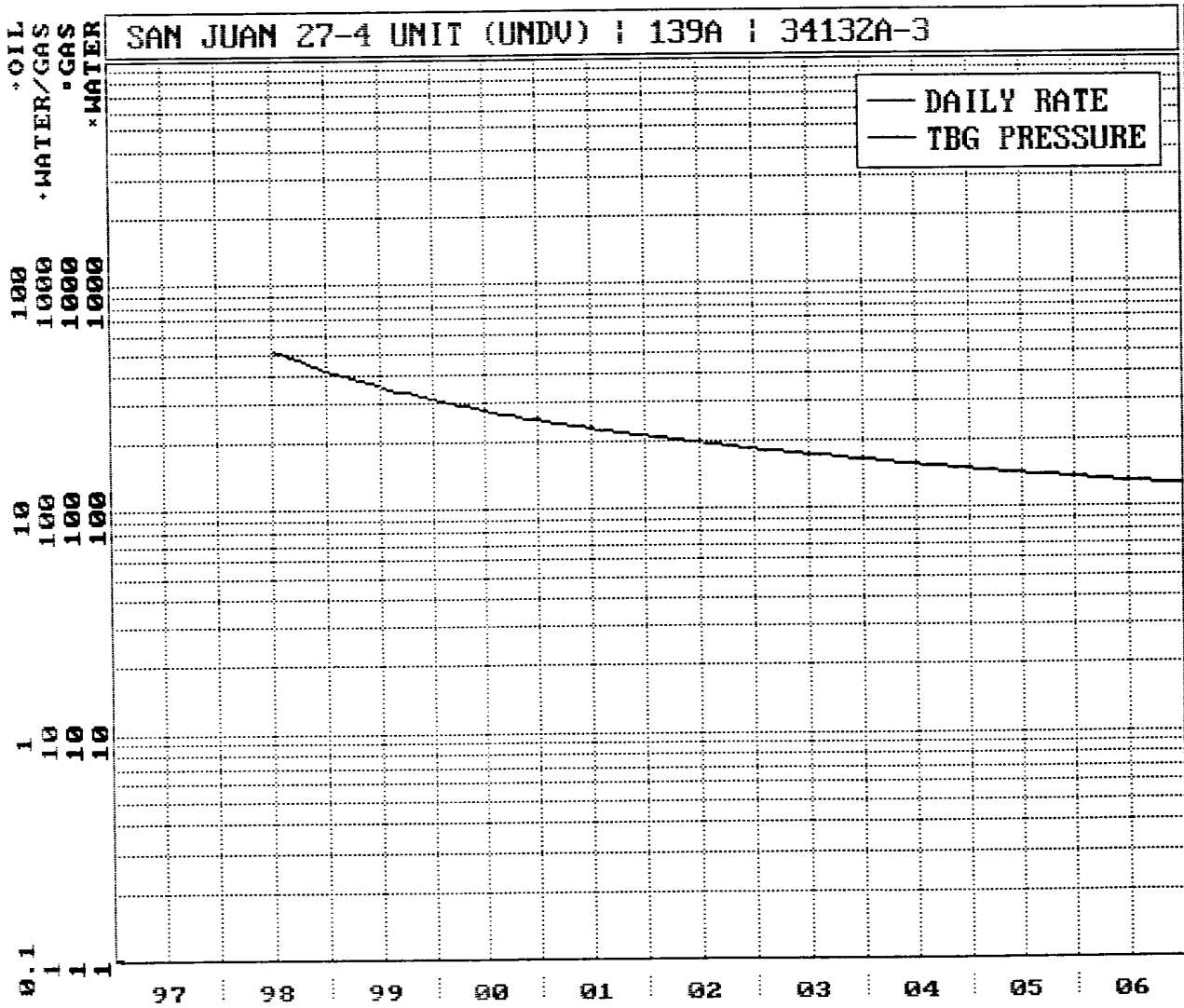

**SJ 27-4 Unit #139A**  
 Bottom Hole Pressures  
 Flowing and Static BHP  
 Cullender and Smith Method  
 Version 1.0 3/13/94

<b>Mesaverde</b>		<b>Dakota</b>	
<b><u>MV-Current</u></b>		<b><u>DK-Current</u></b>	
GAS GRAVITY	0.662	GAS GRAVITY	0.598
COND. OR MISC. (C/M)	C	COND. OR MISC. (C/M)	C
%N2	0.29	%N2	0.36
%CO2	1.24	%CO2	1.71
%H2S	0	%H2S	0
DIAMETER (IN)	2.375	DIAMETER (IN)	1.5
DEPTH (FT)	6593	DEPTH (FT)	8586
SURFACE TEMPERATURE (DEG F)	60	SURFACE TEMPERATURE (DEG F)	60
BOTTOMHOLE TEMPERATURE (DEG F)	137	BOTTOMHOLE TEMPERATURE (DEG F)	198
FLOWRATE (MCFPD)	0	FLOWRATE (MCFPD)	0
SURFACE PRESSURE (PSIA)	519	SURFACE PRESSURE (PSIA)	931
BOTTOMHOLE PRESSURE (PSIA)	609.0	BOTTOMHOLE PRESSURE (PSIA)	1117.5
<b><u>MV-Original</u></b>		<b><u>DK-Original</u></b>	
GAS GRAVITY	0.662	GAS GRAVITY	0.598
COND. OR MISC. (C/M)	C	COND. OR MISC. (C/M)	C
%N2	0.29	%N2	0.36
%CO2	1.24	%CO2	1.71
%H2S	0	%H2S	0
DIAMETER (IN)	2.375	DIAMETER (IN)	1.5
DEPTH (FT)	6593	DEPTH (FT)	8586
SURFACE TEMPERATURE (DEG F)	60	SURFACE TEMPERATURE (DEG F)	60
BOTTOMHOLE TEMPERATURE (DEG F)	137	BOTTOMHOLE TEMPERATURE (DEG F)	198
FLOWRATE (MCFPD)	0	FLOWRATE (MCFPD)	0
SURFACE PRESSURE (PSIA)	1171	SURFACE PRESSURE (PSIA)	2624
BOTTOMHOLE PRESSURE (PSIA)	1397.9	BOTTOMHOLE PRESSURE (PSIA)	3181.9

Page No.: 1  
Print Time: Fri Jan 16 09:33:55 1998  
Property ID: 3779  
Property Name: SAN JUAN 27-4 UNIT | 146 | 44654A-1  
Table Name: K:\ARIES\RR98PDP\TEST.DBF

San Juan 27-4 # 139A  
Mesaverde Offset

--DATE-- M SIWHP  
..... Psi

10/14/82	1171.0	- original
07/29/83	710.0	
06/20/84	815.0	
11/05/85	529.0	
04/21/86	585.0	
08/07/89	533.0	
02/18/91	541.0	
08/20/91	553.0	
05/03/93	519.0	- current







**BURLINGTON RESOURCES OIL AND GAS COMPANY**

**San Juan 27-4 Unit #139A**

**OFFSET OPERATOR/OWNER PLAT**

**Mesaverde / Dakota Formations Commingle Well**

**Township 27 North, Range 4 West**

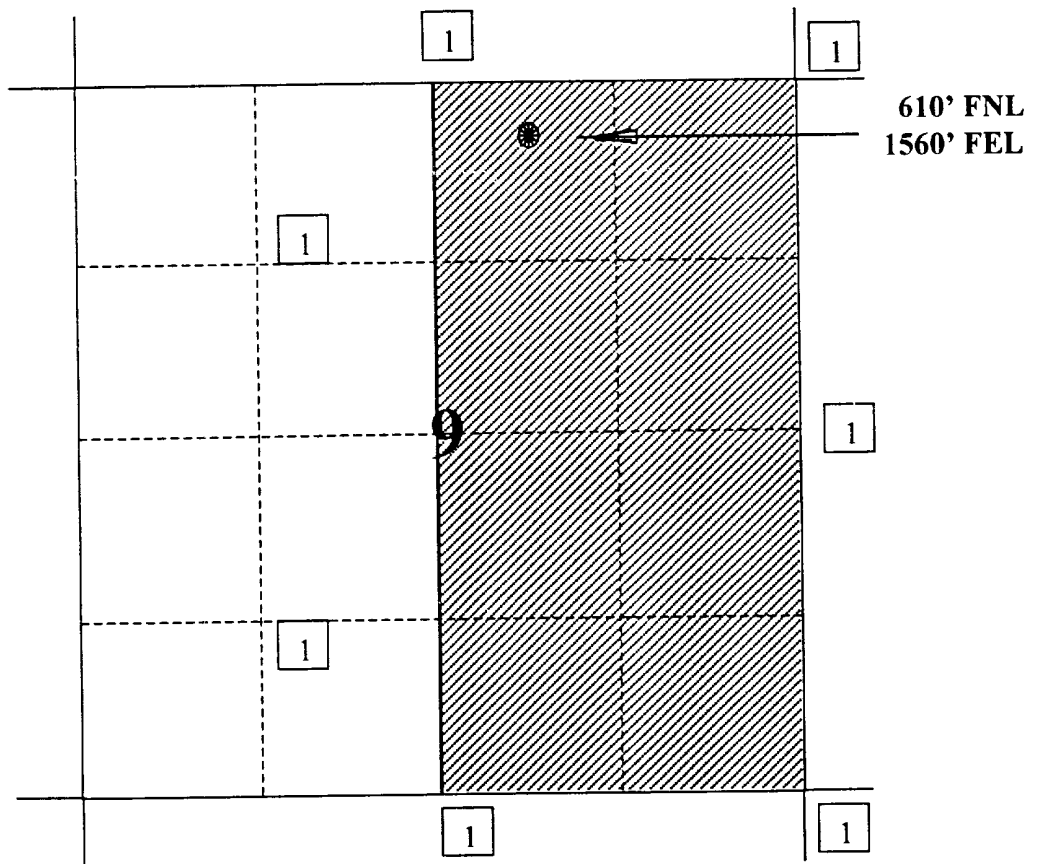

1) Burlington Resources