

# El Paso Natural Gas Company

El Paso, Texas

June 8, 1961

ADDRESS REPLY TO  
POST OFFICE BOX 997  
EL PASO, NEW MEXICO

Mr. A. L. Porter, Secretary & Director  
Oil Conservation Commission  
Box 871  
Santa Fe, New Mexico

Dear Mr. Porter:

This is a request for administrative approval for an unorthodox gas well location in the Blanco Mesa Verde Pool.

It is intended to locate the well, El Paso Natural Gas Co. San Juan 27-4 Unit No. 31, 810 feet from the South line and 690 feet from the West line of Section 7, Township 27 North, Range 4 West, N.M.F.M., Rio Arriba County, New Mexico. The W/2 of Section 7 is dedicated to this well.

As shown on the enclosed plat, the SW/4 of Section 7 consists of rock ledges. The only accessible land for a well in the SW/4 is that which makes the location unorthodox. It is, therefore planned to make the location unorthodox in order that the extremely high cost of constructing an orthodox location be avoided.

Since El Paso Natural Gas Co. holds all leases within the 790' radius the consent to said location has not been sought from any other operators.

I am enclosing two copies of the certified well location plat, and two copies of the notice of intention to drill.

Yours very truly,

ORIGINAL SIGNED E. S. OBERLY  
E. S. Oberly,  
Division Petroleum Engineer

ESO:dgb  
cc: Emery Arnold  
Sam Smith  
Phil McGrath

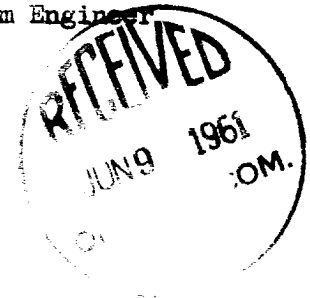

# THE UNIVERSITY OF CHICAGO

OFFICE OF THE DEAN

1961

Dear Mr. [Name]:

I am very pleased to hear

that you are interested in

the [Name] program. We are very interested in your interest in the program.

The [Name] program is a very important part of the University of Chicago. It is a program that is designed to help students who are interested in the [Name] field. The program is designed to help students who are interested in the [Name] field.

The [Name] program is a very important part of the University of Chicago. It is a program that is designed to help students who are interested in the [Name] field. The program is designed to help students who are interested in the [Name] field.

I am very pleased to hear that you are interested in the [Name] program. We are very interested in your interest in the program.

The [Name] program is a very important part of the University of Chicago. It is a program that is designed to help students who are interested in the [Name] field. The program is designed to help students who are interested in the [Name] field.

Sincerely,

Yours truly,  
[Signature]

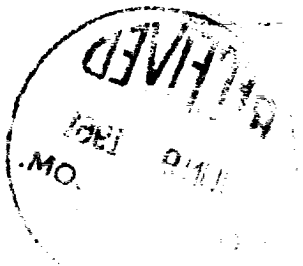

Very truly,  
[Signature]

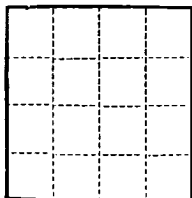

(SUBMIT IN TRIPLICATE)

UNITED STATES  
DEPARTMENT OF THE INTERIOR  
GEOLOGICAL SURVEY

Land Office Santa Fe  
Lease No. 060673  
Unit San Juan 27-4 Unit  
14-00-001-1054

## SUNDRY NOTICES AND REPORTS ON WELLS

NOTICE OF INTENTION TO DRILL.....	<input checked="" type="checkbox"/>	SUBSEQUENT REPORT OF WATER SHUT-OFF.....	
NOTICE OF INTENTION TO CHANGE PLANS.....		SUBSEQUENT REPORT OF SHOOTING OR ACIDIZING.....	
NOTICE OF INTENTION TO TEST WATER SHUT-OFF.....		SUBSEQUENT REPORT OF ALTERING CASING.....	
NOTICE OF INTENTION TO RE-DRILL OR REPAIR WELL.....		SUBSEQUENT REPORT OF RE-DRILLING OR REPAIR.....	
NOTICE OF INTENTION TO SHOOT OR ACIDIZE.....		SUBSEQUENT REPORT OF ABANDONMENT.....	
NOTICE OF INTENTION TO PULL OR ALTER CASING.....		SUPPLEMENTARY WELL HISTORY.....	
NOTICE OF INTENTION TO ABANDON WELL.....			

(INDICATE ABOVE BY CHECK MARK NATURE OF REPORT, NOTICE, OR OTHER DATA)

June 8, 1961

Well No. 31 is located 610 ft. from S line and 620 ft. from W line of sec. 7

SW/4 Sec. 7 27N 4W N.M.P.M.  
(1/4 Sec. and Sec. No.) (Twp.) (Range) (Meridian)  
Blanco Mesa Verde Rio Arriba New Mexico  
(Field) (County or Subdivision) (State or Territory)

The elevation of the derrick floor above sea level is 6713 ft.

### DETAILS OF WORK

(State names of and expected depths to objective sands; show sizes, weights, and lengths of proposed casings; indicate mudding jobs, cementing points, and all other important proposed work)

It is intended to drill a well with rotary tools thru the Mesa Verde formation. Mud circulation will be used thru the Pictured Cliffs and set intermediate casing. Gas circulation will be used thru the Mesa Verde and production liner will be set. Possible productive intervals will be perforated and fractured. Est. Total Depth 5941'.

#### Casing Program:

9 5/8" set at 160' with 170 sacks of cement circulated to the surface.  
7" set at 3611' with 120 sacks of cement - 150% to cover Ojo Alamo  
4 1/2" Liner set at 5911' with 260 sacks of cement - 200% to cover liner top.

The W/2 of Section 7 is dedicated to this well.

I understand that this plan of work must receive approval in writing by the Geological Survey before operations may be commenced.

Company El Paso Natural Gas Company

Address Box 990

Farlington, New Mexico

By Original Signed D. W. Meenan

Title Petroleum Engineer

## NEW MEXICO OIL CONSERVATION COMMISSION

## Well Location and Acreage Dedication Plat

Section A.

Date **May 18, 1961**

Operator **EL PASO NATURAL GAS COMPANY** Lease **SAN JUAN 27-4 UNIT SF 080673**  
 Well No. **31** Unit Letter **M** Section **7** Township **27-N** Range **4-W** NMPM  
 Located **810** Feet From **SOUTH** Line, **690** Feet From **WEST** Line  
 County **RIO ARriba** G. L. Elevation **6703** Dedicated Acreage **321.56** Acres  
 Name of Producing Formation **MESA VERDE** Pool **BLANCO M.V.**

1. Is the Operator the only owner in the dedicated acreage outlined on the plat below?  
 Yes ☐ No ☒
2. If the answer to question one is "no", have the interests of all the owners been consolidated by communitization agreement or otherwise? Yes ☒ No ☐ If answer is "yes", Type of Consolidation:  
~~Joint Agreement~~
3. If the answer to question two is "no", list all the owners and their respective interests below:

Owner	Land Description
-------	------------------

Section B.

This is to certify that the information in Section A above is true and complete to the best of my knowledge and belief.

(Operator)  
Original Signed **D. W. Meehan**

(Representative)

(Address)

Note: All distances must be from outer boundaries of section.

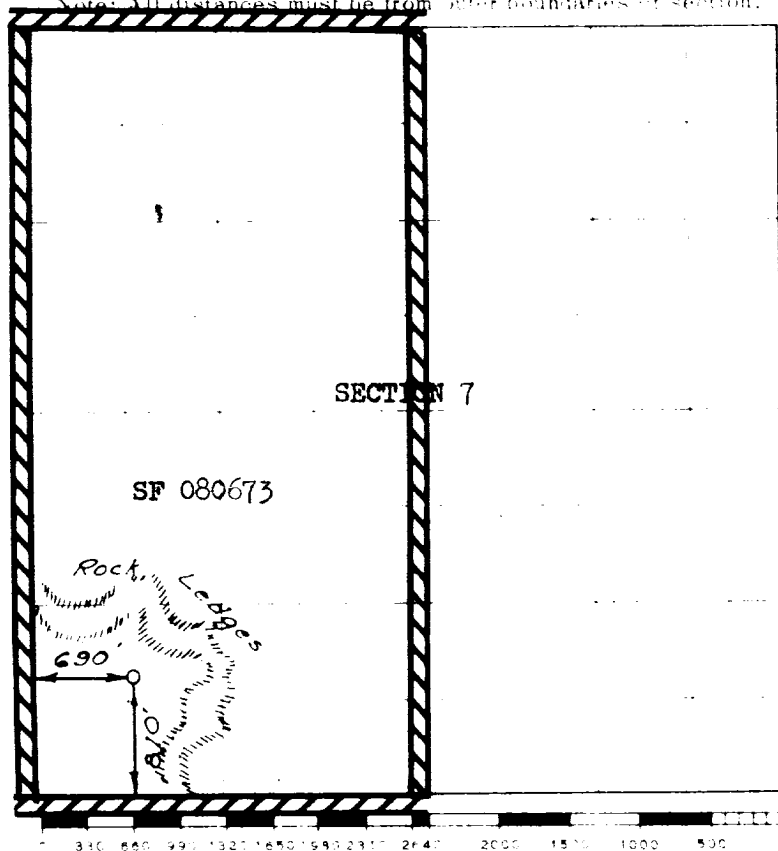

Scale 4 inches equal 1 mile

This is to certify that the above plat was prepared from field notes of actual surveys made by me or under my supervision and that the same are true and correct to the best of my knowledge and belief.

(Seal)

Farmington, New Mexico

Date Surveyed **April 10, 1961**

*Paul O. Silver*  
 Registered Professional Engineer and/or Land Surveyor