

NEW MEXICO OIL CONSERVATION COMMISSION  
Santa Fe, New Mexico

Form O-101  
Revised (12/1/55)

NOTICE OF INTENTION TO DRILL

Notice must be given to the District Office of the Oil Conservation Commission and approval obtained before drilling or recompletion begins. If changes in the proposed plan are considered advisable, a copy of this notice showing such changes will be returned to the tender. Submit this notice in QUINTUPLICATE. One copy will be returned following approval. See additional instructions in Rules and Regulations of the Commission. If State Land submit 6 Copies Attach Form O-128 in triplicate to first 3 copies of form O-101

Farmington, New Mexico

October 10, 1962

(Place)

(Date)

OIL CONSERVATION COMMISSION  
SANTA FE, NEW MEXICO

Gentlemen:

You are hereby notified that it is our intention to commence the Drilling of a well to be known as  
**El Paso Natural Gas Company**

(Company or Operator)

Rincon Unit

Well No.

168

A

The well is

(Lease)

(Unit)

located 1190 feet from the North line and 1190 feet from the

East

Line of Section

36

T.

27N

R.

7W

NMPM.

(GIVE LOCATION FROM SECTION LINE)

Basin Dakota

Pool,

Rio Arriba

County

If State Land the Oil and Gas Lease is No

E-290-28

If patented land the owner is

Address

We propose to drill well with drilling equipment as follows: **Mud drill with rotary tools thru the Dakota formation**

The status of plugging bond is **Statewide**

Drilling Contractor **Brannon & Murray**

We intend to complete this well in the **Dakota**

formation at an approximate depth of **7538**

CASING PROGRAM

We propose to use the following strings of Casing and to cement them as indicated:

Size of Hole	Size of Casing	Weight per Foot	New or Second Hand	Depth	Backs Cement
13 3/4"	9 5/8"	40#	New	300	210
8 3/4"					
7 7/8"	4 1/2"	11.6, 10.5, 11.6#	New	7538	841 in 3 stages

If changes in the above plans become advisable we will notify you immediately.

ADDITIONAL INFORMATION (If recompletion give full details of proposed plan of work.)

Possible producing zones in the Dakota formation will be perforated and fractured.

The N/2 of Section 36 is dedicated to this well.

Approved  
Except as follows:

10-17, 1962

Sincerely yours,

**El Paso Natural Gas Company**

(Company or Operator)

By

*H. E. McAnally*

Position

**Petroleum Engineer**

Send Communications regarding well to

Name

**E. S. Oberly**

Address

**Box 990, Farmington, New Mexico**

OIL CONSERVATION COMMISSION

By

*C. E. Hines*

## NEW MEXICO OIL CONSERVATION COMMISSION

## Well Location and Acreage Dedication Plat

Section A.

Date **OCTOBER 5, 1962**

Operator **EL PASO NATURAL GAS COMPANY** Lease **RINCON UNIT E-290-28**  
 Well No. **168** Unit Letter **A** Section **36** Township **27-N** Range **7-W** NMPM  
 Located **1190** Feet From **NORTH** Line, **1190** Feet From **EAST** Line  
 County **RIO ARriba** G. L. Elevation **6586** Dedicated Acreage **320** Acres  
 Name of Producing Formation **DAKOTA** Pool **BASIN DAKOTA**

1. Is the Operator the only owner in the dedicated acreage outlined on the plat below?  
 Yes **XX** No \_\_\_\_\_
2. If the answer to question one is "no", have the interests of all the owners been consolidated by communitization agreement or otherwise? Yes \_\_\_\_\_ No \_\_\_\_\_. If answer is "yes", Type of Consolidation.
3. If the answer to question two is "no", list all the owners and their respective interests below:

Owner

Land Description

Section B.

This is to certify that the information in Section A above is true and complete to the best of my knowledge and belief.

**El Paso Natural Gas Company**  
 ORIGINAL SIGNED <sup>(Operator)</sup> **H.E. McANALLY**  
 Box 990 (Representative)  
 Farmington, New Mexico (Address)

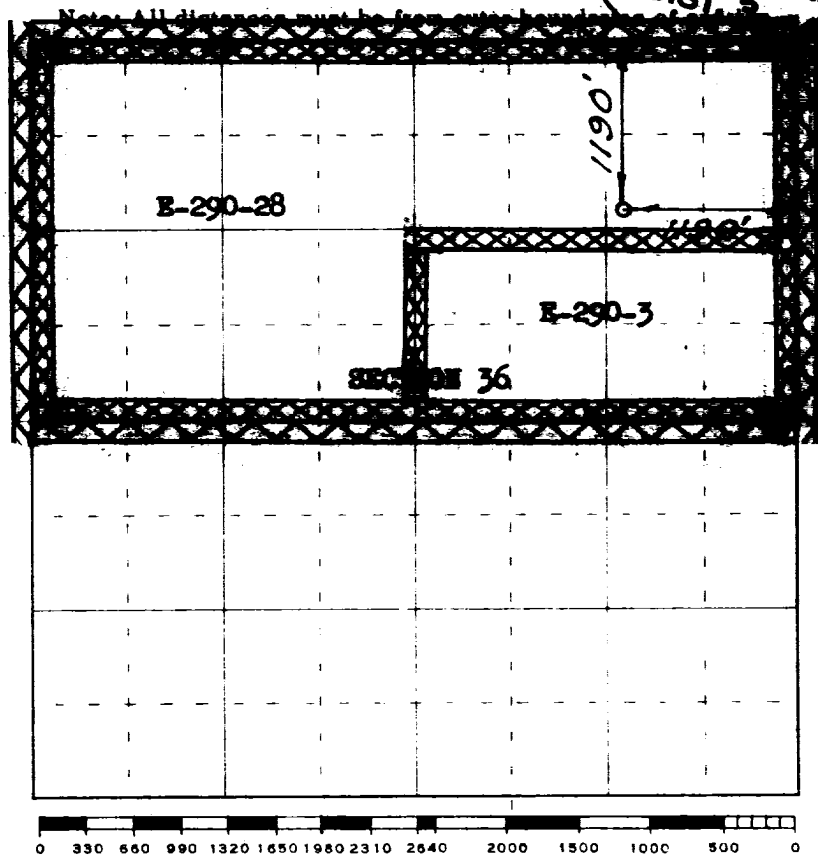

Scale 4 inches equal 1 mile

This is to certify that the above plat was prepared from field notes of actual surveys made by me or under my supervision and that the same are true and correct to the best of my knowledge and belief.

(Seal)

Farmington, New Mexico

Date Surveyed **OCTOBER 4, 1962**

Registered Professional Engineer and/or Land Surveyor