

(SUBMIT IN TRIPLICATE)

UNITED STATES
DEPARTMENT OF THE INTERIOR
GEOLOGICAL SURVEY

Land Office Santa Fe
Lease No. 000385
Unit Rincon Unit
I Sec. 916

SUNDRY NOTICES AND REPORTS ON WELLS

NOTICE OF INTENTION TO DRILL.....	<input checked="" type="checkbox"/>	SUBSEQUENT REPORT OF WATER SHUT-OFF.....
NOTICE OF INTENTION TO CHANGE PLANS.....		SUBSEQUENT REPORT OF SHOOTING OR ACIDIZING.....
NOTICE OF INTENTION TO TEST WATER SHUT-OFF.....		SUBSEQUENT REPORT OF ALTERING CASING.....
NOTICE OF INTENTION TO RE-DRILL OR REPAIR WELL.....		SUBSEQUENT REPORT OF RE-DRILLING OR REPAIR.....
NOTICE OF INTENTION TO SHOOT OR ACIDIZE.....		SUBSEQUENT REPORT OF ABANDONMENT.....
NOTICE OF INTENTION TO PULL OR ALTER CASING.....		SUPPLEMENTARY WELL HISTORY.....
NOTICE OF INTENTION TO ABANDON WELL.....		

(INDICATE ABOVE BY CHECK MARK NATURE OF REPORT, NOTICE, OR OTHER DATA)

November 3, 1953

Well No. 23 is located 990 ft. from $\left\{ \begin{smallmatrix} N \\ S \end{smallmatrix} \right\}$ line and 890 ft. from $\left\{ \begin{smallmatrix} E \\ W \end{smallmatrix} \right\}$ line of sec. 35

SW 1/4 Sec. 35 27 N 7 E 101 W
(1/4 Sec. and Sec. No.) (Twp.) (Range) (Meridian)

Wildcat Rio Arriba New Mexico
(Field) (County or Subdivision) (State or Territory)

The elevation of the derrick floor above sea level is 6523 ft. GG

DETAILS OF WORK

(State names of and expected depths to objective sands; show sizes, weights, and lengths of proposed casings; indicate mudding jobs, cementing points, and all other important proposed work)

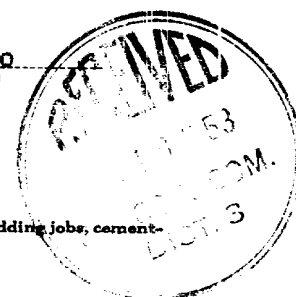

Drill 200 feet of 13 3/4 inch Rotary Hole. Set 200', 32.75#, 10 3/4 inch Surface Casing and circulate out cement.

Drill 3 3/4 inch Rotary hole to 4000' or top of the Cliff House. Set 23', 7 inch Production casing with 200 sacks cement.

Complete Mesa Verde with gas rotary or Cable Tools. Shoot open with approximately 2,000 quarts Nitro Gel. Clean out and run 2" tubing to Total Depth.

NOV 1953

I understand that this plan of work must receive approval in writing by the Geological Survey before operations may be commenced.

Company Ralph A. Johnston

Address Box 613

Farmington, New Mexico

By James W. Copeland
Title James W. Copeland
Supt.

Company.....Johnston Oil & Gas Company.....

Lease.....Well No.....

Sec. 35....., T. 27 N., R. 7 W., N.M.P.M.....

Location.....990' from the South line and 890' from
the West line.

Elevation.....6593 Ungraded ground.....

Rio Arriba County

New Mexico

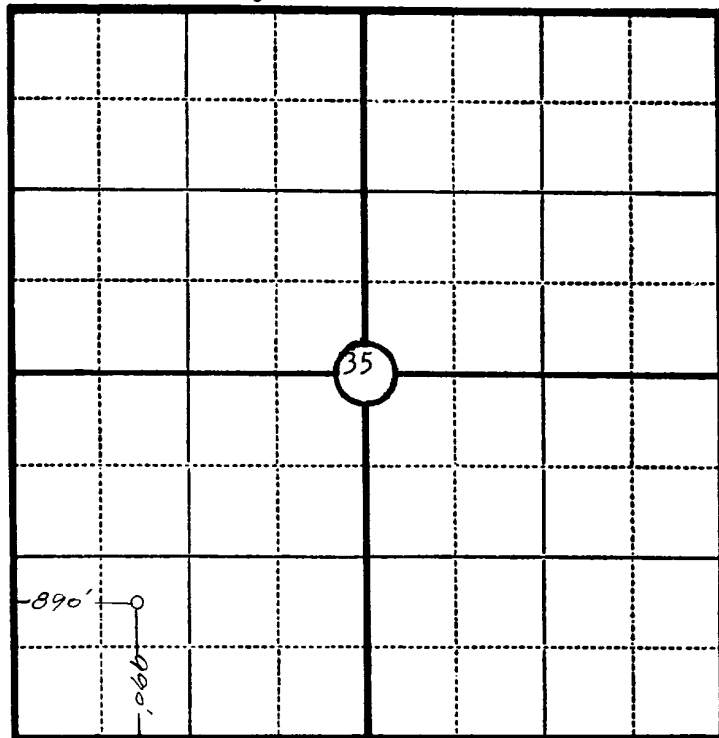

Scale—4 inches equal 1 mile.

This is to certify that the above plat was prepared from field notes of actual surveys made by me or under my supervision and that the same are true and correct to the best of my knowledge and belief.

Charles J. Finklea

Seal:

Registered Professional
Engineer and Land Surveyor.



N
↑

NOV

U. S. GEOLOGICAL SURVEY
FARMINGTON, N. M.

Charles J. Finklea
N. Mex. Reg. No. 1302

SurveyedNovember 2....., 19 53.....