

(SUBMIT IN TRIPLICATE)

UNITED STATES
DEPARTMENT OF THE INTERIOR
GEOLOGICAL SURVEY

Land Office Santa Fe
Lease No. 224432
Unit 34 Section 34
26

SUNDRY NOTICES AND REPORTS ON WELLS

RECEIVED

NOV 24 1954

NOTICE OF INTENTION TO DRILL	<input checked="" type="checkbox"/>	SUBSEQUENT REPORT OF WATER SHUT-OFF	<input type="checkbox"/>
NOTICE OF INTENTION TO CHANGE PLANS	<input type="checkbox"/>	SUBSEQUENT REPORT OF SHOOTING OR ACIDIZING	<input type="checkbox"/>
NOTICE OF INTENTION TO TEST WATER SHUT-OFF	<input type="checkbox"/>	SUBSEQUENT REPORT OF ALTERING CASING	<input type="checkbox"/>
NOTICE OF INTENTION TO RE-DRILL OR REPAIR WELL	<input type="checkbox"/>	SUBSEQUENT REPORT OF REDRILLING OR REPAIR	<input type="checkbox"/>
NOTICE OF INTENTION TO SHOOT OR ACIDIZE	<input type="checkbox"/>	SUBSEQUENT REPORT OF ABANDONMENT	<input type="checkbox"/>
NOTICE OF INTENTION TO PULL OR ALTER CASING	<input type="checkbox"/>	SUPPLEMENTARY WELL HISTORY	<input type="checkbox"/>
NOTICE OF INTENTION TO ABANDON WELL	<input type="checkbox"/>		<input type="checkbox"/>

(INDICATE ABOVE BY CHECK MARK NATURE OF REPORT, NOTICE, OR OTHER DATA)

November 22, 1954

Well No. adren 3 is located 1650 ft. from S line and 1650 ft. from E line of sec. 34

34 (1/4 Sec. and Sec. No.) T-26-N (Twp.) R-1-E (Range) N. 100 W. (Meridian)
Wildcat (Field) San Juan County (County or Subdivision) New Mexico (State or Territory)

The elevation of the derrick floor above sea level is _____ ft. to be furnished

DETAILS OF WORK

(State names of and expected depths to objective sands; show sizes, weights, and lengths of proposed casings; indicate mudlogging jobs, cementing points, and all other important proposed work)

Objective sand is the Victorine (Cliffs expected at about 2100')
Casing progress: 90' 5-5/8" cemented to surface
2100' 5-1/2" cemented with 100 sacks

Rotary tools will be used to T.B. Cable tools to be used in sand-oil
treating and cleaning out.

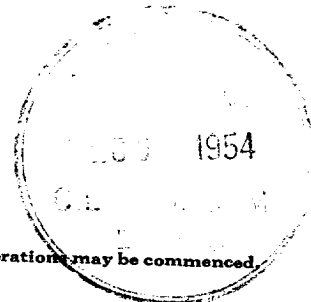

I understand that this plan of work must receive approval in writing by the Geological Survey before operations may be commenced.

Company SANTANA OIL & GAS COMPANY

Address 1041 Hurt Building

Dallas, Texas

By

G. M. Wiedersheim
G. M. Wiedersheim

Title Manager Exploration Dept.

Company Southern Union Gas Company

Lease Hodges Well No. 3

Sec. 34, T. 26 N, R. 8 W

Location 1650' from South line and
1650' from East line

FILED
FARM 100, 100, 100, 100

San Juan County

New Mexico

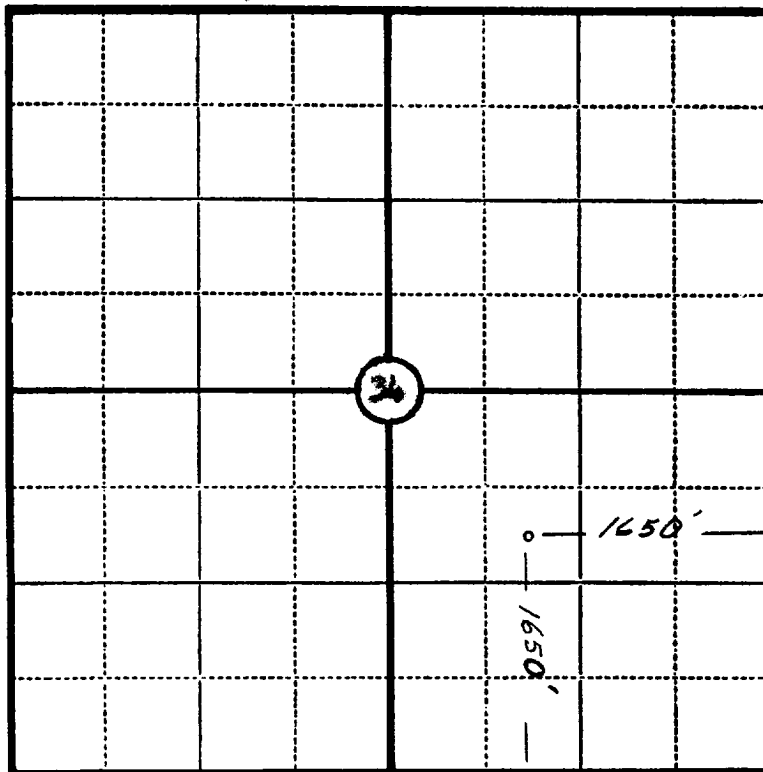

Scale—4 inches equal 1 mile.

This is to certify that the above plat was prepared from field notes of actual surveys made by me or under my supervision and that the same are true and correct to the best of my knowledge and belief.

Charles J. Finkles

Seal:

Registered Professional
Engineer and Land Surveyor.

Charles J. Finkles
N. Mex. Reg. 2302

Surveyed July 29, 1954