

(SUBMIT IN TRIPLICATE)

UNITED STATES
DEPARTMENT OF THE INTERIOR
GEOLOGICAL SURVEY

Land Office Santa Fe
Lease No. 070155
Unit Maryo

SUNDRY NOTICES AND REPORTS ON WELLS

NOTICE OF INTENTION TO DRILL.....	<input checked="" type="checkbox"/>	SUBSEQUENT REPORT OF WATER SHUT-OFF.....
NOTICE OF INTENTION TO CHANGE PLANS.....		SUBSEQUENT REPORT OF SHOOTING OR ACIDIZING.....
NOTICE OF INTENTION TO TEST WATER SHUT-OFF.....		SUBSEQUENT REPORT OF ALTERING CASING.....
NOTICE OF INTENTION TO RE-DRILL OR REPAIR WELL.....		SUBSEQUENT REPORT OF RE-DRILLING OR REPAIR.....
NOTICE OF INTENTION TO SHOOT OR ACIDIZE.....		SUBSEQUENT REPORT OF ABANDONMENT.....
NOTICE OF INTENTION TO PULL OR ALTER CASING.....		SUPPLEMENTARY WELL HISTORY.....
NOTICE OF INTENTION TO ABANDON WELL.....		

(INDICATE ABOVE BY CHECK MARK NATURE OF REPORT, NOTICE, OR OTHER DATA)

February 26, 1957

Well No. Maryo #1 is located 1990 ft. from S line and 1960 ft. from W line of sec. 35

G NE SW, Sec. 35 (1/4 Sec. and Sec. No.) 26N (Twp.) 13W (Range) New Mexican P.M. (Meridian)
Misti-Gallup (Field) San Juan County (County or Subdivision) New Mexico (State or Territory)



The elevation of the derrick floor above sea level is _____ ft.

DETAILS OF WORK

(State names of and expected depths to objective sands; show sizes, weights, and lengths of proposed casings; indicate mudding jobs, cementing points, and all other important proposed work)

To drill & test subject well to the Gallup. Surface Casings: 9-5/8" OD ASW casing to be set at 220' TD & cemented with 175 sax & circulated to surface. MOC 2h hours. Production Casings: 5-1/2" OD 140, J-55 casing to be set thru the lowest producing zone. Use centralizers & rotating type scratchers thru the Gallup and cement with 100 sax Puzos with 25 gal. Coring: None. Logging: DST if content of sands based on electric log is questionable. Loggings: Combination ES-Induction Log from TD to surface casing. Detail thru Pictured Cliffs, Ft. Lockett & Gallup. Microlog same as Detail ES. Drilling Time: Use Geolograph from 210' to TD. Drift Surveys: At 50' intervals to 300'; thereafter at 250' intervals. Depth Measurements: SLM of drill pipe at 150' above the Mances, prior to DST, & at TD. Sampling: Collect 10' samples from 1300' to TD. Completion Program: Whenever practicable, completion will be with rotary.

I understand that this plan of work must receive approval in writing by the Geological Survey before operations may be commenced.

Company THE BRITISH-AMERICAN OIL PRODUCING COMPANY

Address P.O. Box 180

Denver 1, Colorado

By _____

Title District Engineer

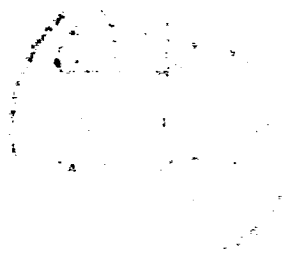

NEW MEXICO
OIL CONSERVATION COMMISSION

Form C-128

Well Location and/or Gas Proration Plat

Date _____

Operator British American Oil Producing Company Lease Marge B

Well No. 4 Section 35 Township 26 North Range 13 West NMPM

Located 1990 Feet From South Line, 1960 Feet From West Line,

County, New Mexico. G. L. Elevation 6237

Name of Producing Formation Gallup Pool Bisti Gallup Dedicated Acreage _____

(Note: All distances must be from outer boundaries of Section)

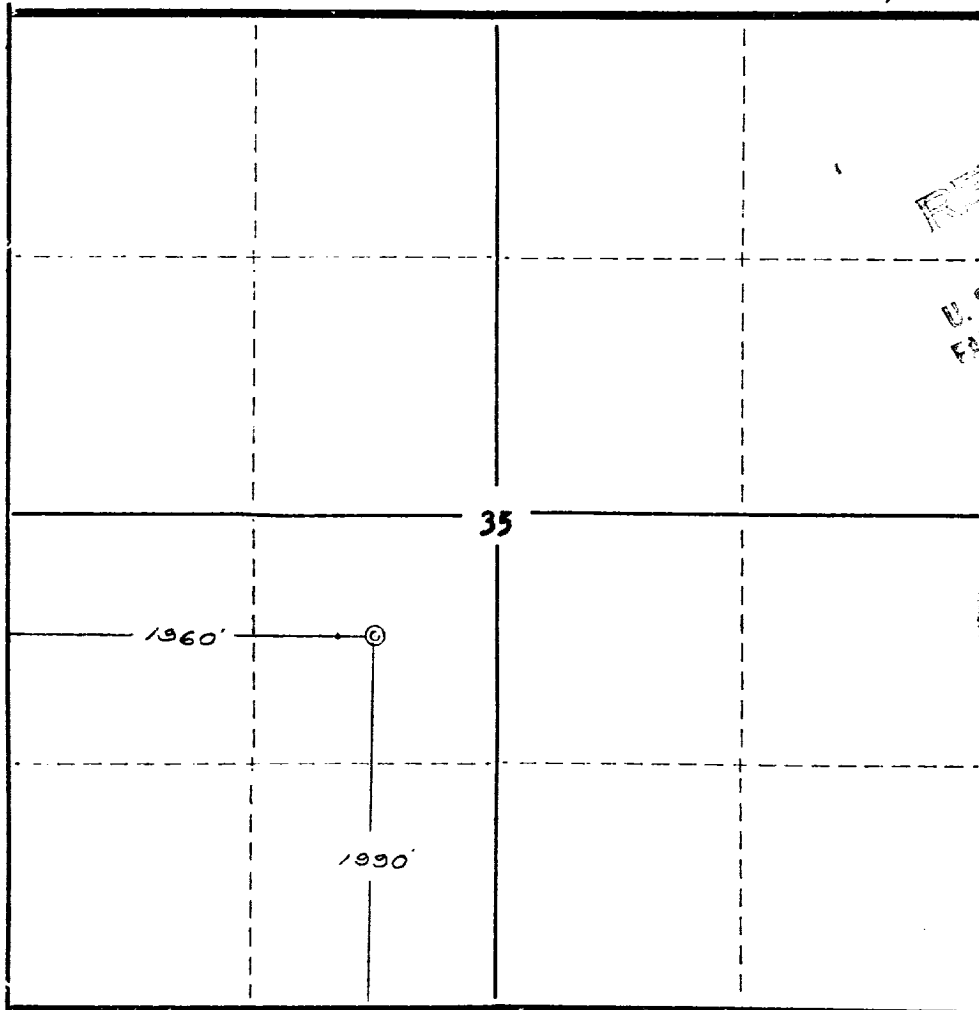

RECORDED
MAR 11 1957
U. S. GEOLOGICAL SURVEY
FRAMMINGTON, NEW MEXICO

FILED
MAR 11 1957
OIL CON. COM.
DIST. 3

ERNEST V. ECHOHAWK
NEW MEXICO
1957
35

NOTE
This section of form is to be used for gas wells only.

SCALE: 1"=1000'

1. Is this Well a Dual Comp. ? Yes ___ No ___
2. If the answer to Question 1 is yes, are there any other dually completed wells within the dedicated acreage? Yes ___ No ___

Name _____
Position _____
Representing _____
Address _____

This is to certify that the above plat was prepared from field notes of actual surveys made by me or under my supervision and that the same are true and correct to the best of my knowledge and belief.

Date Surveyed February 26, 1957

Ernest V. Echohawk
Ernest V. Echohawk
Reg. Land Surveyor, N. Mex., Reg. No. 1545