

P. O. Box 965  
Farmington, New Mexico

July 31, 1956

The British-American Oil Producing Company  
P. O. Box 180  
Denver 1, Colorado

RE: Santa Fe 078155

Gentlemen:

Receipt is acknowledged of your "Notice of Intention to Drill" dated July 30, 1956 covering your well No. 1 Marye "B" in SW $\frac{1}{4}$  NE $\frac{1}{4}$  sec. 35, T. 26 N., R. 13 W., N. M. P. M., San Juan County, New Mexico, Bisti-Gallup pool.

Your proposed work is hereby approved subject to compliance with the provisions of the "Oil and Gas Operating Regulations" revised May 25, 1942, a copy of which will be sent to you on request, and subject to the following conditions:

1. Drilling operations so authorized are subject to the attached sheet for general conditions of approval.
2. Furnish copies of all logs.

Very truly yours,

P. T. McGrath

PTMcGrath:al

COPY TO O. C. C.



P. O. Box 285  
Washington, New Mexico

July 21, 1936

The British-American Oil Producing Company  
P. O. Box 180  
Denver 1, Colorado

Re: Santa Fe Oil

Gentlemen:

Receipt in acknowledgment of your "Notice of Intention to Drill" dated July 30, 1936 covering your well No. 1, State "N" in SW 1/4 Sec. 36, T. 22 N., R. 13 W., S. 10 E., San Juan County, New Mexico, Santa Fe Oil.

Your proposed work is hereby approved subject to compliance with the provisions of the "Oil and Gas Operating Regulations" revised May 20, 1935, a copy of which will be sent to you on request, and subject to the following conditions:

1. Drilling operations as authorized are subject to the attached report for Santa Fe Oil.

2. Santa Fe Oil is to be used.

Very truly yours,

F. T. McGowan

FTMcGowan



COPY TO O.C.O.

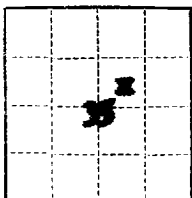

(SUBMIT IN TRIPLICATE)

UNITED STATES  
DEPARTMENT OF THE INTERIOR  
GEOLOGICAL SURVEY

Land Office Santa Fe  
Lease No. 07025  
Unit Marye

SUNDRY NOTICES AND REPORTS ON WELLS

NOTICE OF INTENTION TO DRILL	<input checked="" type="checkbox"/> SUBSEQUENT REPORT OF WATER SHUT-OFF
NOTICE OF INTENTION TO CHANGE PLANS	SUBSEQUENT REPORT OF SHOOTING OR ACIDIZING
NOTICE OF INTENTION TO TEST WATER SHUT-OFF	SUBSEQUENT REPORT OF ALTERING CASING
NOTICE OF INTENTION TO RE-DRILL OR REPAIR WELL	SUBSEQUENT REPORT OF RE-DRILLING OR REPAIR
NOTICE OF INTENTION TO SHOOT OR ACIDIZE	SUBSEQUENT REPORT OF ABANDONMENT
NOTICE OF INTENTION TO PULL OR ALTER CASING	SUPPLEMENTARY WELL HISTORY
NOTICE OF INTENTION TO ABANDON WELL	

(INDICATE ABOVE BY CHECK MARK NATURE OF REPORT, NOTICE, OR OTHER DATA)

July 30, 1956

Well No. Marye #1 is located 1980 ft. from N line and 1980 ft. from E line of sec. 35

G. M. NE, Sec. 35 24N 13W New Mexico P. M.  
(1/4 Sec. and Sec. No.) (Twp.) (Range) (Meridian)  
Blair-Gallup San Juan New Mexico  
(Field) (County or Subdivision) (State or Territory)

The elevation of the derrick floor above sea level is 6217 ft.

DETAILS OF WORK

(State names of and expected depths to objective sands; show sizes, weights, and lengths of proposed casings; indicate mudding jobs, cementing points, and all other important proposed work)

To drill & test subject well to the Gallup S.S. Surface Casings 9-5/8" CD 32.3', N-40 casing to be set at approx. 210' IB & cemented with 175 sack & circulated to surface. 100' 2 1/2" heavy. Production Casing: 5-1/2" CD 11 1/2', J-55 casing to be set thru the lowest producing zone. Use centralizers & rotating type scratchers thru the Gallup & cement with 100 sack with 3% gal. Casing: Core 100' of Gallup. Logging: If warranted. Logging: Electric log from TD to surface casing. Detail thru Pictured Cliffs, Ft. Leaton, & Gallup. Induction log same as Detail 22. Microlog same as Detail 22. Gamma Ray in conjunction with perforating. Drilling Time: Use Geolograph from 210' to TD. Drift Surveys: At 50' intervals to 300'; thereafter at 250' intervals. Depth Measurements: SW of drill pipe at approx. 150' above the Monoc, prior to casing, RT & TD. Completion Program: Whenever practicable, completion will be with rotary.

I understand that this plan of work must receive approval in writing by the Geological Survey before operations may be commenced.

Company THE BRITISH-AMERICAN OIL PRODUCING COMPANY

Address P. O. Box 180

Denver 1, Colorado

Original Sign 100

By L. E. Stern

Title District Engineer

NEW MEXICO  
OIL CONSERVATION COMMISSION

Form C-128

Well Location and/or Gas Proration Plat

Date \_\_\_\_\_

Operator British American Oil Producing Company Lease \_\_\_\_\_

Well No. Marys B-1 Section 35 Township 26 North Range 13 West NMPM

Located 1980 Feet From North Line, 1980 Feet From East Line,

San Juan County, New Mexico. G. L. Elevation 6217 UNGRADED

Name of Producing Formation Gallup Pool Wildcat Dedicated Acreage \_\_\_\_\_

(Note: All distances must be from outer boundaries of Section)

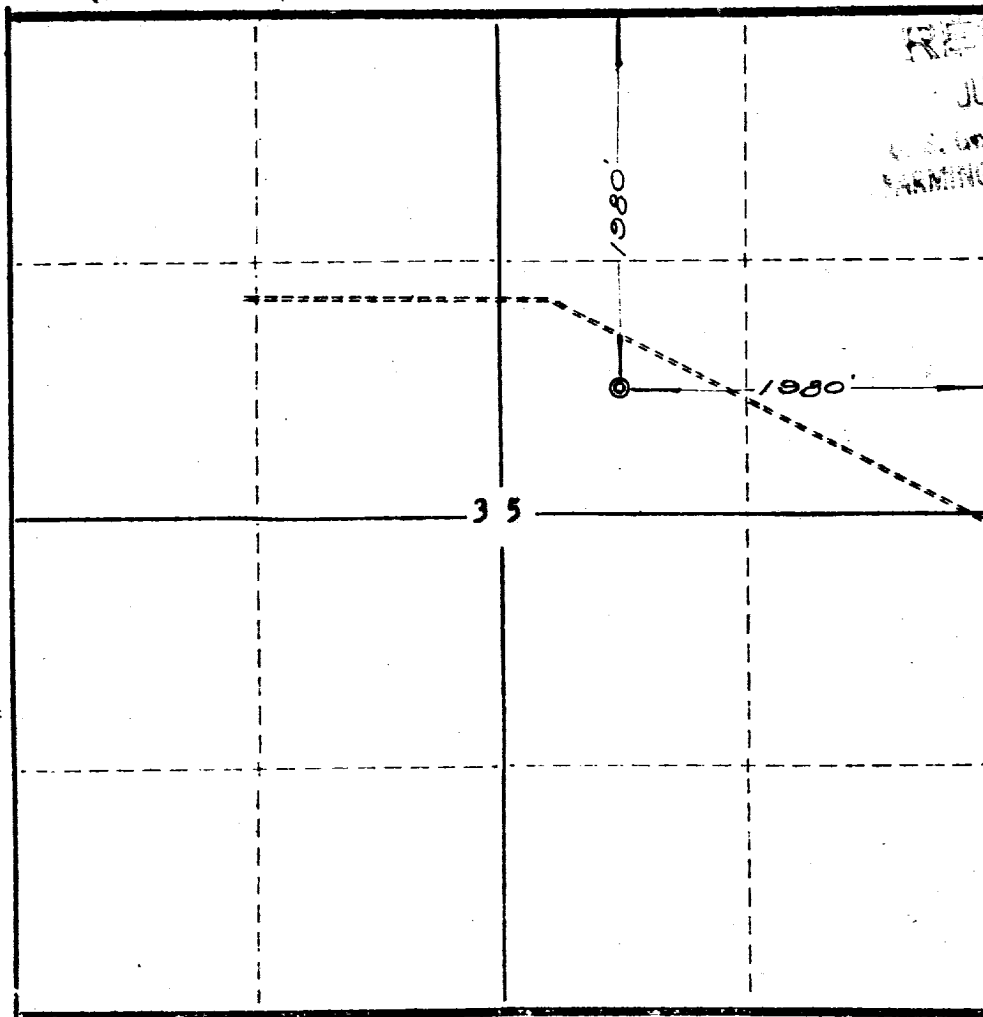

NOTE

This section of form is to be used for gas wells only.

SCALE: 1"=1000'

1. Is this Well a Dual Comp. ? Yes \_\_\_ No \_\_\_
2. If the answer to Question 1 is yes, are there any other dually completed wells within the dedicated acreage? Yes \_\_\_ No \_\_\_

Name \_\_\_\_\_  
Position \_\_\_\_\_  
Representing \_\_\_\_\_  
Address \_\_\_\_\_

This is to certify that the above plat was prepared from field notes of actual survey made by me or under my supervision and that the same are true and correct to the best of my knowledge.

Date Surveyed July 27, 1956

Ernest V. Echohawk  
Reg. Land Surveyor. N. Mex., Reg. No. 1545