



COPY TO O. C. C.

UNITED STATES
DEPARTMENT OF THE INTERIOR
GEOLOGICAL SURVEY

P. O. Box 965
Farmington, New Mexico

IN REPLY REFER TO:

February 1, 1956

Benson-Montin
1054 West Broadway
Farmington, New Mexico

Re: New Mexico Oh226

Gentlemen:

Receipt is acknowledged of your "Notice of Intention to Drill" dated January 30, 1956 covering your well No. 14 McManus in NE $\frac{1}{4}$ NE $\frac{1}{4}$ sec. 33, T. 26 N., R. 8 W., N. M. P. M., San Juan County, New Mexico, Ballard P.O.

Your proposed work is hereby approved subject to compliance with the provisions of the "Oil and Gas Operating Regulations" revised May 25, 1942, a copy of which will be sent to you on request, and subject to the following conditions:

1. Drilling operations so authorized are subject to the attached sheet for general conditions of approval.
2. Furnish copies of all logs.

Very truly yours,

(Orig. Sgd) P. T. McGrath

P. T. McGrath
District Engineer

PTMcGrath:ac



Company BENSON - MONTIN - GREER DRILLING CORPORATION

Lease MC MANUS Well No. 14

Sec. 33, T. 26 N., R. 8 W., N.M.P.M.

Location 875' FROM THE NORTH LINE AND 1015' FROM THE EAST LINE.

Elevation 6566.8 UNGRADED GROUND.

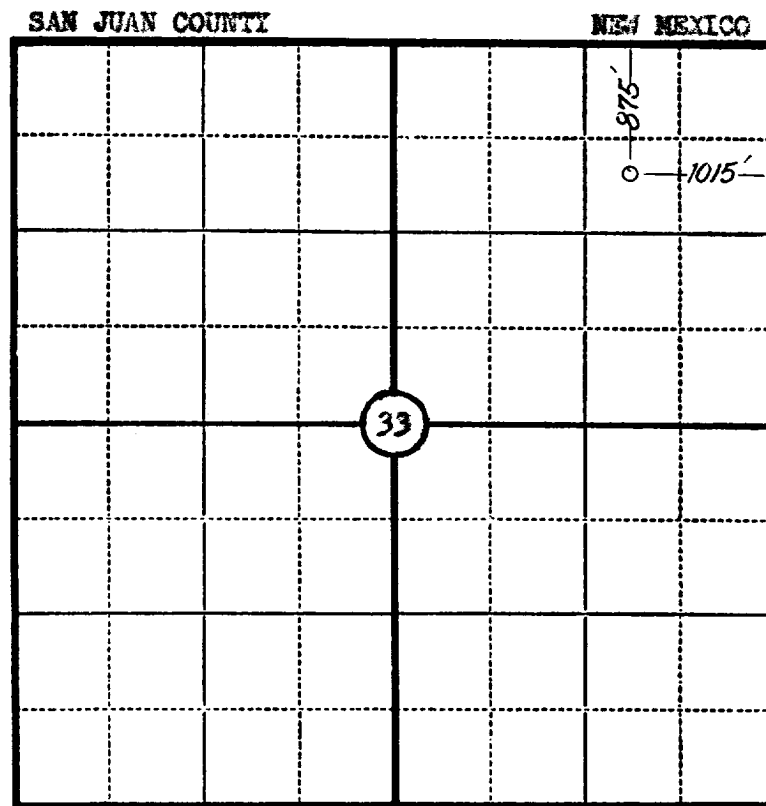

Scale—4 inches equal 1 mile.

This is to certify that the above plat was prepared from field notes of actual surveys made by me or under my supervision and that the same are true and correct to the best of my knowledge and belief.

Seal:

James P. Leese

Registered Land Surveyor.

James P. Leese

N. Mex. Reg. No. 1463

Surveyed 25 January, 19 56

SAN JUAN ENGINEERING COMPANY, FARMINGTON, N. M.