

NEW MEXICO OIL CONSERVATION COMMISSION
Well Location and Acreage Dedication Plat

Section A.

AMENDED

Date January 28, 1958

Operator The British-American Oil Producing Company Lease Douthit "B"
Well No. B-6 Unit Letter O Section 27 Township 26 North Range 13 West NMPM
Located 660 Feet From South Line, 2080 Feet From East Line
County San Juan G. L. Elevation 6227 * Dedicated Acreage 80 Acres
Name of Producing Formation Gallup Sandstone Pool Lower Bisti-Gallup

1. Is the Operator the only owner* in the dedicated acreage outlined on the plat below?
Yes X No .
2. If the answer to question one is "no," have the interests of all the owners been consolidated by communitization agreement or otherwise? Yes No . If answer is "yes," Type of Consolidation
3. If the answer to question two is "no," list all the owners and their respective interests below:

* Ungraded Elevation

Owner

Land Description

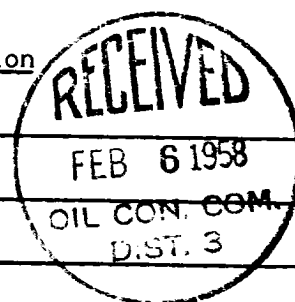

Section B

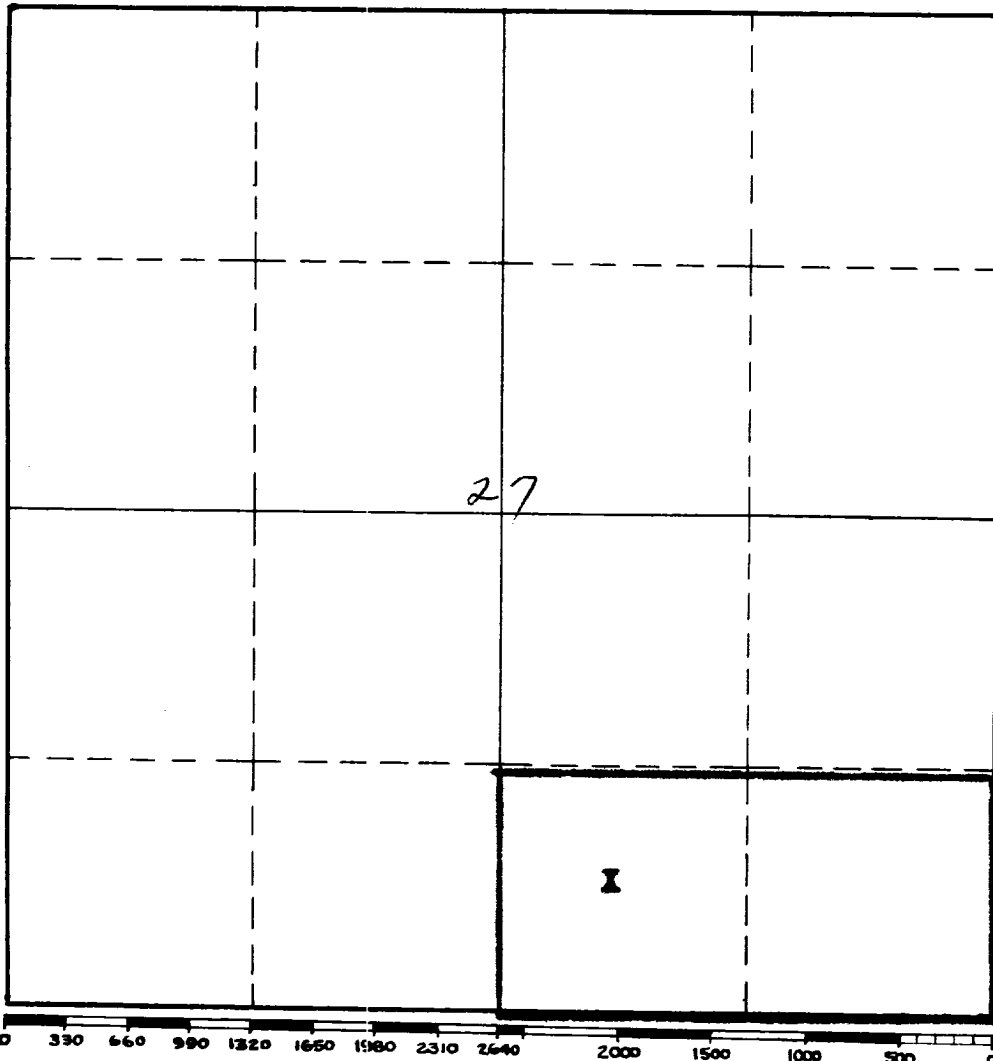

This is to certify that the information in Section A above is true and complete to the best of my knowledge and belief.

The British-American Oil Producing Company

(Operator)

Original Signed By:

Thomas M. Hogan

(Representative)

District Superintendent

Box 180, Denver 1, Colorado

Address

This is to certify that the well location shown on the plat in Section B was plotted from field notes of actual surveys made by me or under my supervision and that the same is true and correct to the best of my knowledge and belief.

Date Surveyed

Registered Professional Engineer and/or Land Surveyor.

Certificate No.

(See instructions for completing this form on the reverse side)

INSTRUCTIONS FOR COMPLETION:

1. Operator shall furnish and certify to the information called for in Section A.
2. Operator shall outline the dedicated acreage for both oil and gas wells on the plat in Section B.
3. A registered professional engineer or land surveyor registered in the State of New Mexico or approved by the Commission shall show on the plat the location of the well and certify this information in the space provided.
4. All distances shown on the plat must be from the outer boundaries of Section.
5. If additional space is needed for listing owners and their respective interests as required in question 3, Section A, please use space below

OIL CONSERVATION COMMISSION		
AZULON DISTRICT OFFICE		
No. Copies	6	
DISTRIBUTION		
Operator		
Engineer	✓	
Surveyor		
Transporter		
U. S. G. S.	✓	
File	✓	✓

* "Owner" means the person who has the right to drill into and to produce from any pool and to appropriate the production either for himself or for himself and another. (65-3-29 (e) NMSA 1953 Comp.)