

(SUBMIT IN TRIPLICATE)

UNITED STATES
DEPARTMENT OF THE INTERIOR
GEOLOGICAL SURVEY

Land Office Santa Fe
Lease No. 101 089656
Unit _____

SUNDRY NOTICES AND REPORTS ON WELLS

NOTICE OF INTENTION TO DRILL.....	<input checked="" type="checkbox"/>	SUBSEQUENT REPORT OF WATER SHUT-OFF.....	RECEIVED DEC 3 1961 U. S. GEOLOGICAL SURVEY
NOTICE OF INTENTION TO CHANGE PLANS.....	<input type="checkbox"/>	SUBSEQUENT REPORT OF SHOOTING OR ACIDIZING.....	
NOTICE OF INTENTION TO TEST WATER SHUT-OFF.....	<input type="checkbox"/>	SUBSEQUENT REPORT OF ALTERING CASING.....	
NOTICE OF INTENTION TO RE-DRILL OR REPAIR WELL.....	<input type="checkbox"/>	SUBSEQUENT REPORT OF RE-DRILLING OR REPAIR.....	
NOTICE OF INTENTION TO SHOOT OR ACIDIZE.....	<input type="checkbox"/>	SUBSEQUENT REPORT OF ABANDONMENT.....	
NOTICE OF INTENTION TO PULL OR ALTER CASING.....	<input type="checkbox"/>	SUPPLEMENTARY WELL HISTORY.....	
NOTICE OF INTENTION TO ABANDON WELL.....	<input type="checkbox"/>		

(INDICATE ABOVE BY CHECK MARK NATURE OF REPORT, NOTICE, OR OTHER DATA)

December 2, 1961

Caldwell Gas Unit "A"
Well No. 1 is located 1850 ft. from 1000 line and 1950 ft. from [E] line of sec. 27

SE/4 Section 27 (1/4 Sec. and Sec. No.) 26 N 11 W (Twp.) N.M.P.M. (Meridian)

Basin Dakota (Field) San Juan (County or Subdivision) New Mexico (State or Territory)

The elevation of the ~~drill collar~~ ground level above sea level is 6000 ft.

DETAILS OF WORK

(State names of and expected depths to objective sands; show sizes, weights, and lengths of proposed casings; indicate mudding jobs, cementing points, and all other important proposed work)

1. Drill 12-1/4" hole to 200'.
2. Run and cement 8-5/8" OD, 24# casing at 200'. Circulate cement to surface.
3. Drill 7-7/8" OD hole to TD (approximately 6200').
4. Run 5-1/2" OD, 14# casing through lowest pay.
5. Cement in 2 stages. First stage: 250 sacks or sufficient volume to cover 500' above Gallup. Second stage: set stage collar 50' below Pictured Cliff and cement with sufficient volume to cover 50' above Pictured Cliff.
6. Perforate and stimulate Dakota.
7. Clean up location.

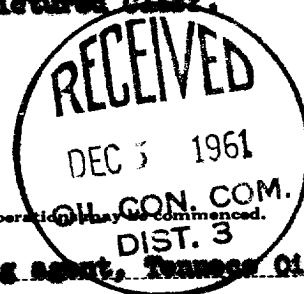

I understand that this plan of work must receive approval in writing by the Geological Survey before operations may be commenced.

Company Tenneco Corporation, acting by and thru its managing agent, Tenneco Oil Co.

Address P. O. Box 1714

Durango, Colorado

By [Signature] V. E. Cox

Title District Office Supervisor

NUMBER OF COPIES RECEIVED	
DISTRIBUTION	
STATE	
FILE	
U.S.G.S.	
LAND OFFICE	
TRANSFER	OIL
	GAS
PRORATION OFFICE	
OPERATOR	

NEW MEXICO OIL CONSERVATION COMMISSION
WELL LOCATION AND ACREAGE DEDICATION PLAT
 SEE INSTRUCTIONS FOR COMPLETING THIS FORM ON THE REVERSE SIDE

FORM C-128
 Revised 5/1/57

SECTION A

Operator TAMMCO OIL COMPANY		Lease CALDWELL GAS UNIT "A"		Well No. 1
Unit Letter J	Section 27	Township 26 North	Range 11 West	County San Juan
Actual Footage Location of Well: 1850 feet from the South line and 1850 feet from the East line <i>1950' R.N.B.</i>				
Ground Level Elev. 6284' Ungraded	Producing Formation Dakota	Pool Basin Dakota	Dedicated Acreage: 320 Acres	

1. Is the Operator the only owner in the dedicated acreage outlined on the plat below? YES NO . ("Owner" means the person who has the right to drill into and to produce from any pool and to appropriate the production either for himself or for himself and another. (65-3-29 (e) NMSA 1935 Comp.)
2. If the answer to question one is "no," have the interests of all the owners been consolidated by communitization agreement or otherwise? YES NO . If answer is "yes," Type of Consolidation _____
3. If the answer to question two is "no," list all the owners and their respective interests below:

Owner	Land Description



SECTION B

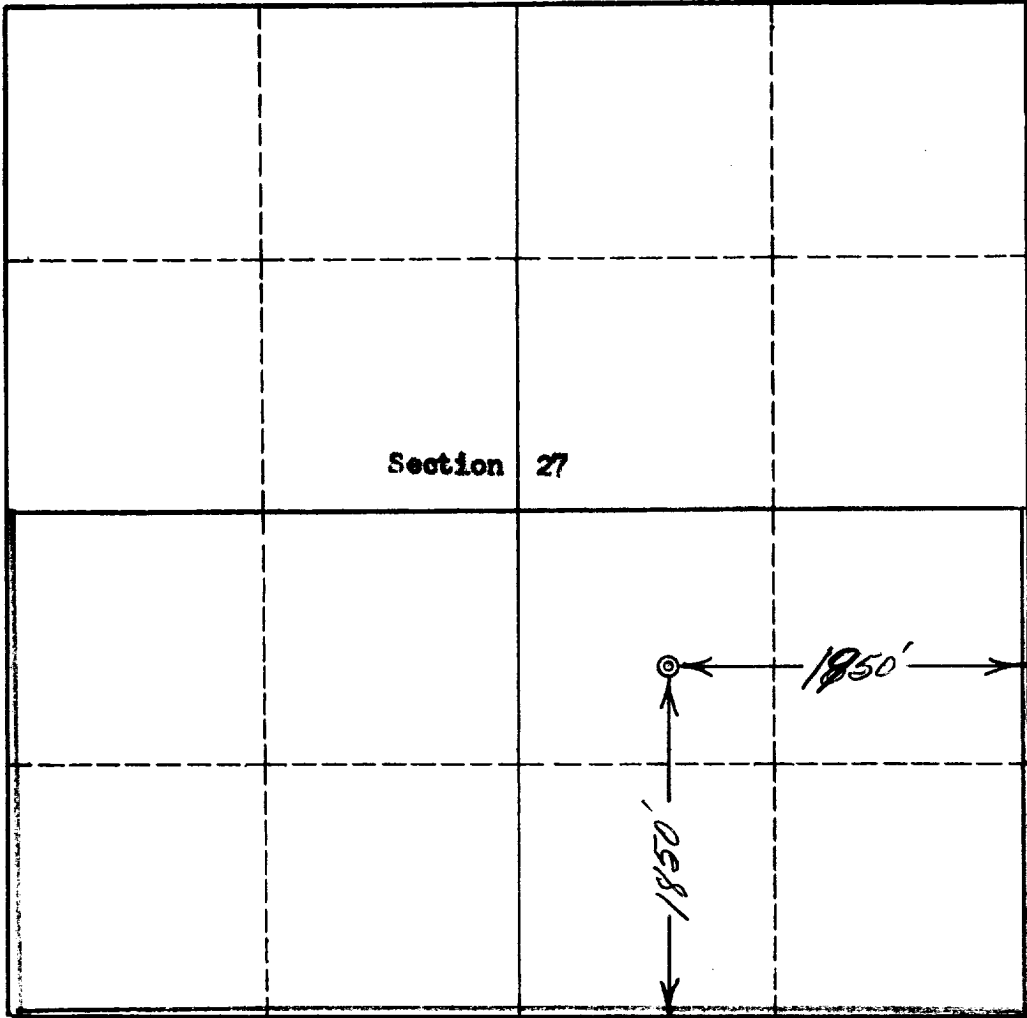

I hereby certify that the information in SECTION A above is true and complete to the best of my knowledge and belief.

Name: *A. E. Cox* **V. E. Cox**
 Position: **District Office Supervisor**
 Company: **Tammco Corp., acting by & thru its managing agent, Tammco Oil Company**
 Date: **December 2, 1961**

I hereby certify that the well location shown on the plat in SECTION B was plotted from field notes of actual surveys made by me or under my supervision, and that the same is true and correct to the best of my knowledge and belief.

Date Surveyed: **20 November 61**
 Registered Professional Engineer and/or Land Surveyor:
Robert W. Finner
San Juan Engineering Co.
 Certificate No. **PE & LS 2463**



INSTRUCTIONS FOR COMPLETION OF FORM C-128

1. Operator shall furnish and certify to the information called for in Section A.
2. Operator shall outline the dedicated acreage for *both* oil and gas wells on the plat in Section B.
3. A registered professional engineer or land surveyor registered in the State of New Mexico or approved by the Commission shall show on the plat the location of the well and certify this information in the space provided.
4. All distances shown on the plat must be from the outer boundaries of the Section.
5. If additional space is needed for listing owners and their respective interests as required in question 3 of Section A, please use space below.