

(SUBMIT IN TRIPLICATE)

UNITED STATES
DEPARTMENT OF THE INTERIOR
GEOLOGICAL SURVEY

Land Office Santa Fe
Lease No. 078249
Unit Sullivan

SUNDRY NOTICES AND REPORTS ON WELLS

| | | | |
|-----------------------------------------------------|-------------------------------------|-------------------------------------------------|--|
| NOTICE OF INTENTION TO DRILL..... | <input checked="" type="checkbox"/> | SUBSEQUENT REPORT OF WATER SHUT-OFF..... | |
| NOTICE OF INTENTION TO CHANGE PLANS..... | | SUBSEQUENT REPORT OF SHOOTING OR ACIDIZING..... | |
| NOTICE OF INTENTION TO TEST WATER SHUT-OFF..... | | SUBSEQUENT REPORT OF ALTERING CASING..... | |
| NOTICE OF INTENTION TO RE-DRILL OR REPAIR WELL..... | | SUBSEQUENT REPORT OF RE-DRILLING OR REPAIR..... | |
| NOTICE OF INTENTION TO SHOOT OR ACIDIZE..... | | SUBSEQUENT REPORT OF ABANDONMENT..... | |
| NOTICE OF INTENTION TO PULL OR ALTER CASING..... | | SUPPLEMENTARY WELL HISTORY..... | |
| NOTICE OF INTENTION TO ABANDON WELL..... | | | |

(INDICATE ABOVE BY CHECK MARK NATURE OF REPORT, NOTICE, OR OTHER DATA)

April 18, 1957

Well No. 2-B is located 1650 ft. from N line and 790 ft. from E line of sec. 29
NW Section 29 26N 12W N.M.P.M.
(1/4 Sec. and Sec. No.) (Twp.) (Range) (Meridian)
Wildcat San Juan New Mexico
(Field) (County or Subdivision) (State or Territory)

The elevation of the derrick floor above sea level is 6071 ft.

DETAILS OF WORK

(State names of and expected depths to objective sands; show sizes, weights, and lengths of proposed casings; indicate mudding jobs, cementing points, and all other important proposed work)

It is intended to drill a well thru the Gallup formation using rotary tools & to perforate and sand-oil fracture possible producing zones.
Estimated Total Depth 5212'.

Casing Program:

10-3/4" at 170' with 125 sacks regular cement circulated to surface.

7-5/8" at 3900' with 250 sacks regular cement.

5-1/2" liner at 5212' with 250 sacks regular cement.

The SWW of Section 29 is dedicated to this well.

SWW SF 078249.

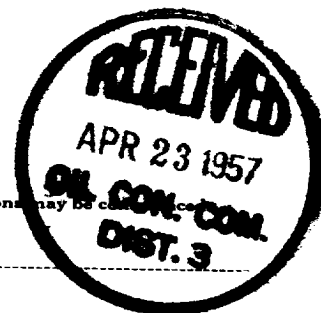

I understand that this plan of work must receive approval in writing by the Geological Survey before operations may be commenced.

Company El Paso Natural Gas Company

Address Box 997

Parasington, New Mexico

By Original Signed EWEIL N. WALSH

Title Petroleum Engineer



NEW MEXICO
OIL CONSERVATION COMMISSION

Form No. 1

WELL LOCATION AND/OR GAS PRORATION PLAT

APRIL 19, 1957

OWNER EL PASO NATURAL GAS COMPANY SULLIVAN "B" SF 078249
ACRES 2 29 26 N 12 W
TOWNSHIP 1650 NORTH 790 WEST
COUNTY SAN JUAN GALLUP WILDCAT 40 AC.
(1915 PLAT)

Note: All dimensions must be from outer boundaries of section.

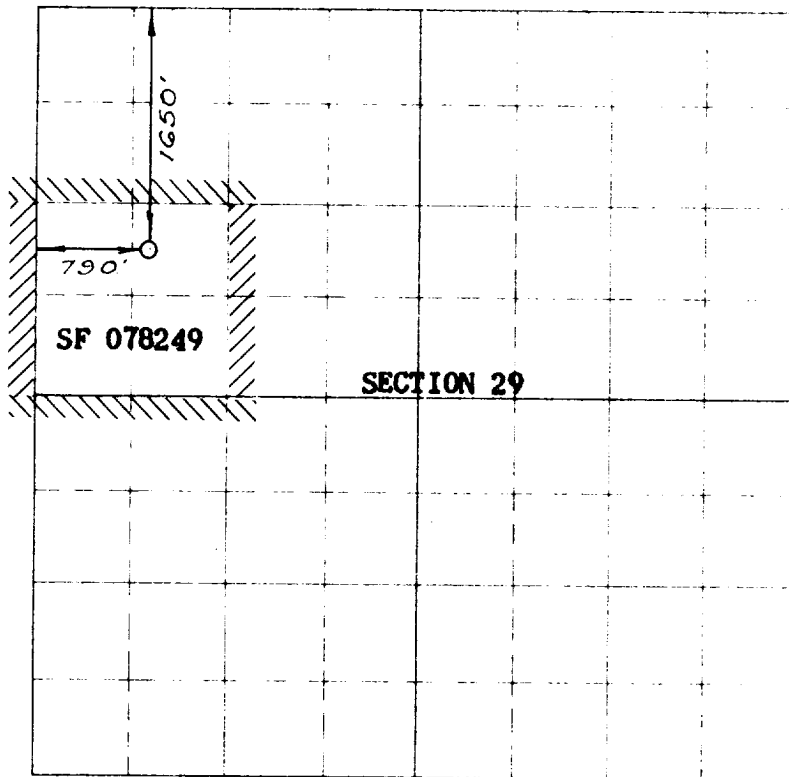

Scale 1 inch equals 1 mile

NOTE

This section of
form is to be used
for gas wells only

This is to certify that the above plat was prepared from
field notes of actual surveys made by me or under my
supervision and that the same are true and correct to the
best of my knowledge and belief.

Date Surveyed APRIL 17, 1957

E. O. Walker
Registered Professional Engineer and/or Land Surveyor

1. Is this well a Dual Comp.

Yes _____ No ☒

2. If the answer to Question 1

is Yes, are there any other dually
completed wells within the
dedicated acreage.

Yes _____ No _____

Name Original Signed EWELL N. WALSH

Position Petroleum Engineer

Representing El Paso Natural Gas

Address Box 997, Farmington, N.M.

(Seal)