

COPY TO O.G.C.

(SUBMIT IN TRIPLICATE)

UNITED STATES
DEPARTMENT OF THE INTERIOR
GEOLOGICAL SURVEY

Land Office Window Rock
Lease No. 111-20-2-3-116
Unit Navajo Indian Lands
Naw-de-des-mood

SUNDRY NOTICES AND REPORTS ON WELLS

NOTICE OF INTENTION TO DRILL.....	<input checked="" type="checkbox"/>	SUBSEQUENT REPORT OF WATER SHUT-OFF.....
NOTICE OF INTENTION TO CHANGE PLANS.....		SUBSEQUENT REPORT OF SHOOTING OR ACIDIZING.....
NOTICE OF INTENTION TO TEST WATER SHUT-OFF.....		SUBSEQUENT REPORT OF ALTERING CASING.....
NOTICE OF INTENTION TO RE-DRILL OR REPAIR WELL.....		SUBSEQUENT REPORT OF REDRILLING OR REPAIR.....
NOTICE OF INTENTION TO SHOOT OR ACIDIZE.....		SUBSEQUENT REPORT OF ABANDONMENT.....
NOTICE OF INTENTION TO PULL OR ALTER CASING.....		SUPPLEMENTARY WELL HISTORY.....
NOTICE OF INTENTION TO ABANDON WELL.....		

(INDICATE ABOVE BY CHECK MARK NATURE OF REPORT, NOTICE, OR OTHER)

February 7, 1955

Well No. 1 is located 1430 ft. from N line and 1650 ft. from W line of sec. 30

SE/4 NW/4 Sec. 30
(1/4 Sec. and Sec. No.)

26N
(Twp.)

8W
(Range)

N. 4. P. M.
(Meridian)

Wildcat
(Field)

San Juan
(County or Subdivision)

New Mexico
(State or Territory)

The elevation of the derrick floor above sea level is ft. (Not available. Will furnish later)

DETAILS OF WORK

(State names of and expected depths to objective sands; show sizes, weights, and lengths of proposed casings; indicate mudding jobs, cementing points, and all other important proposed work)

Pictured Cliffs Sand test. Estimated total depth 2100'.

Surface Casing: 80' of 8-5/8" OD 24# J-55 cemented with 75 sacks.

Production " : Approx. 2000' of 5-1/2" OD 14# J-55 cemented with 100 sacks.

If commercial production is indicated, the producing section will be shot with nitroglycerin and/or sand-oil treated.

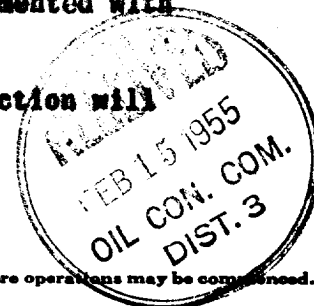

I understand that this plan of work must receive approval in writing by the Geological Survey before operations may be commenced.

Company BENSON-MONTIN

Address 315 1/2 West Main Street

Farmington, New Mexico

By [Signature]

Title Field Superintendent

COMPANY BENSON-MONTIN

LEASE NAW-DE-DES-WOOD WELL NO. #1

SECTION 30 T26 N, R8 W, N.M.P.M.

LOCATION 1430 feet from north line

1576 feet from west line

RECEIVED

FEB 7 1955
U. S. GEOLOGICAL SURVEY
FARMINGTON, NEW MEXICO

SAN JUAN COUNTY NEW MEXICO

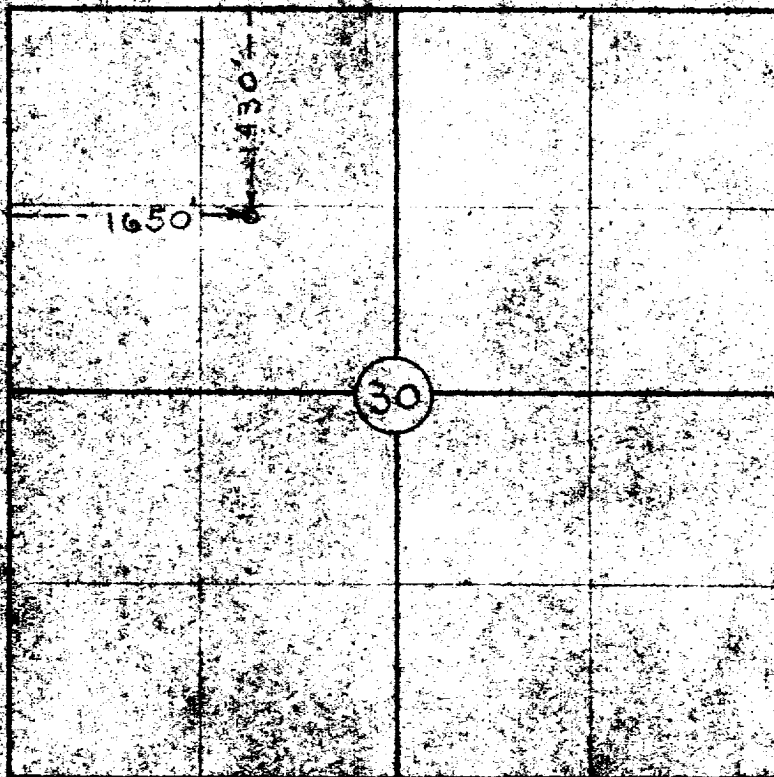

THIS IS TO CERTIFY THAT THE ABOVE PLAT WAS
PREPARED FROM FIELD NOTES OF ACTUAL SURVEYS
MADE BY ME AND ARE TRUE AND CORRECT TO THE
BEST OF MY KNOWLEDGE AND BELIEF

Robert L. Muddoy
ROBERT L. MUDDOY
REGISTERED PROFESSIONAL
ENGINEER AND LAND SURVEYOR
NEW MEXICO REG. NO. 1146

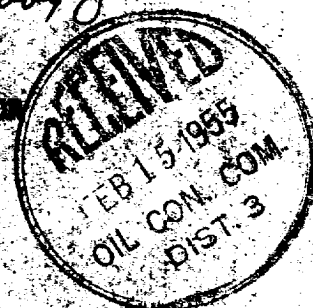

RECORDED 1-22-55