

(SUBMIT IN TRIPLICATE)

UNITED STATES  
DEPARTMENT OF THE INTERIOR  
GEOLOGICAL SURVEY

Land Office \_\_\_\_\_  
Lease No. **078433**  
Unit **SW 1/4 Sec. 29, T-26N,**  
**R-8W, N.M.P.M., San Juan**  
**County, New Mexico.**

SUNDRY NOTICES AND REPORTS ON WELLS

NOTICE OF INTENTION TO DRILL.....	<input checked="" type="checkbox"/>	SUBSEQUENT REPORT OF WATER SHUT-OFF.....	
NOTICE OF INTENTION TO CHANGE PLANS.....		SUBSEQUENT REPORT OF SHOOTING OR ACIDIZING.....	
NOTICE OF INTENTION TO TEST WATER SHUT-OFF.....		SUBSEQUENT REPORT OF ALTERING CASING.....	
NOTICE OF INTENTION TO RE-DRILL OR REPAIR WELL.....		SUBSEQUENT REPORT OF RE-DRILLING OR REPAIR.....	
NOTICE OF INTENTION TO SHOOT OR ACIDIZE.....		SUBSEQUENT REPORT OF ABANDONMENT.....	
NOTICE OF INTENTION TO PULL OR ALTER CASING.....		SUPPLEMENTARY WELL HISTORY.....	
NOTICE OF INTENTION TO ABANDON WELL.....			

(INDICATE ABOVE BY CHECK MARK NATURE OF REPORT, NOTICE, OR OTHER DATA)

**March 14**, 19 **55**

**9 Newton**

Well No. **1** is located **850** ft. from **N** line and **1500** ft. from **W** line of sec. **29**

**SW 1/4 SW 1/4 Sec. 29 T-26N R-8W N.M.P.M.**  
(1/4 Sec. and Sec. No.) (Twp.) (Range) (Meridian)

**Ballard Pictured Cliffs** **San Juan** **New Mexico**  
(Field) (County or Subdivision) (State or Territory)

The elevation of the derrick floor above sea level is \_\_\_\_\_ ft. **(To Be Determined)**

DETAILS OF WORK

(State names of and expected depths to objective sands; show sizes, weights, and lengths of proposed casings; indicate mudding jobs, cementing points, and all other important proposed work)

Objective sand will be the Pictured Cliffs Formation. Anticipated at approximately 2100 feet.

Proposed Casing Program: **90' of 9 5/8" J-55 Cemented to Surface.**  
**2100' of 5 1/2" J-55 Cemented with 150 sacks.**

Rotary tools will be employed from surface to top of Pictured Cliff.  
Cable tools will be employed from top of Pictured Cliff to Total Depth.

The well will be shot or semi-oil fraced in an effort to stimulate production.  
Estimated Total Depth 2175 feet.

I understand that this plan of work must receive approval in writing by the Geological Survey before operations may be commenced.

Company **Southern Union Gas Company**

Address **1001 Burt Building**

**Dallas, Texas**

By **Paul J. Clote**

Title **Paul J. Clote**  
**Petroleum Engineer**

COMPANY Southern Union Gas Company

Well Name & No. Newsom No. 9

Lease No. \_\_\_\_\_

Location 850' from the North line and 1500' from the West line.

Being in NW $\frac{1}{4}$

Sec. 29 T. 26 N., R. 8 W., N.M.P.M., San Juan County, New Mexico.

Ground Elevation \_\_\_\_\_

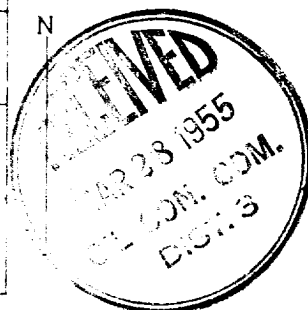
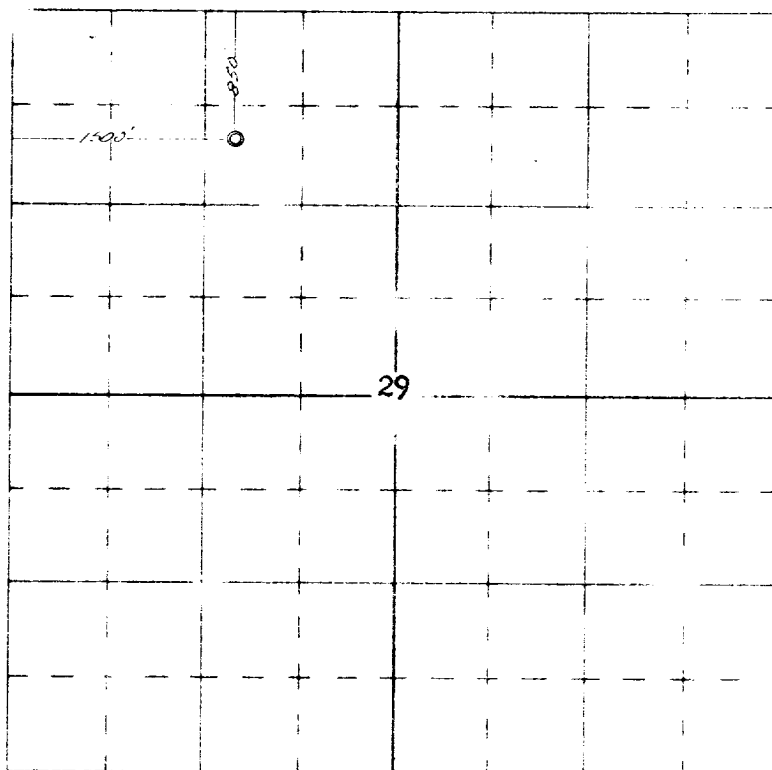

Scale -- 4 inches equals 1 mile

Surveyed March 2, 1955

This is to certify that the above plat was prepared from field notes of actual surveys made by me or under my supervision and that the same are true and correct to the best of my knowledge and belief.

*Ernest V. Echohawk*

Ernest V. Echohawk  
Registered Land Surveyor  
N. M. Reg. #1545

