

NEW MEXICO OIL CONSERVATION COMMISSION

Well Location and Acreage Dedication Plat

Section A.

Date 4 FEBRUARY 1958

Operator SKELLY OIL COMPANY Lease A. L. DUFF  
 Well No. 6 Unit Letter N Section 20 Township 26 NORTH Range 13 WEST NMPM  
 Located 660 Feet From THE SOUTH Line, 1980 Feet From THE WEST Line  
 County SAN JUAN G. L. Elevation \_\_\_\_\_ Dedicated Acreage 80 Acres  
 Name of Producing Formation Gallup Pool Bisti - Est.

1. Is the Operator the only owner\* in the dedicated acreage outlined on the plat below?  
Yes  No \_\_\_\_\_.
2. If the answer to question one is "no," have the interests of all the owners been consolidated by communitization agreement or otherwise? Yes \_\_\_\_\_ No \_\_\_\_\_. If answer is "yes," Type of Consolidation \_\_\_\_\_
3. If the answer to question two is "no," list all the owners and their respective interests below:  
REF. GLO Plat dated 19 July 1915

<u>Owner</u>	<u>Land Description</u>
_____	_____
_____	_____
_____	_____

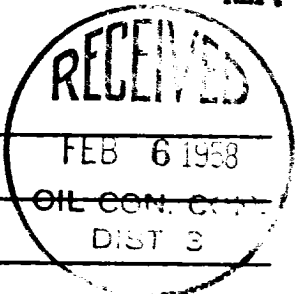

Section B

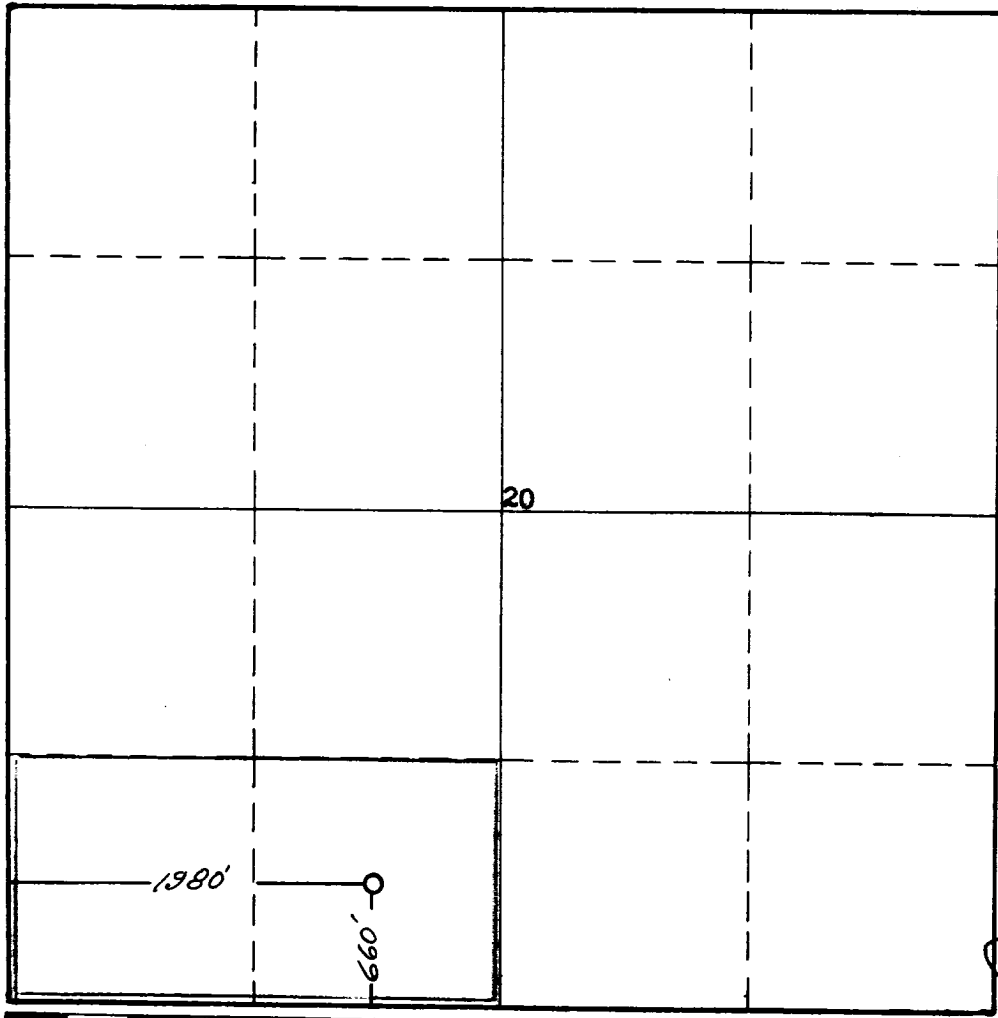

This is to certify that the information in Section A above is true and complete to the best of my knowledge and belief.

SKELLY OIL COMPANY  
(Operator)  
(Signed) P. E. Mosper  
(Representative)

Box 426, Farmington, New Mexico  
Address

This is to certify that the well location shown on the plat in Section B was plotted from field notes of actual surveys made by me or under my supervision and that the same is true and correct to the best of my knowledge and belief.

Date Surveyed 6 DECEMBER 1957

James P. Leese  
Registered Professional Engineer and/or Land Surveyor.

JAMES P. LEESE  
Certificate No. 1463

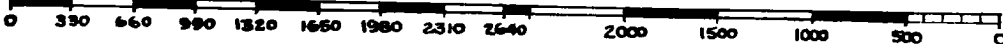

(See instructions for completing this form on the reverse side)

INSTRUCTIONS FOR COMPLETION:

1. Operator shall furnish and certify to the information called for in Section A.
2. Operator shall outline the dedicated acreage for both oil and gas wells on the plat in Section B.
3. A registered professional engineer or land surveyor registered in the State of New Mexico or approved by the Commission shall show on the plat the location of the well and certify this information in the space provided.
4. All distances shown on the plat must be from the outer boundaries of Section.
5. If additional space is needed for listing owners and their respective interests as required in question 3, Section A, please use space below

OIL CONSERVATION COMMISSION		
AZTEC DISTRICT OFFICE		
No. Copies Received	3	
DISTRIBUTION		
Operator		
State File	1	
Production Office		
State Land Office		
U. S. G. S.	1	
Transporter		
File	1	✓

\* "Owner" means the person who has the right to drill into and to produce from any pool and to appropriate the production either for himself or for himself and another. (65-3-29 (e) NMSA 1953 Comp.)