

**Santa Fe**

Land Office

**078433**

Lease No.

**SM/4 Sec. 20, T-26N,**

Unit

**R-2N, San Juan County,  
New Mexico.**

(SUBMIT IN TRIPLICATE)

**UNITED STATES  
DEPARTMENT OF THE INTERIOR  
GEOLOGICAL SURVEY**

**SUNDRY NOTICES AND REPORTS ON WELLS**

NOTICE OF INTENTION TO DRILL	<input checked="" type="checkbox"/>	SUBSEQUENT REPORT OF WATER SHUT-OFF	
NOTICE OF INTENTION TO CHANGE PLANS		SUBSEQUENT REPORT OF SHOOTING OR ACIDIZING	
NOTICE OF INTENTION TO TEST WATER SHUT-OFF		SUBSEQUENT REPORT OF ALTERING CASING	
NOTICE OF INTENTION TO RE-DRILL OR REPAIR WELL		SUBSEQUENT REPORT OF RE-DRILLING OR REPAIR	
NOTICE OF INTENTION TO SHOOT OR ACIDIZE		SUBSEQUENT REPORT OF ABANDONMENT	
NOTICE OF INTENTION TO PULL OR ALTER CASING		SUPPLEMENTARY WELL HISTORY	
NOTICE OF INTENTION TO ABANDON WELL			

(INDICATE ABOVE BY CHECK MARK NATURE OF REPORT, NOTICE, OR OTHER DATA)

**March 14**

**19 55**

Well No. **10 Newcom** is located **990** ft. from **S** line and **990** ft. from **W** line of sec. **20**

**SM/4** **SM/4 Sec. 20**  
(1/4 Sec. and Sec. No.)

**26N**  
(Twp.)

**8N**  
(Range)

**N.M.P.M.**  
(Meridian)

**Ballard Pictured Cliffs**  
(Field)

**San Juan**  
(County or Subdivision)

**New Mexico**  
(State or Territory)

The elevation of the derrick floor above sea level is \_\_\_\_\_ ft. **To Be Determined**

**DETAILS OF WORK**

(State names of and expected depths to objective sands; show sizes, weights, and lengths of proposed casings; indicate mudding jobs, cementing points, and all other important proposed work)

**Objective sand will be the Pictured Cliffs Formation. Anticipated at approximately 2070 feet.**

**Proposed Casing Program: 90' of 9 5/8" J-55 Cemented To Surface.  
2070' of 5 1/2" J-55 Cemented with 150 sacks.**

**Rotary tools will be employed from surface to top of Pictured Cliffs.  
Cable tools will be employed from top of Pictured Cliffs to 2070 feet.**

**The well will be shut or semi-oil fraced in an effort to stimulate production.**

**Estimated Total Depth 2100 feet.**

I understand that this plan of work must receive approval in writing by the Geological Survey before operations may be commenced.

Company **Southern Union Gas Company**

Address **1001 Bart Building**

**Dallas, Texas**

By **Paul J. Clote**

Title **Paul J. Clote**

COMPANY Southern Union Gas Company

Well Name & No. Newsom No. 10

Lease No. \_\_\_\_\_

Location 990' from the South line and 900' from the West line.

Being in SW $\frac{1}{4}$

Sec. 20, T26 N., R 8 W., N.M.P.M., San Juan County, New Mexico.

Ground Elevation \_\_\_\_\_

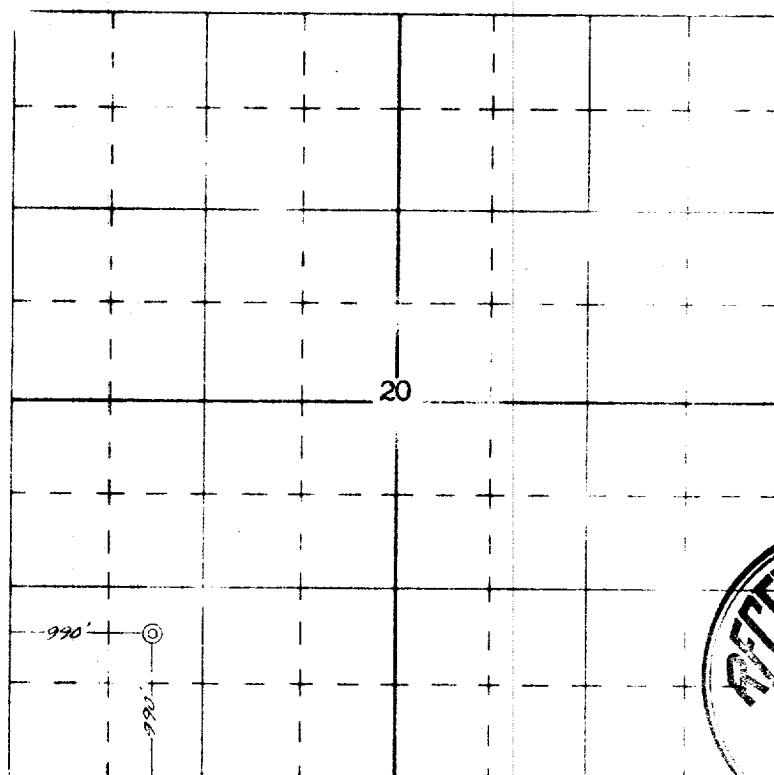

U. S. GEOLOGICAL SURVEY  
FARMINGTON, NEW MEXICO

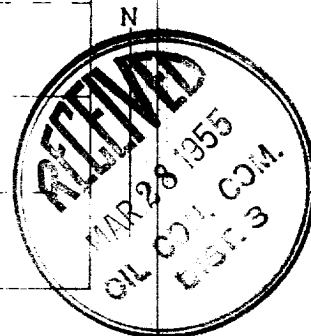

Scale -- 4 inches equals 1 mile

Surveyed March 2

, 1955

This is to certify that the above plat was prepared from field notes of actual surveys made by me or under my supervision and that the same are true and correct to the best of my knowledge and belief.

Ernest V. Echohawk

Ernest V. Echohawk  
Registered Land Surveyor  
N. M. Reg. #1545



NEW MEXICO  
OIL CONSERVATION COMMISSION

Gas Well Plat

Date March 15, 1955

Southern Union Gas Company

Newson

10

Operator

Lease

Well No.

Name of Producing Formation Pictured Cliffs Pool Ballard Pictured Cliffs

No. Acres Dedicated to the Well 160 ✓

SECTION 20 TOWNSHIP 26N RANGE 8W

			<b>RECEIVED</b> MAR 21 1955 U. S. GEOLOGICAL SURVEY FARMINGTON, N.M.

Section 20

I hereby certify that the information given above is true and complete  
to the best of my knowledge.

Name Paul J. Clote  
Position Paul J. Clote - Petroleum Engineer  
Representing Southern Union Gas Company  
Address 1001 Burt Building, Dallas 1, Texas

(over)

## INSTRUCTIONS

1. Is this gas well a dual completion? Yes \_\_\_\_\_ No \_\_\_\_\_
2. If the answer to Question 1 is Yes, are there any other dually completed wells within the dedicated acreage?  
Yes \_\_\_\_\_ No \_\_\_\_\_

A separate plat must be filed for each gas well, outlining the area dedicated to such well and showing the location of all other wells (oil and gas) within the outlined area.

Mail in duplicate to the district office for the district in which the well is located.

OIL CONSERVATION COMMISSION		
AZTEC DISTRICT OFFICE		
No. Copies Received <u>3</u>		
DISTRIBUTION		
Operator	1	
Santa Fe	1	
Promotion Office		
State Land Office		
U. S. G. S.	1	
Transporter		
File	1	