



COPY TO O. C. 21

UNITED STATES  
DEPARTMENT OF THE INTERIOR  
GEOLOGICAL SURVEY  
P. O. Box 965  
Farmington, New Mexico

IN REPLY REFER TO:

March 8, 1956

El Paso Natural Gas Company  
Box 997  
Farmington, New Mexico

Re: New Mexico 09840

Gentlemen:

Receipt is acknowledged of your "Notice of Intention to Drill" dated March 6, 1956 covering your well No. 4 McConnell in SW 1/4 sec. 24, T. 26 N., R. 9 W., N. M. P. M., San Juan County, New Mexico, Ballard P.C.

Your proposed work is hereby approved subject to compliance with the provisions of the "Oil and Gas Operating Regulations" revised May 25, 1942, a copy of which will be sent to you on request, and subject to the following conditions:

1. Drilling operations so authorized are subject to the attached sheet for general conditions of approval.
2. Furnish copies of all logs.

Very truly yours,

(Orig. Sgd.) P. T. McGrath

P. T. McGrath  
District Engineer

PTMcGrath:ac

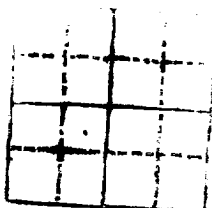
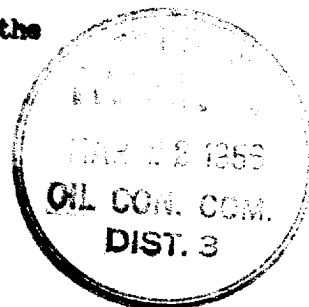

IN REPLY REFER TO

UNITED STATES  
DEPARTMENT OF THE INTERIOR  
GEOLOGICAL SURVEY



TO THE DIRECTOR, GEOLOGICAL SURVEY,  
WASHINGTON, D. C.

FROM THE CHIEF OF THE DISTRICT OF COLUMBIA,  
WASHINGTON, D. C.

SUBJECT: [Illegible]

[Illegible text follows]

100-100000



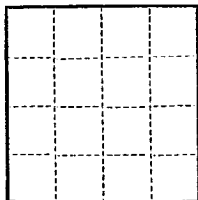

(SUBMIT IN TRIPLICATE)

UNITED STATES  
DEPARTMENT OF THE INTERIOR  
GEOLOGICAL SURVEY

Land Office New Mexico

Lease No. 09040

Unit McConnell

SUNDRY NOTICES AND REPORTS ON WELLS

NOTICE OF INTENTION TO DRILL	<input checked="" type="checkbox"/>	SUBSEQUENT REPORT OF WATER SHUT-OFF	
NOTICE OF INTENTION TO CHANGE PLANS		SUBSEQUENT REPORT OF SHOOTING OR ACIDIZING	
NOTICE OF INTENTION TO TEST WATER SHUT-OFF		SUBSEQUENT REPORT OF ALTERING CASING	
NOTICE OF INTENTION TO RE-DRILL OR REPAIR WELL		SUBSEQUENT REPORT OF RE-DRILLING OR REPAIR	
NOTICE OF INTENTION TO SHOOT OR ACIDIZE		SUBSEQUENT REPORT OF ABANDONMENT	
NOTICE OF INTENTION TO PULL OR ALTER CASING		SUPPLEMENTARY WELL HISTORY	
NOTICE OF INTENTION TO ABANDON WELL			

(INDICATE ABOVE BY CHECK MARK NATURE OF REPORT, NOTICE, OR OTHER DATA)

March 6, 1956

Well No. 4 is located 1300 ft. from S line and 1300 ft. from W line of sec. 24

Section 24  
( $\frac{1}{4}$  Sec. and Sec. No.)

26N  
(Twp.)

7W  
(Range)

NPN  
(Meridian)

Ballard P.C.  
(Field)

San Juan  
(County or Subdivision)

New Mexico  
(State or Territory)

The elevation of the derrick floor above sea level is 6332 ft.

DETAILS OF WORK

(State names of and expected depths to objective sands; show sizes, weights, and lengths of proposed casings; indicate mudding jobs, cementing points, and all other important proposed work)

It is intended to drill a well thru the Pictured Cliff formation using rotary tools to the casing point and to drill the pay section with cable tools and to water fracture the entire pay section. T.D. 2065'.

Casing Program:

9 5/8" at 120' with 125 sacks regular cement circulated to surface.  
5 1/2" at 1965' with 75 sacks regular cement, 75 sacks Pozmix.

The  $\frac{3}{4}$  of Section 24 is dedicated to this well.  
S.N. 4 NM 09040.

I understand that this plan of work must receive approval in writing by the Geological Survey before operations may be commenced.

Company El Paso Natural Gas Company

Address Box 937

Parlington, New Mexico

By [Signature]  
Title Petroleum Engineer

## OIL CONSERVATION COMMISSION

## WELL LOCATION AND/OR GAS PRODUCTION PLAT

DATE MARCH 1, 1956OPERATOR EL PASO NATURAL GAS COMPANY LEASE McCONNELL NM09840WELL NO. 4 SECTION 24 TOWNSHIP 26N RANGE 9W NMPMLOCATED 1800 FEET FROM SOUTH LINE 1800 FEET FROM WEST LINESAN JUAN COUNTY, NEW MEXICOG. L. ELEVATION 6322NAME OF PRODUCING FORMATION PICTURED CLIFF POOL BALLARD DEDICATED ACREAGE 160 ACRES  
(1941 PLAT)

Note: All distances must be from outer boundaries of section.

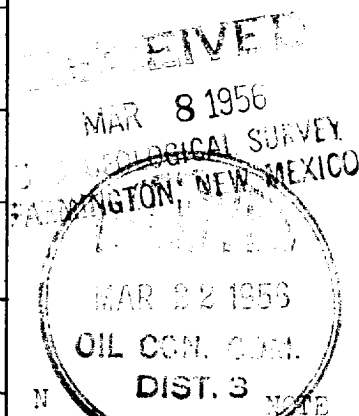
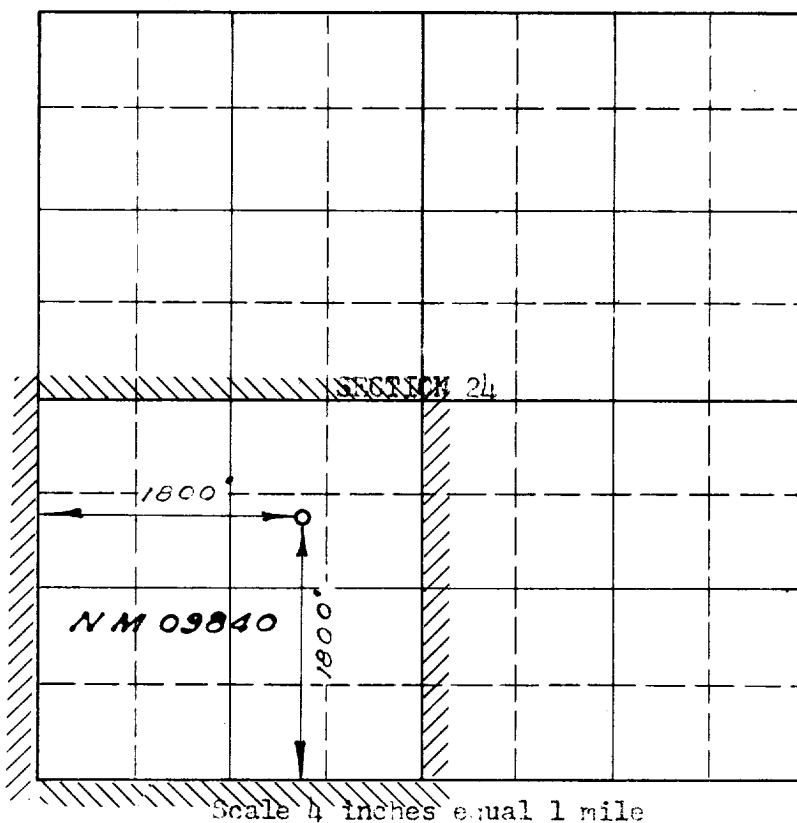

NOTE  
This section of  
farm is to be used  
for gas wells only

This is to certify that the above plat was prepared from field notes of actual surveys made by me or under my supervision and that the same are true and correct to the best of my knowledge and belief.

Date Surveyed FEBRUARY 22, 1956

C. O. Walker  
Registered Professional Engineer and  
Land Surveyor

(Seal)

Farmington, New Mexico

1. Is this well a Dual Comp.  
Yes        No
2. If the answer to Question 1 is yes, are there any other dually completed wells within the dedicated acreage.  
Yes        No

Name William T. WalkerPosition Petroleum EngineerRepresenting El Paso Natural GasAddress Box 997, Farmington, N.M.