

(SUBMIT IN TRIPLICATE)  
**UNITED STATES  
DEPARTMENT OF THE INTERIOR  
GEOLOGICAL SURVEY**

Land Office Fort St  
Lease No. 273000  
Unit Surface Unit

## SUNDRY NOTICES AND REPORTS ON WELLS

NOTICE OF INTENTION TO DRILL	<input checked="" type="checkbox"/>	SUBSEQUENT REPORT OF WATER SHUT-OFF	
NOTICE OF INTENTION TO CHANGE PLANS		SUBSEQUENT REPORT OF SHOOTING OR ACIDIZING	
NOTICE OF INTENTION TO TEST WATER SHUT-OFF		SUBSEQUENT REPORT OF ALTERING CASING	
NOTICE OF INTENTION TO RE-DRILL OR REPAIR WELL		SUBSEQUENT REPORT OF RE-DRILLING OR REPAIR	
NOTICE OF INTENTION TO SHOOT OR ACIDIZE		SUBSEQUENT REPORT OF ABANDONMENT	
NOTICE OF INTENTION TO PULL OR ALTER CASING		SUPPLEMENTARY WELL HISTORY	
NOTICE OF INTENTION TO ABANDON WELL			

(INDICATE ABOVE BY CHECK MARK NATURE OF REPORT, NOTICE, OR OTHER DATA)

**RECEIVED**  
SEP 25 1956  
GEOLOGICAL SURVEY  
FARMINGTON, NEW MEXICO

Well No. 21 is located 1700 ft. from S line and 190 ft. from E line of sec. 21  
21 section 21 20N 10W RMPN  
(1/4 Sec. and Sec. No.) (Twp.) (Range) (Meridian)  
Ballard P.O. Mts. San Juan New Mexico  
(Field) (County or Subdivision) (State or Territory)

The elevation of the derrick floor above sea level is 6412 ft.

### DETAILS OF WORK

(State names of and expected depths to objective sands; show sizes, weights, and lengths of proposed casings; indicate mudding jobs, cementing points, and all other important proposed work)

It is intended to drill a well thru the Pictured Cliff formation using rotary tools and to perforate and water fracture possible producing zones. Estimated T.D. 2005'.

#### Casing Program:

- 9 5/8" at 120' with 125 sacks regular cement circulated to surface.
- 5 1/2" at 2005' with 75 sacks regular cement, 75 sacks Pozmix.

The SE 1/4 of section 21 is dedicated to this well.  
2005' (at 070000).

I understand that this plan of work must receive approval in writing by the Geological Survey before operations may be commenced.

Company El Paso Natural Gas Company

Address Box 957

Farmington, New Mexico

By [Signature]

Title Petroleum Engineer

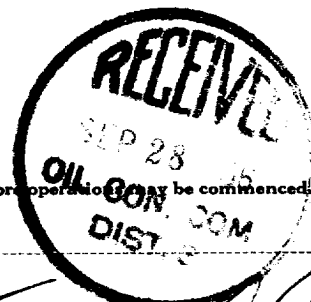



WELL LOCATION AND/OR GAS PRORATION PLAT

DATE SEPTEMBER 18, 1956

OPERATOR EL PASO NATURAL GAS COMPANY NAME HUERFANO SF 078060

WELL NO. 53 SECTION 21 TOWNSHIP 26-N RANGE 9-N NMPN

LOCATED 1700 FEET FROM SOUTH LINE 990 FEET FROM EAST LINE

SAN JUAN COUNTY, NEW MEXICO OIL DEVIATION 640122

NAME OF LAND OWNERS PICTURED CLIFF BALLARD EXTENSION 160  
(1949 PLAT)

Note: All distances must be from outer boundaries of section.

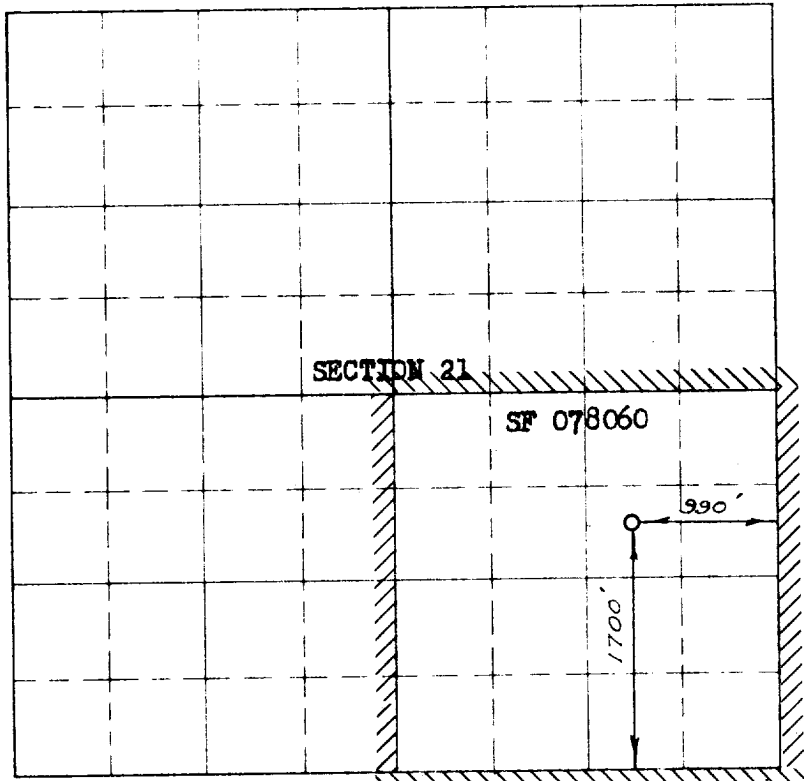

Scale 1 inches equal 1 mile

NOTE

This section of  
form is to be used  
for gas wells only

This is to certify that the above plat was prepared from  
field notes of actual surveys made by me or under my  
supervision and that the same are true and correct to the  
best of my knowledge and belief.

Date Surveyed SEPTEMBER 12, 1956

C. O. Walker  
Registered Professional Engineer and ~~Oil~~ Land Surveyor

1. Is this well a Dual Comp.

Yes \_\_\_\_\_ No X

2. If the answer to Question 1  
is yes, are there any other dually  
completed wells within the  
dedicated acreage.

Yes \_\_\_\_\_ No \_\_\_\_\_

Name [Signature]

Position Petroleum Engineer

Representing El Paso Natural Gas Co.

Address Box 997, Farmington, N.M.

(Seal)