

APPROVED

Form 5331a
(Feb. 1951)

6 1957

JERRY W. LONG
ACTING DISTRICT ENGINEER

(SUBMIT IN TRIPLICATE)

UNITED STATES
DEPARTMENT OF THE INTERIOR
GEOLOGICAL SURVEY

Budget Bureau No. 42-R358.4.
Approval expires 12-31-60.

Land Office Santa Fe
Lease No. N.M. 013492
Unit A. L. Duff

SUNDRY NOTICES AND REPORTS ON WELLS

NOTICE OF INTENTION TO DRILL	<input checked="" type="checkbox"/>	SUBSEQUENT REPORT OF WATER SHUT-OFF	
NOTICE OF INTENTION TO CHANGE PLANS		SUBSEQUENT REPORT OF SHOOTING OR ACIDIZING	
NOTICE OF INTENTION TO TEST WATER SHUT-OFF		SUBSEQUENT REPORT OF ALTERING CASING	
NOTICE OF INTENTION TO RE-DRILL OR REPAIR WELL		SUBSEQUENT REPORT OF RE-DRILLING OR REPAIR	
NOTICE OF INTENTION TO SHOOT OR ACIDIZE		SUBSEQUENT REPORT OF ABANDONMENT	
NOTICE OF INTENTION TO PULL OR ALTER CASING		SUPPLEMENTARY WELL HISTORY	
NOTICE OF INTENTION TO ABANDON WELL			

(INDICATE ABOVE BY CHECK MARK NATURE OF REPORT, NOTICE, OR OTHER DATA)

September 11, 1957

A. L. Duff
Well No. 3 is located 1980 ft. from S line and 1980 ft. from E line of sec. 20

NW 1/4-SE 1/4 (1/4 Sec. and Sec. No.) 26N (Twp.) 13W (Range) N.M.P.M. (Meridian)
Undesignated (Gallup) (Field) San Juan (County or Subdivision) New Mexico (State or Territory)

The elevation of the derrick floor above sea level is _____ ft.

DETAILS OF WORK

(State names of and expected depths to objective sands; show sizes, weights, and lengths of proposed casings; indicate mudding jobs, cementing points, and all other important proposed work)

It is our intention drill Well No. 3 to an approximate depth of 5200' to test the Gallup formation. Our casing program is as follows:

250' of 10-3/4" OD casing, 32.75# BW H-40, cemented with 200 sacks cement. Circulated.

5200' of 5-1/2" OD casing, 14# SS J-55, cemented with 250 sacks cement.

I understand that this plan of work must receive approval in writing by the Geological Survey before operations may be commenced.

Company SKELLY OIL COMPANY
Box 426
Address Farmington, New Mexico

By (Signed) P. B. Cooper
Title District Superintendent

NEW MEXICO OIL CONSERVATION COMMISSION
Well Location and Acreage Dedication Plat

Section A.

Date September 10, 1957

Operator SKELLY OIL COMPANY Lease A. L. DUFF
Well No. 3 Unit Letter J Section 20 Township 26 NORTH Range 13 WEST, NMPM
Located 1980 Feet From the SOUTH Line, 1980 Feet From the EAST Line
County SAN JUAN G. L. Elevation _____ Dedicated Acreage 40 Acres
Name of Producing Formation Gallup Pool Undesignated

1. Is the Operator the only owner* in the dedicated acreage outlined on the plat below?
Yes X No _____.
2. If the answer to question one is "no," have the interests of all the owners been consolidated by communitization agreement or otherwise? Yes _____ No _____. If answer is "yes," Type of Consolidation _____
3. If the answer to question two is "no," list all the owners and their respective interests below:

Owner

Land Description

Section B

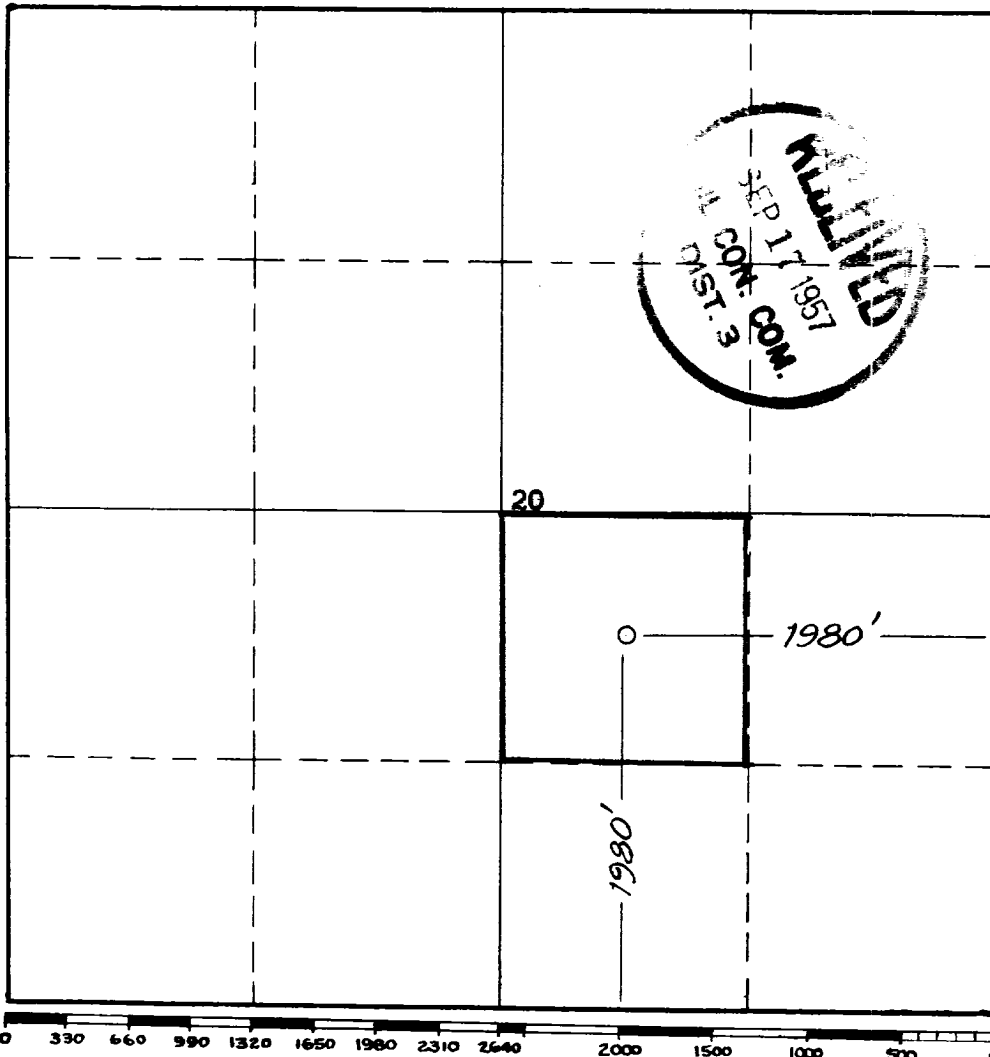

This is to certify that the information in Section A above is true and complete to the best of my knowledge and belief.

SKELLY OIL COMPANY

(Operator)

[Signed] P. E. Cosper

(Representative)

Box 426, Farmington, New Mexico
Address

This is to certify that the well location shown on the plat in Section B was plotted from field notes of actual surveys made by me or under my supervision and that the same is true and correct to the best of my knowledge and belief.

Date Surveyed 8 SEPTEMBER 1957

James P. Lease
Registered Professional
Engineer and/or Land Surveyor.
James P. Lease

Certificate No. 1463