

X			

3-USGS
1-Skelly
1-D
1-F

(SUBMIT IN TRIPLICATE)

UNITED STATES
DEPARTMENT OF THE INTERIOR
GEOLOGICAL SURVEY

Budget Bureau No. 42-R358.4.
Approval expires 12-31-60.

Land Office _____
Lease No. **SP-076937**
Unit _____
Davis Federal

SUNDRY NOTICES AND REPORTS ON WELLS

NOTICE OF INTENTION TO DRILL	<input checked="" type="checkbox"/>	SUBSEQUENT REPORT OF WATER SHUT-OFF	
NOTICE OF INTENTION TO CHANGE PLANS		SUBSEQUENT REPORT OF SHOOTING OR ACIDIZING	
NOTICE OF INTENTION TO TEST WATER SHUT-OFF		SUBSEQUENT REPORT OF ALTERING CASING	
NOTICE OF INTENTION TO RE-DRILL OR REPAIR WELL		SUBSEQUENT REPORT OF RE-DRILLING OR REPAIR	
NOTICE OF INTENTION TO SHOOT OR ACIDIZE		SUBSEQUENT REPORT OF ABANDONMENT	
NOTICE OF INTENTION TO PULL OR ALTER CASING		SUPPLEMENTARY WELL HISTORY	
NOTICE OF INTENTION TO ABANDON WELL			

(INDICATE ABOVE BY CHECK MARK NATURE OF REPORT, NOTICE, OR OTHER DATA)

August 8, 19 62

Well No. 1 is located 1850 ft. from S line and 790 ft. from W line of sec. 24
NW/4 SW/4 Sec. 24 26N 11W NMPM
(1/4 Sec. and Sec. No.) (Twp.) (Range) (Meridian)
Basin Dakota San Juan New Mexico
(Field) (County or Subdivision) (State or Territory)

The elevation of the derrick floor above sea level is 6341 ft. G.L.

DETAILS OF WORK

(State names of and expected depths to objective sands; show sizes, weights, and lengths of proposed casings; indicate mudding jobs, cementing points, and all other important proposed work)

Propose to drill with rotary tools to an estimated depth of 6350 feet or to test the Dakota formation. Casing program will be as follows:

10 3/4" 32.75# surface casing set at approximately 200' cemented w/150 sx.
 4 1/2" 10.90# casing set at total depth w/300 sx or cement to cover the Gallup formation.

Will perforate and sand-water frac the Dakota formation.

I understand that this plan of work must receive approval in writing by the Geological Survey before operations may be commenced.

Company Southwest Production Company

Address 207 Petr. Club Plaza
Farmington, N. M.

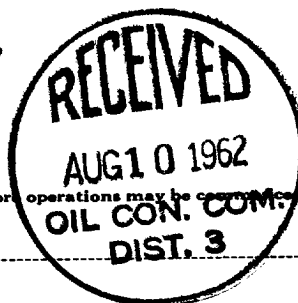

Original signed by
Carl W. Smith

By _____
 Title Superintendent

Well Location and Acreage Dedication Plat

Section A.

Date 8/8/62

Operator SOUTHWEST PRODUCTION COMPANY Lease Devia Federal 57-078937
 Well No. 1 Unit Letter L Section 24 Township 26 NORTH Range 11 WEST NMPM
 Located 1850 Feet From the SOUTH Line, 790 Feet From the WEST Line
 County SAN JUAN G. L. Elevation 6341.0 Dedicated Acreage 8/320 Acres
 Name of Producing Formation Dakota Pool Basin Dakota

1. Is the Operator the only owner in the dedicated acreage outlined on the plat below?
 Yes X No _____
2. If the answer to question one is "no", have the interests of all the owners been consolidated by communitization agreement or otherwise? Yes _____ No _____. If answer is "yes", Type of Consolidation.

3. If the answer to question two is "no", list all the owners and their respective interests below:

Owner

Land Description

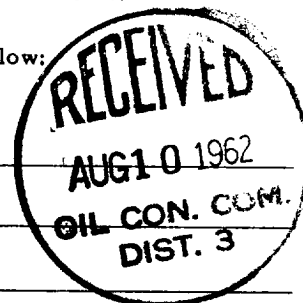

Section B.

Note: All distances must be from outer boundaries of section.

This is to certify that the information in Section A above is true and complete to the best of my knowledge and belief.

Southwest Production Company

(Operator)

Original signed by
Carl W. Smith

(Representative)

207 Petr. Club Plaza

(Address)

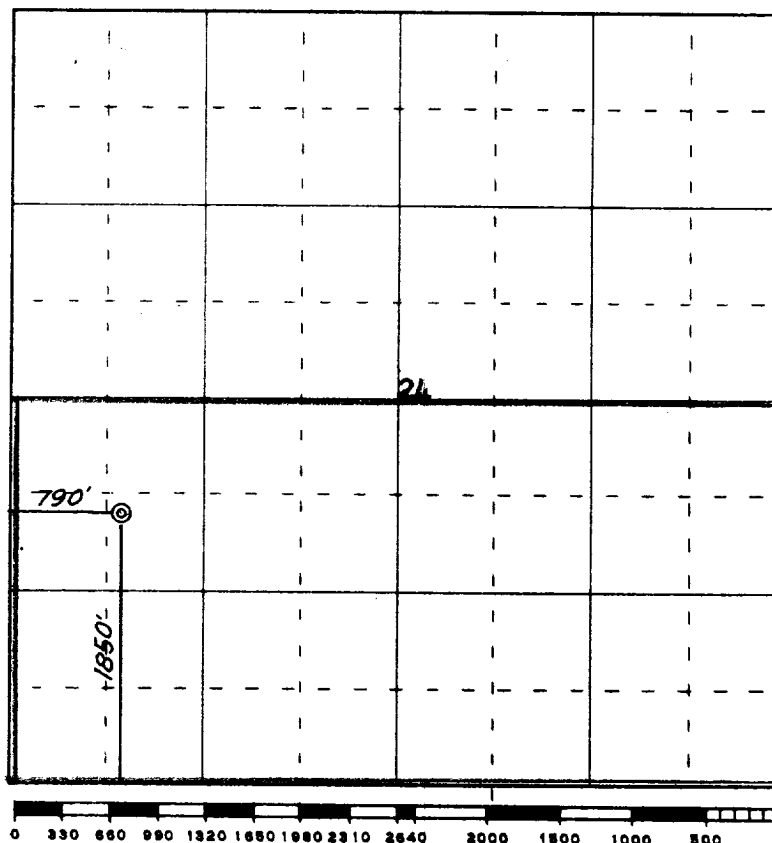
Farmington, New Mexico

Scale 4 inches equal 1 mile

This is to certify that the above plat was prepared from field notes of actual surveys made by me or under my supervision and that the same are true and correct to the best of my knowledge and belief.

(Seal)

Date Surveyed June 16, 1962

Farmington, New Mexico

James P. Leese
 Registered Professional Engineer and/or Land Surveyor
 James P. Leese N. Mex. Reg. No. 1463
 San Juan, New Mexico