

NEW MEXICO OIL CONSERVATION COMMISSION  
Well Location and Acreage Dedication Plat

Section A.

Date February 4, 1958

Operator THE SKELLY OIL COMPANY Lease A. L. DUFF  
Well No. 4 Unit Letter H Section 20 Township 26 NORTH Range 13 WEST NMPM  
Located 1980 Feet From the NORTH Line, 660 Feet From the EAST Line  
County SAN JUAN G. L. Elevation \_\_\_\_\_ Dedicated Acreage 80 Acres  
Name of Producing Formation Gallup Pool Bixti - Ext.

1. Is the Operator the only owner\* in the dedicated acreage outlined on the plat below?  
Yes X No \_\_\_\_\_.
2. If the answer to question one is "no," have the interests of all the owners been consolidated by communitization agreement or otherwise? Yes \_\_\_\_\_ No \_\_\_\_\_. If answer is "yes," Type of Consolidation \_\_\_\_\_
3. If the answer to question two is "no," list all the owners and their respective interests below:  
Ref: GLO plat dated 15 July 1915

Owner

Land Description

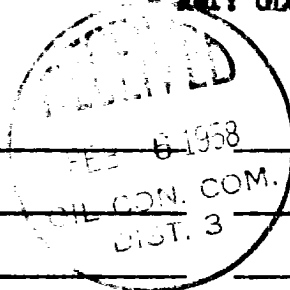

**RECEIVED**  
FEB 5 1958  
U. S. GEOLOGICAL SURVEY  
FARMINGTON, N.M.

Section B

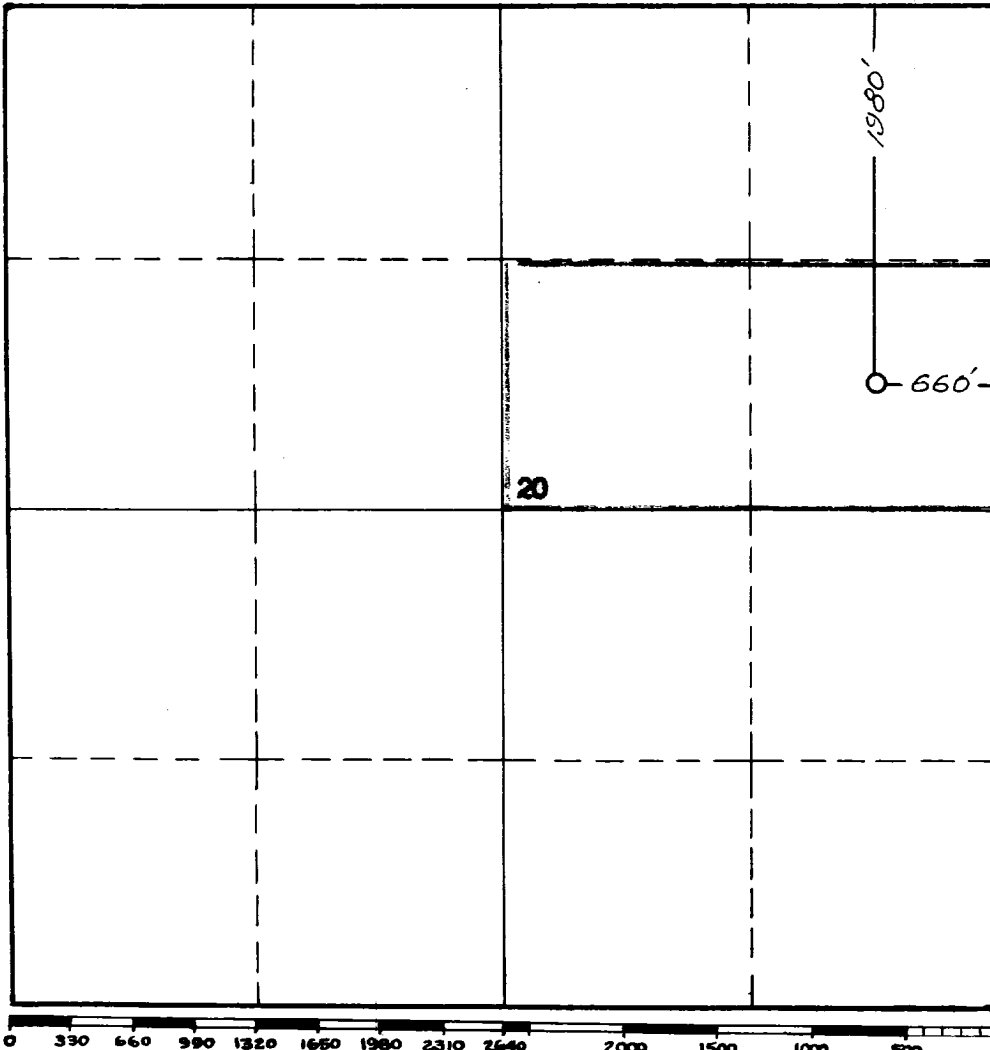

This is to certify that the information in Section A above is true and complete to the best of my knowledge and belief.

SKELLY OIL COMPANY

(Operator)

P. E. Cooper  
(Representative)

Box 426, Farmington, New Mexico

Address

This is to certify that the well location shown on the plat in Section B was plotted from field notes of actual surveys made by me or under my supervision and that the same is true and correct to the best of my knowledge and belief.

Date Surveyed 17 October 1957

James P. Leese  
Registered Professional  
Engineer and/or Land Surveyor.  
James P. Leese

Certificate No. 1463

5

1000000

OIL CONSERVATION COMMISSION		
AZTEC DISTRICT OFFICE		
No. of Copies	3	
Original		
Copy		
See	1	
Copy		
U. S. G. S.	1	
Transporter		
File	1	✓