

	X	

(SUBMIT IN TRIPLICATE)

UNITED STATES  
DEPARTMENT OF THE INTERIOR  
GEOLOGICAL SURVEY

Land Office **NM**  
**02901**  
Lease No. **B**  
Unit

SUNDRY NOTICES AND REPORTS ON WELLS

NOTICE OF INTENTION TO DRILL.....	X	SUBSEQUENT REPORT OF WATER SHUT-OFF.....
NOTICE OF INTENTION TO CHANGE PLANS.....		SUBSEQUENT REPORT OF SHOOTING OR ACIDIZING.....
NOTICE OF INTENTION TO TEST WATER SHUT-OFF.....		SUBSEQUENT REPORT OF ALTERING CASING.....
NOTICE OF INTENTION TO RE-DRILL OR REPAIR WELL.....		SUBSEQUENT REPORT OF RE-DRILLING OR REPAIR.....
NOTICE OF INTENTION TO SHOOT OR ACIDIZE.....		SUBSEQUENT REPORT OF ABANDONMENT.....
NOTICE OF INTENTION TO PULL OR ALTER CASING.....		SUPPLEMENTARY WELL HISTORY.....
NOTICE OF INTENTION TO ABANDON WELL.....		

(INDICATE ABOVE BY CHECK MARK NATURE OF REPORT, NOTICE, OR OTHER DATA)

CONSOLIDATED-NALE

August 5, 1960

Well No. **1-24** is located **795** ft. from **N** line and **1700** ft. from **E** line of sec. **24**  
**NW-NE of 24** **26N** **8W** **NMPM**  
( $\frac{1}{4}$  Sec. and Sec. No.) (Twp.) (Range) (Meridian)  
**Undesignated Dakota** **San Juan** **New Mexico**  
(Field) (County or Subdivision) (State or Territory)

The elevation of the ~~ground~~ derrick floor above sea level is **6887** ft.

DETAILS OF WORK

(State names of and expected depths to objective sands; show sizes, weights, and lengths of proposed casings; indicate mudding jobs, cementing points, and all other important proposed work)

1. Set 150' of 10-3/4" surface casing.
2. Drill with rotary tools to about 7200' to test Dakota.
3. Well will be completed by setting 5-1/2" or 7" thru the Dakota; selectively perforate and sand-water frac.
4. A dual Dakota-Pictured Cliffs completion will be considered. If event, PC will be protected by cement.

I understand that this plan of work must receive approval in writing by the Geological Survey before operations may be commenced.

Company **H. D. MALE**  
Address **Suite 1120 - 1700 Broadway**  
**Denver 2, Colorado**

By **GEORGE WHITE**  
Title **Office Manager**

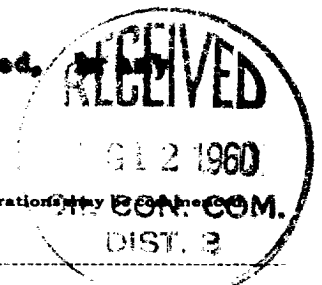

NEW MEXICO OIL CONSERVATION COMMISSION  
WELL LOCATION AND ACREAGE DEDICATION PLAT

FORM C-128  
Revised 5/1/57

SEE INSTRUCTIONS FOR COMPLETING THIS FORM ON THE REVERSE SIDE

SECTION A

Operator <b>HURON DRILLING COMPANY</b>		Lease <b>CONSOLIDATED</b>		Well No. <b>1</b>
Unit Letter <b>B</b>	Section <b>24</b>	Township <b>26 NORTH</b>	Range <b>8 WEST</b>	County <b>SAN JUAN</b>
Actual Footage Location of Well: <b>795</b> feet from the <b>NORTH</b> line and <b>1700</b> feet from the <b>EAST</b> line				
Ground Level Elev. <b>6807.0</b>	Producing Formation <b>DAKOTA</b>	Pool <b>Undesignated Dakota</b>	Dedicated Acreage: <b>320</b> Acres	

1. Is the Operator the only owner in the dedicated acreage outlined on the plat below? YES ☒ NO \_\_\_\_ . ("Owner" means the person who has the right to drill into and to produce from any pool and to appropriate the production either for himself or for himself and another. (65-3-29 (e) NMSA 1935 Comp.)
2. If the answer to question one is "no," have the interests of all the owners been consolidated by communitization agreement or otherwise? YES \_\_\_\_ NO \_\_\_\_ . If answer is "yes," Type of Consolidation \_\_\_\_
3. If the answer to question two is "no," list all the owners and their respective interests below:

Owner	Land Description



SECTION B

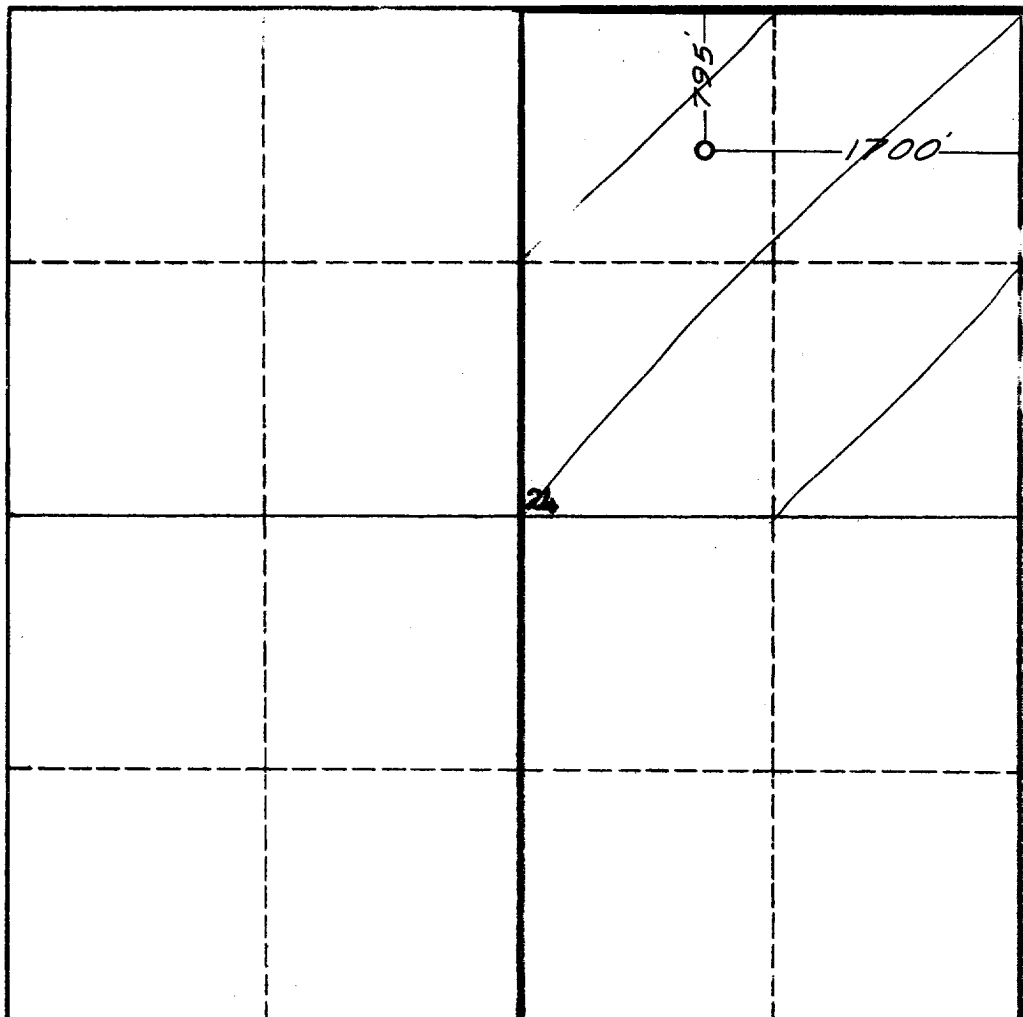

I hereby certify that the information in SECTION A above is true and complete to the best of my knowledge and belief.

Name  
**GEORGE WHITE**

Position  
**Office Manager**

Company  
**H. D. HALE**

Date  
**8/5/60**

I hereby certify that the well location shown on the plat in SECTION B was plotted from field notes of actual surveys made by me or under my supervision, and that the same is true and correct to the best of my knowledge and belief.

Date Surveyed  
**13 July 1960**

Registered Professional Engineer and/or Land Surveyor

*James P. Lease*  
**James P. Lease**

Certificate No. **1463**

0 330 660 990 1320 1650 1980 2310 2640 2000 1500 1000 500 0

## INSTRUCTIONS FOR COMPLETION OF FORM C-128

1. Operator shall furnish and certify to the information called for in Section A.
2. Operator shall outline the dedicated acreage for *both* oil and gas wells on the plat in Section B.
3. A registered professional engineer or land surveyor registered in the State of New Mexico or approved by the Commission shall show on the plat the location of the well and certify this information in the space provided.
4. All distances shown on the plat must be from the outer boundaries of the Section.
5. If additional space is needed for listing owners and their respective interests as required in question 3 of Section A, please use space below.