

(SUBMIT IN TRIPLICATE)

UNITED STATES  
DEPARTMENT OF THE INTERIOR  
GEOLOGICAL SURVEY

Land Office Santa Fe  
Lease No. SF 078431  
Unit S/2, Sec. 14, T-26N,  
R-8W, San Juan County,  
New Mexico

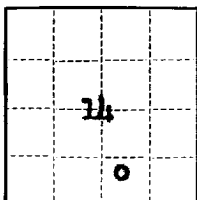

SUNDRY NOTICES AND REPORTS ON WELLS

NOTICE OF INTENTION TO DRILL	<input checked="" type="checkbox"/>	SUBSEQUENT REPORT OF WATER SHUT-OFF	
NOTICE OF INTENTION TO CHANGE PLANS		SUBSEQUENT REPORT OF SHOOTING OR ACIDIZING	
NOTICE OF INTENTION TO TEST WATER SHUT-OFF		SUBSEQUENT REPORT OF ALTERING CASING	
NOTICE OF INTENTION TO RE-DRILL OR REPAIR WELL		SUBSEQUENT REPORT OF RE-DRILLING OR REPAIR	
NOTICE OF INTENTION TO SHOOT OR ACIDIZE		SUBSEQUENT REPORT OF ABANDONMENT	
NOTICE OF INTENTION TO PULL OR ALTER CASING		SUPPLEMENTARY WELL HISTORY	
NOTICE OF INTENTION TO ABANDON WELL			

(INDICATE ABOVE BY CHECK MARK NATURE OF REPORT, NOTICE, OR OTHER DATA)

September 18, 1963

Well No. 10/ Nickson is located 790 ft. from S line and 1735 ft. from E line of sec. 14  
SW/4, SE/4, Sec. 14 26-N 8-W N.M.P.M.  
(1/4 Sec. and Sec. No.) (Twp.) (Range) (Meridian)  
Basin Dakota San Juan New Mexico  
(Field) (County or Subdivision) (State or Territory)

The elevation of the derrick floor above sea level is 6325 ft. Ground Level.

DETAILS OF WORK

(State names of and expected depths to objective sands; show sizes, weights, and lengths of proposed casings; indicate mudding jobs, cementing points, and all other important proposed work)

To drill a well to the Dakota formation. Total depth 6730 ft.  
Casing Program: Surface: 8-5/8", 24.0#, J-55 at 250 ft. cemented to surface.  
Production: 4-1/2", 10.50#, J-55 at 6730 w/250 sx.  
Tubing: 1-1/2", E.U.E., 2.90#, JCW at approx. 6600 ft.  
Baker Stage Collar will be set at approx. 2300 ft. under Pictograph Bluffs formation and Cement Circulated to surface.  
Rotary tools will be employed from surface to total depth.  
Well will be fraced to stimulate production.

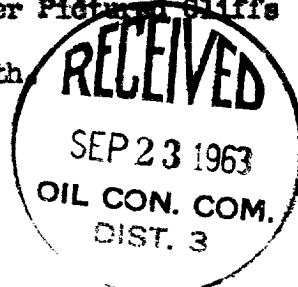

I understand that this plan of work must receive approval in writing by the Geological Survey before operations may be commenced.

Company SOUTHERN UNION PRODUCTION COMPANY

Address P. O. Box 808

Farmington, New Mexico

By Gilbert D. Noland, Jr.  
Title Drilling Superintendent

## NEW MEXICO OIL CONSERVATION COMMISSION

## Well Location and Acreage Dedication Plat

Section A.

Date September 13, 1963

Operator SOUTHERN UNION PRODUCTION COMPANY Lease HICKSON  
 Well No. 30 Unit Letter P Section 14 Township 26 NORTH Range 8 WEST NMPM  
 Located 790 Feet From the SOUTH Line, 1735 Feet From the EAST Line  
 County SAN JUAN G. L. Elevation 6325.0 Dedicated Acreage 300 Acres  
 Name of Producing Formation SAKOTA Pool BASIN SAKOTA

1. Is the Operator the only owner in the dedicated acreage outlined on the plat below?  
 Yes 3 No \_\_\_\_\_
2. If the answer to question one is "no", have the interests of all the owners been consolidated by communitization agreement or otherwise? Yes \_\_\_\_\_ No \_\_\_\_\_. If answer is "yes", Type of Consolidation \_\_\_\_\_
3. If the answer to question two is "no", list all the owners and their respective interests below:

Owner

Land Description

RECEIVED  
 SEP 23 1963  
 OIL CO.

RECEIVED  
 SEP 20 1963

U. S. GEOLOGICAL SURVEY  
 ALBUQUERQUE, NEW MEXICO

Section B.

Note: All distances must be from outer boundaries of section.

This is to certify that the information  
 in Section A above is true and complete  
 to the best of my knowledge and belief.

SOUTHERN UNION PRODUCTION COMPANY

(Operator)

*William D. Noland Jr.*  
 (Representative)

P. O. Box 808

(Address)

Farmington, New Mexico

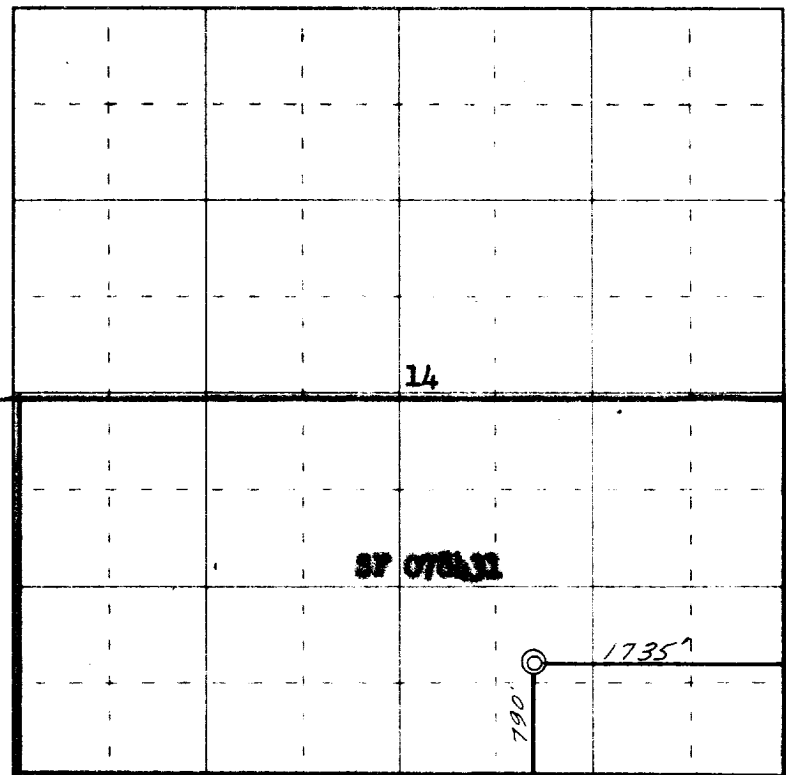

0 330 660 990 1320 1650 1980 2310 2640 2000 1500 1000 500 0

Scale 4 inches equal 1 mile

This is to certify that the above plat was prepared from field notes of actual surveys  
 made by me or under my supervision and that the same are true and correct to the best  
 of my knowledge and belief.

(Seal)

Date Surveyed 15 September 1963

Farmington, New Mexico

*James P. Leese*  
 Registered Professional Engineer and/or Land Surveyor  
 James P. Leese N. Mex. Reg. No. 1463  
 San Juan Engineering Company