

OK

Denny E. Faust
EL PASO FIELD SERVICES
DEPUTY OIL & GAS INSPECTOR
PIT CLOSURE REPORT

AUG 09 1999

Approved

NICKSON #10 Pit #1
Meter/Line ID - 73744

SITE DETAILS

Legals: Twp: 26N Rng: 8W
NMOCD Hazard Ranking: 10
Operator: Conoco

Sec: 14 Unit: O
Land Type: BLM

PREVIOUS ACTIVITIES

Site Assessment: Sept-94 Test Excavation: Sept-94 Revised Site Assessment: May-98

A test excavation was conducted on the pit and a soil sample was collected at 12 feet beneath ground surface (bgs). The headspace soil reading from the excavation bottom was 1 ppm. Soil analytical results were as follows: TPH (418.1) 46.1 mg/kg .

CONCLUSIONS

The primary source, discharge to the pit, has been removed and the pit has been closed for over four years.

Groundwater was not encountered and an analytical soil sample, collected from below the pit, was below New Mexico Oil Conservation Division (NMOCD) standards for a pit with a hazard ranking of 10. Impact to groundwater is unlikely and no excavation of soils from the pit was required to meet closure standards. The pit was filled with clean fill dirt during final pit closure activities.

RECOMMENDATIONS

- EPFS requests closure at this site.

ATTACHMENT

- Revised Pit assessment Form
- Field Pit Assessment Form
- Field Pit Remediation/Closure Form
- Laboratory Analytical Results
- Chain of Custody

RECEIVED
JUN 22 1999

OIL CON. DIV.
DIST. 3

REVISED
FIELD PIT SITE ASSESSMENT FORM

GENERAL	<p>Meter: <u>73744</u> Location: <u>NICKSON #10</u> <u>Pit 1</u></p> <p>Operator #: _____ Operator Name: <u>CONOCO</u> P/L District: _____</p> <p>Coordinates: Letter: <u>0</u> Section <u>14</u> Township: <u>26</u> Range: <u>8</u></p> <p>Or Latitude _____ Longitude _____</p> <p>Pit Type: Dehydrator _____ Location Drip: _____ Line Drip: _____ Other: _____</p> <p>Site Assessment Date: <u>5-4-98</u> Area: <u>07</u> Run: <u>51</u></p>
SITE ASSESSMENT	<p>NMOCD Zone: (From NMOCD Maps)</p> <p style="margin-left: 100px;">Inside <input type="checkbox"/> (1)</p> <p style="margin-left: 100px;">Outside <input checked="" type="checkbox"/> (2)</p> <p>Land Type:</p> <p style="margin-left: 100px;">BLM <input checked="" type="checkbox"/> (1)</p> <p style="margin-left: 100px;">State <input type="checkbox"/> (2)</p> <p style="margin-left: 100px;">Fee <input type="checkbox"/> (3)</p> <p style="margin-left: 100px;">Indian _____</p> <p>Depth to Groundwater</p> <p>Less Than 50 Feet (20 points) <input type="checkbox"/> (1)</p> <p>50 Ft to 99 Ft (10 points) <input checked="" type="checkbox"/> (2)</p> <p>Greater Than 100 Ft (0 points) <input type="checkbox"/> (3)</p> <p>Wellhead Protection Area</p> <p>Is it less than 1000 ft from wells, springs or other sources of fresh water extraction?, or; Is it less than 200 ft from a private domestic water source?</p> <p align="center"><input type="checkbox"/> (1) YES (20 points) <input checked="" type="checkbox"/> (2) NO (0 points)</p> <p>Horizontal Distance to Surface Water Body</p> <p>Less Than 200 Ft (20 points) <input type="checkbox"/> (1)</p> <p>200 Ft to 1000 Ft (10 points) <input type="checkbox"/> (2)</p> <p>Greater Than 1000 Ft (0 points) <input checked="" type="checkbox"/> (3)</p> <p>Name of Surface Water Body _____</p> <p>(Surface Water Body: Perennial Rivers, Streams, Creeks, Irrigation Canals, Ditches, Lakes, Ponds)</p> <p>Distance to Nearest Ephemeral Stream <input type="checkbox"/> (1) < 100' (Navajo Pits Only)</p> <p style="margin-left: 100px;"><input type="checkbox"/> (2) > 100'</p> <p>TOTAL HAZARD RANKING SCORE: <u>10</u> POINTS</p>
REMARKS	<p>Remarks : <u>Site has been re-assessed, due to initial assessment including washes as a Surface Water Body. LOCATION IS IN A REMOTE AREA ON A HILL WEST OF BIG RINCON WASH.</u></p>

FIELD PIT SITE ASSESSMENT FORM

GENERAL

Meter: 73-744 Location: Nickson 10 (Pit 1)
 Operator #: 0177 Operator Name: Merit Energy Co. P/L District: Ballard
 Coordinates: Letter: Q Section 14 Township: 26 Range: 8
 Or Latitude _____ Longitude _____
 Pit Type: Dehydrator _____ Location Drip: Line Drip: _____ Other: _____
 Site Assessment Date: 9/27/94 Area: 07 Run: 51

SITE ASSESSMENT

NMOCD Zone:
 (From NMOCD Maps) Inside (1) Outside (2)

Land Type: BLM (1) State (2) Fee (3) Indian _____

Depth to Groundwater
 Less Than 50 Feet (20 points) (1)
 50 Ft to 99 Ft (10 points) (2)
 Greater Than 100 Ft (0 points) (3)

Wellhead Protection Area :
 Is it less than 1000 ft from wells, springs, or other sources of fresh water extraction? , or ; Is it less than 200 ft from a private domestic water source? (1) YES (20 points) (2) NO (0 points)

Horizontal Distance to Surface Water Body
 Less Than 200 Ft (20 points) (1)
 200 Ft to 1000 Ft (10 points) (2)
 Greater Than 1000 Ft (0 points) (3)

Name of Surface Water Body Big Rincon
 (Surface Water Body : Perennial Rivers, Major Wash, Streams, Creeks, Irrigation Canals, Ditches, Lakes, Ponds)

Distance to Nearest Ephemeral Stream (1) < 100' (Navajo Pits Only) (2) > 100'

TOTAL HAZARD RANKING SCORE: 30 POINTS

REMARKS

Remarks : Redline Book - Inside Vulnerable Zone Type - Outside
Four pits on site, location drip pit #1 is dr
Will close one pit.

PL 54

ORIGINAL PIT LOCATION

Original Pit : a) Degrees from North 179° Footage from Wellhead 72'
b) Length : 13' Width : 13' Depth : 2'

ORIGINAL PIT LOCATION

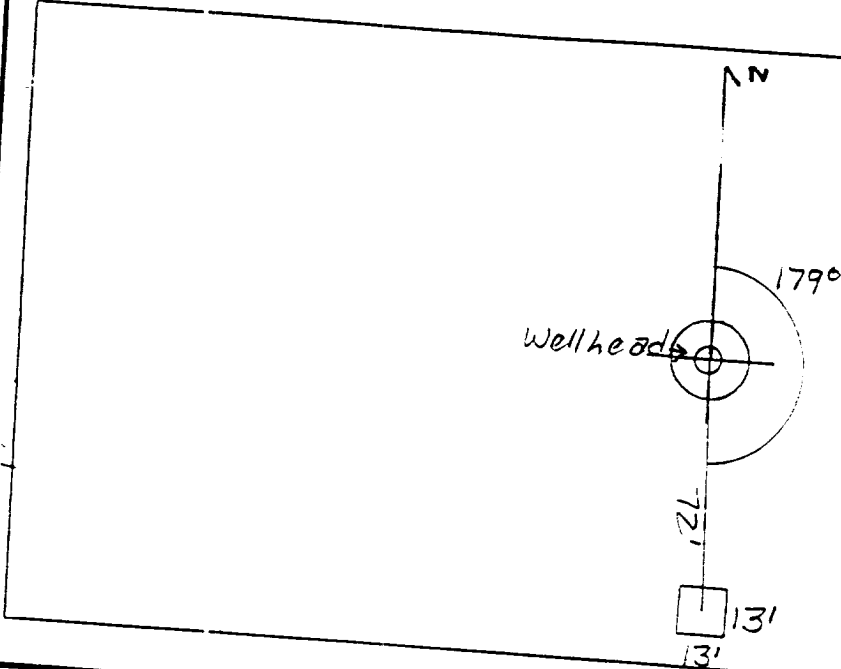

REMARKS

Remarks :

Pictures @ 1312 (1-4, Roll 12)
Dump Truck

Completed By:

Mark Kelly
Signature

9/27/94
Date

FIELD PIT REMEDIATION/CLOSURE FORM

GENERAL	Meter: <u>23-744</u> Location: <u>Nickson 10 Pit 1</u> Coordinates: Letter: <u>0</u> Section <u>14</u> Township: <u>26</u> Range: <u>8</u> Or Latitude _____ Longitude _____ Date Started : <u>9-30-94</u> Run: <u>07</u> <u>51</u>
FIELD OBSERVATIONS	Sample Number(s): <u>VW367</u> Sample Depth: <u>12'</u> Feet Final PID Reading <u>1</u> PID Reading Depth <u>12'</u> Feet Yes No Groundwater Encountered <input type="checkbox"/> <input checked="" type="checkbox"/> Approximate Depth _____ Feet
CLOSURE	Remediation Method : Excavation <input type="checkbox"/> Approx. Cubic Yards _____ Onsite Bioremediation <input type="checkbox"/> Backfill Pit Without Excavation <input checked="" type="checkbox"/> Soil Disposition: Envirotech <input type="checkbox"/> <input type="checkbox"/> Tierra Other Facility <input type="checkbox"/> Name: _____ Pit Closure Date: <u>9-30-94</u> Pit Closed By: _____
REMARKS	Remarks : _____ <u>10 yds c-11</u> _____ _____
	Signature of Specialist: <u>Vall Wilson</u>





**FIELD SERVICES LABORATORY
ANALYTICAL REPORT**

PIT CLOSURE PROJECT - Soil Samples Outside the GWV Zone

SAMPLE IDENTIFICATION

	Field ID	Lab ID
SAMPLE NUMBER:	vw 367	946294
MTR CODE SITE NAME:	73744 p.t.1	N/A
SAMPLE DATE TIME (Hrs):	9-30-94	1430
SAMPLED BY:	N/A	
DATE OF TPH EXT. ANAL.:	10-3-94	
DATE OF BTEX EXT. ANAL.:	N/A	N/A
TYPE DESCRIPTION:	VG	Brown Sand & Clay

REMARKS: _____

RESULTS

PARAMETER	RESULT	UNITS	QUALIFIERS			
			DF	Q	M(g)	V(ml)
TPH (418.1)	46.1	MG/KG			2.01	28
HEADSPACE PID	wx 10/3/94 61	PPM				
PERCENT SOLIDS	88.9	%				

-- TPH is by EPA Method 418.1 --

Narrative: _____

DF = Dilution Factor Used

Approved By: _____

Date: _____

10/6/94

